



Preliminary Information

PIT5386G Back Up Alarm Inoperative and needs to be Connected During PDI

Product Investigation Review Required

Models

Brand:	Model:	Model Years:	VIN:		Engine:	Transmissions:
			from	to		
Chevrolet	Silverado 1500	2014 - 2022	All	All	All	All
Chevrolet	Silverado 2500/3500	2015 - 2022	All	All	All	All
GMC	Sierra 1500	2014 - 2022	All	All	All	All
GMC	Sierra 2500/3500	2015 - 2022	All	All	All	All

Equipped with Back Up Alarm (RPO 8S3)

Supersession Statement

This PI was superseded to update the model years and Correction. Please discard PIT5386F.

The following diagnosis might be helpful if the vehicle exhibits the symptom(s) described in this PI.

Condition / Concern

During the PDI it may be noticed that the backup alarm is inoperative. Trucks equipped with the Back Up Alarm (RPO 8S3), the alarm will be intentionally left disconnected from the assembly plant.

Recommendations / Instructions

- For 2020-2022 3500 Chassis Cab models (31003, 31043, and 31403) the back up alarm is not installed on the truck's frame and it has been left loose inside the cab from the assembly plant. It is the upfitters responsibility to mount the back up alarm and splice into the reverse circuit. The labor op listed below does not apply to these vehicles because no additional work is needed during PDI. – Refer to the latest revision of UI Bulletin 175 (<https://www.gmupfitter.com/technical-bulletins/>) for more information
- For All Other Trucks, the alarm is located on the right rear of the frame, and the chassis harness alarm connector is located on the left rear of the frame. Route the harness up and over the spare tire hoist tube and connect to the backup alarm.

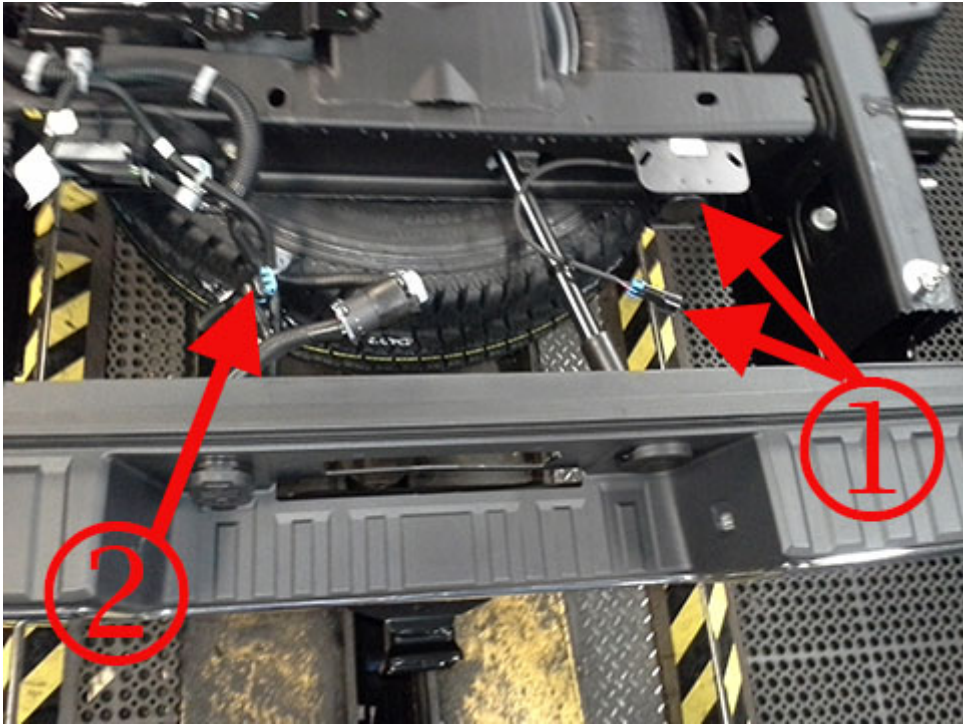

- 1. Back Up Alarm/Connector
- 2. Chassis Harness Alarm Connector

Warranty Information

For vehicles repaired under the Bumper-to-Bumper coverage (Canada Base Warranty coverage), use the following labor operation. Reference the Applicable Warranties section of Investigate Vehicle History (IVH) for coverage information.

Labor Operation	Description	Labor Time
0590032	PDI - Dealer Installed - Factory Invoiced Options	Use Published Labor Operation Time

Please follow this diagnostic or repair process thoroughly and complete each step. If the condition exhibited is resolved without completing every step, the remaining steps do not need to be performed.

Additional SI Keywords

backup reverse shift

