

FLA COE
FLB COE
FLD Conventional
Business Class
FLC 112 Conventional

Century Class Conventional
Argosy
Cargo
Columbia

Coronado
Business Class M2
> Cascadia
108SD/114SD

**Freightliner
Service Bulletin**

Description of Revisions: *This bulletin replaces the version dated December 2013. The related VMRS codes are added.*

General Information

On some Cascadia 125 vehicles built before October 24, 2011, the cab-mounted splash shields may crack. A brace has been designed to reinforce the splash shields and prevent cracking. Use the procedure in this bulletin to replace the broken splash shield(s), and to install braces on both splash shields.

NOTE: Cascadia 125 vehicles built between October 24, 2011 and December 1, 2013 are equipped with braces from the factory.

Cascadia 125 vehicles built after December 1, 2013 are equipped with new splash shields that do not require a brace; these splash shields (A22-69527-000 and -001) are interchangeable with the old splash shields (A22-63542-xxx), except the braces do not fit on the new splash shields and are not intended to be used with them.

Parts

Parts are available through the PDCs. See [Table 1](#) for parts needed to install braces on both sides of the vehicle.

NOTE: The braces are designed to be used only with the old splash shields (A22-63542-xxx). Do not install braces on the new splash shields (A22-69527-000 and -001).

Parts for Cab-Mounted Splash Shields		
Part Number	Description	Qty.
A17-19549-002	Brace Tube, Splash Shield, LH	1
A17-19549-003	Brace Tube, Splash Shield, RH	1
A17-19796-000	Nut Plate	2
17-20042-000	Flat Plate	2
23-12645-735	Screw	4
23-10900-032	Washer	4

Table 1, Parts for Cab-Mounted Splash Shields

Procedure

1. Park the vehicle on a level surface, shut down the engine, and set the parking brake. Chock the tires.
2. Replace the broken splash shield(s). See *Cascadia Workshop Manual*, [Section 88.01, Subject 100](#).

NOTE: If replacing the splash shield, do not install the nut and washer on the front-wall stud yet, as they will be used to secure the upper end of the brace also.

3. For better access to the wheel well, steer the wheel on the affected side to point inboard.
4. If installing the brace on an undamaged splash shield, remove the nut and washer that attach the splash shield to the cab front wall.
5. Using the nut and washer, attach the upper end of the brace to the front-wall stud. Tighten the nut 15 lbf·ft (21 N·m). See [Fig. 1](#).

Freightliner Service Bulletin

FLA COE
FLB COE
FLD Conventional
Business Class
FLC 112 Conventional

Century Class Conventional
Argosy
Cargo
Columbia

Coronado
Business Class M2
> Cascadia
108SD/114SD

6. The lower end of the brace fits into the groove on the inboard side of the splash shield. Using the brace as a template, mark the centers of two holes to be drilled into the splash shield.
7. Using a 3/8-inch (9-mm) bit, drill two holes in the splash shield.
8. Assemble the flat plate, the two washers, and the two screws with the lower end of the brace. Position the nut plate on the aft side of the splash shield, then secure all items together. Tighten the screws 12 lbf-ft (16 N·m).

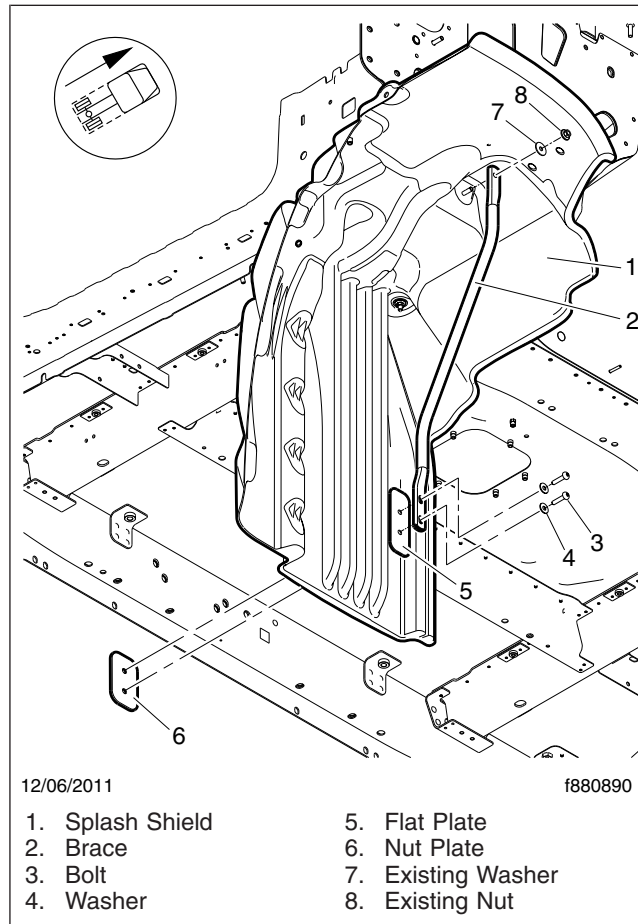

Fig. 1, Splash Shield Brace Installation

Warranty

This procedure is warrantable only if the described condition exists and the repair is performed within the applicable base or extended coverage warranty period. If a failure is not found, this procedure is considered preventive and warranty does not apply.

Normal warranty applies. See [Table 2](#) for QuickClaim damage code and labor allowance information. Refer to this service bulletin by number at the beginning of the claim comments. See [Table 3](#) for OWL VMRS codes and labor allowance information. Enter this service bulletin number in the *Service Bulletin #:* field.

FLA COE
 FLB COE
 FLD Conventional
 Business Class
 FLC 112 Conventional

Century Class Conventional
 Argosy
 Cargo
 Columbia

Coronado
 Business Class M2
 > Cascadia
 108SD/114SD

**Freightliner
 Service Bulletin**

QuickClaim Damage Code and Labor Allowance			
Damage Code	SRT Code	Description	Time: Hours
667-002A01130	667-5010B	SHIELD, SPLASH, REPLACE AND INSTL BRACE, BOTH SIDES	1.3

Table 2, QuickClaim Damage Code and Labor Allowance

OWL VMRS Codes and Labor Allowance					
Primary Failed Part	Component Code	Cause Code	SRT Code	Description	Time: Hours
A22-63542-000	002-002-042	14	667-5010B	SHIELD, SPLASH, REPLACE AND INSTL BRACE, BOTH SIDES	1.3

Table 3, OWL VMRS Codes and Labor Allowance

NOTE:

Component Code / VMRS = 002-002-046 BRACKET - SPLASH SHIELD, FENDER

Component Code / VMRS = 002-002-042 GUARD - SPLASH (MULTIPLE APPLICATIONS)

