



TECH EXCHANGE

©2021 YAMAHA MOTOR CORPORATION, U.S.A.

SUBJECT: ALL XV19F (STAR VENTURE), XV19B (STAR ELUDER), CZD300 (XMAX), AND XP500F (TMAX) MODELS
— Securing Important Yamaha Smart Key System Information

i INTRODUCTION

Motorcycle and scooter models equipped with a smart key system are supplied with one smart key (also called a “key fob”) and a card containing the “smart key emergency code.” It’s extremely important to record the vehicle’s unique emergency code properly on the Predelivery Inspection (PDI) sheet as well as in the Owner’s Manual. Supply the smart key emergency code card to the customer during unit delivery. In the event both the smart key and emergency code have been misplaced, the only way to remedy the situation is to replace the entire smart key system – a costly solution.

Below is an image of the actual smart key emergency code card supplied with the vehicle. Yamaha does NOT keep a record of this information. It is your responsibility as a dealer to record this information and provide it to the customer at the time of sale.



Actual Smart Key emergency code

Write the smart key emergency code legibly in the “KEY NO.” box on the PDI sheet.

YAMAHA MOTORCYCLE & SCOOTER DEALER SET-UP AND PREDELIVERY CHECKLIST			
MODEL	FRAME NO. (VIN)	PRIMARY ID	KEY NO.
SET-UP ASSEMBLY			
Assemble according to the assembly manual and any technical bulletin information that applies to the particular model. Pay special attention to the following items:			
<input type="checkbox"/> FRONT FORK PINCH BOLTS - Torque to specification (if equipped)	<input type="checkbox"/> BRAKE PEDAL - Install per assembly manual (if equipped)		
<input type="checkbox"/> FRONT WHEEL AND AXLE - Torque axle and axle holder to specifications (if equipped)	<input type="checkbox"/> CONTROLS - Check for proper operation and cable routing		
	<input type="checkbox"/> KEYS - Check all locks for proper operation.		

The Owner’s Manual for these vehicles also explains the smart key emergency code. This is another great location to record the actual code for the vehicle (write it legibly in the manual).

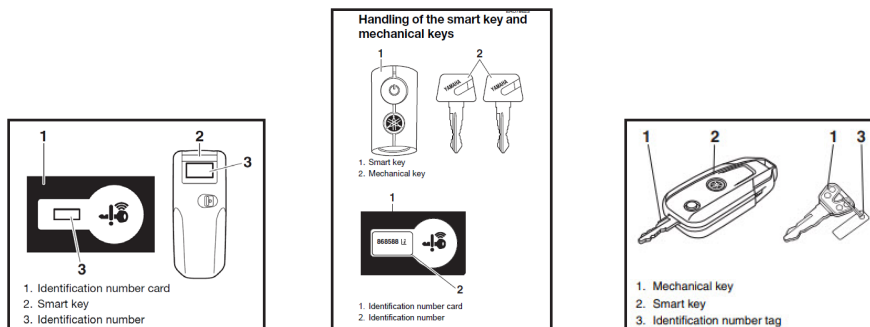

Star Venture / Star Eluder models

XMAX models

TMAX models