



Technical Journal

TITLE:

Evap system DTC ECM P044200

REF NO: TJ 35956.2.0	ISSUING DEPARTMENT: Technical Service	CAR MARKET: United States and Canada	
PARTNER: 3 US 7510 Volvo Car USA		ISSUE DATE: 2021-07-12	STATUS DATE: 2021-07-13
FUNC GROUP: 2340	FUNC DESC: fuel tank, fuel lines, evaporator system	Page 1 of 14	

“Right first time in Time”

Attachment

File Name	File Size
TJ-35956 1 (1).jpg	2.3437 MB
TJI-520985-2_1_0_en-US (1).pdf	3.7616 MB

Rows beginning with * are modified

Note! If using a printed copy of this Technical Journal, first check for the latest online version.

DESCRIPTION:

If the check engine lamp may appear in the DIM (Driver Information Module) and the listed DTC is set, follow “service”.

Usually the car is running without any drivability issues when this DTC is set.

CSC Customer Symptom Codes

Code	Description
DL	Warning lights and chimes/Malfunction Indicator Light ("Check engine" light) indication/no indication

DTC Diagnostic Trouble Codes

ECU	DTC	Fault Type
ECM	P044200	Permanent



Vehicle Type

Type	Eng	Eng Desc	Sales	Body	Gear	Steer	Model Year	Plant	Chassis range	Struc Week Range
224							2019-2020	70	0001116-0050383	201817-201946
225							2019-2020	21	0000324-0368333	201817-201946
225							2019-2020	22	0016395-0069480	201840-201946
227							2019-2020	21	0000602-0040063	201846-201948
234							2017-2019	21	0005417-0061348	201635-201822
234							2019-2020	35	0061349-0082471	201822-201946
235							2017-2020	21	0001700-0132410	201635-201946
236							2018-2020	21	0005505-0107455	201709-201946
238							2018-2020	35	0040932-0161856	201746-201946
246							2018-2020	21	0000389-0511603	201717-201946
246							2018-2020	36	0042892-0533148	201746-201946
256							2017-2020	21	0141506-0578774	201641-201946
256							2017-2020	21	0141506-0578774	201641-201946

SERVICE:

Follow VIDA fault tracing. There is a new spare part launched.

-If you have to change the filler pipe see attached picture TJ35956.1.

-If the filler pipe match picture A - change filler pipe insert according to the attached instruction and the part number that match your car in the instruction.

-If the filler pipe match picture B or have no match - change complete filler pipe, part number according to VIDA.

*Warranty claim info:

To get warranty claim accepted for a job described in this TJ, please use following data:

VST OP number: 98764-2, 36001-2

VST Operation Number

VST Operation Number	Description
98764-2	Insert, filling pipe replacement acc. to TJ35956
36001-2	Diagnostic trouble codes read / reset / known Diagnostic trouble codes with VIDA

VEHICLE REPORT:

Yes, please submit a Vehicle Report if the service solution described in this TJ has no effect. Use concern area "Vehicle Report" and sub concern area "Support not needed", use function group 2340.

To view TJ attachments continue to next page. This TJ has two attachments.

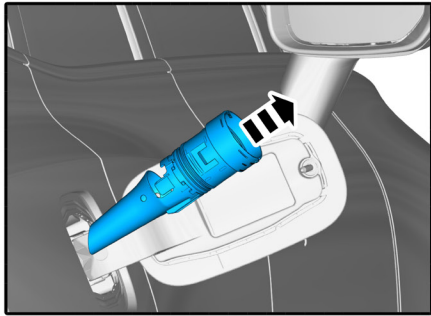

TJ-35956.1.

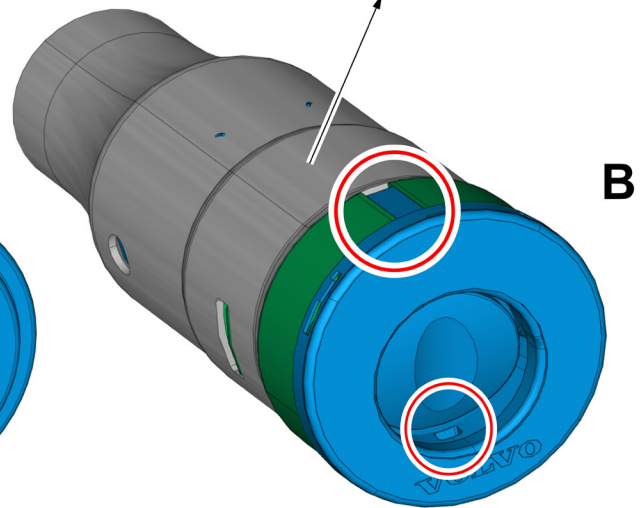
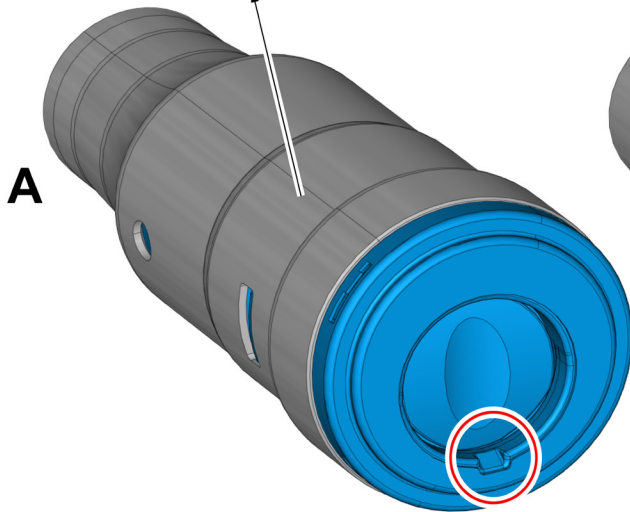
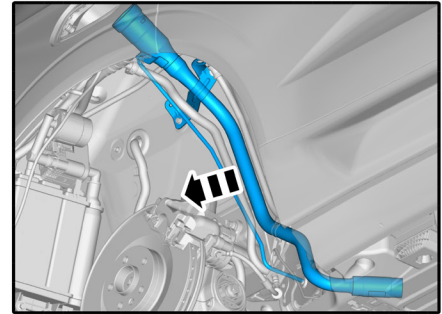



Volvo Car Customer Service

TJ Instruction VCC-520985-2

Title	Filling pipe insert	Page	1 (11)
Action	Product fix	Operation number:	98764-2

Issue	Date	Reason
1	2021-04	First issue

Affected vehicles

Model year	Model
2019, 2020	S60 (19-)
2017, 2018, 2019, 2020	S90 (17-)
2017, 2018, 2019, 2020	S90L
2019, 2020	V60 (19-)
2019, 2020	V60 Cross Country (19-)
2017, 2018, 2019, 2020	V90 (17-)
2017, 2018, 2019, 2020	V90 Cross Country
2018, 2019, 2020	XC60 (18-)
2017, 2018, 2019, 2020	XC90 (16-)

Materials

Materials	Qty.	Part No.	Notes
Silicone grease	1	1161687	
Insert	1.0	32312179	Petrol;
Insert	1.0	32363302	PHEV;

Special tools

Description	Part No.
SLEDGE (EXTRACT-OVERDRIVE) J cover remover	999 2709
	999 7786

Equipment

Designation	Part No.
Pipe wrench	
Marker pen	

Color symbols

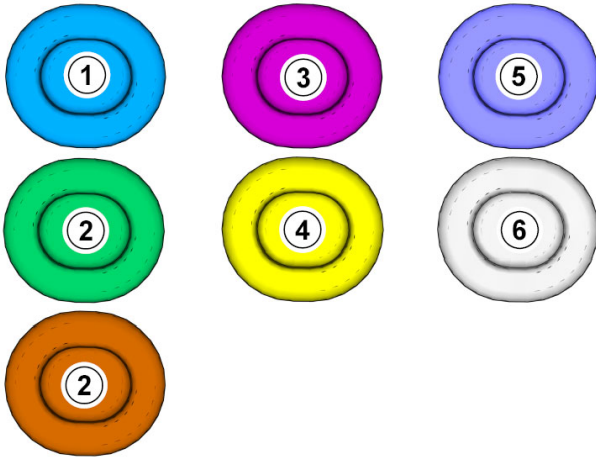

Note! This colour chart displays (in colour print and electronic version) the importance of the different colours used in the images of the method steps.

- 1 . Used for focused component, the component with which you will do something.
- 2 . Used as extra colors when you need to show or differentiate additional parts.
- 3 . Used for attachments that are to be removed/installed. May be screws, clips, connectors, etc.
- 4 . Used when the component is not fully removed from the vehicle but only hung to the side.
- 5 . Used for standard tools and special tools.
- 6 . Used as background color for vehicle components.

Removal

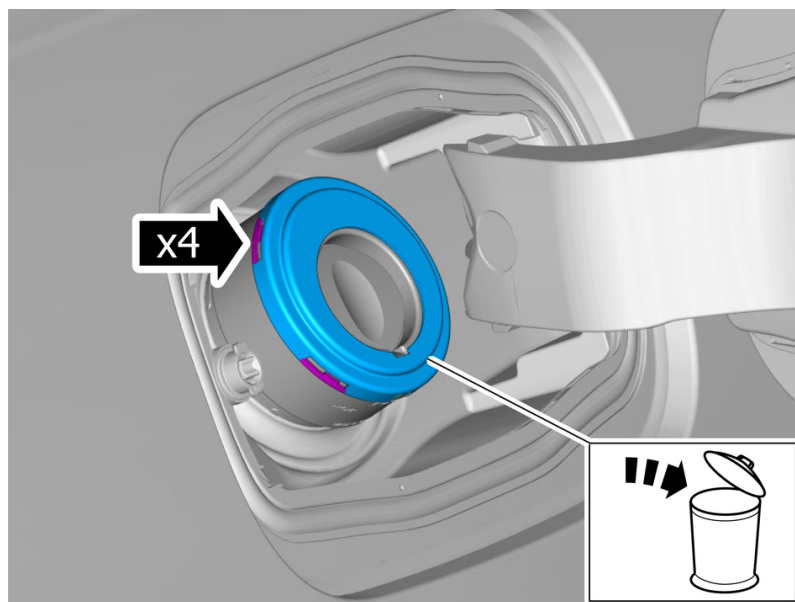

Loosen the fasteners.
Remove the marked part.

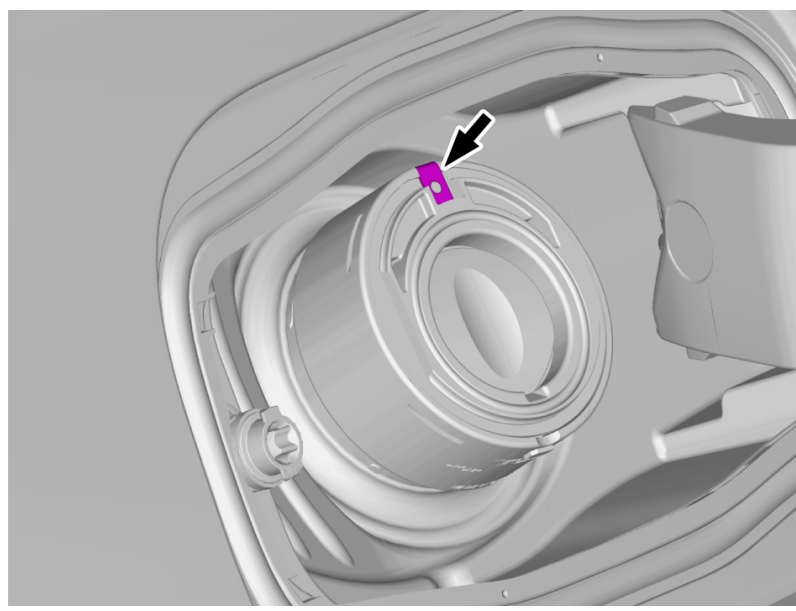

Fold marked part aside.

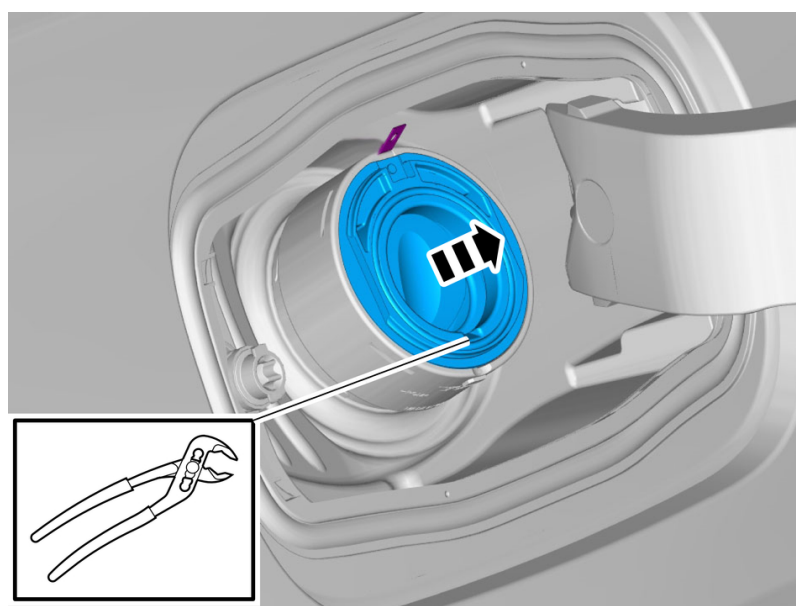

Remove the marked part.

Use: Pipe wrench

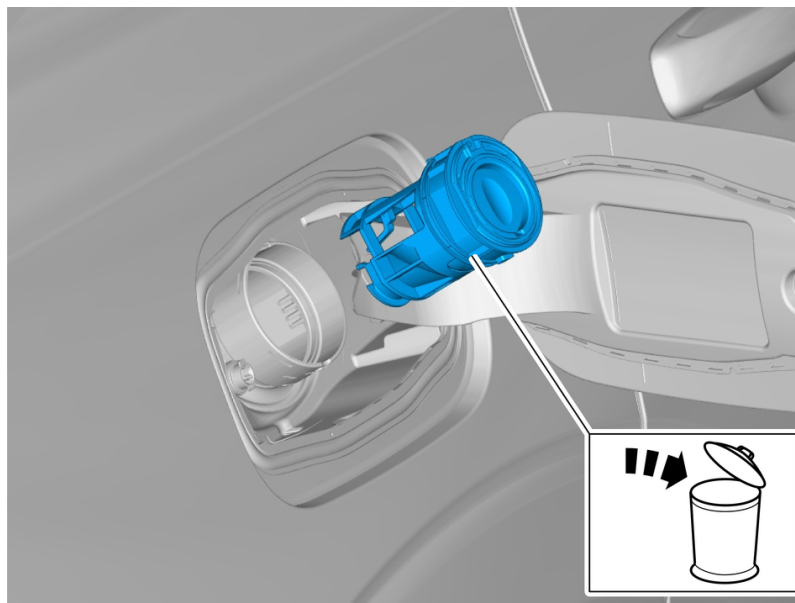

Note! Make sure that the whole detail is removed.

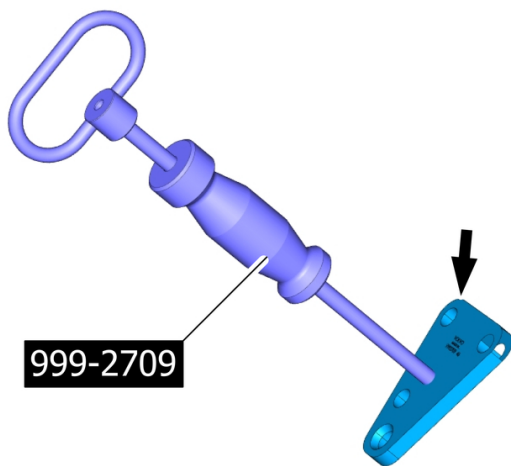

Special Tool: T9992709, SLEDGE (EXTRACT-OVERDRIVE) J

Remove the marked part.

Special Tool: T9997786, cover remover

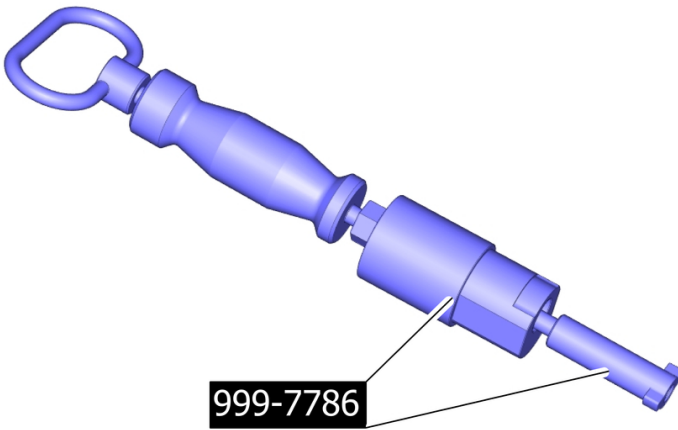

Caution! Note the placing of the tool.

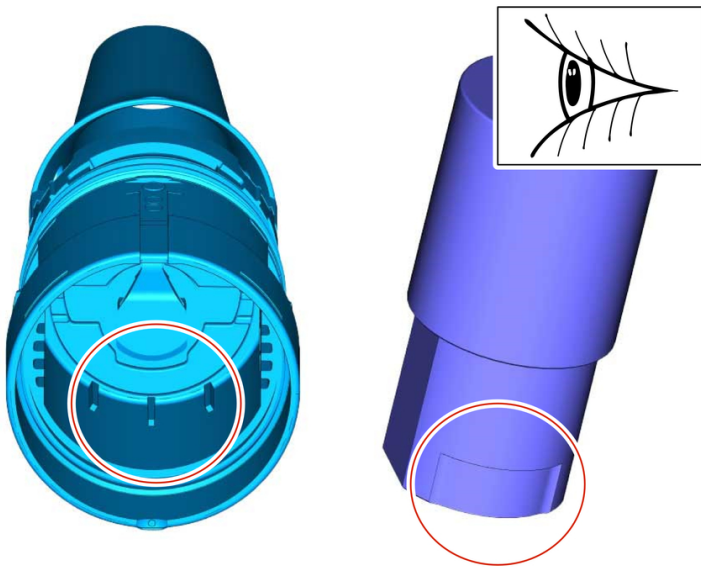

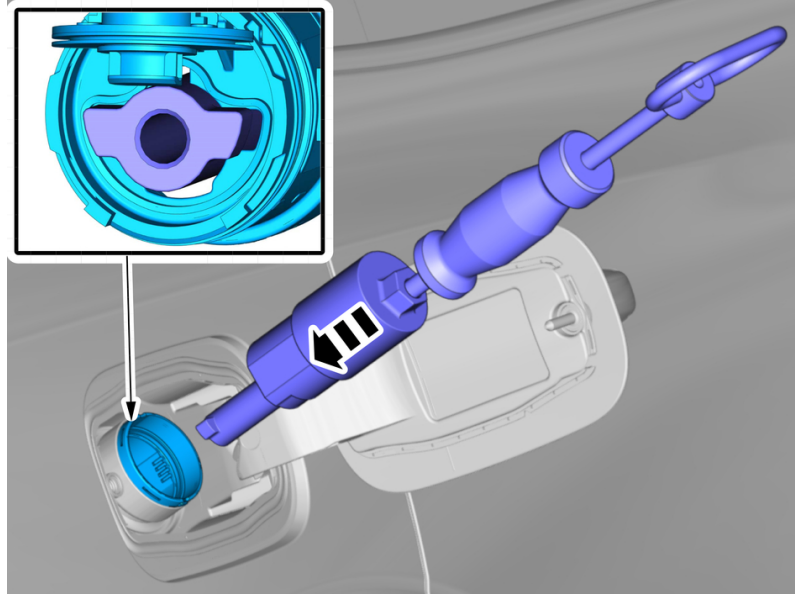

Install the tools.

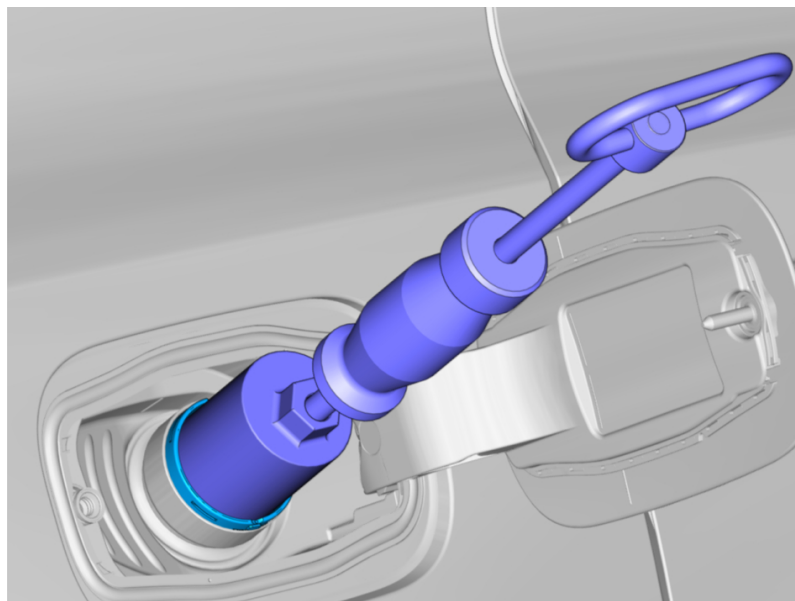

Caution! Make sure that the components is positioned correctly.

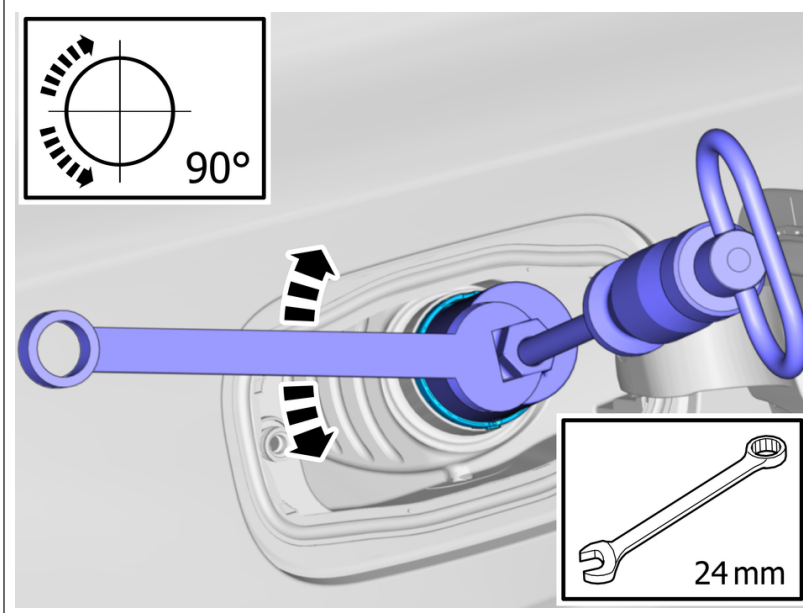

Caution! Make sure not to damage painted surfaces.

Rotate marked component according to image.
Turn back to original position.

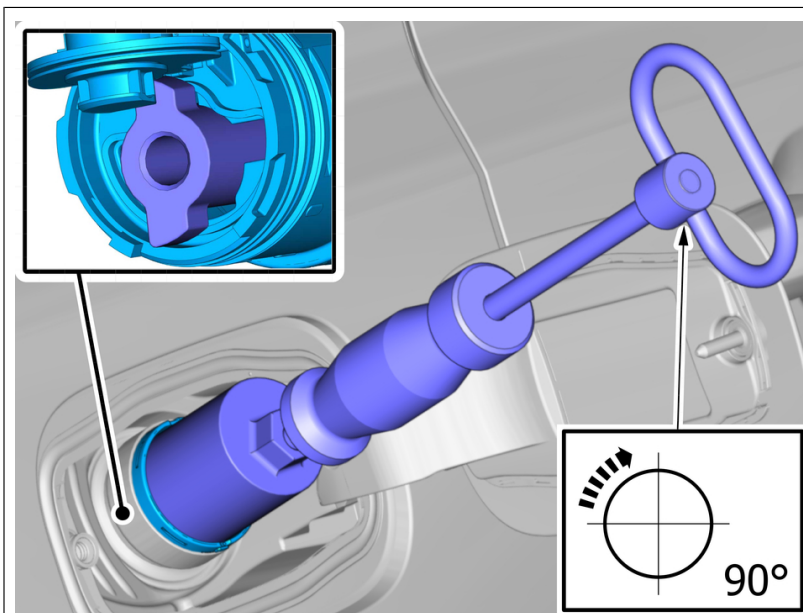

Caution! Make sure that the components is positioned correctly.

Rotate marked component according to image.

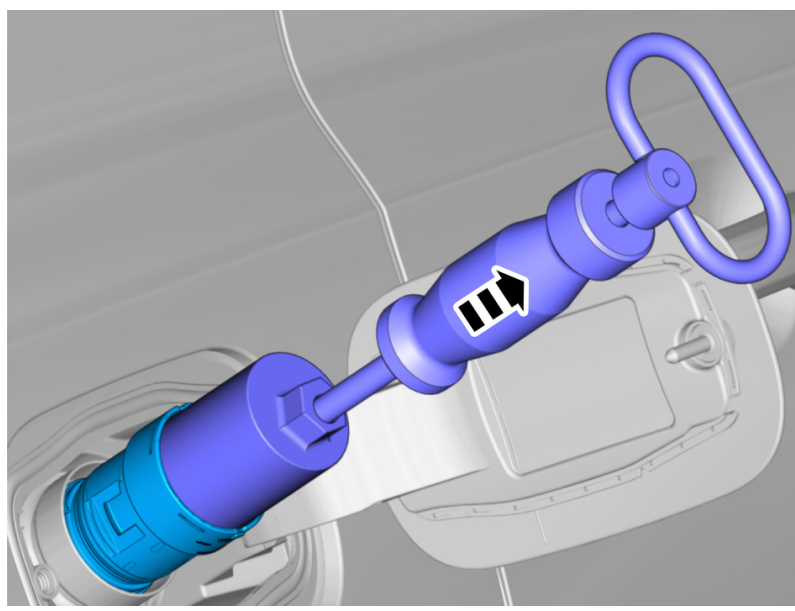

Note! Only use moderate force.

Use the special tool to release the marked detail.

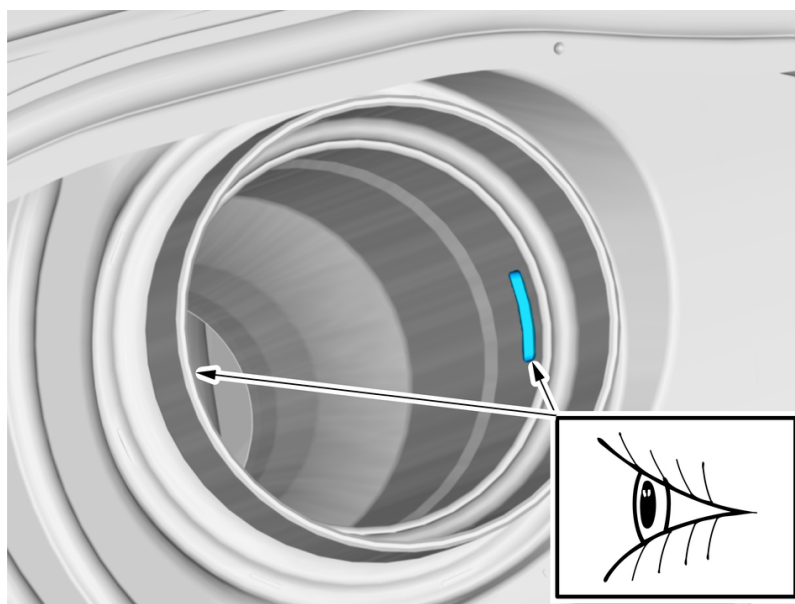

Note! Make sure that no residue remains, according to image.

Installation

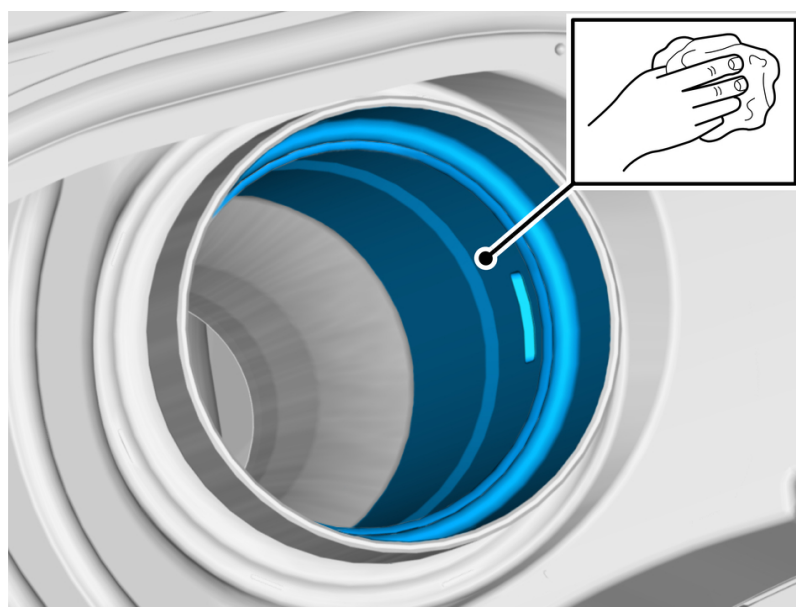

Clean the marked area.

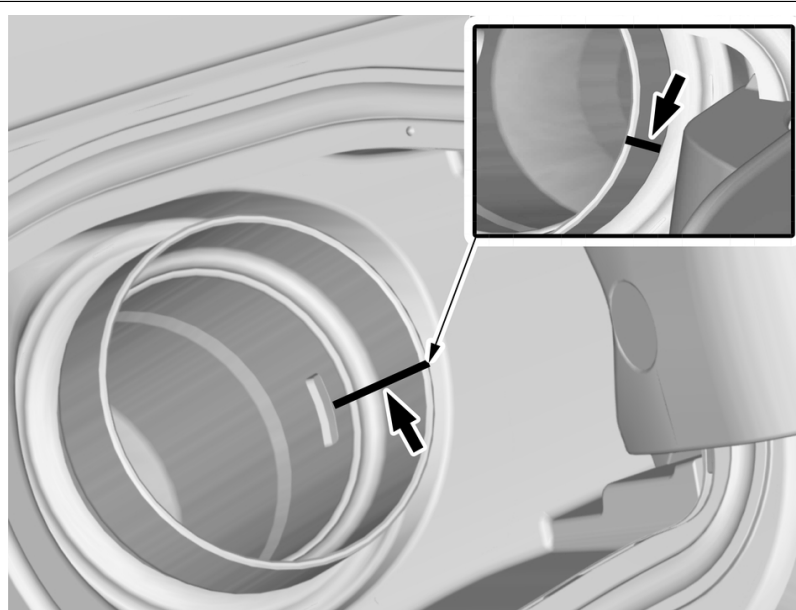

Use: Marker pen

Mark center according to image.

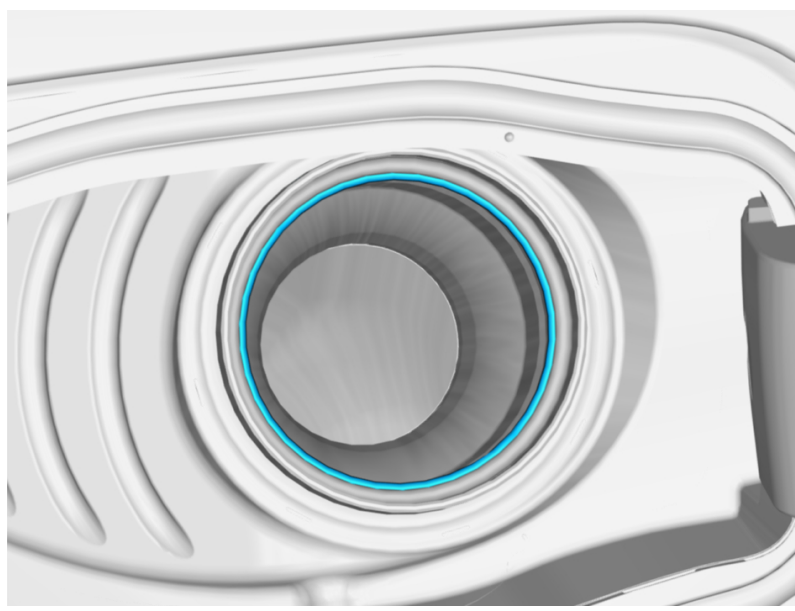

Apply grease on the area indicated.

Use: Silicone grease , 1161687

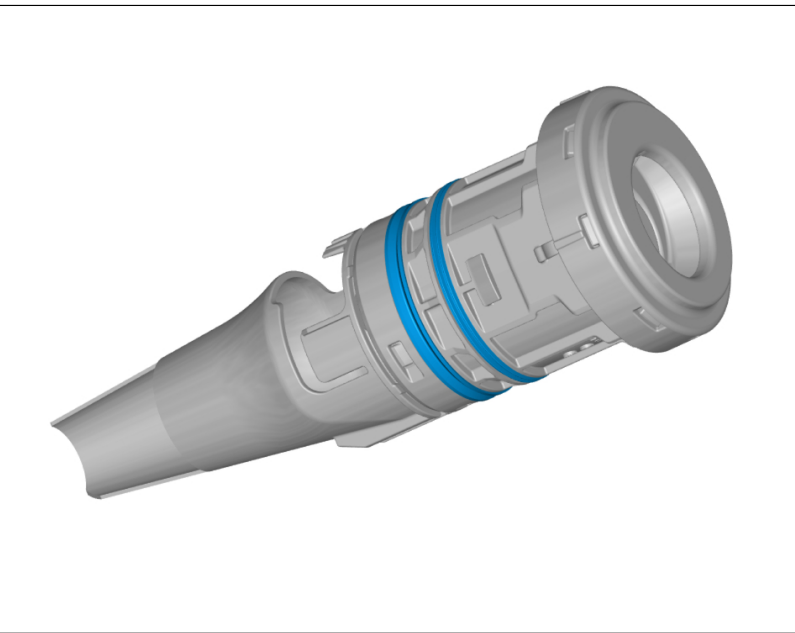

Apply grease on the area indicated.

Use: Silicone grease , 1161687

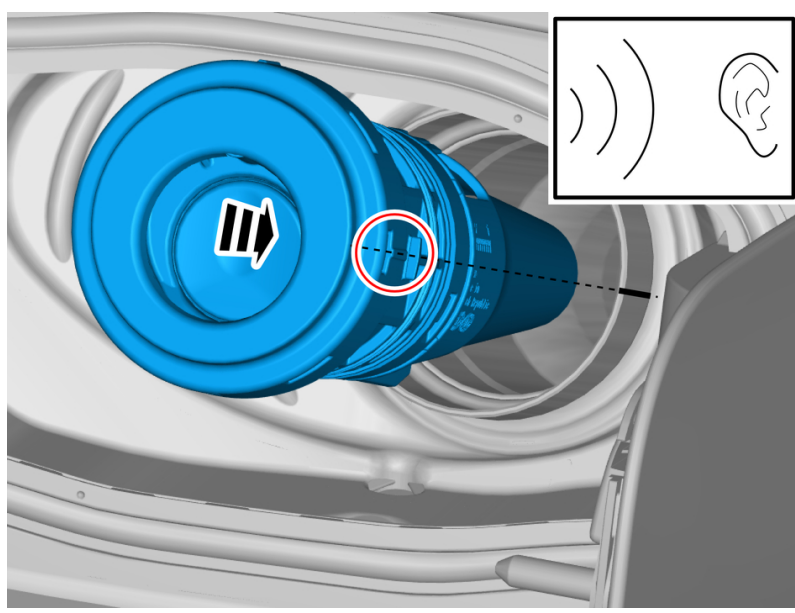

Caution! Make sure that the component is positioned correctly.

Install the marked component.
A click confirms that the component is in the correct position.