



Technical Service Bulletin

SUBJECT:			No: TSB-21-42A-006
UPDATES TO FUEL FILLER LID - SERVICE MANUAL REVISION			DATE: October 2021
			MODEL: See Below
CIRCULATE TO:	<input type="checkbox"/> GENERAL MANAGER	<input checked="" type="checkbox"/> PARTS MANAGER	<input checked="" type="checkbox"/> TECHNICIAN
<input checked="" type="checkbox"/> SERVICE ADVISOR	<input checked="" type="checkbox"/> SERVICE MANAGER	<input checked="" type="checkbox"/> WARRANTY PROCESSOR	<input type="checkbox"/> SALES MANAGER

PURPOSE

This TSB provides newly added and updated content for the Body section of the affected Service Manual, Fuel Filler Lid.

AFFECTED VEHICLES

- 2018-2021 Outlander PHEV

AFFECTED SERVICE MANUAL

- 2018-2021 Outlander PHEV Service Manual, Group 42A-Body -> Fuel Filler Lid



Please replace the pages in the 2018 Outlander PHEV Service Manual, Group 42A-Body -> Fuel Filler Lid sections as follows:

- 2018 Outlander PHEV Service Manual, Group 42A-Body -> Fuel Filler Lid - Special Tools/ Trouble Symptom Chart - Attached sheets 18 and 32
- 2018 Outlander PHEV Service Manual, Group 42A-Body -> Fuel Filler Lid - Inspection Procedure - Attached sheets 33 and 34
- 2018 Outlander PHEV Service Manual, Group 42A-Body -> Fuel Filler Lid - Lid Removal and Installation - Attached sheets 19 and 5
- 2018 Outlander PHEV Service Manual, Group 42A-Body -> Fuel Filler Lid - Fuel Filler Lid Inspection - Attached sheet 20

Please replace the pages in the 2019 Outlander PHEV Service Manual, Group 42A-Body -> Fuel Filler Lid sections as follows:

- 2019 Outlander PHEV Service Manual, Group 42A-Body -> Fuel Filler Lid - Special Tools/ Trouble Symptom Chart - Attached sheets 23 and 32
- 2019 Outlander PHEV Service Manual, Group 42A-Body -> Fuel Filler Lid - Inspection Procedure - Attached sheets 33 and 34
- 2019 Outlander PHEV Service Manual, Group 42A-Body -> Fuel Filler Lid - Lid Removal and Installation - Attached sheets 24 and 35
- 2019 Outlander PHEV Service Manual, Group 42A-Body -> Fuel Filler Lid - Fuel Filler Lid Inspection - Attached sheet 25

Copyright 2021, Mitsubishi Motors North America, Inc.

The information contained in this bulletin is subject to change. For the latest version of this document, go to the Mitsubishi Dealer Link, MEDIC, or the Mitsubishi Service Information website (www.mitsubishitechinfo.com).

(5122)

Please replace the pages in the 2020 Outlander PHEV Service Manual, Group 42A-Body -> Fuel Filler Lid sections as follows:

- 2020 Outlander PHEV Service Manual, Group 42A-Body -> Fuel Filler Lid - Special Tools/ Trouble Symptom Chart - Attached sheets 23 and 32
- 2020 Outlander PHEV Service Manual, Group 42A-Body -> Fuel Filler Lid - Inspection Procedure - Attached sheets 33 and 34
- 2020 Outlander PHEV Service Manual, Group 42A-Body -> Fuel Filler Lid - Lid Removal and Installation - Attached sheets 24 and 35
- 2020 Outlander PHEV Service Manual, Group 42A-Body -> Fuel Filler Lid - Fuel Filler Lid Inspection - Attached sheet 25

Please replace the pages in the 2021 Outlander PHEV Service Manual, Group 42A-Body -> Fuel Filler Lid sections as follows:

- 2021 Outlander PHEV Service Manual, Group 42A-Body -> Fuel Filler Lid - Special Tools/ Trouble Symptom Chart - Attached sheets 30 and 32
- 2021 Outlander PHEV Service Manual, Group 42A-Body -> Fuel Filler Lid - Inspection Procedure - Attached sheets 33 and 34
- 2021 Outlander PHEV Service Manual, Group 42A-Body -> Fuel Filler Lid - Lid Removal and Installation - Attached sheets 19 and 5
- 2021 Outlander PHEV Service Manual, Group 42A-Body -> Fuel Filler Lid - Fuel Filler Lid Inspection - Attached sheet 20

REMOVAL AND INSTALLATION

M14210025A0004

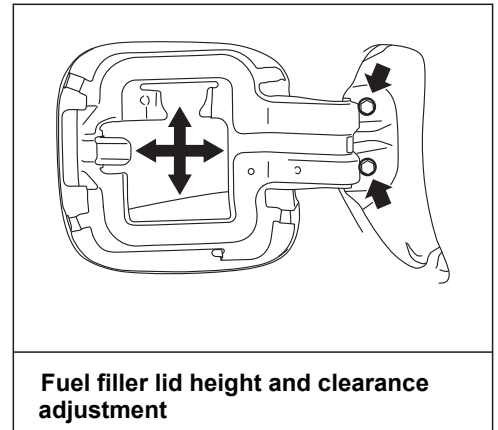
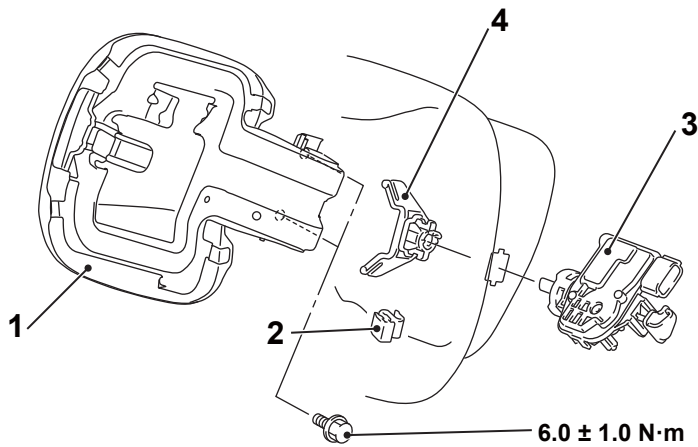

Fuel filler lid height and clearance adjustment

BCKA0800AA

Removal steps

1. Fuel filler lid
2. Fuel filler lid damper spring
- Quarter trim lower (LH) (Refer to GROUP 52A - Interior Trim).

<Added> >>A<<

Removal steps

3. Fuel filler lid opener actuator
4. Fuel filler lid hook

<Added>

INSTALLATION SERVICE POINT

>>A<< FUEL FILLER LID OPENER ACTUATOR INSTALLATION

CAUTION

Do not install the fuel filler lid opener actuator by turning it anti-clockwise.

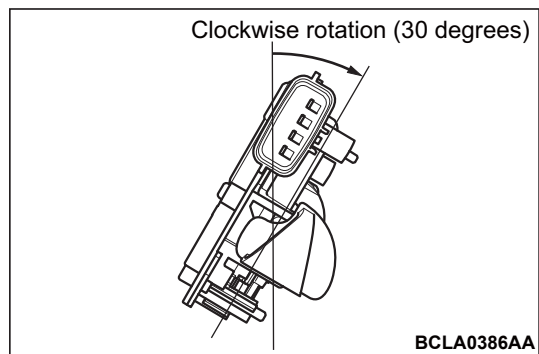

Insert the fuel filler lid opener actuator into the fuel filler lid hook which is installed to the vehicle body. Then install the fuel filler lid opener actuator by turning it clockwise.

BODY
FUEL FILLER LID



42A-33

FUEL FILLER LID

SPECIAL TOOL(S)

<Added> Attached sheet 32

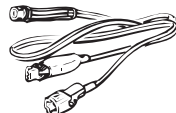
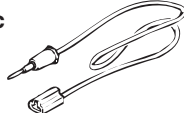
M1421000600740

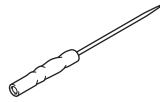
Tool	Tool number and name	Supersession	Application
<p>a</p>  <p>b</p>  <p>c</p>  <p>d</p>  MB991223	MB991223 a. MB991219 b. MB991220 c. MB991221 d. MB991222 Harness set a. Test harness b. LED harness c. LED harness adaptor d. Probe	General service tools	Continuity check and voltage measurement at harness wire or connector for loose, corroded or damaged terminals, or terminals pushed back in the connector. a. Connector pin contact pressure inspection b. Power circuit inspection c. Power circuit inspection d. Commercial tester connection
 MB992006	MB992006 Extra fine probe	-	Making voltage and resistance measurement during troubleshooting

DIAGNOSIS

<Correct> Refer to Attached sheet 33

TROUBLE SYMPTOM CHART

M1421006000520

Trouble symptom	Inspection procedure number	Reference page
The fuel filler lid will not closed.	1 <Incorrect>	Refer to GROUP 13A - Troubleshooting P.13A-46.
The fuel filler lid will not open.	2	P.42A-12

<Added>

The fuel filler lid locks but "CLOSE FUEL LID AND CAP" is displayed on the warning screen.	1 - 1	Refer to Attached sheet 34
--	-------	----------------------------

<Added>

NOTE: The engine control module (ECM) also sets a diagnostic trouble code of refueling control-related component. Therefore, if the following warning screens are displayed on the multi-information display of the combination meter, check whether the diagnostic trouble code is set in the ECM. If the diagnostic trouble code is set, carry out troubleshooting for the relevant diagnostic trouble code [Refer to GROUP 13A - MULTIPOINT FUEL INJECTION (MFI) DIAGNOSIS - Diagnostic Trouble Code Chart].

- REFUELING SYSTEM SERVICE REQUIRED
- "CLOSE FUEL LID AND CAP" or "READY TO REFUEL" on the warning screen does not disappear even after the fuel filler lid is closed.

42A-36

BODY FUEL FILLER LID

REMOVAL AND INSTALLATION

M1421002501485

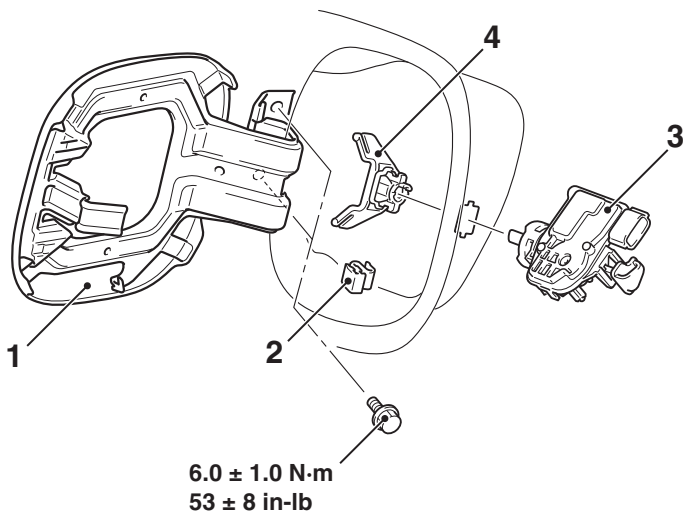

6.0 ± 1.0 N·m
53 ± 8 in-lb

Removal steps

1. Fuel filler lid
2. Fuel filler lid damper spring

<Added>

>>A<<

Removal steps (Continued)

3. Fuel filler lid opener actuator
4. Fuel filler lid hook

ACH04432AB

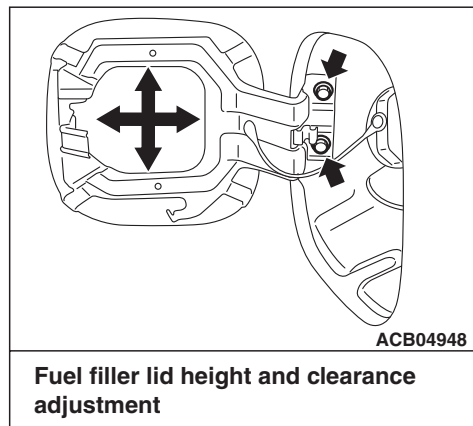

Fuel filler lid height and clearance adjustment

REMOVAL AND INSTALLATION

Attached sheet 35

<Added>

M1421013000016

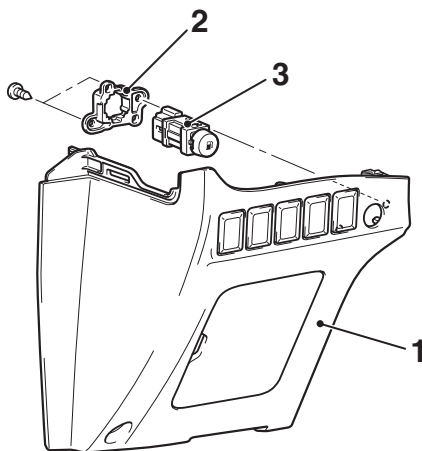

Removal steps

1. Instrument panel lower LH (Refer to GROUP 52A – Instrument Panel Assembly P.52A-3.)

Removal steps (Continued)

2. Instrument panel switch holder
3. Fuel filler lid opener switch

ACG00300AC

BODY
FUEL FILLER LID

42A-37

FUEL FILLER LID INSPECTION

M1421002600092

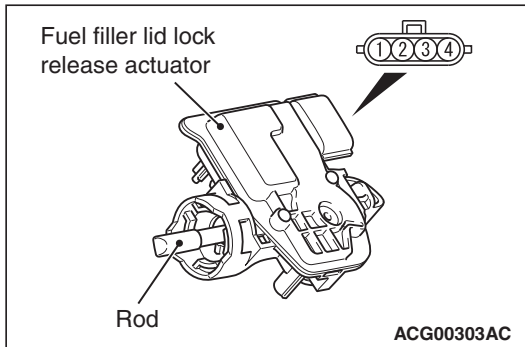

FUEL FILLER LID OPENER ACTUATOR CHECK

Fuel filler lid opener actuator rod:	Battery connected terminal No.	Normal conditions
Closed (Rod protruded)	1(-) – 2(+)	Open (Rod was pulled in)
	Disconnected	Closed (Rod protruded)

FUEL FILLER LID OPENER SWITCH CHECK

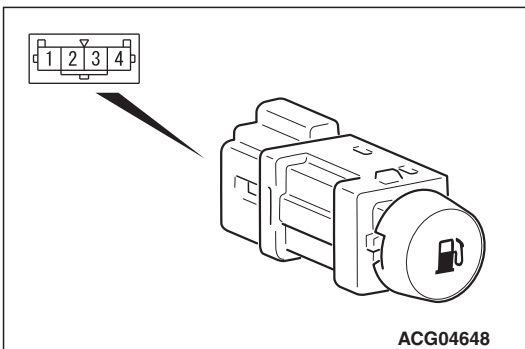

Switch position	Terminal number	Normal value
ON (Press)	1 – 2	Continuity exists (2 Ω or less)
OFF	1 – 2	No continuity

<Added>

CAUTION

Do not energize the component three seconds or more as it may be damaged.

BODY
FUEL FILLER LID



42A-31

FUEL FILLER LID

SPECIAL TOOLS

<Added> Attached sheet 32

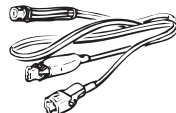
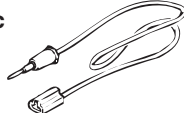
M1421000600740

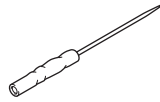
Tool	Tool number and name	Supersession	Application
<p>a</p>  <p>b</p>  <p>c</p>  <p>d</p>  <p>MB991223</p>	<p>MB991223</p> <p>a. MB991219</p> <p>b. MB991220</p> <p>c. MB991221</p> <p>d. MB991222</p> <p>Harness set</p> <p>a. Test harness</p> <p>b. LED harness</p> <p>c. LED harness adaptor</p> <p>d. Probe</p>	<p>General service tools</p>	<p>Continuity check and voltage measurement at harness wire or connector for loose, corroded or damaged terminals, or terminals pushed back in the connector.</p> <p>a. Connector pin contact pressure inspection</p> <p>b. Power circuit inspection</p> <p>c. Power circuit inspection</p> <p>d. Commercial tester connection</p>
 <p>MB992006</p>	<p>MB992006</p> <p>Extra fine probe</p>	<p>—</p>	<p>Making voltage and resistance measurement during troubleshooting</p>

DIAGNOSIS

<Correct>

Refer to Attached sheet 33

TROUBLE SYMPTOM CHART

M1421006000520

Trouble symptom	Inspection procedure number	Reference page
The fuel filler lid will not closed.	1	Refer to GROUP 13A – Troubleshooting P.13A-47.
The fuel filler lid will not open.	2	P.42A-11

<Added>

The fuel filler lid locks but "CLOSE FUEL LID AND CAP" is displayed on the warning screen.	1 - 1	Refer to Attached sheet 34
--	-------	----------------------------

<Added>

NOTE: The engine control module (ECM) also sets a diagnostic trouble code of refueling control-related component. Therefore, if the following warning screens are displayed on the multi-information display of the combination meter, check whether the diagnostic trouble code is set in the ECM. If the diagnostic trouble code is set, carry out troubleshooting for the relevant diagnostic trouble code [Refer to GROUP 13A - MULTIPORT FUEL INJECTION (MFI) DIAGNOSIS - Diagnostic Trouble Code Chart].

- REFUELING SYSTEM SERVICE REQUIRED
- "CLOSE FUEL LID AND CAP" or "READY TO REFUEL" on the warning screen does not disappear even after the fuel filler lid is closed.

42A-34

BODY FUEL FILLER LID

REMOVAL AND INSTALLATION

M1421002501485

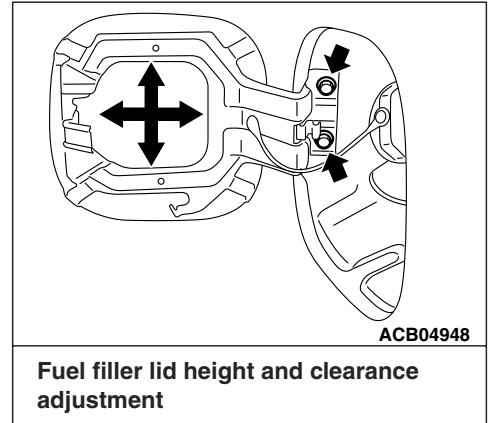
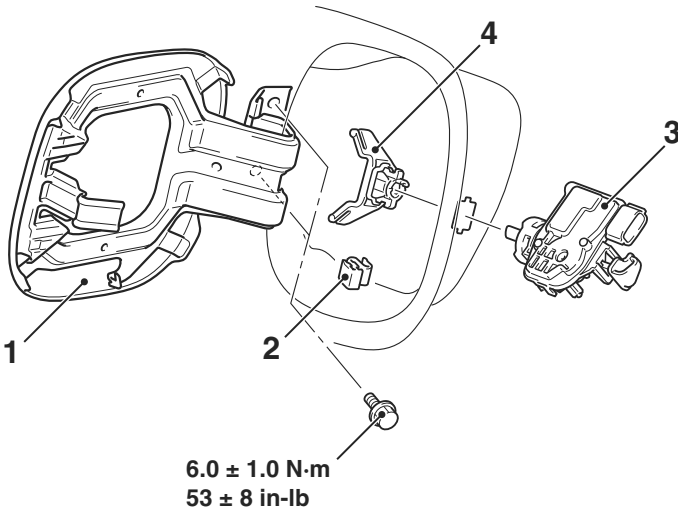

ACH04432AB

- Removal steps**
1. Fuel filler lid
 2. Fuel filler lid damper spring

<Added> >>A<<

- Removal steps (Continued)**
3. Fuel filler lid opener actuator
 4. Fuel filler lid hook

REMOVAL AND INSTALLATION

Attached sheet 35 <Added>

M1421013000016

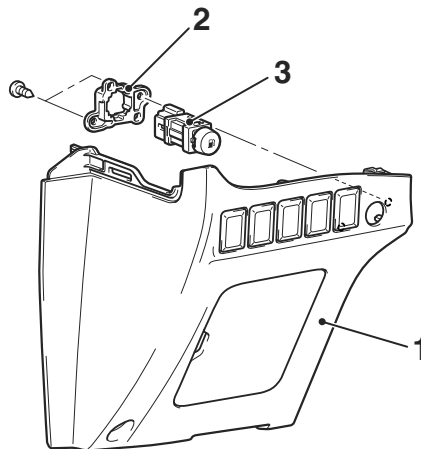

ACG00300AC

- Removal steps**
1. Instrument panel lower LH (Refer to GROUP 52A – Instrument Panel Assembly P.52A-3.)

- Removal steps (Continued)**
2. Instrument panel switch holder
 3. Fuel filler lid opener switch

**BODY
WINDOW GLASS**

42A-35

FUEL FILLER LID INSPECTION

M1421002600092

FUEL FILLER LID OPENER ACTUATOR CHECK

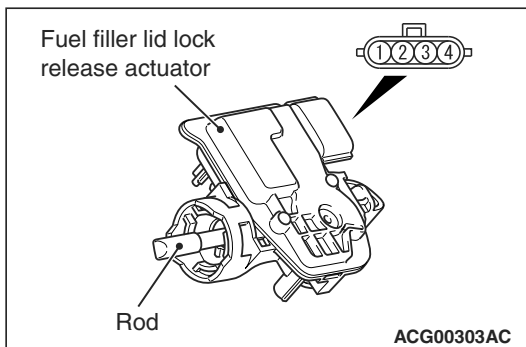

Fuel filler lid opener actuator rod:	Battery connected terminal No.	Normal conditions
Closed (Rod protruded)	1(-) – 2(+)	Open (Rod was pulled in)
	Disconnected	Closed (Rod protruded)

FUEL FILLER LID OPENER SWITCH CHECK

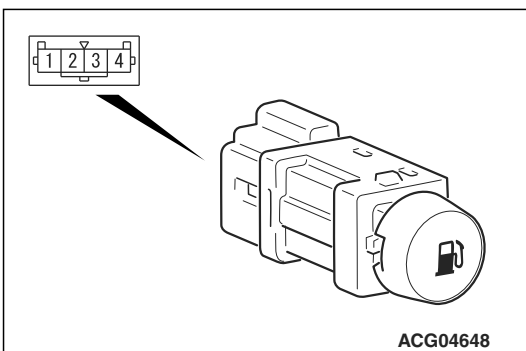

Switch position	Terminal number	Normal value
ON (Press)	1 – 2	Continuity exists (2 Ω or less)
OFF	1 – 2	No continuity

<Added>

⚠ CAUTION

Do not energize the component three seconds or more as it may be damaged.

WINDOW GLASS

ADHESIVE

M1422000500683

Item	Specified adhesive
Windshield glass	3M ATD Part No.8609 Super Fast Urethane Auto Glass Sealant or equivalent
Quarter window glass	
Liftgate window glass	3M ATD Part No.8608 Super Fast Urethane Primer or equivalent

LUBRICANT

M1421000400092

Item	Specified lubricant	Quantity
Degrease agent	Grease and dirt removal from parts surface	3M™ AAD Part No. 8906 or equivalent
		As required

42A-32

BODY FUEL FILLER LID

FUEL FILLER LID

SPECIAL TOOL(S)

<Added> Attached sheet 32

M1421000600740

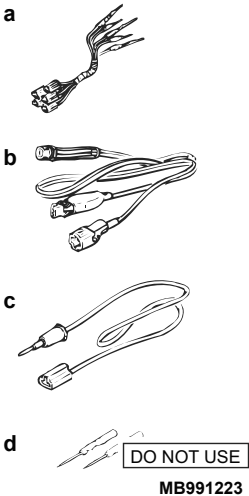
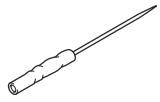
Tool	Tool number and name	Supersession	Application
 <p>a</p> <p>b</p> <p>c</p> <p>d DO NOT USE MB991223</p>	<p>MB991223</p> <p>a. MB991219 b. MB991220 c. MB991221 d. MB991222</p> <p>Harness set</p> <p>a. Test harness b. LED harness c. LED harness adaptor d. Probe</p>	<p>General service tools</p>	<p>Continuity check and voltage measurement at harness wire or connector for loose, corroded or damaged terminals, or terminals pushed back in the connector.</p> <p>a. Connector pin contact pressure inspection b. Power circuit inspection c. Power circuit inspection d. Commercial tester connection</p>
 <p>MB992006</p>	<p>MB992006</p> <p>Extra fine probe</p>	-	<p>Making voltage and resistance measurement during troubleshooting</p>

DIAGNOSIS

<Correct> Refer to Attached sheet 33

TROUBLE SYMPTOM CHART

M1421006000520

Trouble symptom	Inspection procedure number	Reference page
The fuel filler lid will not closed.	1	Refer to GROUP 13A - Troubleshooting P.13A-44.
The fuel filler lid will not open.	2	P.42A-12

<Incorrect>

<Added>



The fuel filler lid locks but "CLOSE FUEL LID AND CAP" is displayed on the warning screen.	1 - 1	Refer to Attached sheet 34
--	-------	----------------------------

NOTE: The engine control module (ECM) also sets a diagnostic trouble code of refueling control-related component. Therefore, if the following warning screens are displayed on the multi-information display of the combination meter, check whether the diagnostic trouble code is set in the ECM. If the diagnostic trouble code is set, carry out troubleshooting for the relevant diagnostic trouble code [Refer to GROUP 13A - MULTIPOINT FUEL INJECTION (MFI) DIAGNOSIS - Diagnostic Trouble Code Chart].

- REFUELING SYSTEM SERVICE REQUIRED
- "CLOSE FUEL LID AND CAP" or "READY TO REFUEL" on the warning screen does not disappear even after the fuel filler lid is closed.

<Added>

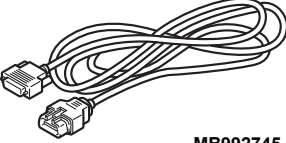
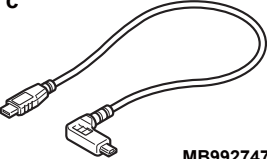
<Added>

<p>a</p>  <p>MB992744</p> <p>b</p>  <p>MB992745</p> <p>c</p>  <p>MB992747</p> <p>d</p>  <p>MB992748 ACH04622AB</p>	<p>a. MB992744 b. MB992745 c. MB992747 d. MB992748</p> <p>M.U.T.-III SE</p> <p>a. Vehicle communication interface-Lite (V.C.I.-Lite) b. V.C.I.-Lite main harness A (for vehicles with CAN communication) c. V.C.I.-Lite USB cable short d. V.C.I.-Lite USB cable long</p>	-	DTC and data list check.
--	---	---	--------------------------

<Added>

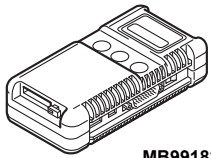
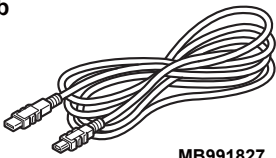
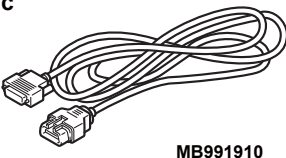
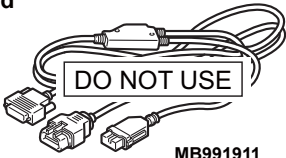
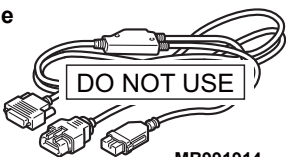
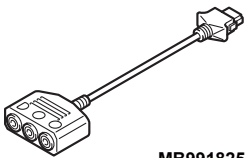
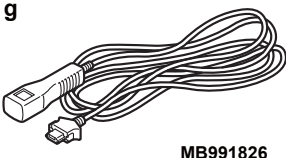
<p>a</p>  <p>MB991824</p> <p>b</p>  <p>MB991827</p> <p>c</p>  <p>MB991910</p> <p>d</p>  <p>MB991911</p> <p>e</p>  <p>MB991914</p> <p>f</p>  <p>MB991825</p> <p>g</p>  <p>MB991826 MB991958</p>	<p>MB991958</p> <ul style="list-style-type: none"> a. MB991824 b. MB991827 c. MB991910 d. MB991911 e. MB991914 f. MB991825 g. MB991826 <p>M.U.T.-III sub-assembly</p> <ul style="list-style-type: none"> a. Vehicle communication interface (V.C.I.) b. M.U.T.-III USB cable c. M.U.T.-III main harness A (Vehicles with CAN communication system) d. M.U.T.-III main harness B (Vehicles without CAN communication system) e. M.U.T.-III main harness C (for Chrysler models only) f. M.U.T.-III measurement adapter g. M.U.T.-III trigger harness 	<p>MB991824-KIT</p> <p>NOTE: G: MB991826 M.U.T.-III Trigger Harness is not necessary when pushing V.C.I. ENTER key.</p>	<p>⚠ CAUTION</p> <p>M.U.T.-III main harness A (MB991910) should be used. M.U.T.-III main harness B and C should not be used for this vehicle.</p> <p>DTC and data list check.</p>
---	---	---	---

<Added>

Inspection Procedure 1: The fuel filler lid will not closed.**COMMENTS ON TROUBLE SYMPTOM**

If the fuel filler lid lock does not work normally, the mechanism of the fuel filler lid opener actuator, fuel filler lid itself or the lock mechanism of the fuel filler lid may be defective.

PROBABLE CAUSES

- Malfunction of the fuel filler lid opener actuator (damage, malfunction)
- Improper installation of the fuel filler lid opener actuator
- Improper installation of the fuel filler lid
- Deformation of the lock part of the fuel filler lid

DIAGNOSIS**STEP 1. Fuel filler lid opener actuator check**

Check the fuel filler lid opener actuator as follows:

1. Check whether the scraped surface of the rod is facing the right direction (the scraped surface is facing front).
2. Check the rod part for damage and deformation.

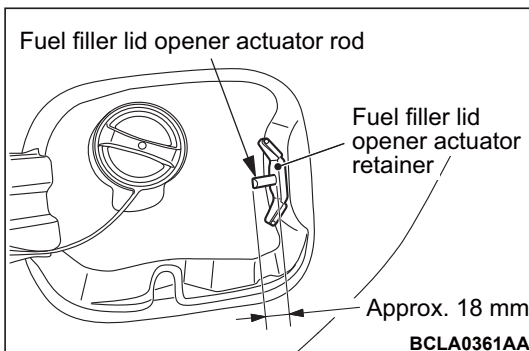
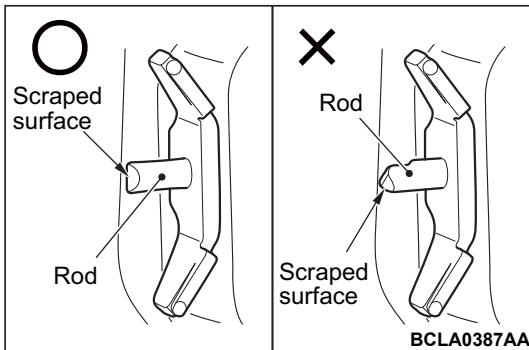

3. Check that the rod part is protruded from the fuel filler lid opener actuator retainer by approximately 18 mm.
4. Press in the rod with a finger, and check that the rod returns to the original position when the finger is released.

Q: Are the check results normal?

YES : Go to Step 2.

NO : Replace the fuel filler lid opener actuator and install it properly.

STEP 2. Check whether the fuel filler lid opener actuator is installed properly.**Q: Is the check result normal?**

YES : Go to Step 3.

NO : Replace the fuel filler lid opener actuator and install it properly.

STEP 3. Check whether the fuel filler lid is installed properly.**Q: Is the check result normal?**

YES : Check the lock part of the fuel filler lid because it may be deformed. Then repair or replace the fuel filler lid if necessary.

NO : Install the fuel filler lid properly.

<Added>

Inspection Procedure 1 - 1: The fuel filler lid locks but "CLOSE FUEL LID AND CAP" is displayed on the warning screen.

COMMENTS ON TROUBLE SYMPTOM

If the engine control module determines that the fuel filler lid has been left open after refueling, "CLOSE FUEL LID AND CAP" will be displayed on the warning screen. "CLOSE FUEL LID AND CAP" will also be displayed when the engine control module recognizes that the fuel filler lid has opened under the conditions below although the fuel filler opener switch has not been pressed.

- When the fuel filler lid is opened by operating the release lever.
- When the fuel filler lid is opened unintentionally due to a defective fuel filler lid-related component.

- When the signal from the fuel filler lid opener actuator switch (the lid position sensor incorporated into the fuel filler lid opener actuator) is always indicating the "Open" status.
- When the auxiliary battery is connected while the fuel filler lid is open.

PROBABLE CAUSES

- Release of the fuel filler lid lock by release lever operation
- The auxiliary battery is connected while the fuel filler lid is open.
- Improper installation of the fuel filler lid
- Malfunction of the fuel filler lid-related system (MFI system)

DIAGNOSIS

STEP 1. Opening/closing of the fuel lid (refueling control)

1. Press the fuel filler opener switch.
2. After "READY TO REFUEL" is displayed, check that the fuel filler lid lock is released.
3. Close the opened fuel filler lid.

Q: Did "CLOSE FUEL LID AND CAP" on the warning screen disappear after the fuel filler lid opened/closed normally?

YES : Check end.

NO : Go to Step 2.

STEP 2. Use the scan tool (M.U.T.-IIISE) to confirm a diagnostic trouble code of other systems.

Check whether a fuel filler lid-related diagnostic trouble code (P04B5, P04B6, P04B9 or P04BF) is set in the engine control module.

Q: Is the DTC set?

YES : Carry out troubleshooting for the relevant diagnostic trouble code [Refer to GROUP 13A - MULTIPORT FUEL INJECTION (MFI) DIAGNOSIS - Diagnostic Trouble Code Chart]. After the troubleshooting is completed, go to Step 4.

NO : Go to Step 3.

<Added>

STEP 3. Use the scan tool (M.U.T.-IIISE) to confirm a data list of other systems.

Check whether the following data list of the MFI system is normal [Refer to GROUP 13A - MULTIPORT FUEL INJECTION (MFI) DIAGNOSIS - Data List Reference Table].

- Item No. 213: Fuel fill door position sensor

Q: Is the check result normal?

YES : Go to Step 4.

NO : Check whether the fuel filler lid opener actuator and the fuel filler lid are installed properly, and check the

deformation. Then, repair or replace the defective parts. Then, check again that the check result of item No. 213: Fuel fill door position sensor is normal, and go to Step 4.

STEP 4. Opening/closing of the fuel lid (refueling control)

1. Press the fuel filler opener switch.
2. After "READY TO REFUEL" is displayed, check that the fuel filler lid lock is released.
3. Close the opened fuel filler lid.

Q: Did "CLOSE FUEL LID AND CAP" on the warning screen disappear after the fuel filler lid opened/closed normally?

YES : Check end.

NO : Use the scan tool (M.U.T.-IIISE) to execute "Forced Refuel control completion" on the MFI system special function menu, and check that "CLOSE FUEL LID AND CAP" on the warning screen has disappeared. If the message does not disappear, replace the engine control module.

<Added>

INSTALLATION SERVICE POINT

>>A<< FUEL FILLER LID OPENER ACTUATOR INSTALLATION

CAUTION

Do not install the fuel filler lid opener actuator by turning it counterclockwise.

Insert the fuel filler lid opener actuator into the fuel filler lid hook which is installed to the vehicle body. Then install the fuel filler lid opener actuator by turning it clockwise.

