



Technical Service Bulletin

SUBJECT:			No: TSB-21-35A-002
UPDATES TO REAR DISC BRAKE ASSEMBLY REMOVAL AND INSTALLATION - SERVICE MANUAL REVISION			DATE: October 2021
			MODEL: See Below
CIRCULATE TO:	<input type="checkbox"/> GENERAL MANAGER	<input checked="" type="checkbox"/> PARTS MANAGER	<input checked="" type="checkbox"/> TECHNICIAN
<input checked="" type="checkbox"/> SERVICE ADVISOR	<input checked="" type="checkbox"/> SERVICE MANAGER	<input checked="" type="checkbox"/> WARRANTY PROCESSOR	<input type="checkbox"/> SALES MANAGER

PURPOSE

This TSB provides updated content for the Basic Brake section of the affected Service Manuals.

AFFECTED VEHICLES

- 2018 Eclipse Cross
- 2019 Eclipse Cross
- 2020 Eclipse Cross
- 2022 Eclipse Cross

AFFECTED SERVICE MANUALS

- 2018, 2019, 2020 and 2022 Eclipse Cross Service Manuals, Group 35A-Basic Brake



Please replace the pages in the 2018 Eclipse Cross Service Manual, Group 35A-Basic Brake section as follows:

- 2018 Eclipse Cross Service Manual, Group 35A - Basic Brake -> Rear Disc Brake Assembly Removal and Installation- Attached sheet 4

Please replace the pages in the 2019 Eclipse Cross Service Manual, Group 35A-Basic Brake section as follows:

- 2019 Eclipse Cross Service Manual, Group 35A - Basic Brake -> Rear Disc Brake Assembly Removal and Installation- Attached sheet 4

Please replace the pages in the 2020 Eclipse Cross Service Manual, Group 35A-Basic Brake section as follows:

- 2020 Eclipse Cross Service Manual, Group 35A - Basic Brake -> Rear Disc Brake Assembly Removal and Installation- Attached sheet 4

Please replace the pages in the 2022 Eclipse Cross Service Manual, Group 35A-Basic Brake section as follows:

- 2022 Eclipse Cross Service Manual, Group 35A - Basic Brake -> Rear Disc Brake Assembly Removal and Installation- Attached sheet 11

35A-42

BASIC BRAKE REAR DISC BRAKE ASSEMBLY

REAR DISC BRAKE ASSEMBLY

REMOVAL AND INSTALLATION

M1351007001759

Pre-removal Operation

- Parking Brake Rear Cable Connection (Rear Brake Caliper Side) Removal (Refer to GROUP 36 – Parking Brake Cable P.36-66) <Vehicles without Electric Parking Brake>.
- Activates the maintenance mode (when rear brake caliper assembly is disassembled and reassembled) (Refer to P.35A-26) <Vehicles with electric parking brake>.
- Brake Fluid Draining

Post-installation Operation

- Brake Fluid Supplying and Air Bleeding (Refer to P.35A-16).
- Parking Brake Rear Cable Connection (rear brake caliper side) Installation (Refer to GROUP 36 – Parking Brake Cable P.36-66) <Vehicles without Electric Parking Brake>.
- Resumes the normal operation mode (when rear brake caliper assembly is disassembled and reassembled) (Refer to P.35A-26) <Vehicles with electric parking brake>.

<Vehicles without electric parking brake>

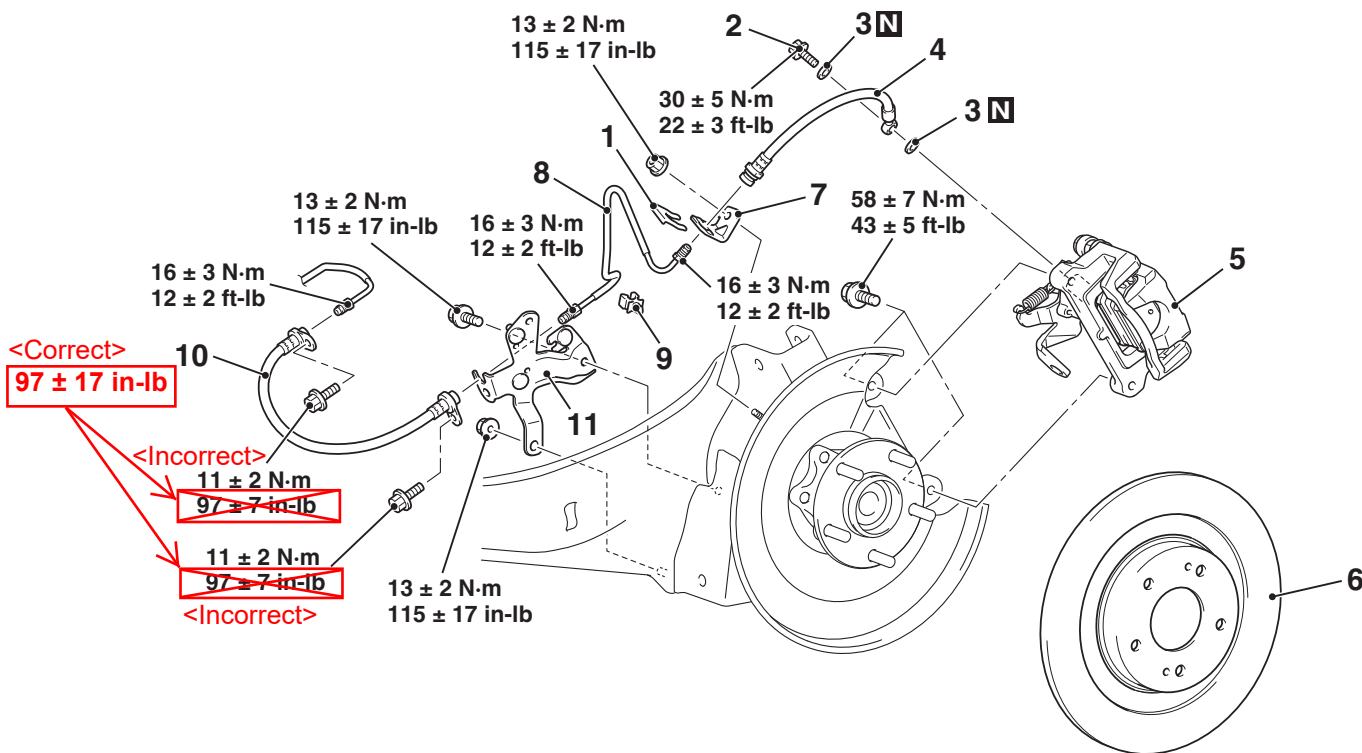

ACH03411AB

Removal steps

1. Hose clip
2. Eye bolt
3. Gasket
- >>A<< 4. Brake hose (rear brake caliper side)
5. Rear brake caliper assembly
 - Brake disc run-out check and correction (only at installation) (Refer to P.35A-22).

Removal steps (Continued)

6. Rear brake disc
7. Bracket A
8. Brake tube (trailing arm side)
9. Clip
10. Brake hose (body floor side)
11. Bracket B

**BASIC BRAKE
REAR DISC BRAKE ASSEMBLY**

35A-45

REAR DISC BRAKE ASSEMBLY

REMOVAL AND INSTALLATION

M13510070A0014

<p>Pre-removal Operation</p> <ul style="list-style-type: none"> • Parking Brake Rear Cable Connection (Rear Brake Caliper Side) Removal (Refer to GROUP 36 - Parking Brake Cable P.36-62) <Vehicles without Electric Parking Brake>. • Activates the maintenance mode (when rear brake caliper assembly is disassembled and reassembled) (Refer to P.35A-27) <Vehicles with Electric Parking Brake>. • Brake Fluid Draining 	<p>Post-installation Operation</p> <ul style="list-style-type: none"> • Brake Fluid Supplying and Air Bleeding (Refer to P.35A-18). • Parking Brake Rear Cable Connection (rear brake caliper side) Installation (Refer to GROUP 36 - Parking Brake Cable P.36-62) <Vehicles without Electric Parking Brake>. • Resumes the normal operation mode (when rear brake caliper assembly is disassembled and reassembled) (Refer to P.35A-27) <Vehicles with Electric Parking Brake>.
---------------------------------------------------------------------------------------------------------------------------------------------------------------------------------------------------------------------------------------------------------------------------------------------------------------------------------------------------------------------------------------------------------------------------------------------------------------------------------	--------------------------------------------------------------------------------------------------------------------------------------------------------------------------------------------------------------------------------------------------------------------------------------------------------------------------------------------------------------------------------------------------------------------------------------------------------------------------------------------------------------------------------------

<Vehicles without electric parking brake>

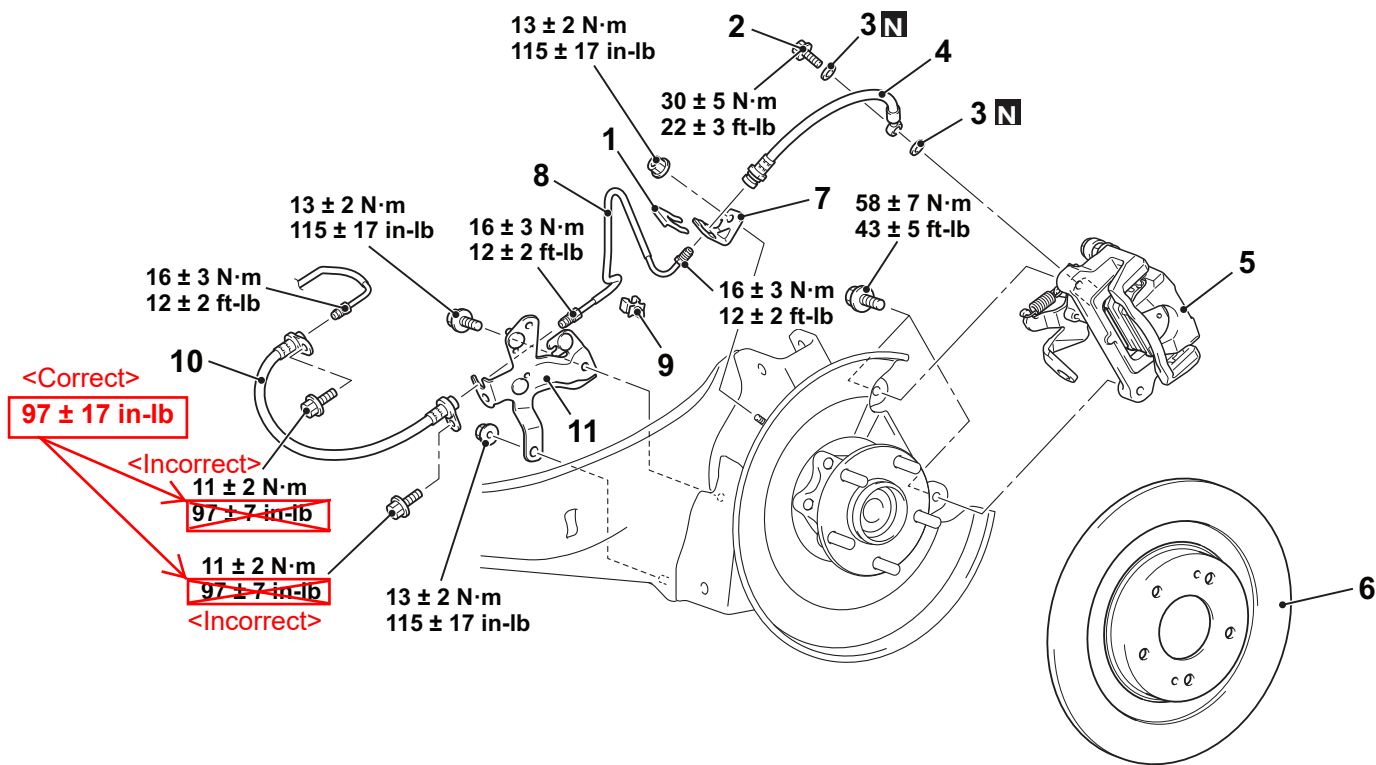

ACH03411AB

- Removal steps**
1. Hose clip
 2. Eye bolt
 3. Gasket
 - >>A<< 4. Brake hose (rear brake caliper side)
 5. Rear brake caliper assembly
 - Brake disc run-out check and correction (only at installation) (Refer to P.35A-24).

- Removal steps**
6. Rear brake disc
 7. Bracket A
 8. Brake tube (trailing arm side)
 9. Clip
 10. Brake hose (body floor side)
 11. Bracket B