

Technical product information

Topic	DTC P060600 evident within address 51 - Electric drive Control unit
Market area	Russische Föderation (5RU),China 796 VW Import Comp. Ltd (Vico), Beijing (6796),Germany E02 Bentley rest Europe (6E02),Japan E03 Bentley Japan (6E03),United Kingdom E01 Bentley UK (6E01),United States E05 Bentley USA and rest America (6E05)
Brand	Bentley
Transaction No.	2064680/1
Level	EH
Status	Approval
Release date	

Event memory entries

Diagnostic address	Event memory entry	Fault type	Fault status
0051 - Electric drive	P060600: ECM/PCM Processor		Intermittent
0051 - Electric drive	P060600: ECM/PCM Processor		static

New customer code

Object of complaint	Complaint type	Position
information, navigation, communication, entertainment -> driver information system (DIS, MFI, MMI) -> text message display -> text message: system fault in hybrid drive	functionality -> activates	
electrical power, electric system, data transfer -> power supply	electrics	
electrical power, electric system, data transfer -> battery management -> charging high-voltage battery	functionality -> defective function sequence	

Vehicle data

Bentayga

Sales types

Type	MY	Brand	Designation	Engine code	Gearbox code	Final drive code
4V14F9	2019	E		*	*	*
4V14F9	2020	E		*	*	*
4V14F9	2021	E		*	*	*
4V14F9	2022	E		*	*	*

Documents

Document name
master.xml

Customer statement / workshop findings

Customer statement:

High voltage system warning within the DIP

Workshop findings:

Power Electronics DTC P060600 evident within address 51 - Electric drive Control unit (DTC cannot be cleared)

Technical background

DTC P060600 relates to an Active discharge counter error within address 51 (DTC cannot be cleared)

In the event the symptoms are as described, conduct the instructions within the Measure section to completion noting the following:

▪
 IMPORTANT: There are separate SVM codes and MUST be strictly applied as instructed

- 4V051SW01 (MUST BE APPLIED FIRST)
- 4V0EDU01 (MUST BE APPLIED SECOND)

Production change

-

Measure

▪

VERY IMPORTANT: This vehicle uses a High voltage system and MUST only be worked on by suitably qualified personnel.

▪

VERY IMPORTANT: Please ensure all guidelines within the repair manual are strictly followed before and whilst conducting any work on vehicles with a High voltage system

General information for the reprogramming:

- *The closed-circuit voltage of the vehicle must be at least 12.5 V during the reprogramming. Connect the battery of the vehicle to an external power supply. For further information see the Maintenance manual.*
- *During the reprogramming switch off all unnecessary consumers (ventilation, seat heater, inside light).*
- *Because of the highest transmission stability we recommend the use of the diagnosis interface VAS 6154 (WiFi diagnostic tool) only in the USB operation or the cable-connected VAS 5055 for the reprogramming (updating) of control units. If these units are not available, the diagnosis interface VAS 5054 (A) can also be used in USB mode.*

Software update (Application of the first SVM code - 4V051SW01)

1. Select and run Guided fault finding

- Within the Special functions tab - Select SVM Problem related Hardware/Software update then select Perform test (Figure 1).

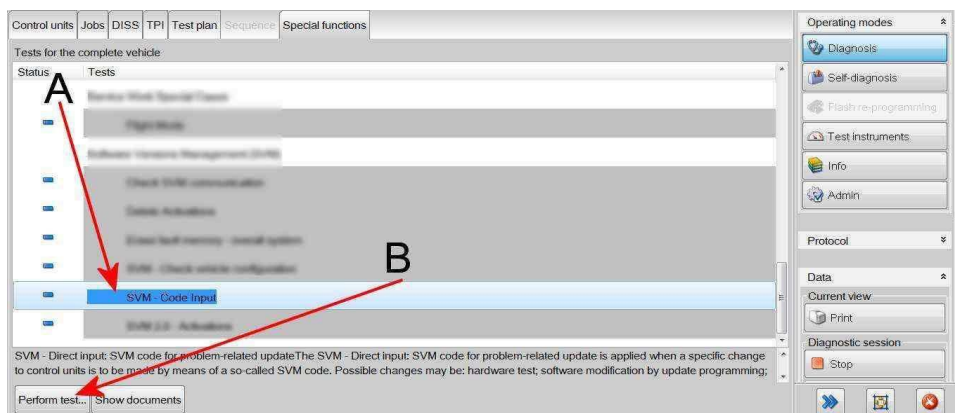

Figure 1

2. On the next screen enter the SVM code 4V051SW01 and select Adopt (Figure 2).

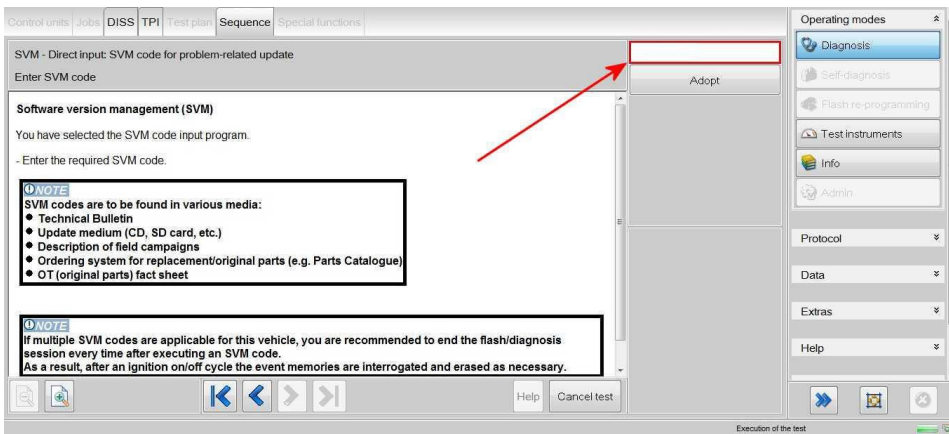

Figure 2

3. On the following screen, confirm the code is correct then select - Yes.

- All control modules will now be interrogated, follow all on screen prompts.
- The update will then begin

4. Follow all remaining on screen prompts until completion

After the programming is complete, a bus silence is required (20 minutes), carry out the following steps in the order stated below:

- Switch off the ignition
- Remove the diagnostic interface from the OBD port
- Switch off and remove the battery charger from the vehicle
- Close the bonnet and all doors, then lock the vehicle
- Wait 20 minutes to allow the vehicle to go into bus silence
- When 20 minutes has elapsed, unlock the vehicle and open the driver's door
- Switch on the ignition
- Confirm that gear selection is possible

[Software update \(Application of the second SVM code - 4V0EDU01\)](#)

5. Select and run Guided fault finding

- Within the Special functions tab select SVM Problem related Hardware/Software update then select Perform test (Refer back to Figure 1)

6. On the next screen enter the SVM code **4V0EDU01** and select *Adopt* (Refer back to Figure 2)

7. On the following screen, confirm the code is correct then select - Yes.

- All control modules will now be interrogated, follow all on screen prompts.
- The update will then begin
- Follow all remaining on screen prompts until completion

8. Conduct a full ignition cycle (Off/On)

9. Erase all DTC's

NOTE: Carry out a second bus silence in the order stated below:

After the programming is complete, a second bus silence is required (20 minutes), carry out the following steps in the order stated below:

- Switch off the ignition
- Remove the diagnostic interface from the OBD port
- Switch off and remove the battery charger from the vehicle
- Close the bonnet and all doors, then lock the vehicle

VERY IMPORTANT: The 20 minute wait requirement in the next part of the process MUST be strictly adhered to, if the vehicle

does not successfully enter into a bus silence condition, this may prevent the next part of the SVM process from completing successfully

- Wait 20 minutes to allow the vehicle to go into bus silence
- When 20 minutes has elapsed, unlock the vehicle and open the driver's door
- Switch on the ignition
- Confirm that gear selection is possible

11. Check/confirm no DTC's are evident including DTC P060600

Warranty accounting instructions

Warrantytype 110 or 910

Damage service number 93 50

Damage code 00 41

Labour

Labour operation code 01510000

Time As per the ODIS log (Must not exceed 80 time units for both SVM updates)