

Symptom in PSCB Disc Brakes - Noises from Around the Front Axle (SY 146/21)

Model Line: **Taycan (Y1A/Y1B)**

Model Year: **As of 2020**

Equipment: **Porsche Surface Coated Brake (PSCB), M-no. 1LZ/1ZP)**

Concerns: **Front disc brakes, PSCB**

Symptom: The customer complains about a scraping noise from the front axle area, primarily at low speeds and when the brake is not actuated.

Cause: A slight deviation from the tolerance of the wear pattern and/or slight lateral contact of the PSCB disc brakes result in sound transmission via the steering column into the passenger compartment.

Remedial Action: To dampen the sound transmission, retrofit a balance weight on the cross joint of the steering column. Also check brake discs on the front axle for deviations from tolerances, lateral wear and hotspots and replace them if necessary.

Required parts and materials

Parts Info:	Part No.	Designation	Qty.
		- Use	
	9J1419647B	⇒ Balance weight (halfshaft) - Halfshaft	1 ea.
	9J1419647C	⇒ Balance weight (halfshaft) - Halfshaft	1 ea.
	PAF104882	⇒ Internal hexagon round oval-head screw, M5 x 20 - Balance weights	2 ea.
	N90799102	⇒ Countersunk screw with internal serration, self-locking, M18 x 1.5 x 18 - Steering wheel	1 ea.
	WHT004955A	⇒ Internal hexagon round cheese head bolt, M8 x 30 - Steering column	2 ea.
		Additional parts required only in certain cases	
	971907637	⇒ Brake pad sender wire (brake pad wear indicator) - Brake calliper on front axle	2 ea.

PAF004572	⇒ Collared cheese head bolt with hexagon socket head for fixed calliper, M14 x 1.5 x 135 – Brake calliper on front axle	4 ea.
From model year 2021:		
9Y0615301AA	⇒ Brake disc – Front axle, left	1 ea.
9Y0615302AA	⇒ Brake disc – Front axle, right	1 ea.
971698231A	⇒ 1 set of springs - repair kit – Brake calliper on front axle	2 ea.
9Y0698151AE	⇒ 1 set of brake pads for disc brakes – Brake calliper on front axle	1 ea.
Up to model year 2021:		
9J1615301B	⇒ Brake disc – Front axle, left	1 ea.
9J1615302B	⇒ Brake disc – Front axle, right	1 ea.
9A769826900	⇒ Retainer spring for repair kit – Brake calliper on front axle	2 ea.
9J1698151H	⇒ 1 set of brake pads for disc brakes – Brake calliper on front axle	1 ea.
or		
9J1698151K	⇒ 1 set of brake pads for disc brakes – Brake calliper on front axle	1 ea.

Materials: **Required materials** (usually already available at the Porsche dealer):

Part No.	Designation	Qty.
00004330508	⇒ Mounting paste (100 gram/ 3.52 oz tube)	4 grams/ 0.14 oz

Preparatory work

- Work Procedure: 1 Remove both front wheels. ⇒ *Workshop Manual '440519 Removing and installing wheel'*
- 2 Check wear pattern and lateral check of PSCB brake discs. ⇒ *Workshop Manual '465202 Checking front PSCB brake discs'*

Checking brake discs and brake pads and replacing brake discs and pads if necessary

Work Procedure: 1 Check wear pattern and lateral check of PSCB brake discs. ⇒ *Workshop Manual '465202 Checking front PSCB brake discs'*

- If the brake discs have no defects after being checked in accordance with the Workshop Manual, only the balance weight must be installed.
- If the brake discs have defects as per the check in accordance with the Workshop Manual, the brake discs and brake pads must be replaced and the balance weight must also be retrofitted.



Information

If hotspots are visible, replacing the brake discs and brake pads cannot be billed using the new vehicle warranty.
⇒ *Brake disc hotspots*

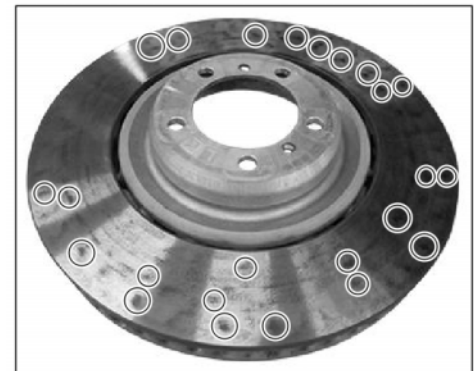

Brake disc hotspots

Retrofitting balance weight



Information

When installing the balance weights, the wheels must be in the straight-ahead position.

Work Procedure: 1 Disconnect the steering column from the cross joint as described. ⇒ *Workshop Manual '481519 Removing and installing steering column'*



Information

When screwing on the balance weights, first screw in both screws and then tighten them to prevent the half shells from tilting.

- 2 Install balance weights on the steering wheel side ⇒ *Fitting balance weight -1-* at the cross joint and tighten screws.

Tightening torque 6 Nm (4.5ftlb.)

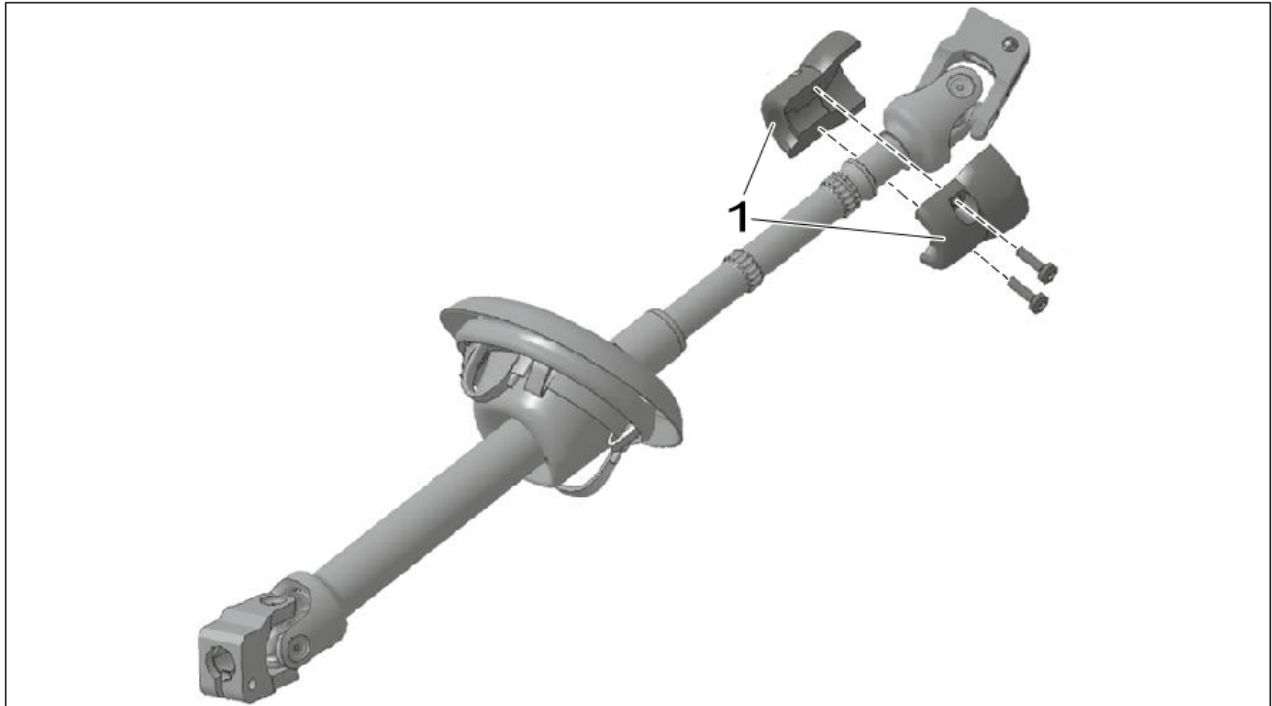

Fitting balance weight

Concluding work

- Work Procedure: 1 Install steering column. ⇒ *Workshop Manual '481519 Removing and installing steering column'*
- 2 Install both front wheels. ⇒ *Workshop Manual '440519 Removing and installing wheel'*

Invoicing



Information

- If the PSCB disc brakes have **hotspots**, the brake disc and brake pad replacement **cannot** be billed using the new vehicle warranty.
- If the PSCB disc brakes have **deviations from tolerance limits and/or lateral wear**, the brake disc and brake pad replacement can be billed using the new vehicle warranty.
- Retrofitting the balance weight can be billed using the new vehicle warranty.

Invoicing: For documentation and invoicing in the event of a warranty claim, specify the required labor operations and the specified PQIS coding in the warranty claim, depending on the required scope of work.

APOS	Labor operation	I No.
46525002	Reworking front PSCB brake discs and installing balance weight	
46525000	Reworking front PSCB brake discs, replacing them and installing balance weight	

PQIS coding:

Location (FES5)	46520	Front PSCB brake disc
Damage type (SA4)	1316	Rubs

References: ⇒ *Workshop Manual '440519 Removing and installing wheel'*
 ⇒ *Workshop Manual '465202 Checking front PSCB brake discs'*
 ⇒ *Workshop Manual '463456 Replacing front PCCB brake pads'*
 ⇒ *Workshop Manual '465119 Removing and installing front PCCB brake disc'*
 ⇒ *Workshop Manual '481519 Removing and installing steering column'*

Important Notice: Technical Bulletins issued by Porsche Cars North America, Inc. are intended only for use by professional automotive technicians who have attended Porsche service training courses. They are written to inform those technicians of conditions that may occur on some Porsche vehicles, or to provide information that could assist in the proper servicing of a vehicle. Porsche special tools may be necessary in order to perform certain operations identified in these bulletins. Use of tools and procedures other than those Porsche recommends in these bulletins may be detrimental to the safe operation of your vehicle, and may endanger the people working on it. Properly trained Porsche technicians have the equipment, tools, safety instructions, and know-how to do the job properly and safely. Part numbers listed in these bulletins are for reference only. The work procedures updated electronically in the Porsche PIWIS diagnostic and testing device take precedence and, in the event of a discrepancy, the work procedures in the PIWIS Tester are the ones that must be followed.

© 2021 Porsche Cars North America, Inc.