

**Sports Tailpipe - Silver (OP3)/Black (OP6)**

Revision: This bulletin replaces bulletin Group 2 15/17, dated September 11, 2017.

Model Year: **As of 2017 up to 2020**

Vehicle Type: **Panamera/Panamera 4/Panamera 4 E-Hybrid**  
including related **Executive** and **Sport Turismo** variants

Information: **Retrofitting**



Information



Figure 1

Notes: The tailpipes for the standard exhaust system on the vehicles specified above can be replaced by new sports tailpipes in Silver chrome-plated look (OP3) or Black chrome-plated look (OP6) (⇒ Figure 1).

The sports tailpipes can be retrofitted worldwide.

The sports tailpipes are also available straight from the factory for new vehicles by requesting the relevant optional equipment.

Parts Info: Sets **ONLY** for Panamera/Panamera 4 **WITHOUT** petrol particulate filter (-OPF):  
**971.044.205.A** ⇒ Sports tailpipe -silver chrome-plated-, set  
**971.044.205.B** ⇒ Sports tailpipe -black chrome-plated-, set

Parts List:

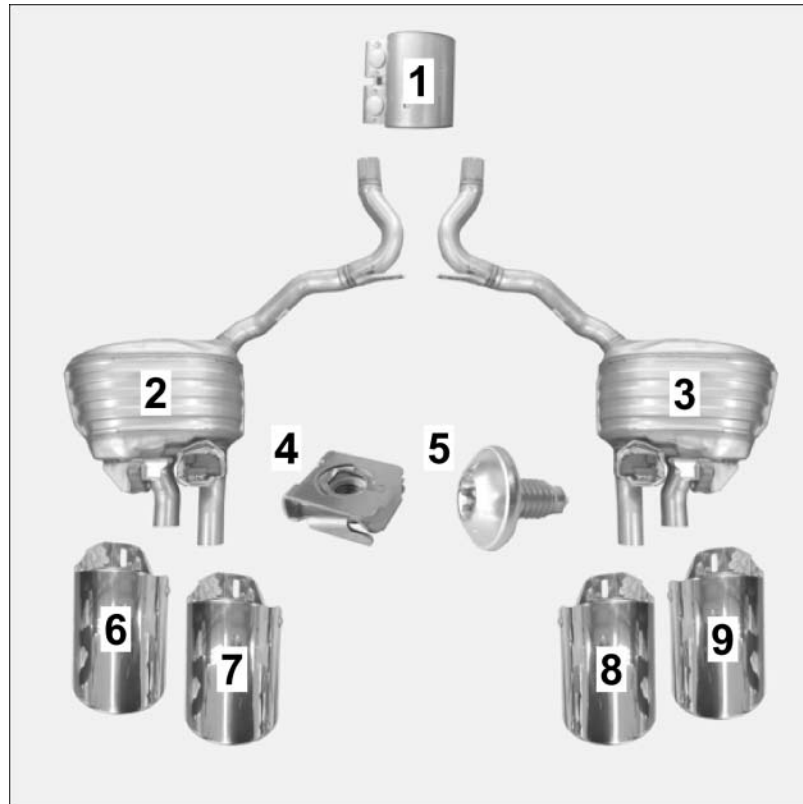

Figure 2

958.111.220.00 <sup>1</sup>	2 x	Clamping sleeve, Ø 60 x 88 ⇒ Figure 2-1-
971.253.607.JY <sup>1</sup>	1 x	Rear silencer, left ⇒ Figure 2-2-
971.253.608.JY <sup>1</sup>	1 x	Rear silencer, right ⇒ Figure 2-3-
958.111.220.10	2 x	Clamping sleeve, Ø 65 x 88 (not shown)
971.253.607.AY	1 x	Rear silencer, left (not shown)
971.253.608.AY	1 x	Rear silencer, right (not shown)
N.903.425.02	4 x	Speed nut, M6 x 19.5 x 18 – VW602 49 ⇒ Figure 2-4-
9A7.253.824.40	4 x	Countersunk screw, M6 x 12 PA ⇒ Figure 2-5-
9A7.253.823.30 <sup>2</sup>	1 x	Sports tailpipe, silver chrome-plated, outer left ⇒ Figure 2-6-
9A7.253.823.35 <sup>2</sup>	1 x	Sports tailpipe, silver chrome-plated, inner left ⇒ Figure 2-7-
9A7.253.824.35 <sup>2</sup>	1 x	Sports tailpipe, silver chrome-plated, inner right ⇒ Figure 2-8-
9A7.253.824.30 <sup>2</sup>	1 x	Sports tailpipe, silver chrome-plated, outer right ⇒ Figure 2-9-
9A7.253.823.40 <sup>2</sup>	1 x	Sports tailpipe, black chrome-plated, outer left (not shown)
9A7.253.823.45 <sup>2</sup>	1 x	Sports tailpipe, black chrome-plated, inner left (not shown)

9A7.253.824.45 <sup>2</sup>	1 x	Sports tailpipe, black chrome-plated, inner right (not shown)
9A7.253.824.40 <sup>2</sup>	1 x	Sports tailpipe, black chrome-plated, outer right (not shown)

1 **ONLY** contained in set for Panamera/Panamera 4 without PPF!

2 **ONLY** contained in respective set!



### Information

**ONLY** in the event of repairs/replacement:

Items **WITHOUT** a part number in the parts list can be found/ordered from the Porsche Electronic Parts Catalog = PET.

Check model year and vehicle equipment (I-no.) in the standard catalog!

Tools:	<b>Nr. 90 Pos. 1 - Torque wrench</b>	Hand lamp
	<b>Nr. 166 - Chain-type pipe cutters</b>	<b>Nr. 166-1 - Ratchet-type pipe cutters</b>
	<b>VAS 6780 Body saw</b>	<b>VAS 6931 Engine and gearbox jack</b>

Installing:	1 Preparatory work
	1.1 Drive the vehicle onto a lifting platform and connect the battery charger. ⇒ <i>Workshop Manual '2X00IN Battery trickle charging'</i>
	1.2 Raise the vehicle. ⇒ <i>Workshop Manual '4X00IN Lifting the vehicle'</i>



### Hot components

- Risk of burns
- ⇒ Let hot components cool down.
- ⇒ Wear personal protective gear.

- 1.3 Remove standard tailpipes (⇒ *Figure 5 (Panamera Turbo)*). ⇒ *Workshop Manual '263519 Removing and installing tailpipe cover'*

- 1 – Standard tailpipes – right-hand side  
 2 – Lens-head screw, M6 x 12  
 3 – Speed nut, M6 x 19.5 x 18 – VW602 49

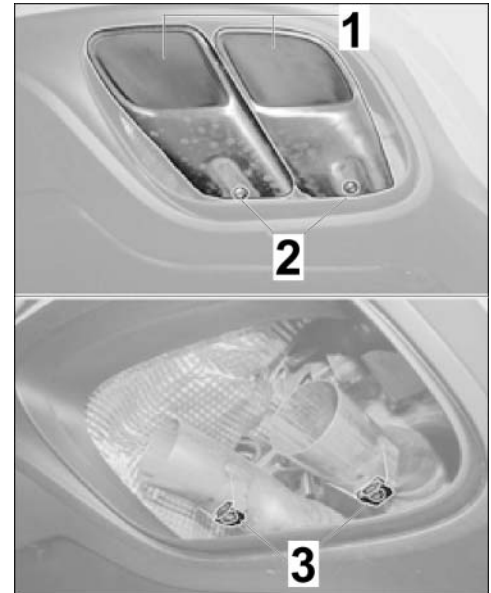

Figure 5 (Panamera Turbo)

- 1.4 Remove rear silencer. ⇒ *Workshop Manual '263319 Removing and installing rear silencer'*

- 1.4.1 Remove rear underbody cover.  
 ⇒ *Workshop Manual '519419 Removing and installing cover for rear underbody'*

- 1.4.2 Remove hexagon-head bolt (M8 x 16, 2 x) on strut between the rear silencers (⇒ *Figure 6-1-*) and remove strut.

- 1 – Installation position of strut  
 2 – Disconnection point  
 3 – **Body saw**  
 4 – Multiple-tooth countersunk screw, M8 x 20 (rear-end cross strut)

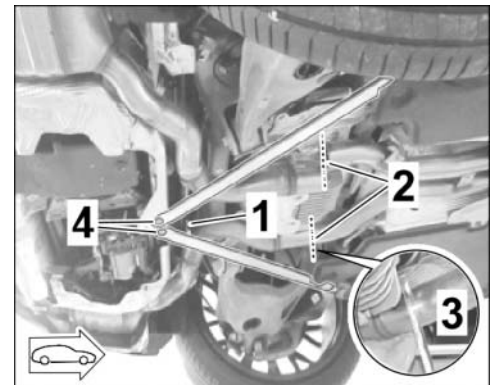

Figure 6

- 1.4.3 Cut rear silencer at the connection point (marking on underside) using pipe cutters or **body saw**.

- 1.4.4 Release and disconnect plug connection for exhaust flap actuator (rear silencer at the left/right).

- 1.4.5 Remove hexagon-head bolts (M8 x 20, 2 x) on rear-end cross strut (⇒ *Figure 6-4-*). ⇒ *Workshop Manual '421319 Removing and installing rear-axle chassis subframe struts'*



#### Information

- Before the rear muffler is released, the exhaust system must be supported with a transmission jack or held by another person.

- 1.4.6 Remove hexagon-head bolt (M8 x 16) on rear silencer holder at the rear (left/right).

1.4.7 Remove rear silencers (at the left/right).

1.4.8 De-burr cut on inside and outside of front silencer (⇒ *Figure 7 -arrows-*).

If necessary, remove rust from front silencer exhaust pipe using suitable polishing agents and restore its round shape.

2 Install new rear silencers (left/right). ⇒ *Workshop Manual '263319 Removing and installing rear silencer'*

2.1 Install clamping sleeve with diameter of 60 x 88 (2 x) and clamping sleeve with diameter of 65 x 88 (2 x) on front silencer exhaust pipe (left/right).

2.2 Install new speed nut (M6 x 19.5 x 18 – VW602 49, 2 x) on holders on exhaust pipes of new rear silencers (left/right ⇒ *Figure 8*).

- 1 – Speed nut, M6 x 19.5 x 18 – VW602 49
- 2 – Holder on rear silencer exhaust pipes (right)

2.3 Lift new rear silencers (left/right) into installation position and secure to the body using a hexagon-head bolt (M8 x 16, 1 x).

**Tightening torque 23 Nm (17 ftlb.)**

2.4 Connect plug connection for exhaust flap actuator (rear silencer at the left/right).

2.5 Align clamping sleeve (Ø 60 x 88 and Ø 65 x 88, 2 x) on exhaust pipe on front silencer/rear silencer (at the left/right) so that the clamping sleeve is not touching/rubbing at any point (⇒ *Figure 9*).

- 1 – Clamping sleeve
- 2 – Hexagon nut M8

Tighten M8 hexagon nut (2 x).

**Tightening torque 33 Nm (24 ftlb.)**

2.6 Tighten multiple-tooth countersunk screws (M8 x 20, 2 x) on rear-end cross strut. ⇒ *Workshop Manual '421319 Removing and installing rear-axle chassis subframe struts'*



Figure 7

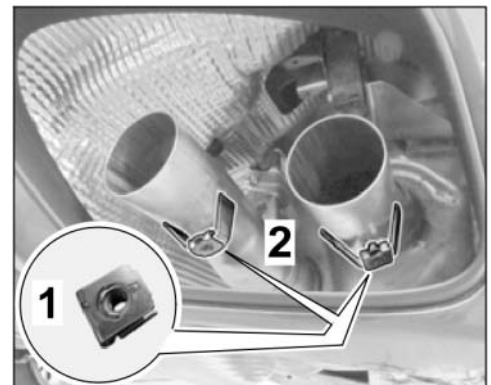

Figure 8

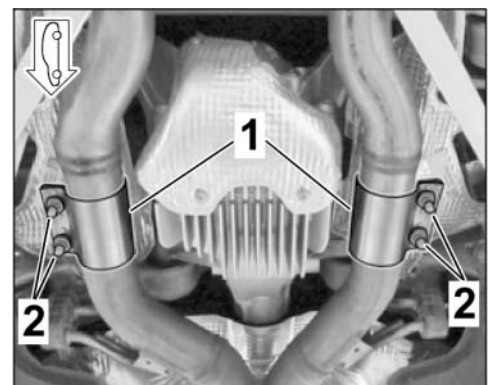

Figure 9

**Tightening torque 20 Nm (15 ftlb.)**

- 2.7 Loosely pre-install strut between the rear silencers using hexagon-head bolts (M8 x 16, 2 x).

## 3 Installing sports tailpipe

- 3.1 Slide the new sports tailpipes onto the relevant rear silencer stub pipes as far as the screw point and preassemble by installing a new M6 x 12 lens-head screw **hand-tight**.

**Information**

If the sports tailpipes have to be moved to the right or left, this can only be performed via the connecting strut between the rear mufflers (see also: ⇒ *Workshop Manual '263319 Removing and installing rear muffler'*).

- 3.2 Check that the gap = "dimension Z" between the new sports tailpipes and exhaust system cover (rear apron – left and right side of vehicle ⇒ *Figure 10-Z-*) is symmetrically constant.

**dimension Z** – symmetrically constant  
all the way around with respect to  
exhaust system cover

**dimension X** – equal projection (right side of  
vehicle)

Re-align sports tailpipes if necessary.

**Information**

The tailpipes are adjusted in X direction using the slots in the tailpipe.

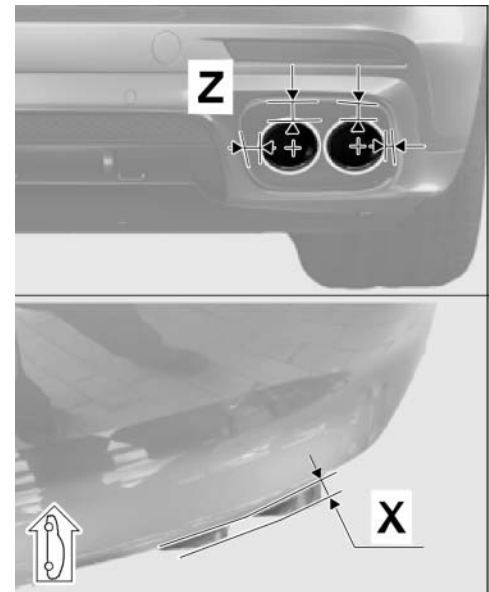

Figure 10

- 3.3 Check that the sports tailpipes project equally = "dimension X" with respect to the rear apron (left and right side of vehicle ⇒ *Figure 10-X-*). Re-align sports tailpipes if necessary.

- 3.4 Tighten lens-head screw (M6 x 12) on the sports tailpipe.  
**Tightening torque 8 Nm (6 ftlb.) +/- 1 Nm (+/- 0.5 ftlb.)**

## 4 Concluding work

- 4.1 Tighten hexagon-head bolt (M8 x 16, 2 x) on strut between the rear silencers.

**Tightening torque 23 Nm (17 ftlb.)**

- 4.2 Install rear underbody cover. ⇒ *Workshop Manual '519419 Removing and installing cover for rear underbody'*

- 4.3 Disconnect the battery charger. ⇒ *Workshop Manual '2X00IN Battery trickle charging'*
- 4.4 Lower the lifting platform and remove the vehicle.

26 35 20 05: –Tailpipes (4 ea.) removed and installed–

Labor time: **161 TU**

- Includes:
- Removing standard tailpipe (4 ea.) and installing new sports tailpipe (4 ea.).
  - Removing standard rear silencer (2 ea.) and installing new rear silencer (2 ea.).
  - Aligning new sports tailpipe (4 ea.) with respect to the rear apron.

**Important Notice:** Technical Bulletins issued by Porsche Cars North America, Inc. are intended only for use by professional automotive technicians who have attended Porsche service training courses. They are written to inform those technicians of conditions that may occur on some Porsche vehicles, or to provide information that could assist in the proper servicing of a vehicle. Porsche special tools may be necessary in order to perform certain operations identified in these bulletins. Use of tools and procedures other than those Porsche recommends in these bulletins may be detrimental to the safe operation of your vehicle, and may endanger the people working on it. Properly trained Porsche technicians have the equipment, tools, safety instructions, and know-how to do the job properly and safely. Part numbers listed in these bulletins are for reference only. The work procedures updated electronically in the Porsche PIWIS diagnostic and testing device take precedence and, in the event of a discrepancy, the work procedures in the PIWIS Tester are the ones that must be followed.

© 2021 Porsche Cars North America, Inc.