

Porsche

Special Tools & Equipment

P90028 Holding Bridge

Technical Support

2128 USA Only

Porsche Special Tools & Equipment will release tool #P90028 as an auto-ship starting CW43/21, Monday, October 25, 2021. If you have any questions about the holding bridge, please feel free to contact Porsche Special Tools & Equipment at askthetoolguy@porsche.us

Model line

Model



718 Boxster (982)



718 Cayman (982)



911 (992)

Porsche

Special Tools & Equipment

P90028 Holding Bridge

Technical Support

2128

USA Only

New Products

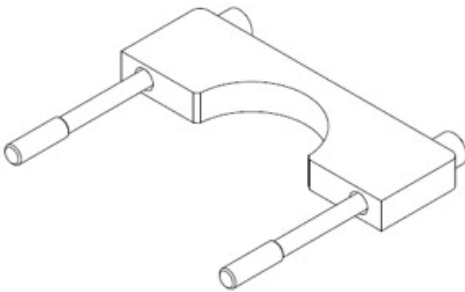

Holding Bridge

P90028 | ★★★ | \$ 109.70

Model lines 911 (992) GT3 from MY 2022, 982 (Boxster Spyder, Cayman GT, Boxster GTS 4.0, Cayman GTS 4.0, Boxster 25th Anniversary Model) from MY 2020-2021

Use Used for holding crankshaft

Workshop Manual WM131020

Order Number V04 014 028 TT

Supplier Porsche Special Tools & Equipment (PPL)

Availability Immediate Availability

Note

Porsche

Special Tools & Equipment

P90028 Holding Bridge

Technical Support

2128

USA Only



General Information

Ordering process

* For ordering tools identified with a prefix of T, VW, VAS, VAG or a four digit tool number (Ex. 3438) please login to porsche.snapon.com for ordering

* For ordering tools with a prefix of 000 721, PNA or 918 721 please login to POLARIS (PPL) to order tools

Workshop Equipment Classification

- ★ Servicing and maintenance
- ★★ Replacement of units and assemblies
- ★★★ Disassembly of units and assemblies
- ★★★★ Tool hire
-  Body & Paint
-  High-voltage

Contact person

E-mail: askthetoolguy@porsche.us

All After Sales Circulars can also be found at:

PPN Aftersales Workshop Special Tools & Equipment

All prices are subject to change without notice