

**October 21, 2021**

Version 3

## 2018-20 Accord: Rear Tray Rattles

Supersedes 19-044, dated October 1, 2021, to revise the information highlighted in **yellow**.

### AFFECTED VEHICLES

Year	Model	Trim	VIN Range
2018-20	ALL	ALL	ALL

### REVISION SUMMARY

- Under AFFECTED VEHICLES, the table was updated.
- Under CORRECTIVE ACTION, the information was updated.
- Under REPAIR PROCEDURE, steps 7 and 8 were revised.

### SYMPTOM

The rear tray rattles when the audio unit bass is turned up.

### POSSIBLE CAUSES

The rear tray may be warped in the back corners.

### CORRECTIVE ACTION

Apply a **5 mm X 100 mm** piece of EPT foam to each back corner and **5 mm X 50 mm** to the middle of the rear tray.

### REQUIRED MATERIALS

Part Name	Part Number	Quantity
EPT Foam (One roll repairs 30 vehicles.)	06990-SA5-000	1

### PARTS INFORMATION

Part Name	Part Number	Quantity
C-Pillar Clip	91561-TVA-A01	2

**CUSTOMER INFORMATION:** The information in this bulletin is intended for use only by skilled technicians who have the proper tools, equipment, and training to correctly and safely maintain your vehicle. These procedures should not be attempted by "do-it-yourselfers," and you should not assume this bulletin applies to your vehicle, or that your vehicle has the condition described. To determine whether this information applies, contact an authorized Honda automobile dealer.

## WARRANTY CLAIM INFORMATION

The normal warranty applies.

Operation Number	Description	Flat Rate Time	Defect Code	Symptom Code	Template ID	Failed Part Number
848001	Remove the rear tray, and apply EPT foam to the back corners.	1.0 hr	00401	03217	A19044A	84502-TVA-A36ZA

Skill Level: Repair Technician

## DIAGNOSIS

Turn the audio unit up to a volume level of 23 and the bass all the way up.

- If a rattle is heard around the rear tray area, go to REPAIR PROCEDURE.
- If no rattle is heard around the rear tray area, continue with normal system troubleshooting.

## REPAIR PROCEDURE

NOTE: SRS components are located in this area. Review the SRS component locations and the precautions and procedures before doing repairs or service. Refer to the service information.

1. Remove the C-pillar lower trim.

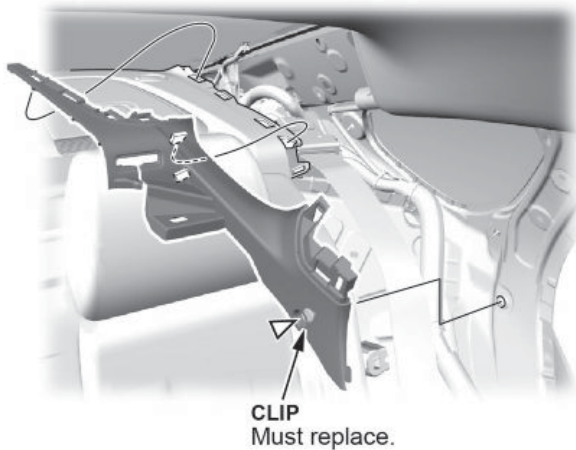

2. Fold down the rear seat-back(s).

3. From the trunk lid opening, disconnect the high-mount brake light connector.

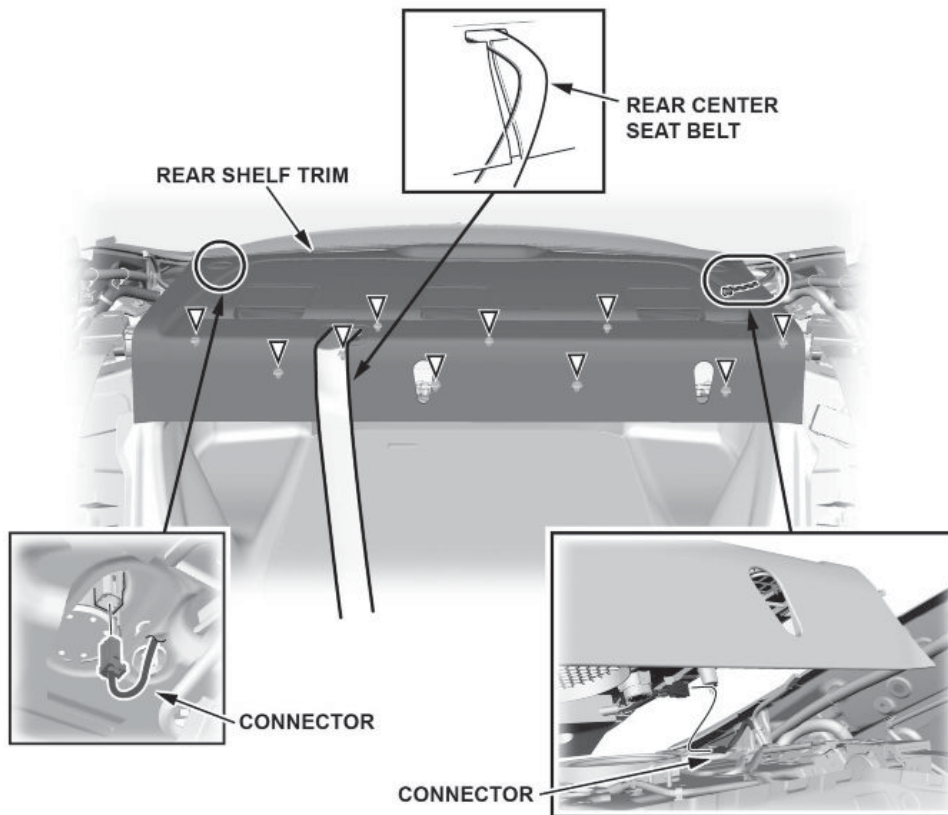

4. Detach the clips.
5. Lift up the rear shelf trim, then disconnect the connector.
6. Pull out the rear center seat belt through the slit in the rear shelf trim, then remove the rear shelf trim.

7. Cut two pieces of EPT foam 5 mm X 100 mm and 5 mm X 50 mm as shown below.

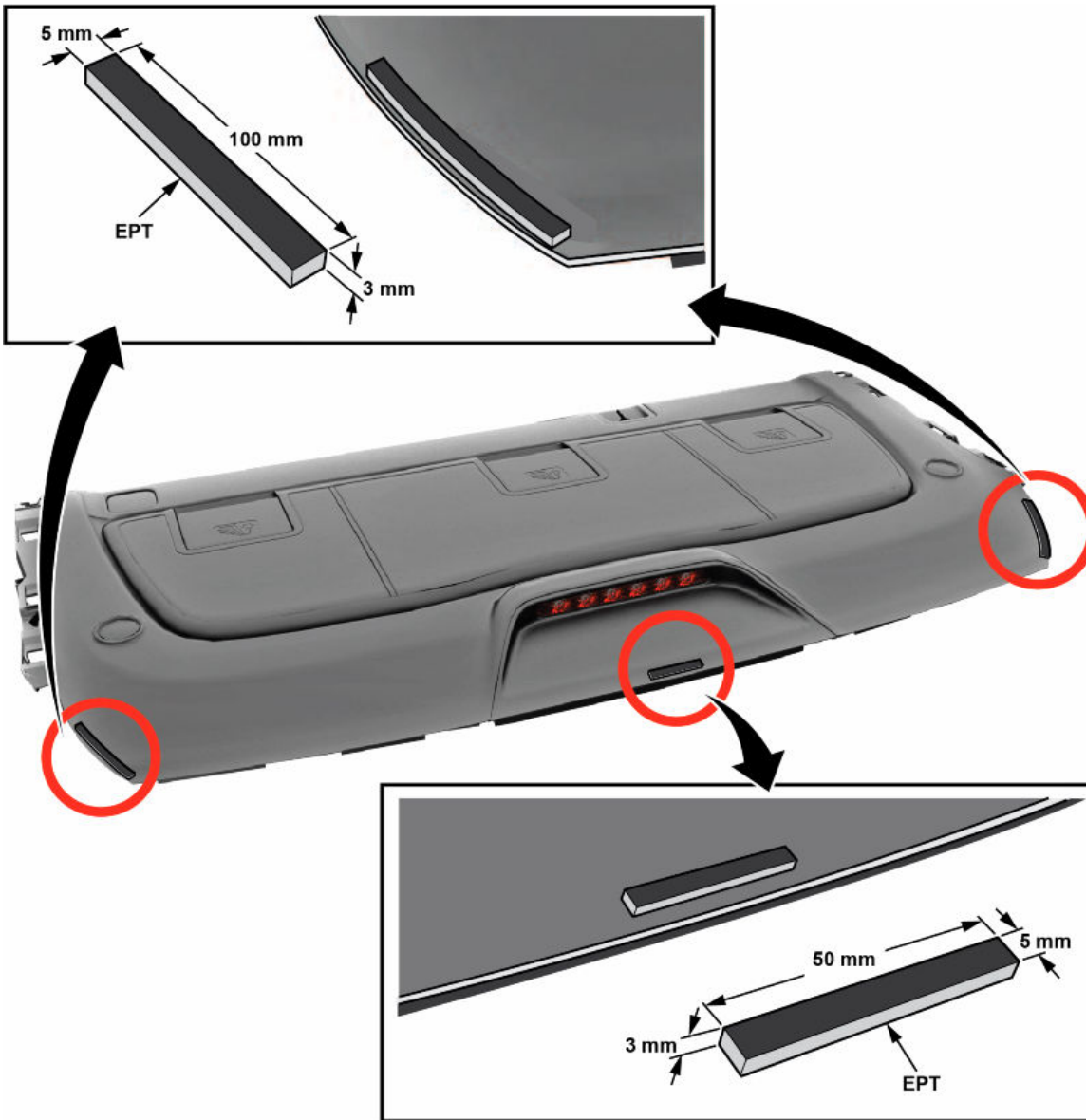

8. Clean the surface of the rear shelf where the EPT foam will be attached. Then, attach the EPT foam as shown.

NOTE: Make sure to center the EPT foam when applying to the tray.

9. Install all removed parts in the reverse order of removal.  
10. Make sure the noise is gone.

END