

# 2022 IS 300, IS 350, IS 500 Pre-Delivery Service (PDS)

**Service Category** General

**Section** Pre-Delivery Service

**Market** USA

Toyota Supports  
ASE Certification 

## Applicability

YEAR(S)	MODEL(S)	ADDITIONAL INFORMATION
2022	IS300, IS350, IS500	

## Introduction

This bulletin contains the vehicle specific pre-delivery services for 2022 model year IS 300, IS 350, and IS 500 vehicles. Additionally, refer to the applicable Pre-Delivery Service (PDS) Check Sheet for services to be performed.

## Warranty Information

OP CODE	DESCRIPTION	TIME	OFF	T1	T2
N/A	Not Applicable to Warranty	–	–	–	–

## Procedures

- [D/C Cut Fuse Installation](#) ..... 2
- [Deletion of Vehicle Alert History](#) ..... 3
- [Parking Assist Monitor Initialization\\*](#) ..... 4
- [Steering Sensor Zero Point Calibration\\*](#) ..... 4
- [Front Emergency Towing Eyelet Removal and Hole Cover Installation](#) ..... 5
- [Front Wheel Opening Extension Pad Installation](#) ..... 6
- [Front License Plate and Mounting Bracket Installation\\*](#) ..... 7
- [Installation of Rubber Body Plugs](#) ..... 9
- [Tire Pressure Warning System \(TPWS\) Initialization](#) ..... 10

\*If applicable.

## 2022 IS 300, IS 350, IS 500 Pre-Delivery Service (PDS)

### D/C Cut Fuse Installation

To minimize battery discharge during transportation and storage, the D/C cut fuse (30A) has been removed at the assembly plant and temporarily stored in the blank space of the relay block in the engine compartment. During PDS, reinstall the D/C cut fuse (30A) into its original location and clear ALL related Diagnostic Trouble Codes (DTCs).

**Figure 1.**

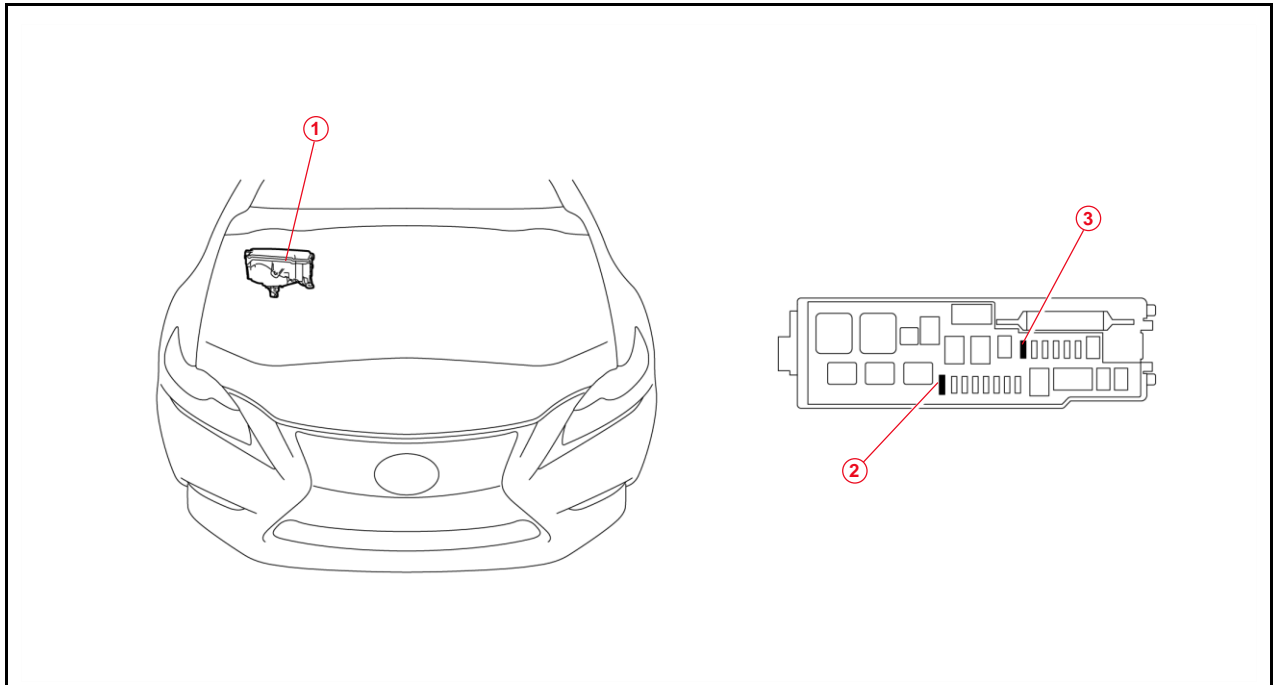

<b>1</b>	<b>Relay Block</b>
<b>2</b>	<b>Remove D/C Cut Fuse (30A)</b>

<b>3</b>	<b>Install D/C Cut Fuse (30A) (Original Location)</b>
----------	---

#### NOTE

While the vehicle is stored at the dealership, disconnect the negative (-) battery terminal to prevent battery discharge. Refer to [L-SB-0013-21](#), *Battery Maintenance During PDS*, for battery maintenance information.

## 2022 IS 300, IS 350, IS 500 Pre-Delivery Service (PDS)

---

### Deletion of Vehicle Alert History

As the D/C cut fuse is removed, the communication between the various ECUs is interrupted. When the D/C cut fuse is reinstalled, the communication status is restored, but Lexus Enform Service Connect may store malfunction history in the form of vehicle alert history. Therefore, it is necessary to operate the multi-display and delete the vehicle alert history AFTER installing the D/C cut fuse during PDS at the dealership.

#### Deletion Procedure

1. Turn the engine switch (power switch) to the ON position (ON mode).
2. Push the Menu switch on the remote touch device.
3. On the multi-display, enter the following menus: *Info – Vehicle Alert History*.
4. If there is vehicle alert history stored, perform the Delete History operation.

**HINT**

If there is no vehicle alert history stored, the system will display a message stating "There is no vehicle alert history."

5. When the vehicle alert history deletion confirmation screen is displayed, select Yes.

**HINT**

If there is no vehicle alert history stored, the system will display a message stating "There is no vehicle alert history."

6. Turn the engine switch (power switch) to the OFF position (OFF mode).

## 2022 IS 300, IS 350, IS 500 Pre-Delivery Service (PDS)

---

### Parking Assist Monitor Initialization

As a result of the removal of the D/C cut fuse, the power source to the steering angle sensor is cut off. When the D/C cut fuse is reinstalled, the parking assist monitor system/panoramic view monitor will be operative, but it cannot display guidelines to assist parking operation because the center position recognized by the steering angle sensor may not be in an initial position. Therefore, perform parking assist monitor initialization AFTER installing the D/C cut fuse during PDS.

Refer to the applicable Repair Manual for the parking assist monitor [initialization procedure](#).

### Steering Sensor Zero Point Calibration

As a result of the removal of the D/C cut fuse, the steering angle sensor power source is cut off. When the D/C cut fuse is reinstalled, the center position recognized by the steering angle sensor may not be the appropriate position. Therefore, it is necessary to perform the steering sensor zero point calibration AFTER installing the D/C cut fuse during PDS.

Refer to the applicable Repair Manual for the steering sensor zero point [calibration procedure](#).

## 2022 IS 300, IS 350, IS 500 Pre-Delivery Service (PDS)

### Front Emergency Towing Eyelet Removal and Hole Cover Installation

1. Remove the front and/or rear emergency towing eyelet(s) from the radiator grille or rear bumper by turning them counterclockwise.

**NOTE**

If it is difficult to loosen the emergency towing eyelet(s), use a steel bar.

**Figure 2.**

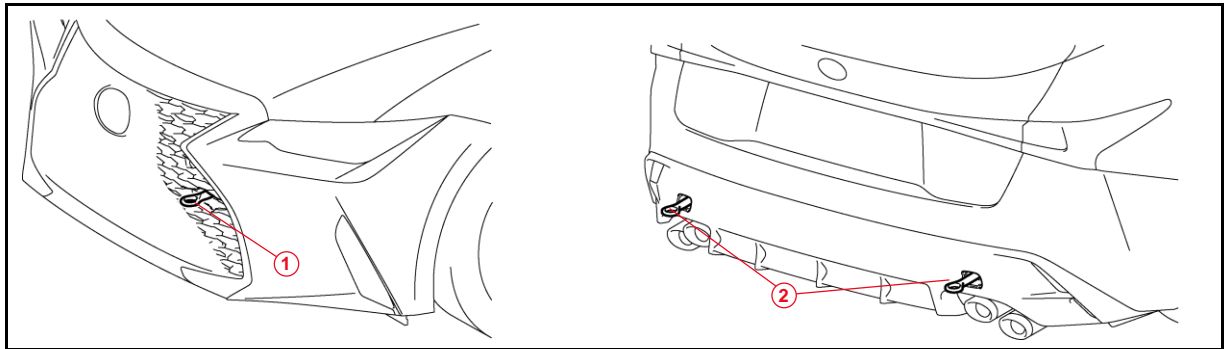

<b>1</b>	<b>Front Emergency Towing Eyelet</b>
<b>2</b>	<b>Rear Emergency Towing Eyelet</b>

2. Place one of the removed emergency towing eyelets into the tool tray in the luggage compartment.

**Figure 3.**

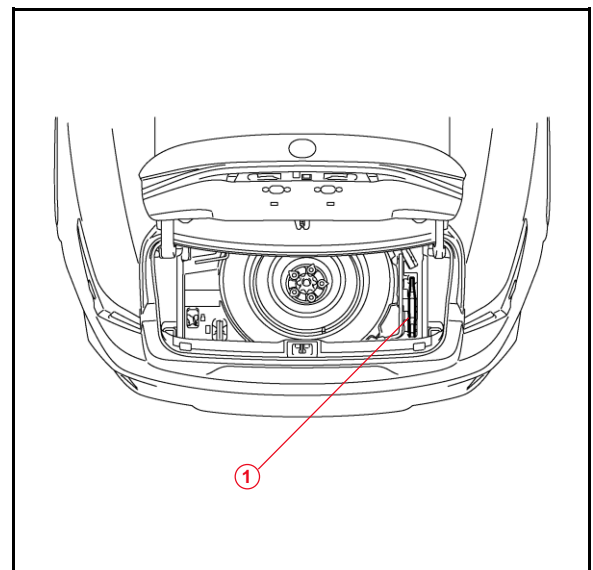

<b>1</b>	<b>Front Emergency Towing Eyelet</b>
----------	--------------------------------------

## 2022 IS 300, IS 350, IS 500 Pre-Delivery Service (PDS)

### Front Emergency Towing Eyelet Removal and Hole Cover Installation (continued)

3. Install the emergency towing eyelet hole cover(s), which is(are) stored in the glove compartment, onto the radiator grille or rear bumper.
  - A. Insert the arrow-shaped tab of the emergency towing eyelet hole cover “A” into the eyelet hole tab “B” as shown.
  - B. Install the emergency towing eyelet hole cover to the hole in the radiator grille or rear bumper.

**Figure 4.**

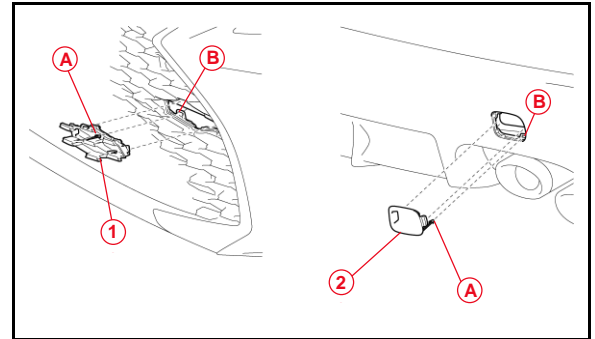

<b>A</b>	<b>Arrow-shaped Tab</b>
<b>B</b>	<b>Eyelet Hole Tab</b>
<b>1</b>	<b>Front Emergency Towing Eyelet Hole Cover</b>
<b>2</b>	<b>Rear Emergency Towing Eyelet Hole Cover</b>

### Front Wheel Opening Extension Pad Installation

The front wheel opening extension pad set (right and left front wheel opening extension pads and tapping screws) is located in the luggage compartment at the assembly plant to avoid damage in transit.

1. Place the left front wheel opening extension pad on the installation position and temporarily tighten the tapping screws. Then, tighten the tapping screws.

**NOTE**

There is a distinguishable mark on each opening extension pad.

2. Repeat step 1 for the right side.

**Figure 5.**

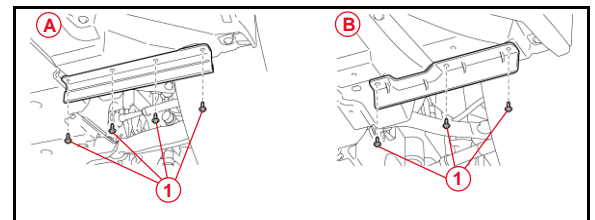

<b>A</b>	<b>IS 300, IS 350</b>
<b>B</b>	<b>IS 500</b>
<b>1</b>	<b>Tapping Screw</b>

## 2022 IS 300, IS 350, IS 500 Pre-Delivery Service (PDS)

### Front License Plate and Mounting Bracket Installation

The front license plate bracket and two self-tapping screws are stored in the vehicle at the assembly plant. Follow this procedure to install the front license plate bracket and front license plate in states where it is required by law.

- Align holes "A" of the mounting bracket with the dimples on the radiator grille. Mark the location of holes "B" on the radiator grille.

**NOTE**

- Holes "A" are used for installation of the mounting bracket to the radiator grille.
- Holes "B" are used for the installation of the front license plate to the mounting bracket.

- Drill two relief holes with a diameter of 10 mm (0.39 in.) at the hole B marks on the radiator grille to prevent the license plate retaining bolt end from contacting the radiator grille.

**NOTICE**

- Do NOT pre-drill holes into the radiator grille.
- Do NOT drill dimples on the radiator grille.

Figure 6.

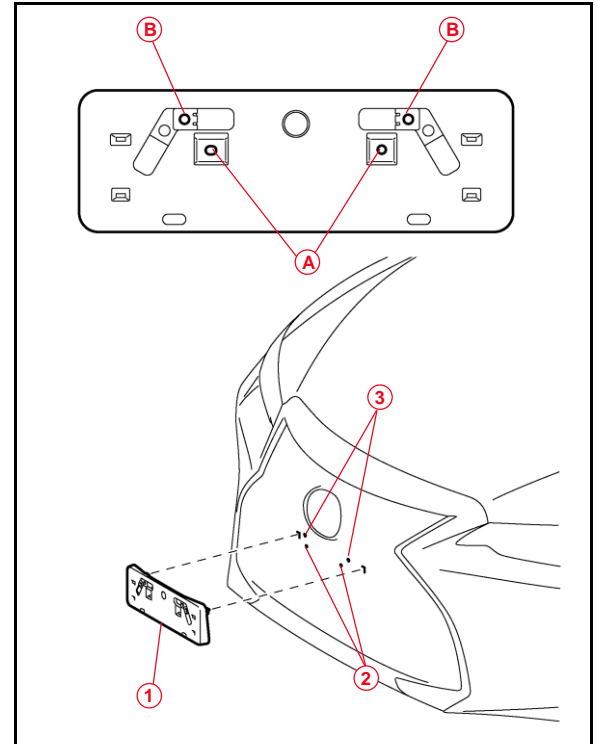

1	Mounting Bracket
2	Dimple
3	Mark and Drill Hole

## 2022 IS 300, IS 350, IS 500 Pre-Delivery Service (PDS)

### Front License Plate and Mounting Bracket Installation (continued)

3. Install the mounting bracket to the radiator grille by attaching the two self-tapping screws into the dimples.

**NOTICE**

Do NOT overtighten the self-tapping screws.

**Figure 7.**

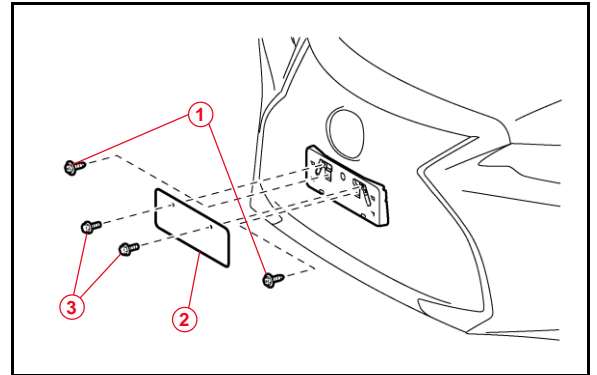

1	Self-tapping Screw
2	License Plate
3	Bolt

4. Install the front license plate to the mounting bracket using two noncorroding bolts with the following dimensions:

**Nominal Length: 15.0 mm (0.59 in.)**

**Diameter: 6.0 mm (0.24 in.)**

**Figure 8.**

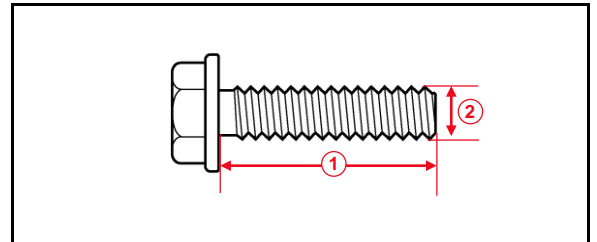

1	Nominal Length
2	Diameter



## 2022 IS 300, IS 350, IS 500 Pre-Delivery Service (PDS)

### Installation of Rubber Body Plugs

1. Confirm the number of plugs in the glove box. If two plugs are present, perform substep 2A ONLY. If four plugs are present, perform substep 2A AND substep 2B.
2. Install plugs according the instructions below by confirming the number of plugs in the glove box.
  - A. Install two plugs in the rear side member hole or rocker inner hole as shown.
  - B. Install two plugs in the torque box hole or rocker inner hole as shown.

**Figure 9.**

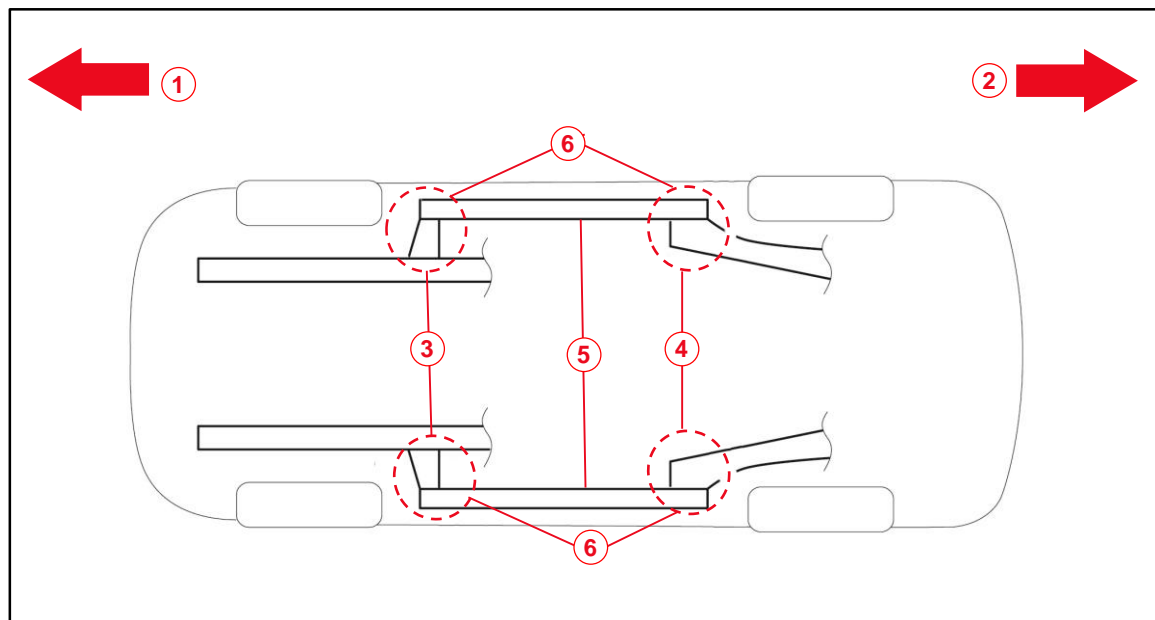

<b>1</b>	<b>Front Side</b>
<b>2</b>	<b>Rear Side</b>
<b>3</b>	<b>Torque Box Hole or Rocker Inner Hole</b>
<b>4</b>	<b>Rear Side Member Hole or Rocker Inner Hole</b>
<b>5</b>	<b>Rocker Inner</b>
<b>6</b>	<b>Install Plug Here (if Applicable)</b>

**NOTICE**

- The installation of these plugs is required to prevent rust.
- These plugs are stored in the glove box.
- The number of plugs may vary according to production locations in the same vehicle model.

## 2022 IS 300, IS 350, IS 500 Pre-Delivery Service (PDS)

---

### Tire Pressure Warning System (TPWS) Initialization

Refer to the applicable Repair Manual for the TPWS [initialization procedure](#).

Note the spare tire does NOT have a TPWS sensor.

#### NOTE

To adjust the tire pressure correctly when the outside temperature is significantly colder than shop temperature, perform a Health Check using Techstream and select the compensation tire pressure checkbox. Compensation pressures will display on the Health Check results screen. Adjust the tire pressure when the tires are cold.