

FLA COE
FLB COE
FLD Conventional
Business Class
FLC 112 Conventional

Century Class Conventional
Argosy
Cargo
Columbia
122SD and Coronado

Business Class M2
Cascadia
108SD/114SD
> New Cascadia

**Freightliner
Service Bulletin**

General Information

New Cascadia trucks built from January 1, 2017 through June 16, 2020 may be equipped with auxiliary mirrors that vibrate or wobble. A service kit (part number 22-77791-500) is available to resolve the issue.

The service kit can be used with the following parts:

- A22-73902-000 thru -007
- A22-75354-000 thru -007
- A22-76914-000 thru -003
- A22-76915-000 thru -003
- A22-77790-000 thru -003 current
- A22-77791-000 thru -003 current

Auxiliary Mirror Retrofit

1. Park the vehicle on a level surface, shut down the engine, and set the parking brake. Chock the tires.
2. Unlock the auxiliary mirror glass by tilting it all the way down and using a flat screwdriver to turn the locking ring to the left.
3. Pull the glass out, and disconnect the heater wires.
4. Use a flat screwdriver to push in the spring-loaded locking pin, and turn it 90 degrees, then remove the rest of the parts.
5. Assemble the three tip-tap parts—outer sphere, main adaptor, and inner sphere—as shown in [Fig. 1](#).

Freightliner Service Bulletin

FLA COE
FLB COE
FLD Conventional
Business Class
FLC 112 Conventional

Century Class Conventional
Argosy
Cargo
Columbia
122SD and Coronado

Business Class M2
Cascadia
108SD/114SD
> New Cascadia

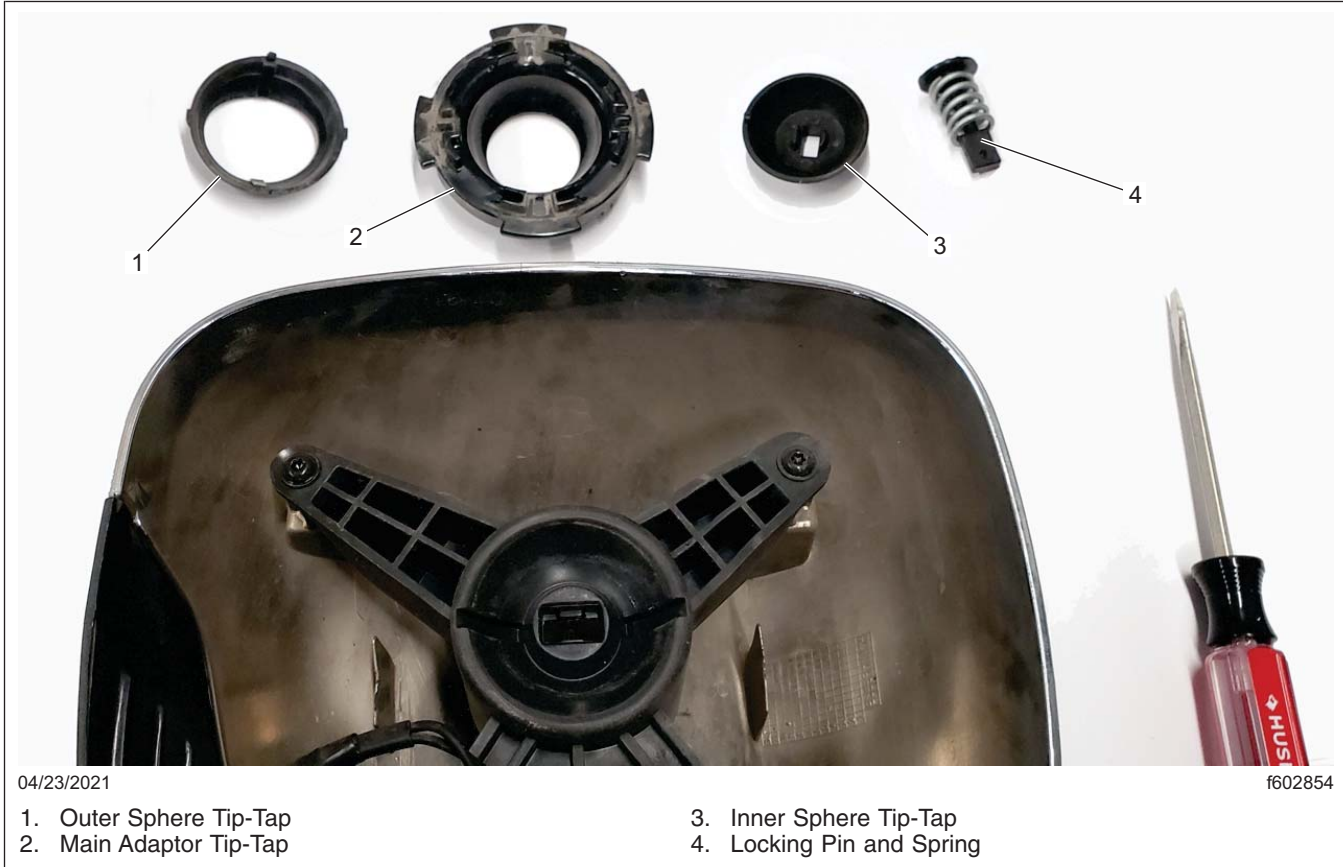

Fig. 1, Tip-Tap Components

6. Make sure the notches and grooves in each part match up as shown in the following video (you must be logged into DTNACconnect to view the video):
[video](#)
7. Push the spring-loaded locking pin inward, and turn it 90 degrees until all parts of the assembly are locked in place. See [Fig. 2](#).

FLA COE
 FLB COE
 FLD Conventional
 Business Class
 FLC 112 Conventional

Century Class Conventional
 Argosy
 Cargo
 Columbia
 122SD and Coronado

Business Class M2
 Cascadia
 108SD/114SD
 > New Cascadia



Fig. 2, Placing and Securing the Spring-Loaded Locking Pin

8. Ensure that the glass assembly is unlocked (locking ring turned to the left).
9. Connect the heater wires, then push the glass assembly into the adaptor.
10. Turn the locking ring to the right to secure the glass.

Warranty

This procedure is warrantable only if the described condition exists and the repair is performed within the applicable base or extended coverage warranty period. If a failure is not found, this procedure is considered preventive and warranty does not apply.

Normal warranty applies. See [Table 1](#) for OWL VMRS codes and labor allowance information. Enter this service bulletin number in the *Service Bulletin #* field.

OWL VMRS Codes and Labor Allowance						
Primary Failed Part	Component Code	Cause Code	Correction Code	SRT Code	Description	Time: Hours
Aux. Mirror	002-010-037	19	03	74B-5000A	Aux. Mirror Service Kit R/R	0.2

Table 1, OWL VMRS Codes and Labor Allowance