

Have the room about 8" out.  
Measure from middle of the rail on  
the top rail to the middle of the rail  
on the bottom rail. Must be the  
same points on both. Then move the  
room all the way out take the  
measurement again. Do this on both  
sides.

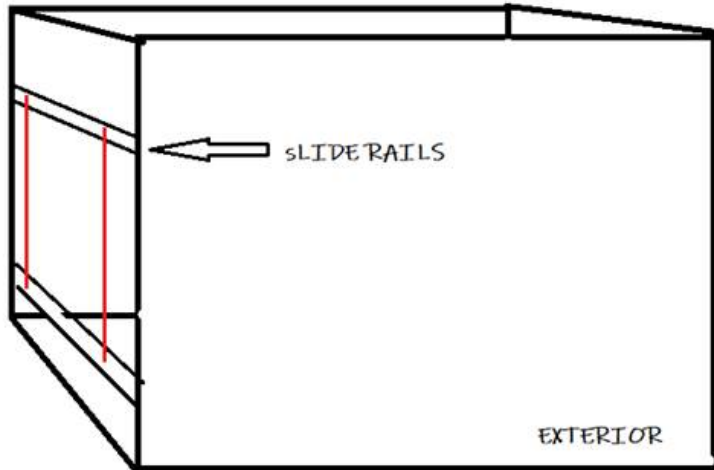

Side View

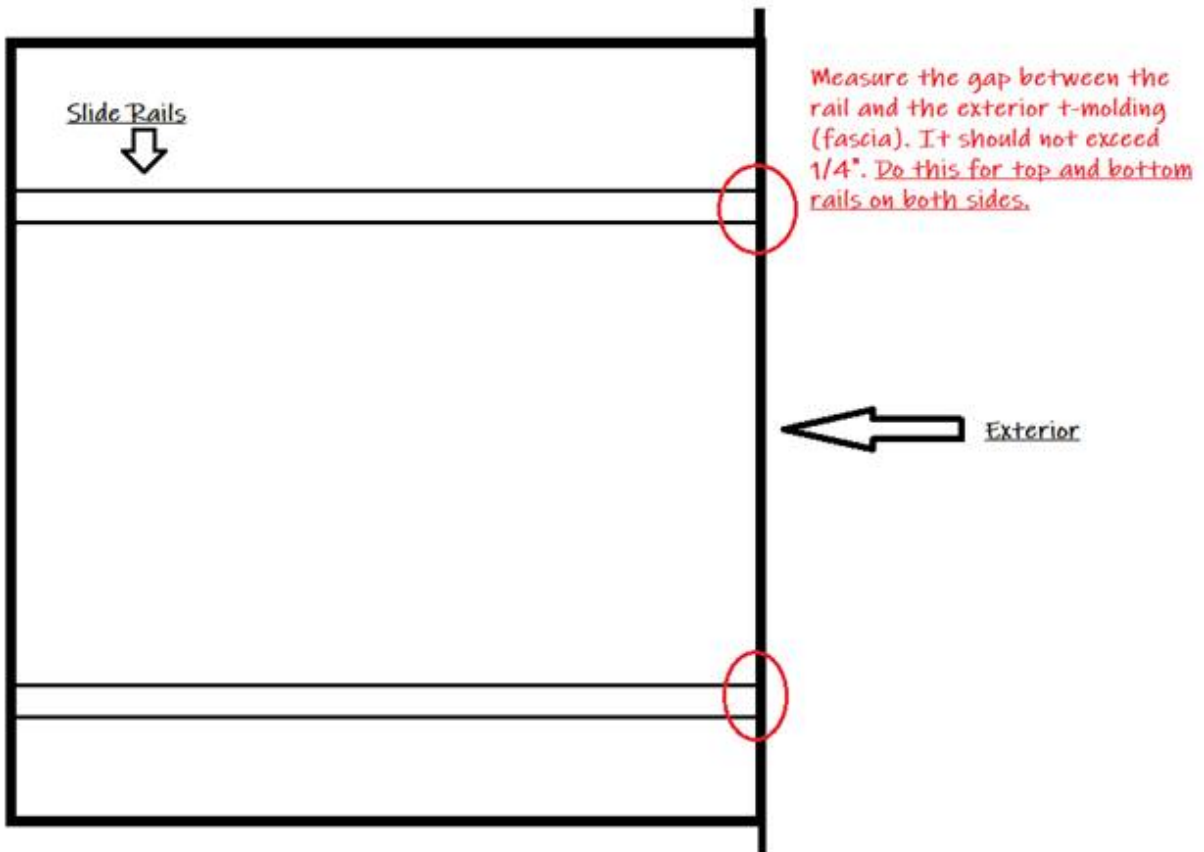

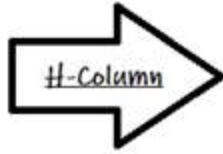

Measure the distance between the slide rails and the H-column. At all 4 locations.

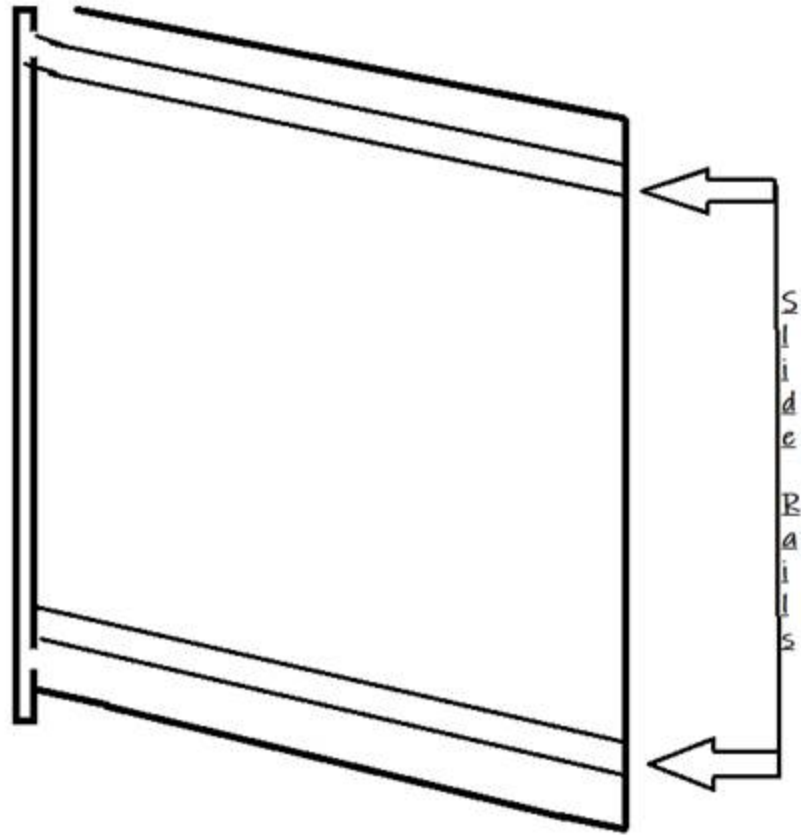



REV LVL	CHANGE DESCRIPTION	BY	CHK	DT	ECON/PRR
-		-	-	-	-

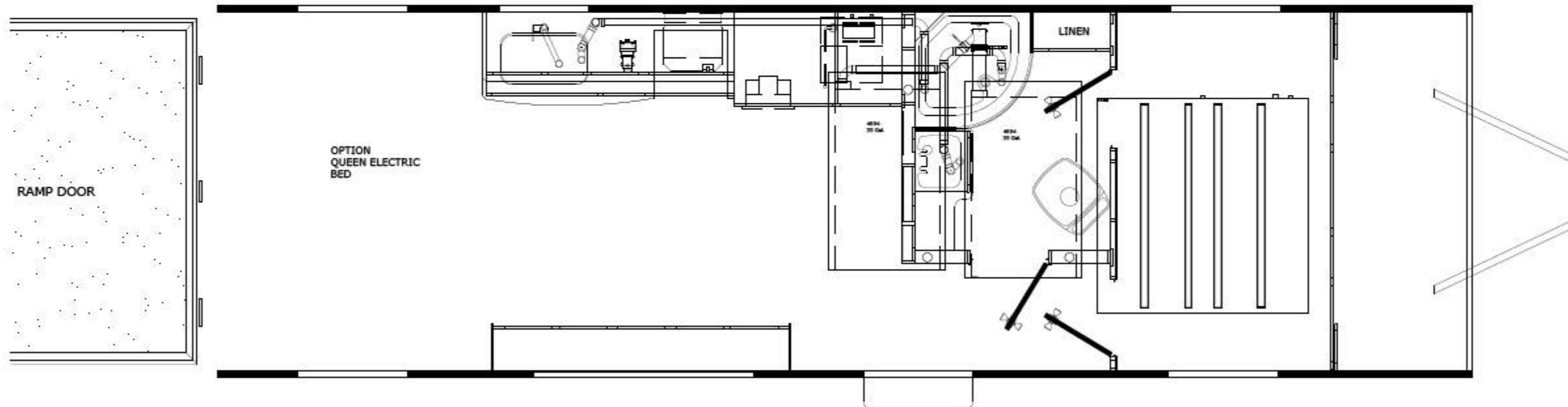

QUANTITY	REF NO.	PART NO.	MATERIAL OR PART DESCRIPTION
TOLERANCE UNLESS OTHERWISE SPECIFIED		OPTION DATE	CLASS CODE:
WOOD	OTHER	DH 6/15/20	COACHMEN R.V. CO. LLC
+ 1/8"	+ 1/16"	APPRO DATE	WASTE ASSY
+ .125"	+ .063"		SCALE
			NTS
			DO NOT SCALE
			PART #
			REV
			HEET 1 OF 1

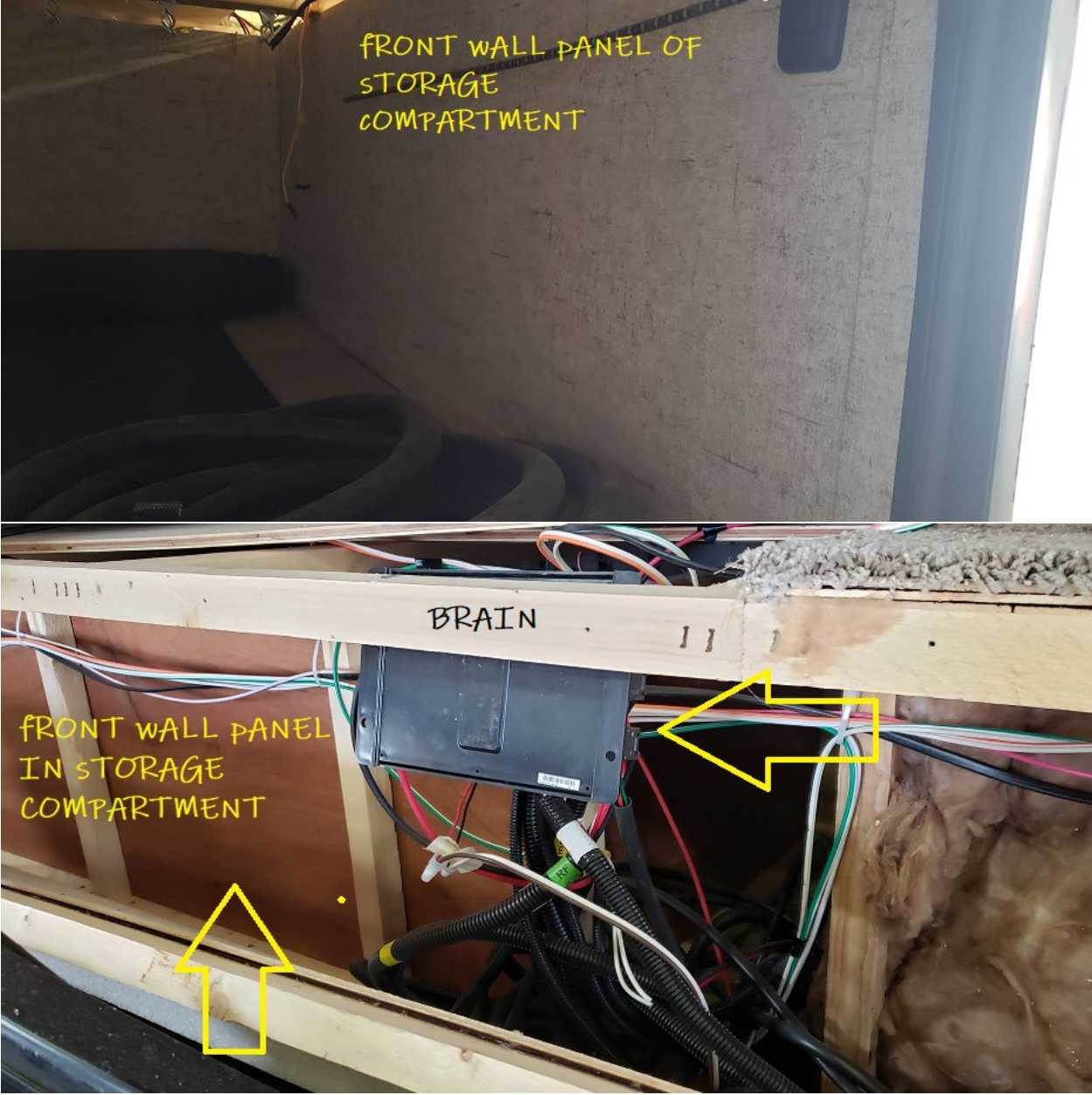

FRONT WALL PANEL OF  
STORAGE  
COMPARTMENT

FRONT WALL PANEL  
IN STORAGE  
COMPARTMENT

BRAIN



# Generator Electrical Hook up

Harness from House has the following...

Black, White, Red, Copper

Harness From Onan Generator had the following...

Black, Black with yellow stripe, 2 whites, Green

- Connect all the whites together
- The solid black to solid black tie together
- Black with yellow stripe ties to the Red
- Green ties to the Copper

# Jaboni 265W Solar Power Hook Up

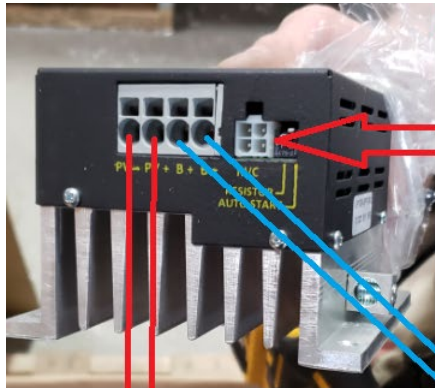

Controller

This is where the harness plugs in.



Remote Display

Red and white to Panels



PLEASE NOTE:  
If unit has 12V  
Refer, it also uses  
blue and white  
wires. Please pay  
attention!

Blue and White  
from batterie(s)

Battery