

GFI PROTECTION MADE THROUGH A GFI RECEPT.

MINIMUM EXPOSED POWER CORD LENGTH = 25' (WHEN PLUG IS ON SIDE OF UNIT)

MINIMUM EXPOSED POWER CORD LENGTH = 30' (WHEN PLUG IS IN REAR OF UNIT)

ENERGY MANAGEMENT SYSTEM

FOREST RIVER INC.		001	EVA	02/11/06	06 PRINT REV.	DR BY / DATE	DESC	SERIES:
P.O. BOX 3030 ELKHART, IN 46515-3030		REV #	BT	DATE	SCALE	01/17/06	ELECTRICAL SYSTEM (OPT.)	DWG #
					N.T.S.			E-03

V=RAM AIR PER NFPA 1192 SECTION 6.4.6.2
 *NOTE : HEAT RUNS ARE DEVELOPED WITH 12" X 2.5" METAL DUCTING .01125 IN COMPLIANCE WITH ANSI/UL 181.
 Total Sq. Ft. = 377

OPTIONAL FUEL DISPENSING SHALL COMPLY WITH ALL REQUIREMENTS OF NFPA 1192 SECTIONS 5.9 THRU 5.9.12

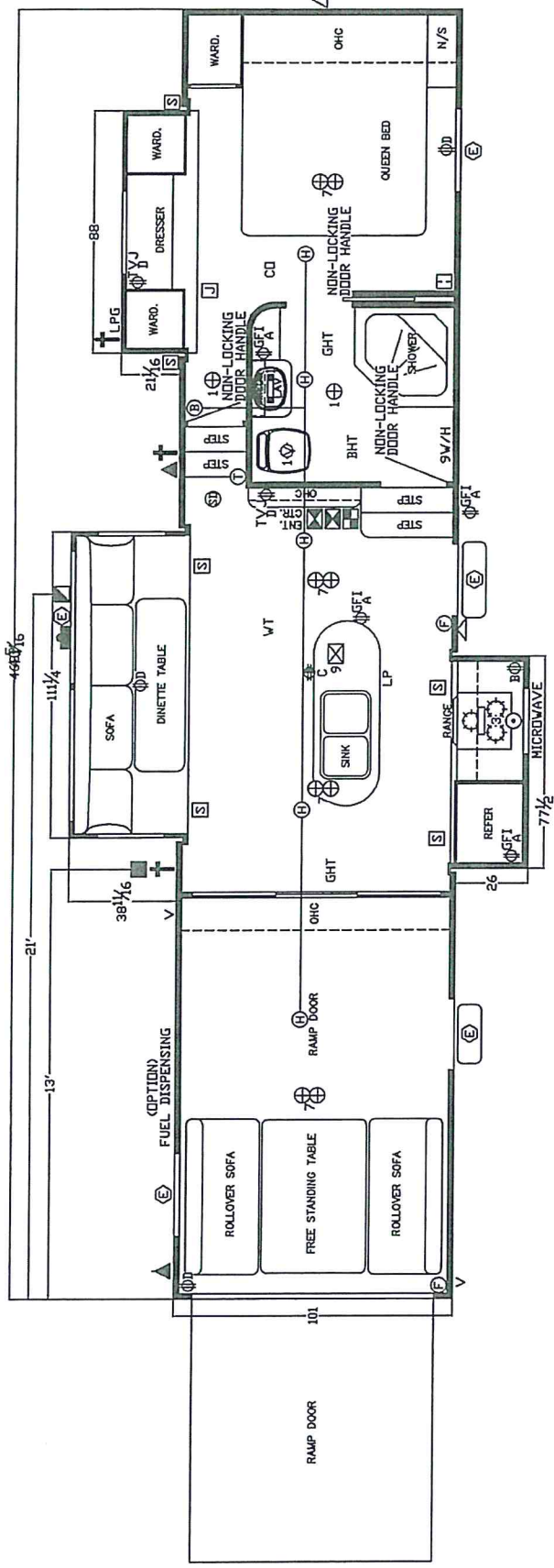

FLOOR COVERING OF SEAMLESS, NONABSORBANT LINDOLEUM
 APPLICATIONS TO BE MADE IN ACCORDANCE WITH NFPA 1192 SECTION 6.4.6.2

SYSTEMS

PLUMBING	W-4015C	W-	D-3985
LPG	M-2006B		
ELECTRICAL	E-01 C	E-03	
FIRE & LIFE	10-BIC FIRE EXTINGUISHER (MIN) EGRESS MEETS REQUIREMENT-24 X 17 (MIN) INTERIOR MATERIALS ARE CLASS C FLAME SPREAD OR BETTER UNIT COMPLIES W/ANSI 1192 SECT. 6.4.6		

CIRCUIT	1	2	3	4	5	6	7	8	9
	50 A	F	G	H	I	J	K	L	M
	30 A	A	B	C	D	E			

(OPT.)

FOREST RIVER INC. 3010 College Ave. Goshen, IN 46526	REV #	BY	APPD	DATE	DESC
	DR BY / DATE	DESC			
	Ryan / 06-20-13	FLOOR PLAN			
	SCALE	SERIES			
	N.T.S.	CFSK-1.0			
		DWG #			