



DEALER HOLD

Release Date: April 16, 2021

IND

Communication #: IDH-21-02

Model Year(s): 2022

— Confidential and Proprietary —

VERSION: R02 (July 20, 2021)

****Added Kit Installation Procedure****

IMPORTANT STOP SALE NOTICE!
Stop selling affected vehicles immediately.

SUBJECT: CHIEF LICENSE PLATE MOUNT - AUS/NZ ONLY

PURPOSE

EFFECTIVE IMMEDIATELY: STOP SALE on affected motorcycle(s) identified in your inventory until further notice.

Reference Unit Inquiry for specific VIN(s).

Indian Motorcycle has developed a license plate mount kit to meet AUS/NZ regulation requirements. Kit installation instructions have been added to this communication.

AFFECTED MODELS

MODEL YEAR	MODELS	VEHICLE IDENTIFICATION NUMBER RANGE
2022	Chief	Reference Unit Inquiry on the dealer website or the Service Communications list on the STOP site to look up affected VINs.
	Chief Bobber	
	Super Chief	

WARRANTY CLAIM INFORMATION

2022 CHIEF	
Bulletin #	IDH-21-02
Claim Type	Dealer Hold
Labor Allowance	1.5 hours (90 minutes)
Part Number / Description	2889608 (QTY 1) Kit, Center Mount License Plate
Parts Availability	Available to order
University of Polaris Video Training Required	NO

Claim Submission:

- **International Dealers:** On iDEX, go to Service and Warranty> Warranty Claims>Start a New Warranty Claim. Select Dealer Hold> Enter the VIN and Retrieve Registration. Select IDH-21-02 and Send Claim

KIT CONTENTS

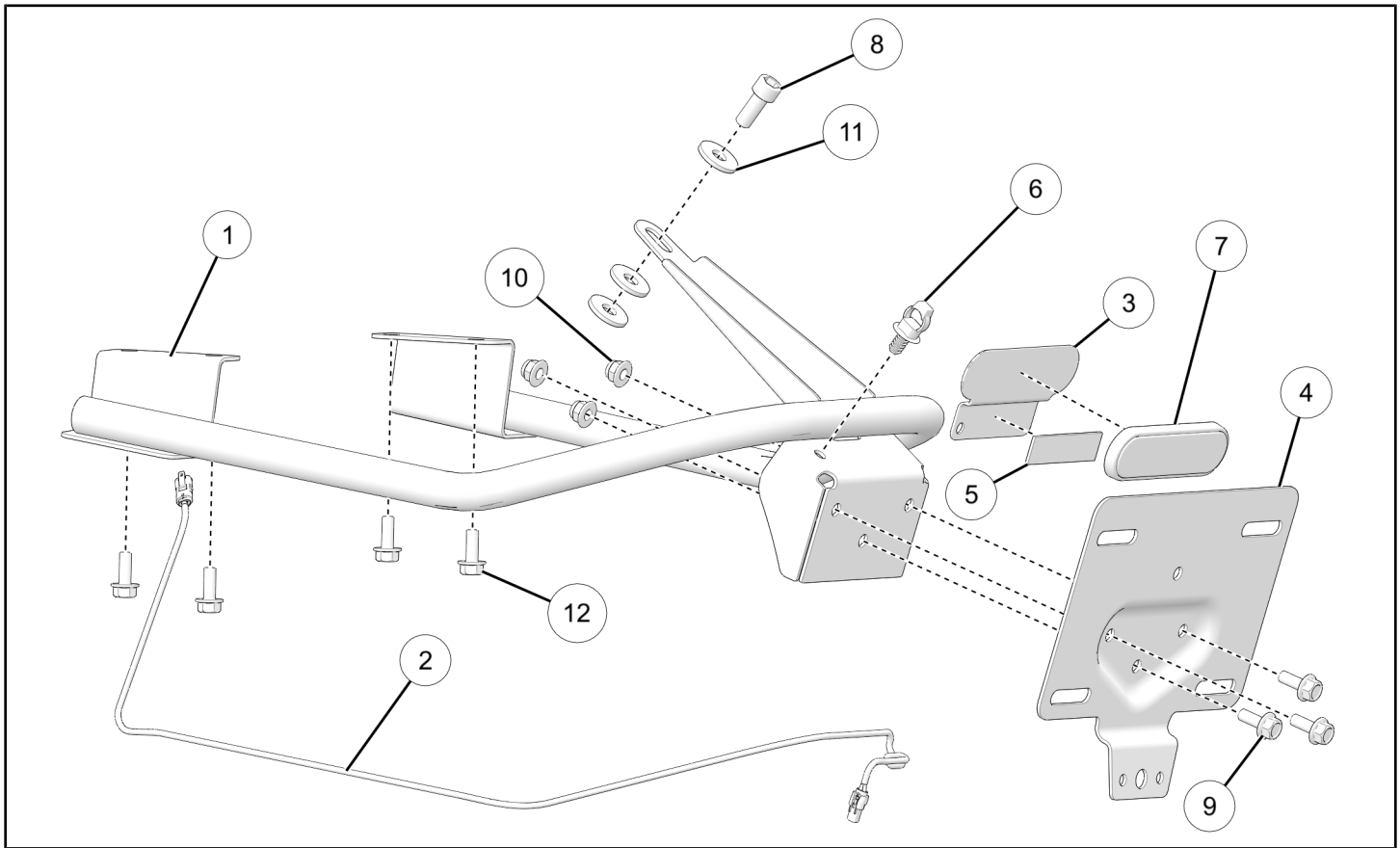

REF	QTY	PART DESCRIPTION	P/N AVAILABLE SEPARATELY
①	1	Assembly, Bracket Mount, Center License Plate	1027380
②	1	Harness, Center License Plate Extension	4080694
③	1	Bracket, Reflector	n/a
④	1	Support Plate, Center	5265832
⑤	1	Tape, Foam	5814711
⑥	1	Clip, Routing	7081496
⑦	1	Reflector, Red, Oval	7180903
⑧	1	Screw, Socket Head, M8 x 1..25 x 20 mm	7516738
⑨	3	Screw, Hex Flange Head, M6 x 1.0 x 16 mm	7518591
⑩	3	Net, Hex Flange, M6 x 1.0 mm	7547453
⑪	3	Washer, Flat, 0.327 x 0.875 x 0.9	7556341
⑫	4	Screw, Hex Flange Head, M6 x 1.0 x 16 mm, Thread Lock	7517770

The information contained within this document is confidential and protected by U.S. and international copyright laws, and is the property of Polaris Inc. This document is provided for the sole use of authorized Polaris dealers and distributors. This document is not to be distributed, duplicated, or copied, digitally or otherwise, without the written consent of Polaris Inc.

REPAIR PROCEDURE

TOOLS REQUIRED

- Safety Glasses
- Cutting Tool
- File, Flat
- Pick and Hook Set
- Push Dart (Panel Clip) Tool
- Socket Set, Hex Bit, Metric
- Socket Set, Hex Bit, Metric, Ball-End
- Socket Set, Metric
- Socket Set, Torx® Bit
- Torque Wrench
- Vise, Bench

CONSUMABLES REQUIRED

- Indian Motorcycle Gloss Black Paint: *PN 2859078-266*

DISASSEMBLY

1. Park motorcycle on a flat surface, fully extend kickstand, and make sure vehicle is stable.
2. Turn key to OFF position and remove key.
3. Remove two screws from saddlebag support.

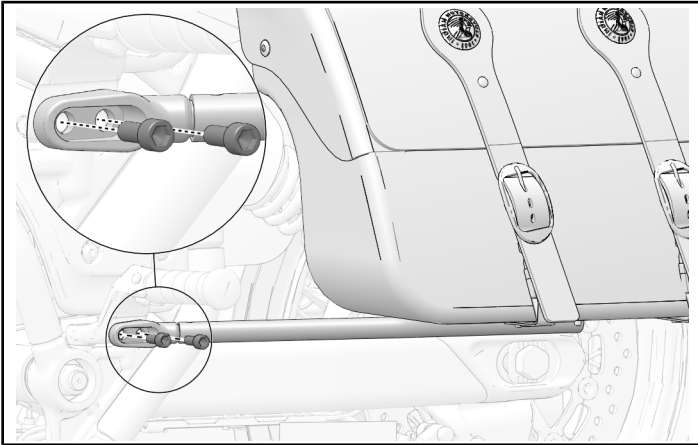

4. Open saddlebag lid and remove two screws from inside saddlebag.

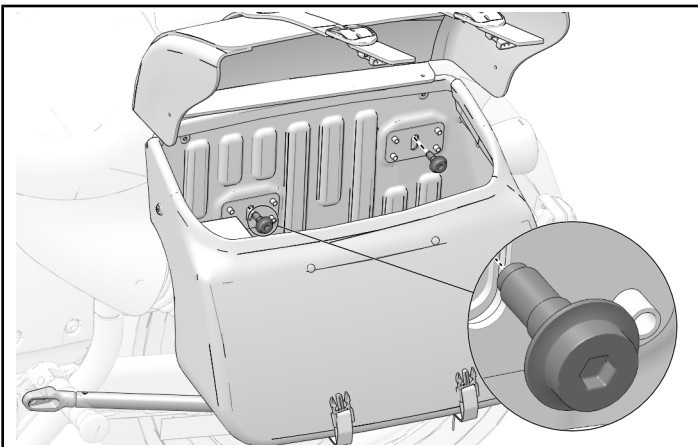

NOTICE

Left side saddlebag shown; Right side similar.

5. Remove saddlebag and carefully set aside.

6. Remove the passenger seat screw.

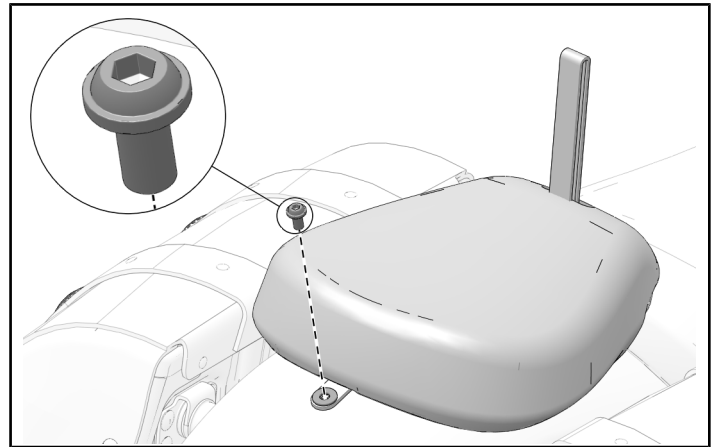

7. Remove the passenger seat by lifting up on the front edge of the seat to disengage the grommet from the seat stud.

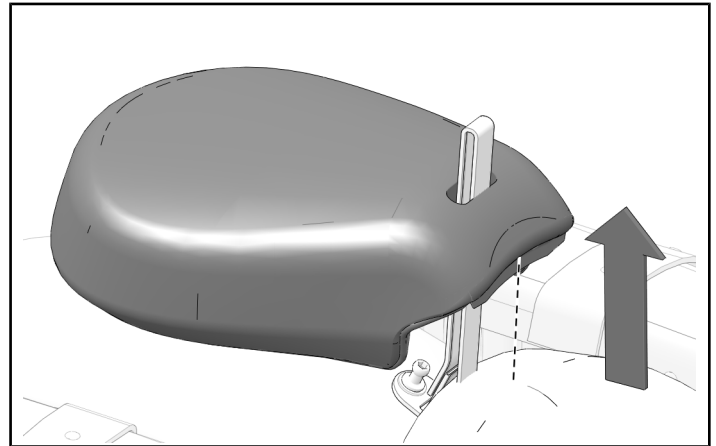

8. Remove the seat stud and washer from the strap bracket.

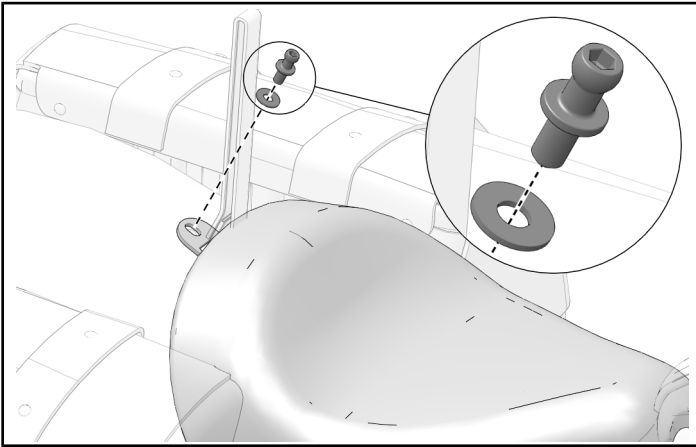

NOTICE

The fastener is different for motorcycles without a passenger seat.

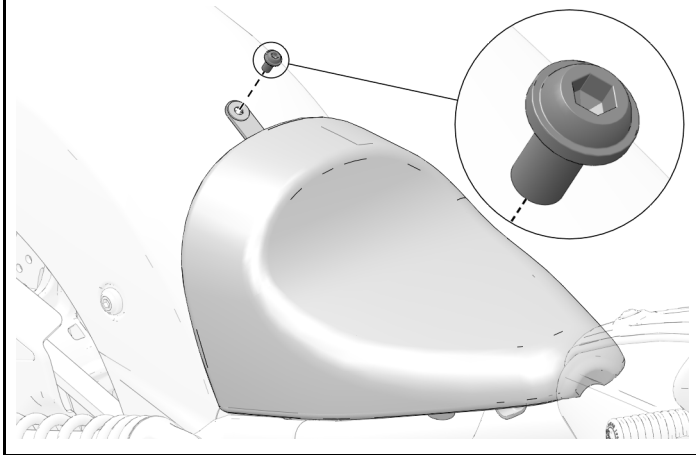

9. Remove the driver's seat by lifting up on the seat bracket and pulling the seat rearward.

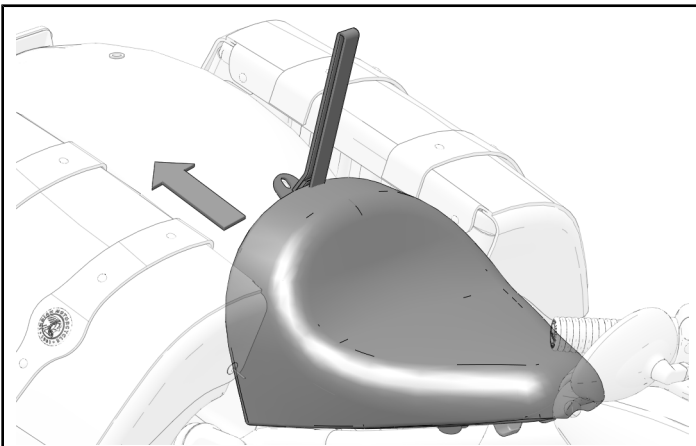

10. Remove four screws and washers or four saddlebag spool assemblies.

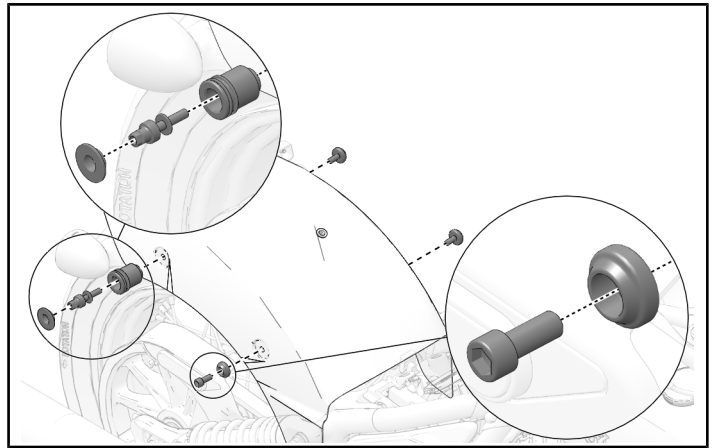

CAUTION

Protect painted surfaces with protective cloth during procedure.

11. Carefully lift rear fender from motorcycle and set aside.

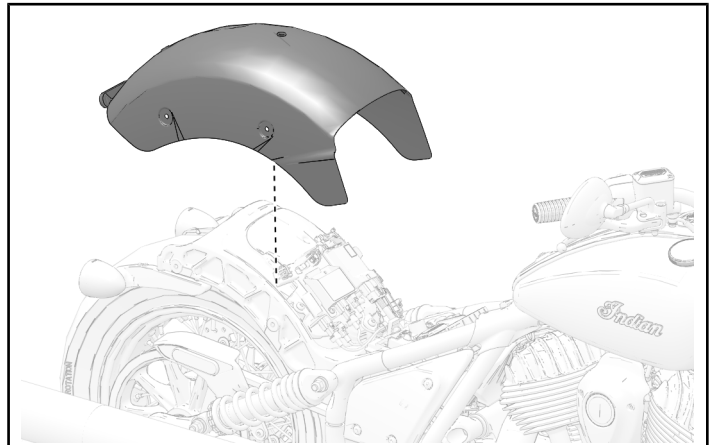

12. Disconnect license plate light harness connector.

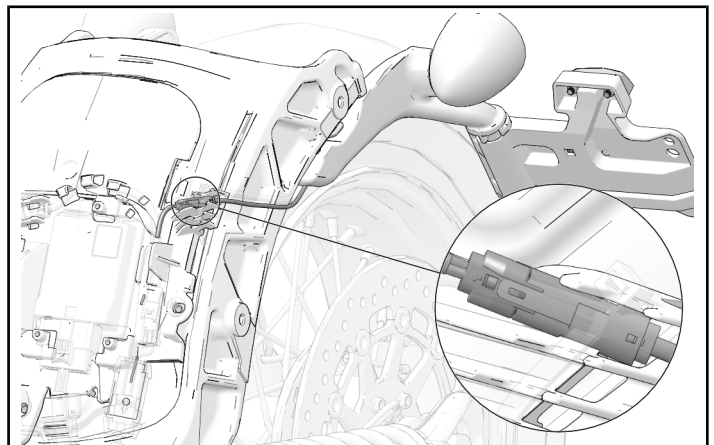

13. Remove and keep two push pin darts from inner bracket cover.

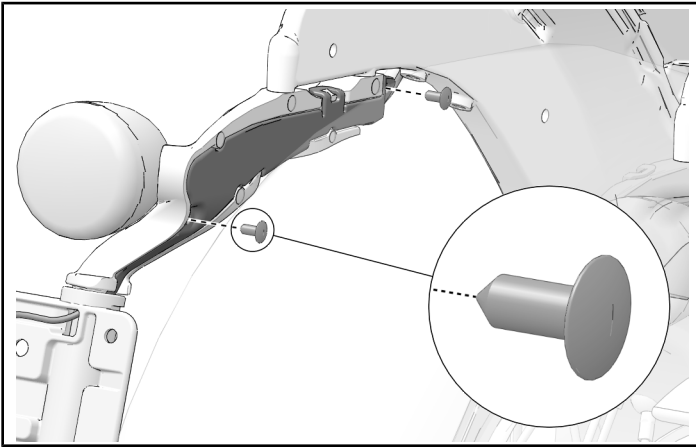

14. Carefully lift tab on inner bracket wire cover, remove and keep cover.

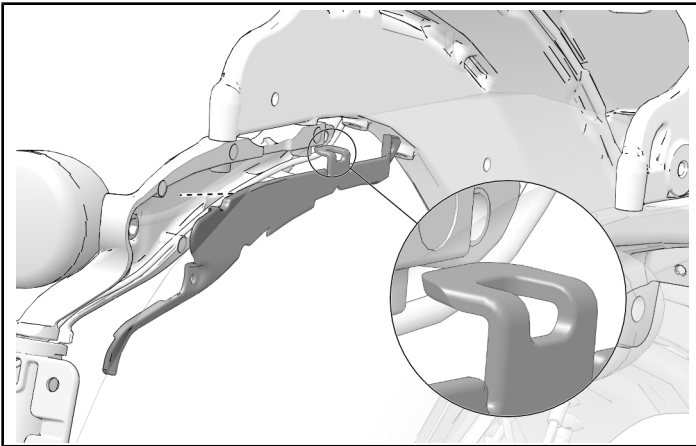

15. Remove and keep two nuts, license plate light, and harness from bracket.

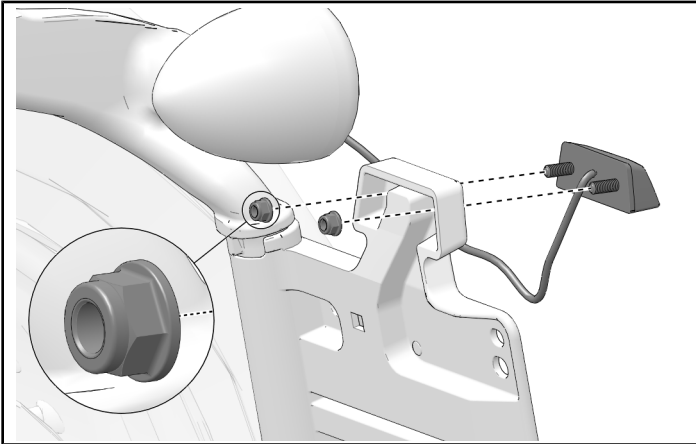

16. Disconnect left turn signal connector from chassis harness.

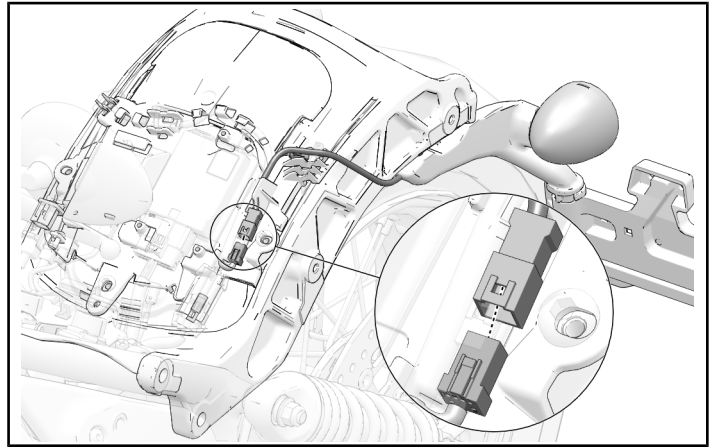

17. Remove and keep two screws and left turn signal bracket assembly.

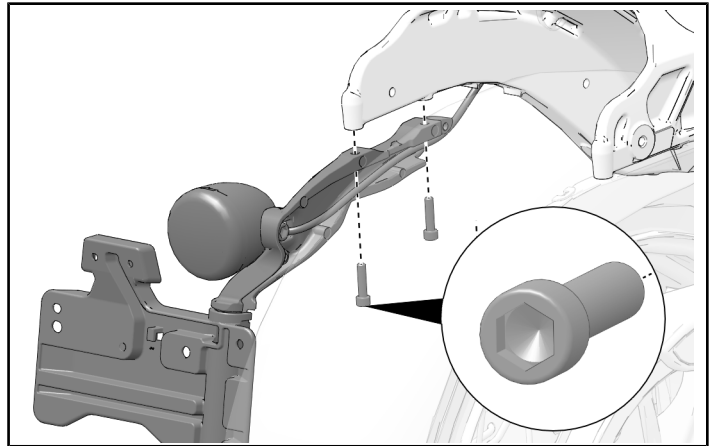

18. Remove and keep left turn signal screw, and left turn signal assembly.

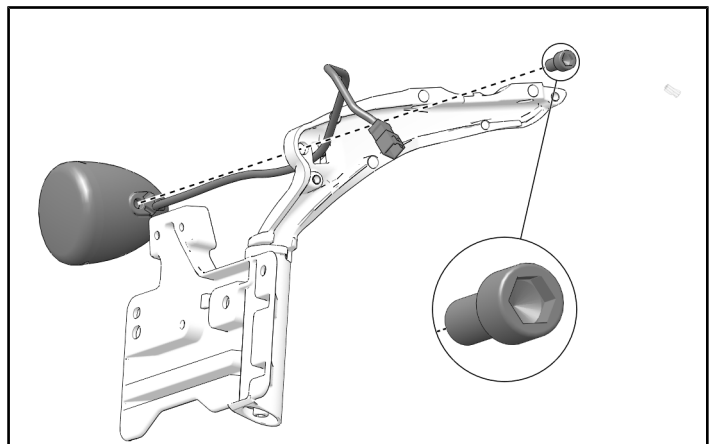

19. Remove and keep two push pin rivets from right turn signal wire channel cover, and wire channel cover.

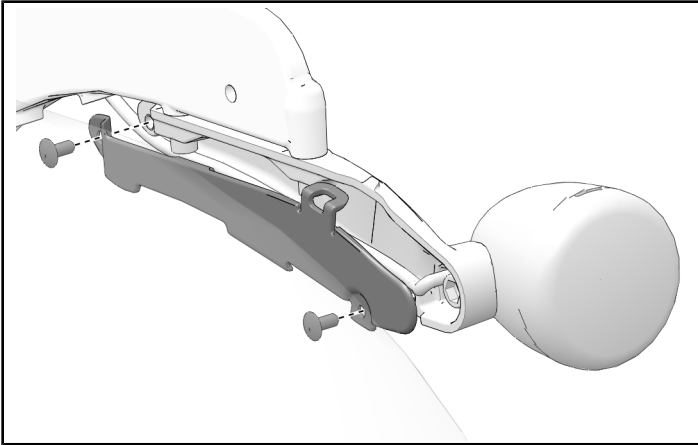

20. Remove and keep two bolts from right turn signal bracket. Carefully hang turn signal bracket.

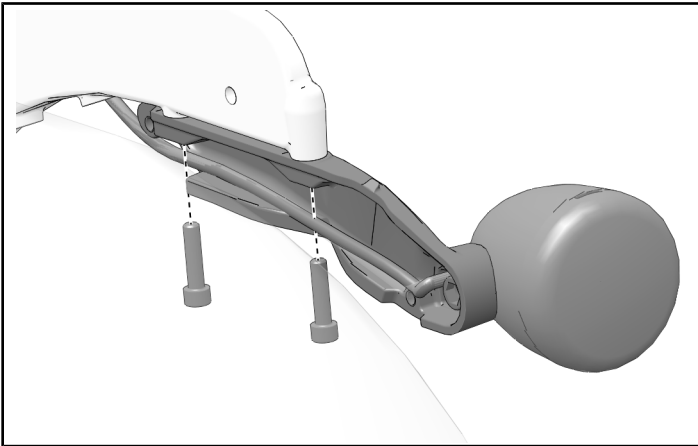

MODIFY TURN SIGNAL BRACKET

1. Cut left hand signal mount along line as shown. Make sure to cut **below** hole.

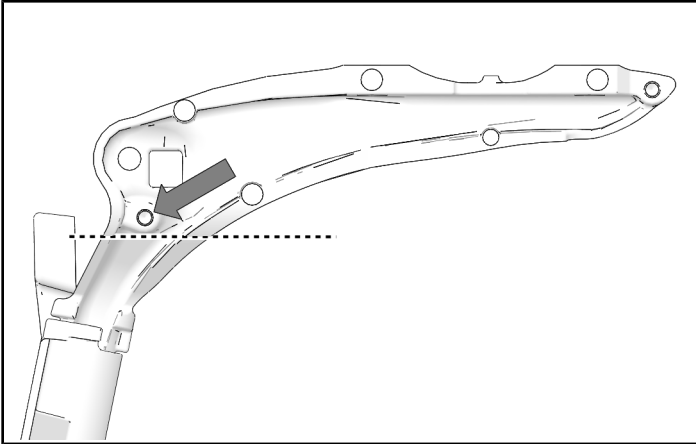

2. Cut excess material off wiring cover for left hand signal mount.

TIP

Install in place to make sure you have removed enough material.

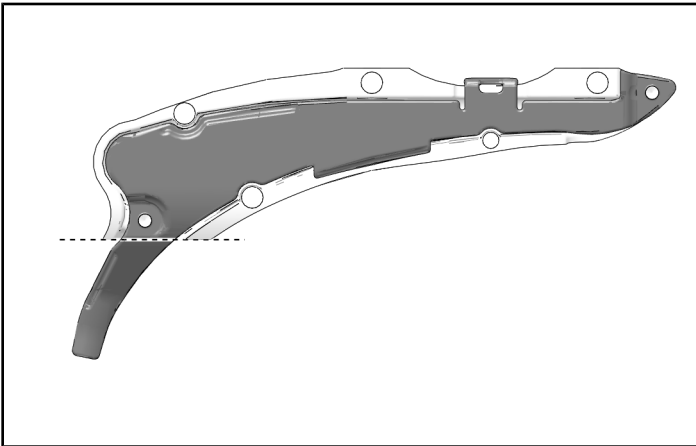

3. Round off cut edges until smooth.

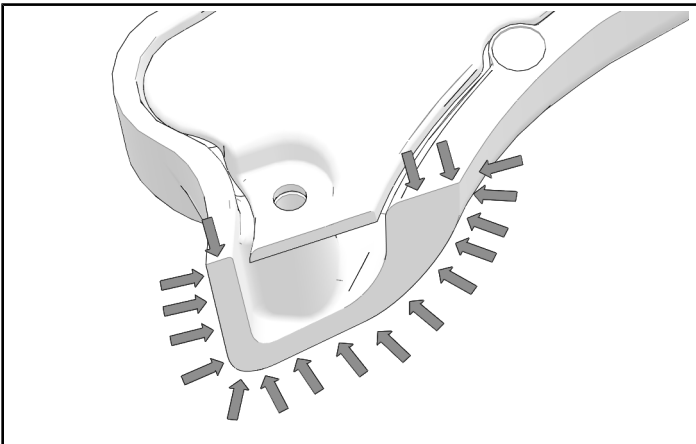

4. Clean exposed metal surface and prepare for paint.

The information contained within this document is confidential and protected by U.S. and international copyright laws, and is the property of Polaris Inc. This document is provided for the sole use of authorized Polaris dealers and distributors. This document is not to be distributed, duplicated, or copied, digitally or otherwise, without the written consent of Polaris Inc.

5. Paint exposed metal surface and allow to dry.

LEFT HAND TURN SIGNAL BRACKET ASSEMBLY

Inset wire connector through opening and install turn signal assembly to bracket. Attach with screw. Torque screw to specification.

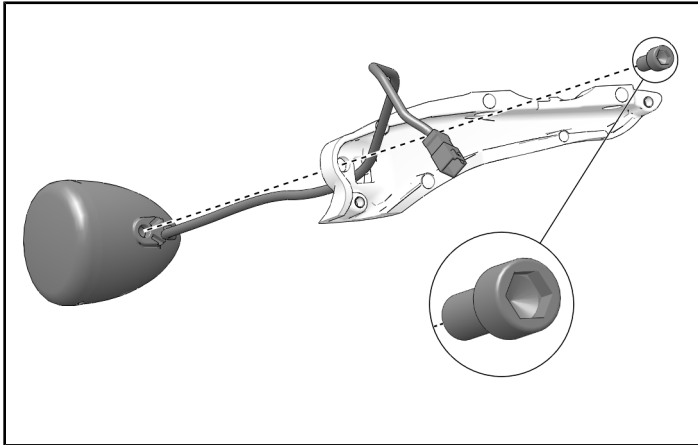

TORQUE

Rear Turn Signal Mounting Screw:
18 ft-lbs (25 N·m)

CENTER LICENSE PLATE BRACKET ASSEMBLY

1. Clean surface of reflector bracket ③ with isopropyl alcohol. Remove backing paper and attach reflector ⑦ to reflector bracket ③.

⚠ WARNING

Isopropyl alcohol is hazardous to your health. See isopropyl alcohol packaging for proper handling instructions, including recommended personal protective equipment such as goggles and chemical resistant gloves.

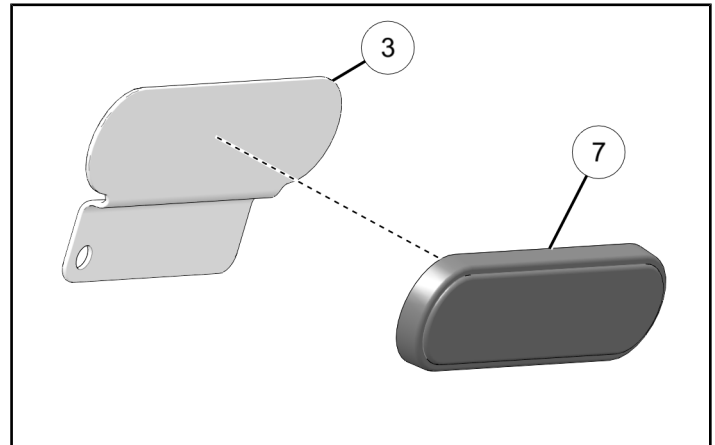

2. Clean surface of reflector bracket ③ with isopropyl alcohol. Remove one side of backing paper and attach foam tape ⑤ to reflector bracket ③.

⚠ WARNING

Isopropyl alcohol is hazardous to your health. See isopropyl alcohol packaging for proper handling instructions, including recommended personal protective equipment such as goggles and chemical resistant gloves.

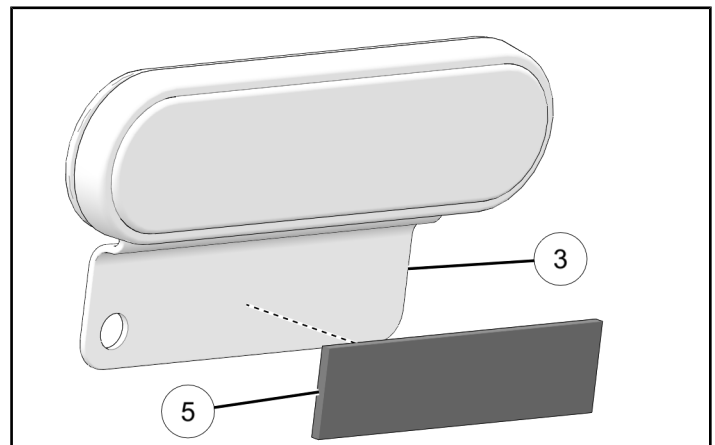

- Clean surface of center support plate ④ with isopropyl alcohol. Remove remaining side of backing paper from foam tape ⑤ and attach assembly to center support plate ④.

⚠ WARNING

Isopropyl alcohol is hazardous to your health. See isopropyl alcohol packaging for proper handling instructions, including recommended personal protective equipment such as goggles and chemical resistant gloves.

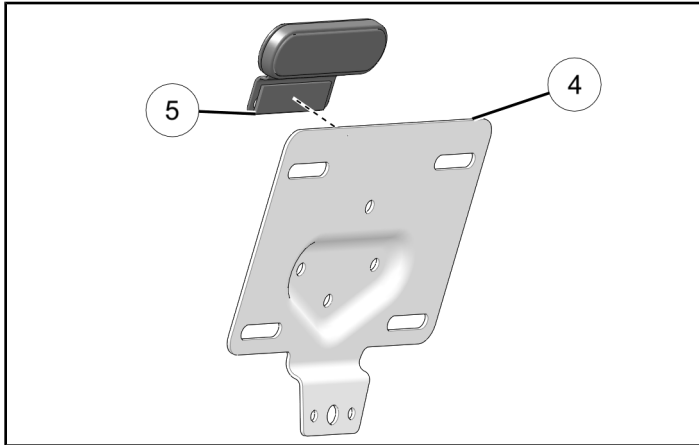

- Attach center support plate ④ to main assembly ① with three screws ⑨ and three nuts ⑩. Torque to specification.

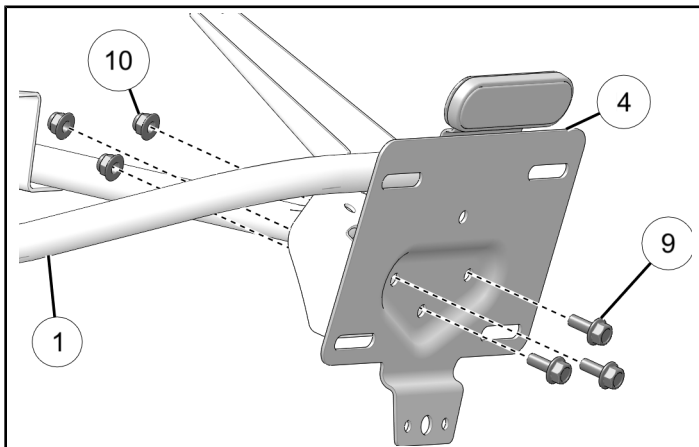

TORQUE

Center Support Plate Screws⑨:
88 in-lbs (10 N·m)

CENTER LICENSE PLATE BRACKET INSTALLATION

- If equipped, remove and discard rear center reflector from rear fender.

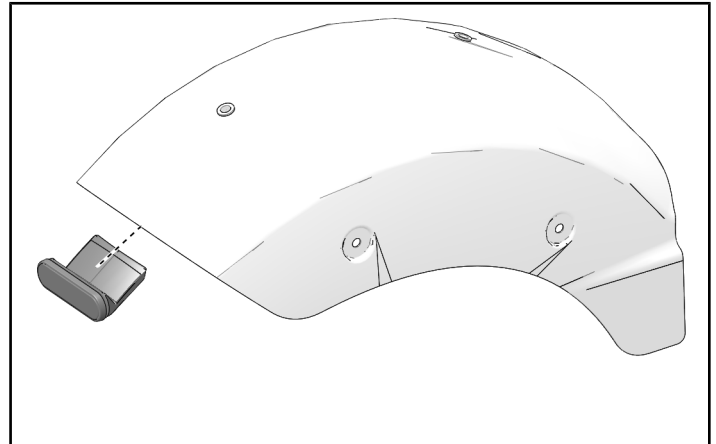

- Connect left turn signal wire harness and carefully hang left turn signal from vehicle.

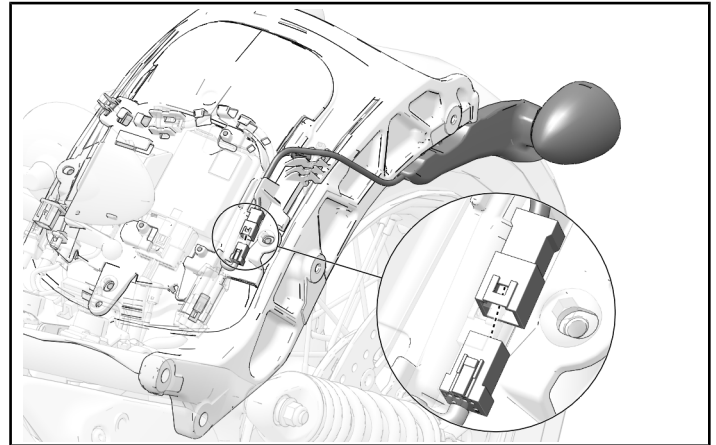

- Connect center license plate extension harness ② to chassis harness and install into track as shown. Hang harness down side of vehicle.

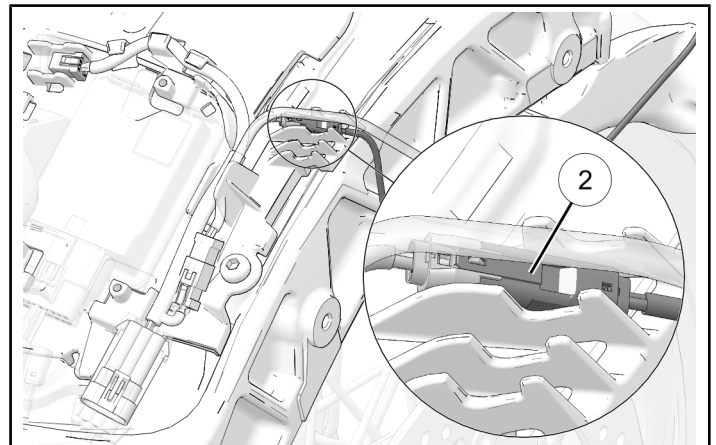

4. Set rear fender in place, make sure wiring for center license plate harness and both left and right turn signals is not pinched. Make sure harness for license plate light is *outside* of turn signal wiring and bracket.

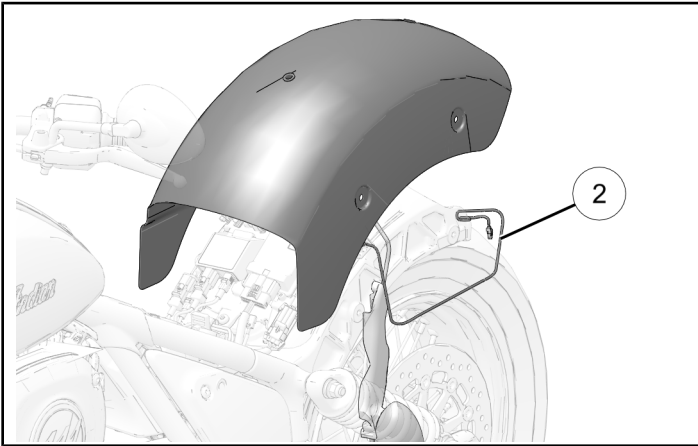

5. Attach rear fender with retained hardware. Torque fasteners to specification.

TORQUE

Rear Fender Fasteners:
18 ft-lbs (25 N·m)

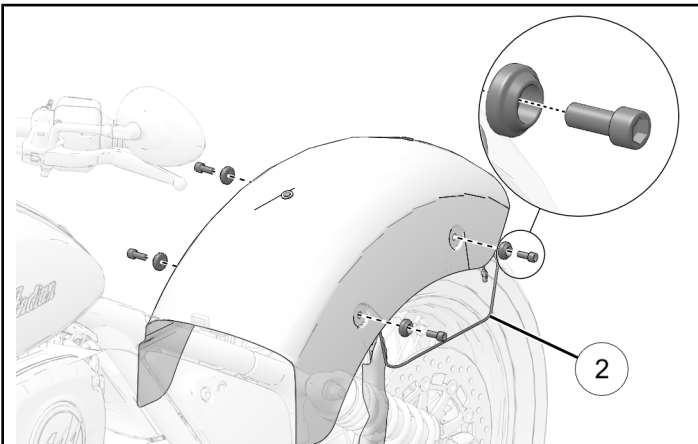

6. Carefully install center license plate bracket assembly ① into place. Loosely install one washer ⑪ and screw ⑧ into fender as shown.

DO NOT torque fasteners at this time.

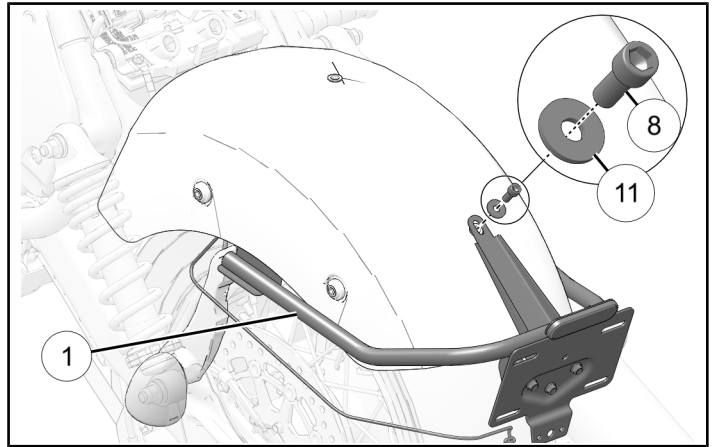

7. Starting on the right hand side, loosely install four screws ④ to attach center plate bracket assembly ①.

DO NOT torque fasteners at this time.

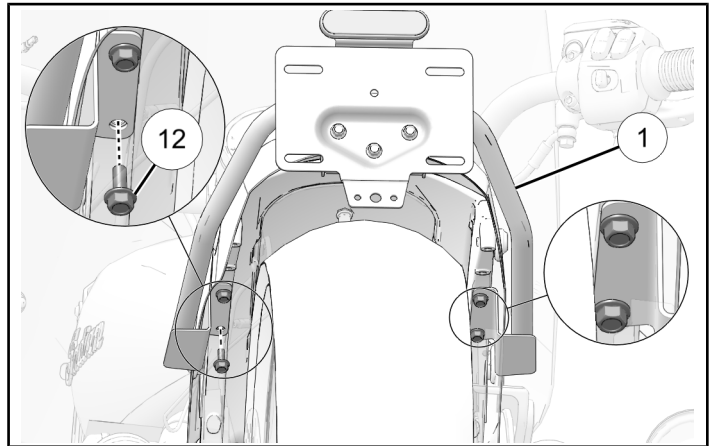

8. Insert connector from harness ② into opening in left tube on center plate bracket assembly until it can be pulled from opening in center of tube as shown. Pull wire end until connector is completely outside of opening.

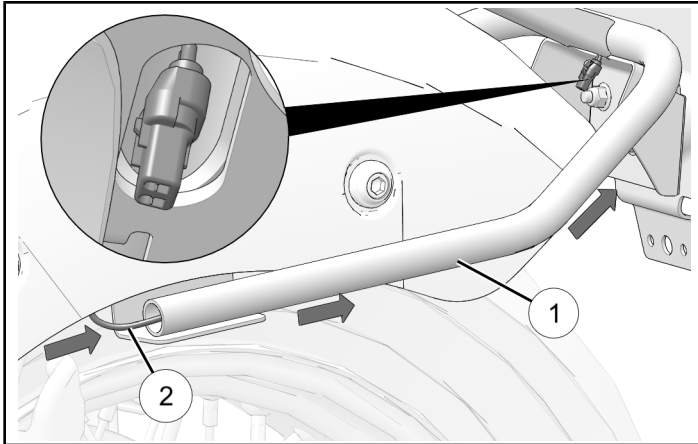

SEAT, PASSENGER SEAT, ACCESSORY RACK INSTALLATION

Install seat and rack configuration that is applicable to your motorcycle.

1. Driver seat only option

- a. Install driver seat by inserting front tabs into place and lowering rear of seat into place.

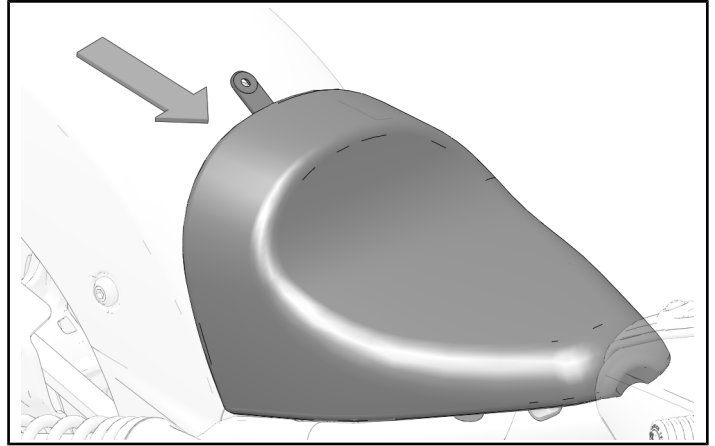

- b. Attach driver seat with screw. Torque to specification.

TORQUE

Driver Seat Screw:
13 ft-lbs (18 N·m)

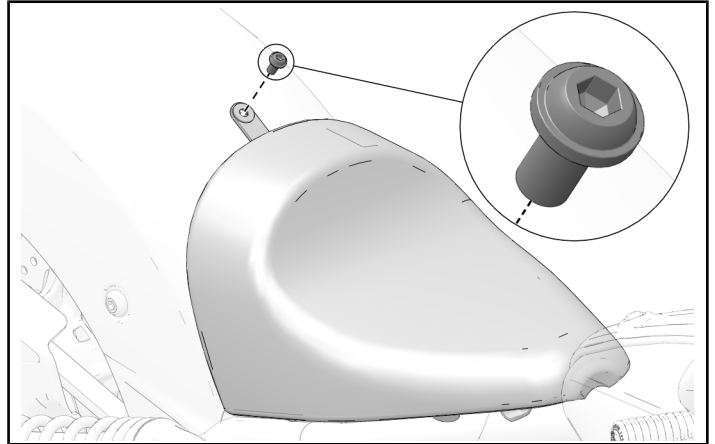

c. Attach center license plate bracket ① to fender with screw ⑧, and three washers ⑪ in the top-down order listed.

- Screw ⑧
- One Washer ⑪
- Center License Plate Bracket ①
- Two Washers ⑪

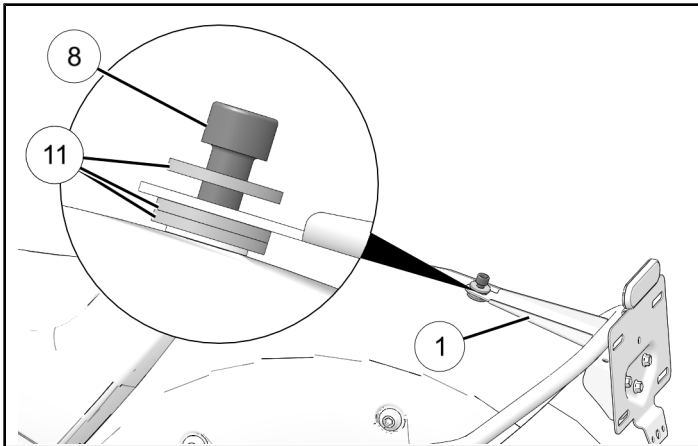

d. Torque upper center license plate bracket screw ⑧ to specification.

TORQUE

Upper License Plate Bracket Screw ⑧:
13 ft-lbs (18 N·m)

e. Torque four lower bracket screws ⑫ to specification.

TORQUE

Lower License Plate Bracket Screw ⑫:
88 in-lbs (10 N·m)

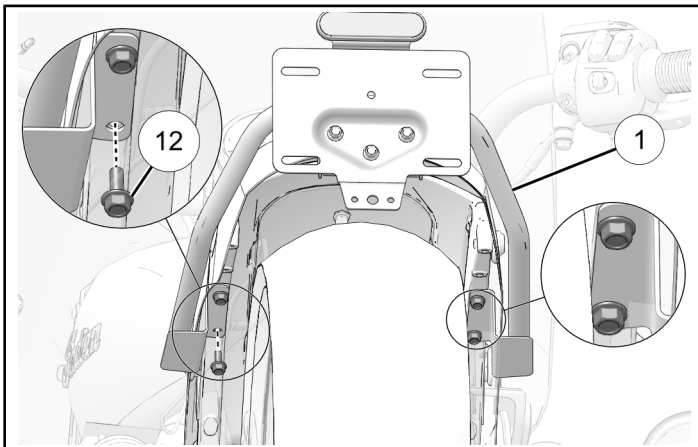

2. Driver and Passenger Seat Option

a. Install driver seat by inserting front tabs into place and lowering rear of seat into place.

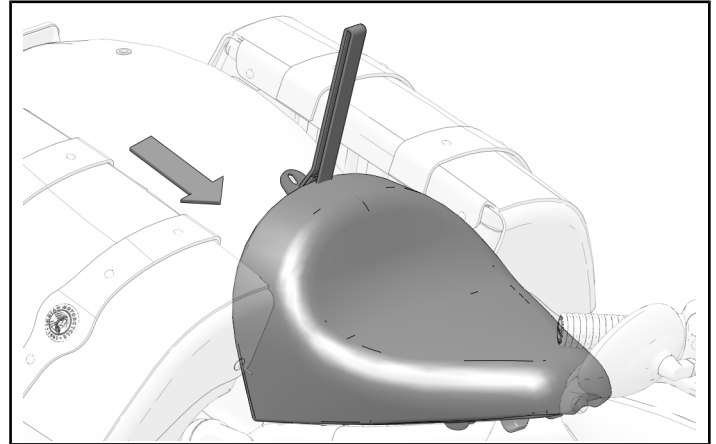

b. Attach driver seat with stud and washer. Torque to specification.

TORQUE

Driver Seat Stud:
13 ft-lbs (18 N·m)

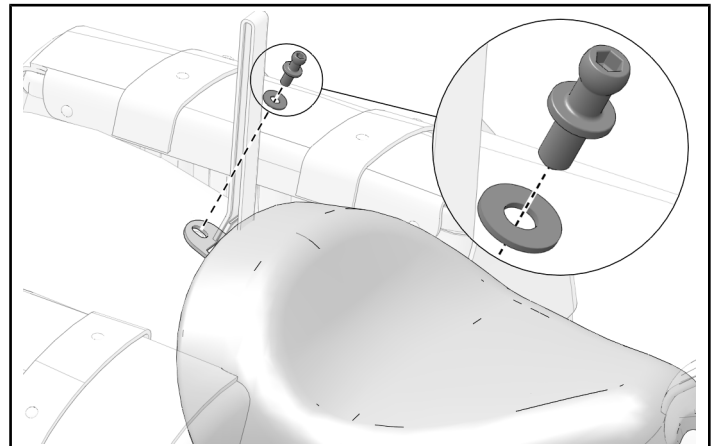

c. Remove and keep screw ⑧ and washer ⑪ from license plate bracket ①.

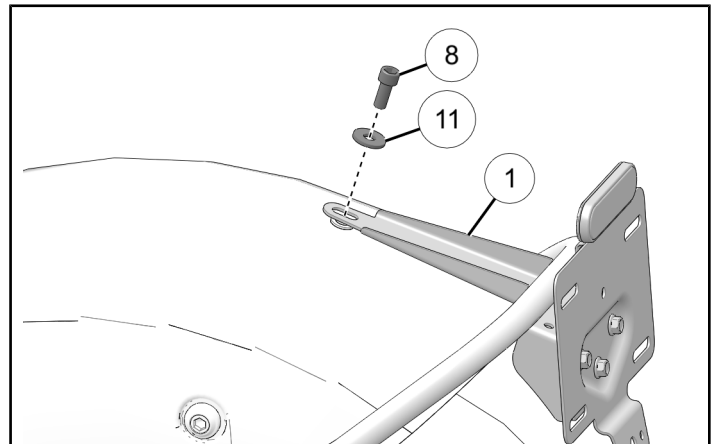

d. Pull strap through opening in passenger seat and lower seat onto stud.

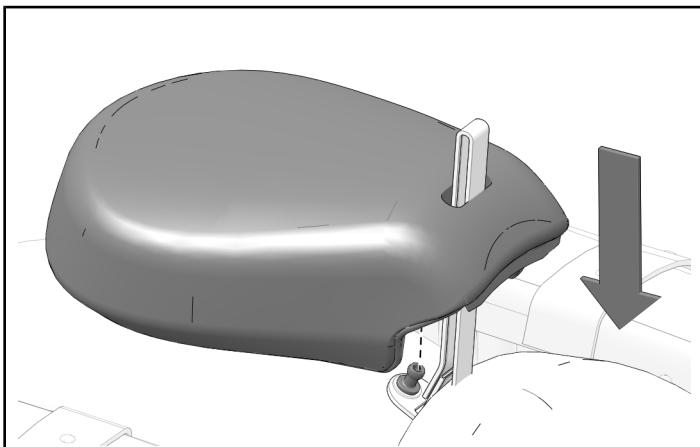

e. Attach passenger seat and center license plate bracket ① to fender with screw ⑧, washer ⑪ and seat washer ① in the top-down order listed.

- Screw ⑧
- Washer ⑪
- Center License Plate Bracket ①
- Passenger Seat Bracket
- Passenger Seat Plastic Washer ①

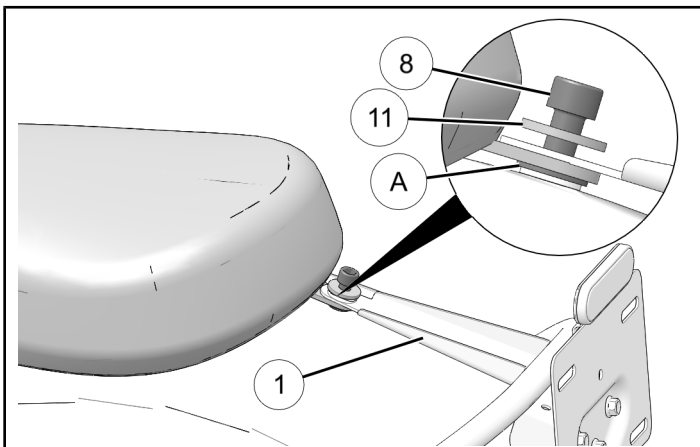

f. Torque upper center license plate bracket screw ⑧ to specification.

TORQUE

Upper License Plate Bracket Screw ⑧:
13 ft-lbs (18 N·m)

g. Torque four lower bracket screws ⑫ to specification.

TORQUE

Lower License Plate Bracket Screw ⑫:
88 in-lbs (10 N·m)

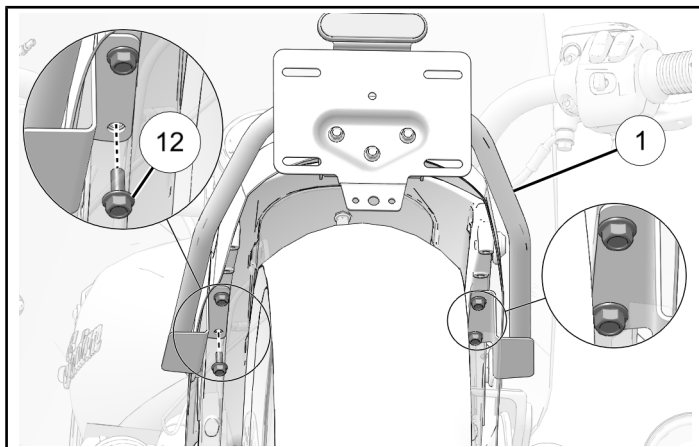

3. Solo Rack Installation (If Equipped)

a. Install driver seat by inserting front tabs into place and lowering rear of seat into place.

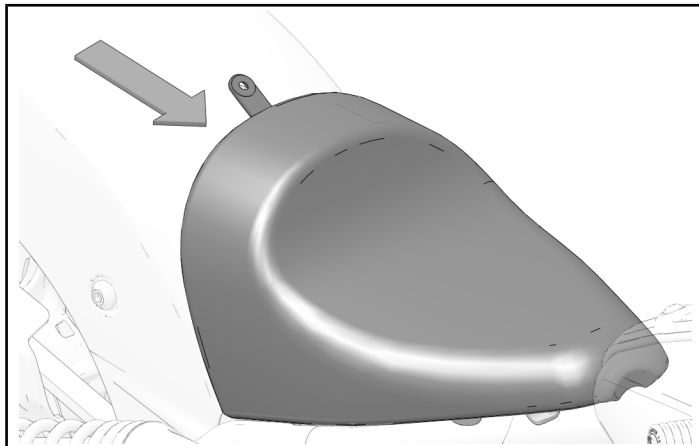

- b. Set solo rack in place with rear under license plate rack bracket and front over seat mounting bracket. Loosely install screw and washer to front mount.

DO NOT torque fasteners at this time.

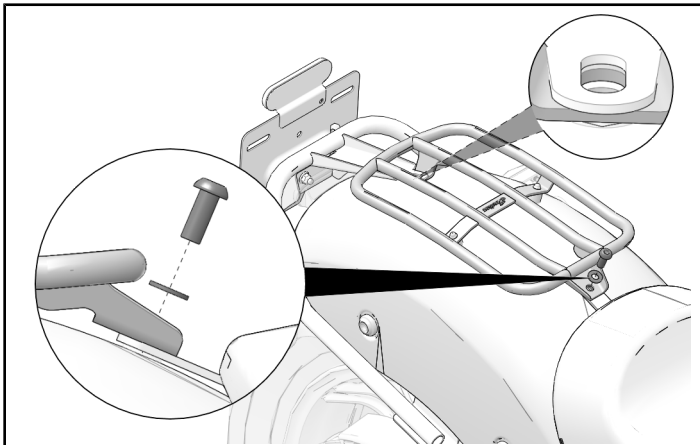

- c. Attach solo rack and center license plate bracket ① to fender with screw ⑧, washer ⑪ and solo rack washer ① in the top-down order listed.

- Screw ⑧
- Washer ⑪
- Center License Plate Bracket ①
- Solo Rack
- Solo Rack Washer ①

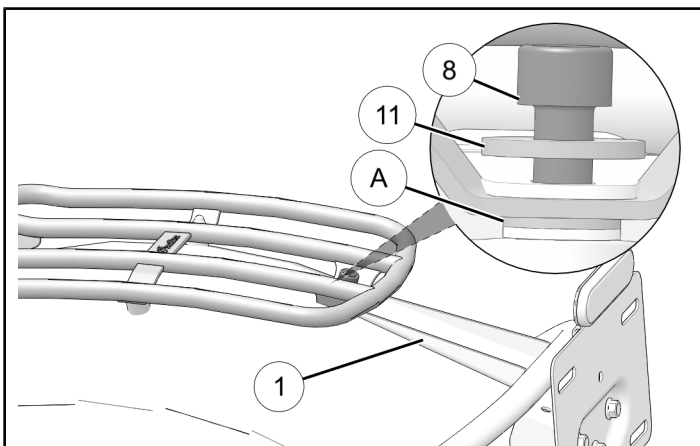

- d. Torque upper center license plate bracket screw ⑧ to specification.

TORQUE

**Upper License Plate Bracket Screw ⑧:
13 ft-lbs (18 N·m)**

- e. Torque four lower bracket screws ⑫ to specification.

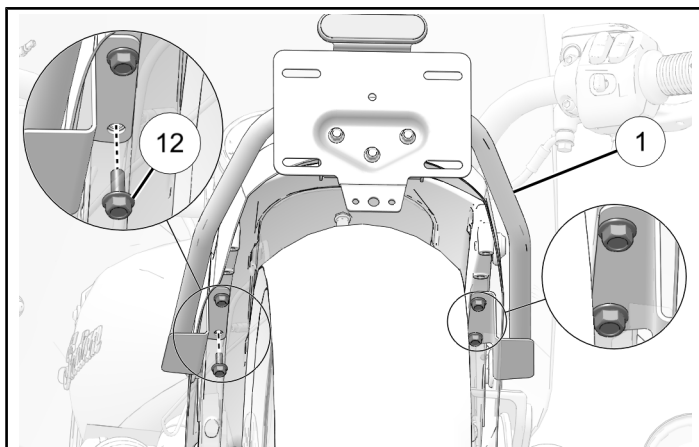

TORQUE

**Lower License Plate Bracket Screw ⑫:
88 in-lbs (10 N·m)**

LICENSE PLATE LIGHT INSTALLATION

1. Install retained license plate light harness through license plate bracket ④ and attach light with two retained nuts. Torque nuts to specification.

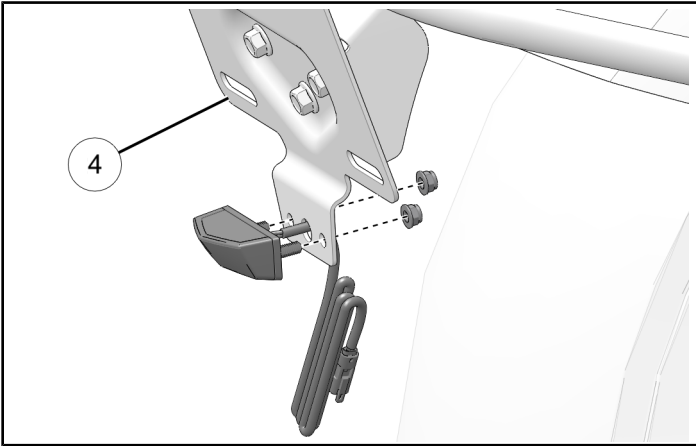

TORQUE

License Plate Light Nut:
17 in-lbs (2 N·m)

2. Loop wiring harness for license plate light and connect to harness extension ②.

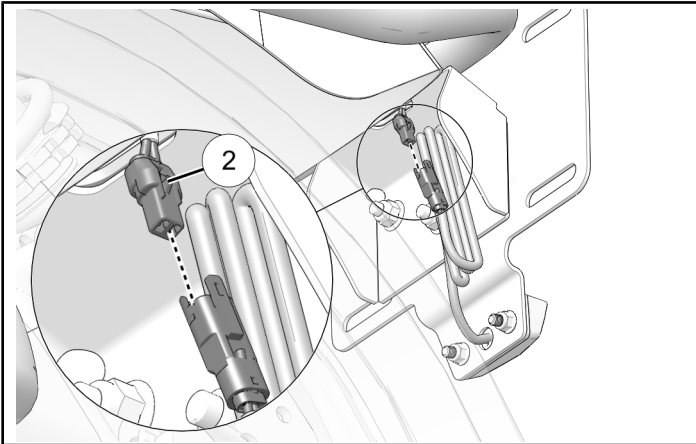

3. Attach looped harness to license plate bracket ① with routing clip ⑥.

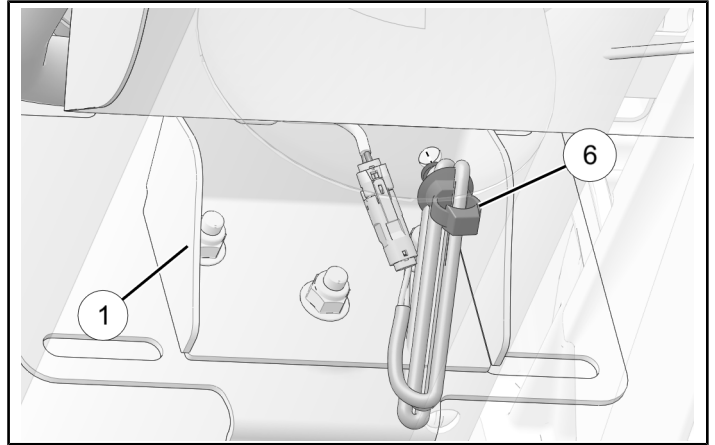

TURN SIGNAL INSTALLATION

NOTICE

Right hand rear turn signal shown. Left hand similar.

1. Install right rear turn signal into position and attach with two screws. Torque screws to specification.

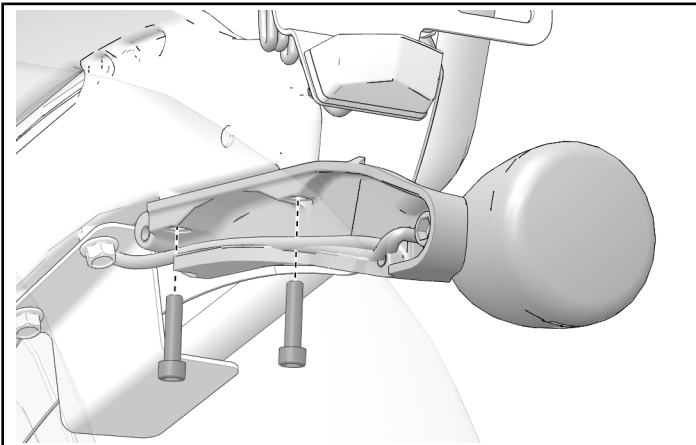

TORQUE

Turn Signal Mounting Screws:
9.5 ft-lbs (13 N·m)

2. Install wire channel cover and attach with two push pin rivets.

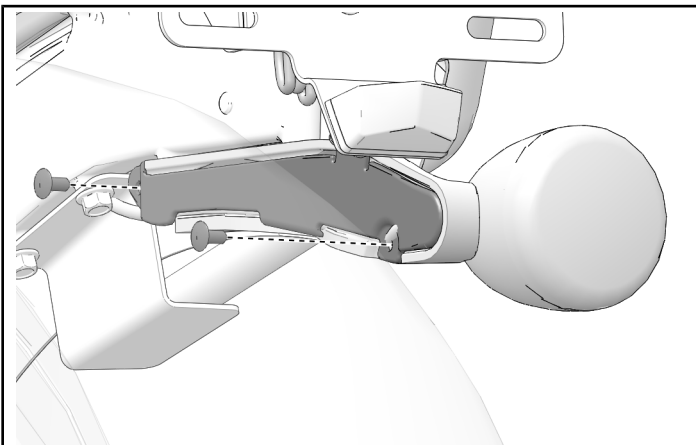

SADDLEBAG INSTALLATION

1. Set Saddlebag in place and loosely attach with two screws inside saddlebag.

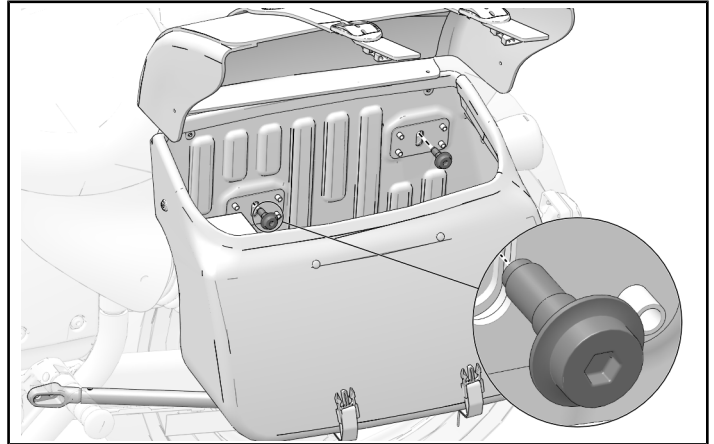

DO NOT torque fasteners at this time.

2. Install two screws to saddlebag support. Torque screws to specification.

TORQUE

Saddlebag Support Screws:
18 ft-lbs (25 N·m)

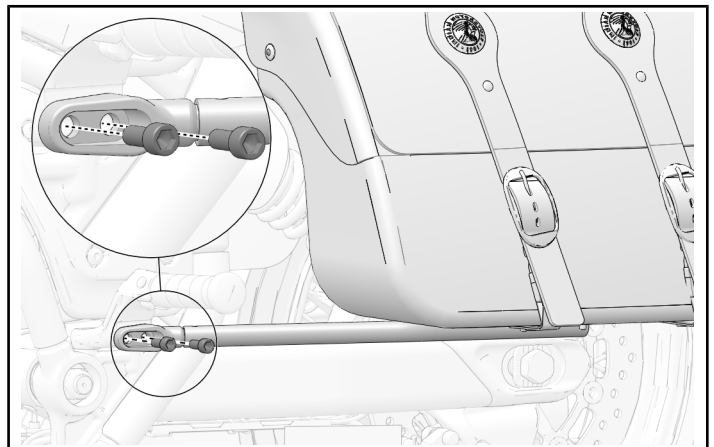

3. Torque saddlebag mounting screws to specification.

TORQUE

Saddlebag Mounting Screws:
13 ft-lbs (18 N·m)

4. Submit a Service Bulletin Warranty Claim for Indian Motorcycle® IDH-21-02.