

Campaign No. 2021050005 June, 2021

TO: ALL MERCEDES-BENZ & FREIGHTLINER CENTERS

SUBJECT: **Model 907 Sprinter, Model Year 2019-2020**
Install Additional Retaining Ring on
Brake Pedal Bracket

Mercedes-Benz AG (MBAG) the manufacturer of Mercedes-Benz and Freightliner vans, has determined that on certain platform 907 (VS30) Sprinter vehicles, the retaining washer on the bolt that connects the brake pedal to its bearing block could come loose. If the retaining washer comes loose, over time it could detach from the bolt, and in the worst case and with ongoing use of the brake pedal, the bolt may work its way out of the bearing block on one side. If this occurs, the brake lamp switch may become permanently activated even when the brake pedal is not pressed. If the brake lamps are permanently illuminated, it would not be possible for following traffic to determine the braking intention of the vehicle, which could increase the risk of a crash. An authorized Mercedes-Benz or Freightliner dealer will install an additional retaining ring on the bearing bracket of the brake pedal.

Prior to performing this Recall Campaign:

- Please check VMI to determine if the vehicle is involved in the Campaign and if it has been previously repaired.
- Please review the entire Recall Campaign bulletin and follow the repair procedure exactly as described.

Please note that Recall Campaigns **do not expire** and may also be performed on a vehicle with a vehicle status indicator.

Approximately **56,534** vehicles are involved.

Order No. V-RC-2021050005 This bulletin has been created and maintained in accordance with MBUSA-SLP S423QH001, Document and Data Control, and MBUSA-SLP S424HH001, Control of Quality Records.

Model 907, 910

Operation no. of the operation texts or standard texts and flat rates

Category	Op. no.	Operation text	Time	Damage Code	Code
L	02 1307	Operations: Additionally secure bearing bracket to brake pedal	0.2 hrs	29 911 53	VS3BREBO L
L	02 1309	Operations: Extra work for additionally securing bearing bracket to brake pedal for right-hand drive vehicles	0.4hrs	29 911 53	VS3BREBO L

Before/after

- 1 Brake pedal
- 4 Retaining ring

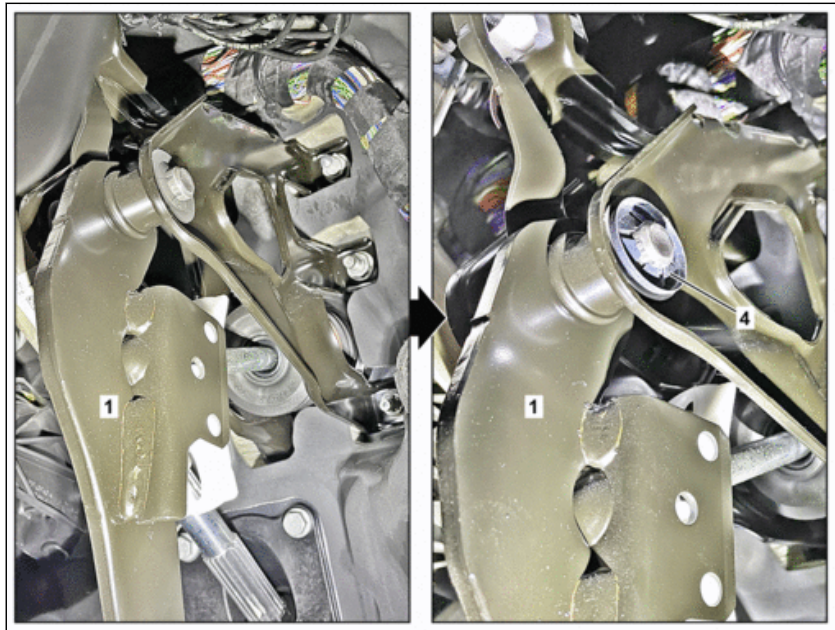



D29.10-A008-76

Shown on model 907.### 1# with automatic transmission

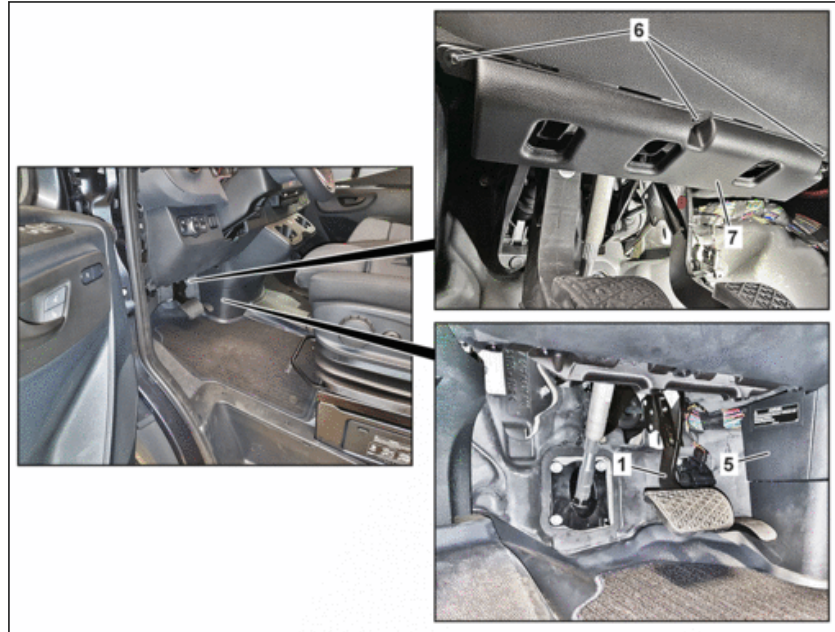



- 1 Brake pedal
- 5 Trim
- 6 Bolts
- 7 Trim



D29.10-A004-76

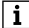

 Warning	Risk of injury. Moving parts can pinch, crush or, in extreme cases even sever extremities.	No parts of the body or limbs should be within the operating area of mechanical components when moving components.	AS00.00-Z-0009-01A
 Caution	Risk of injury caused by scraping or cutting body parts on sharp vehicle parts	Always wear protective gloves when working on or near sharp and non-deburred vehicle parts. Deburr repair panels.	AS00.00-Z-0017-01A
Topical note	Notes on carrying out repair work in the vehicle interior		AH68.00-N-0001-01S

	Check		
1	Check, whether the vehicle is affected by the measure.	<p>Affected vehicles: Additionally secure bearing bracket to brake pedal (code: VS3BREBOL, acc. no.: 29 911 53) Model 907.### #P as of 000484 up to 213294, 910.### #P as of 000484 up to 213294</p> <p>Affected vehicles: Additionally secure bearing bracket to brake pedal (code: VS3BREBOL, acc. no.: 29 911 53) Model 907.### #N as of 001834 up to 077403, 910.### #N as of 001837 up to 077596</p> <p> For authorized Mercedes-Benz service partners, only the entry in the Extended VEGA Application (EVA) system, in the "Current" tab, is decisive. An additional test of the affected vehicles in the workshop information system (WIS) or vehicle list is thereby not necessary.</p>	<p>SM29.10-D-0010-01AAB</p> <p>SM29.10-D-0010-01AAA</p>
Fabricate special tool			
2	Fabricate special tool.	<p> The tool is only to be fabricated once per workshop.</p> <p> Commercially available devices/ tools</p> <p>C-clamp Angular grinder Hacksaw</p>	Page 8
Remove			
3	Switch off ignition and store transmitter key outside of transmission range (min. 2 m).		
4	Remove trim (5).	<p>Model 907.### 1# , 910.### 1#</p> <p> The trim (5) can be unclipped without using a tool.</p>	
5	Remove trim (7).	<p>If installed.</p> <p> To do so, remove the screws (6).</p>	

6	Remove pedal bracket of brake pedal (1).	Model 910.### 2# If there is insufficient space for C-clamp.	AR29.10-D-4210TS
		 Remove pedal bracket far enough to enable the C-clamp to be positioned for installation of the retaining ring (4).	
	Retrofit retaining ring (4).		
7	Retrofit additional retaining ring (4) at bearing bracket of brake pedal (1).	Clip: Additionally secure bearing bracket to brake pedal (code: VS3BREBOL, acc. no.: 29 911 53)	GB29.10-D-0000-01A
	Install		Page 5
8	Install pedal bracket of brake pedal (1).	Model 910.### 2#	AR29.10-D-4210TS
			
9	Install trim (7).	If installed.  To do so, screw in screws (6).	
10	Install trim (5).	Model 907.### 1# , 910.### 1#	

Parts ordering note

Part no.	Designation	Quantity
	Commercially available C-clamp (opening dimension greater than 9.5 cm)	1
A 907 994 01 00	Retaining ring	1

SM29.10-D-0010-02SG	Retrofit additional retaining ring to bearing bracket of brake pedal (code: VS3BREBOL, acc. no.: 29 911 53)		
 Warning	Risk of injury. Moving parts can pinch, crush or, in extreme cases even sever extremities.	No parts of the body or limbs should be within the operating area of mechanical components when moving components.	AS00.00-Z-0009-01A
 Caution	Risk of injury caused by scraping or cutting body parts on sharp vehicle parts	Always wear protective gloves when working on or near sharp and non-deburred vehicle parts. Deburr repair panels.	AS00.00-Z-0017-01A
Topical note	Notes on carrying out repair work in the vehicle interior		AH68.00-N-0001-01S
		Clip: Additionally secure bearing bracket to brake pedal (code: VS3BREBOL, acc. no.: 29 911 53)	GB29.10-D-0000-01A

Model 907, 910

The following operation steps are shown on model 907.### 1# and must be performed analogously on model 907.### 2# and on model 910.### 1#.

pedal (1) is required in order to gain access to the bearing pin of brake pedal (1) and to provide space for positioning C-clamp (2).

On model 910.### 2# the method shown here differs slightly in that here, removal of the bearing bracket of brake

- 1 Select suitable socket wrench socket (3) for pressing in retaining ring (4).
 The socket wrench socket must fit flush in retaining ring (4). This prevents the tool from slipping off when retaining ring (4) is pressed on.
- 2 Position retaining ring (4) on socket wrench socket (3).

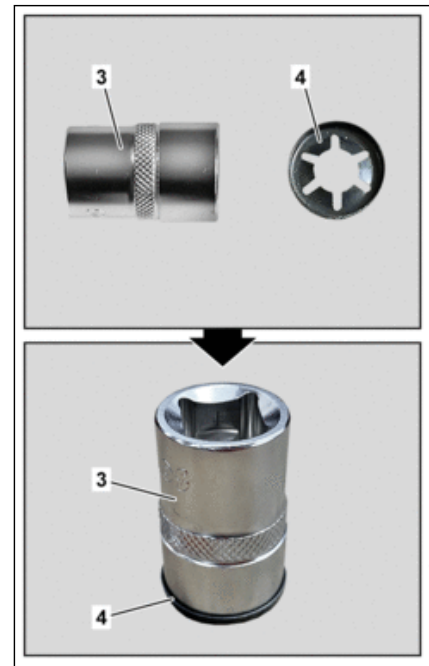

D29.10-A006-73

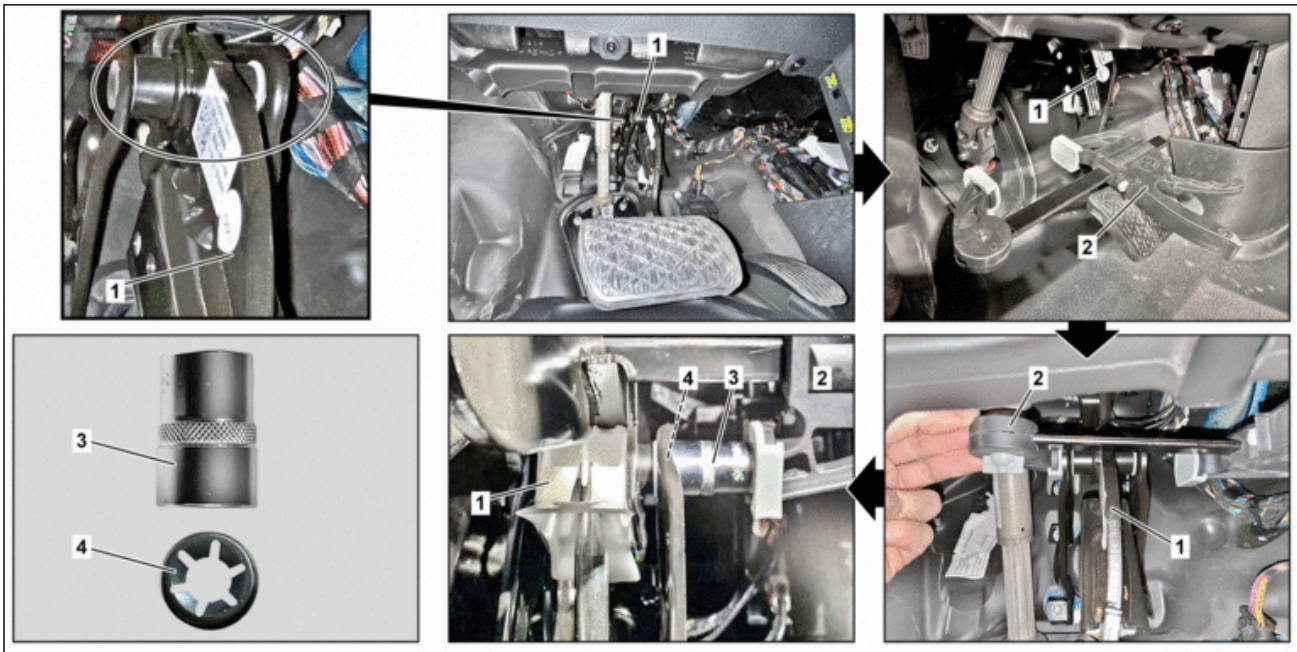

D29.10-A007-79

Shown on model 910.### 1# with automatic transmission

- 3 Place socket wrench socket (3) with retaining ring (4) and C-clamp (2) within easy reach in the footwell.



For operation steps 4 to 7, see content of GB document reference.

- 4 Place C-clamp (2) on bearing pin of brake pedal (1) as shown and position socket wrench socket (3) with retaining ring (4) between C-clamp (2) and bearing pin.
- 5 Operate C-clamp (2) and slowly press retaining ring (4) onto bearing pin of brake pedal (1) up to end stop.



During the process, constantly check whether socket wrench socket (3) is aligned along the same axis with the bearing pin.

- 6 Remove C-clamp (2) and socket wrench socket (3).

7

Check that retaining ring (4) is correctly seated.

If not fully pressed on,



Place tool in position again and repeat procedure.

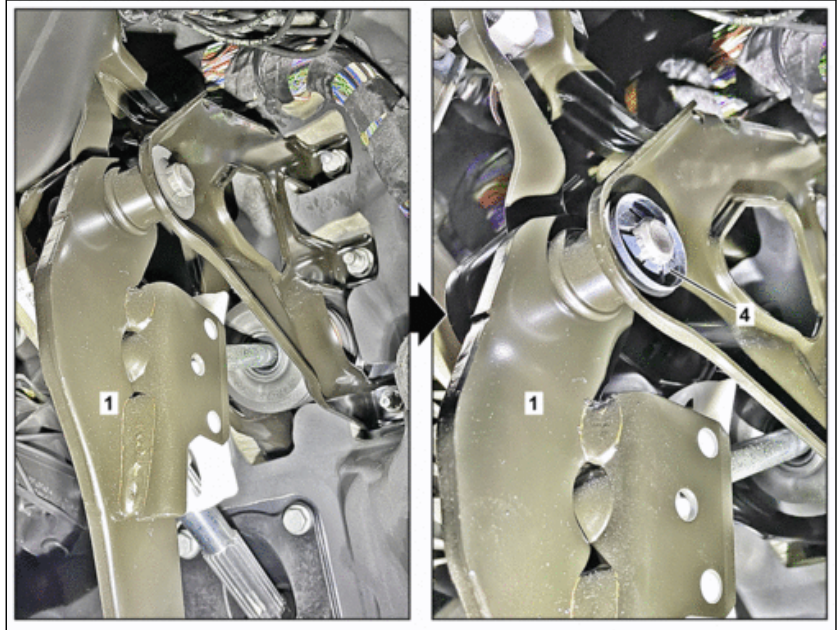

D29.10-A008-76

SM29.10-D-0010-03SG	Fabricate special tool (code: VS3BREBOL, acc. no.: 29 911 53)		
⚠ Caution	Risk of injury caused by scraping or cutting body parts on sharp vehicle parts	Always wear protective gloves when working on or near sharp and non-deburred vehicle parts. Deburr repair panels.	AS00.00-Z-0017-01A

Model 907, 910

The tool is **to be fabricated only once per workshop** and can be reused. Store tool accordingly. A commercially available C-clamp with an opening dimension greater than 9.5 cm can be used.

- 1 Open C-clamp (2).
i
 Open C-clamp (2) only until dimension (a) is approx. 9.5 cm.
- 2 Mark separation line for cut on C-clamp (2).
⬇
 Dimension (b) must be 2 cm.
 This means that there is sufficient clearance for extending and retracting the C-clamp (2).

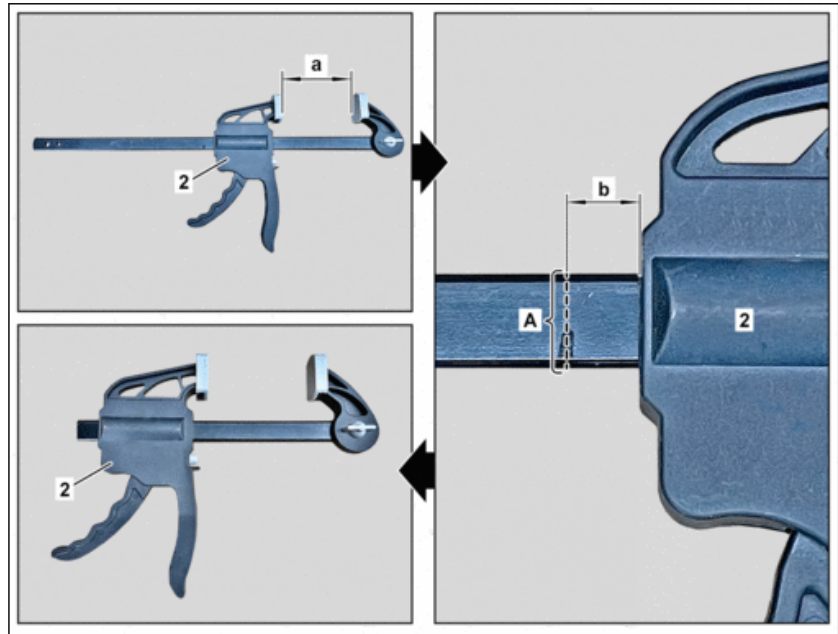

D29.10-A005-76

- 3 Cut off or saw off C-clamp (2) at separation line.
i
Commercially available devices/tools
 Angular grinder
 Hacksaw
- 4 Deburr cutting edge on C-clamp (2).