



## A-Frame Additional Support

<b>Bulletin Type:</b>	Technical Service Bulletin TSB	<b>Publication Date:</b>	April 23, 2021
<b>Bulletin #:</b>	20-025	<b>Make(s):</b>	Starcraft
<b>Job Code:</b>	9802517	<b>Model(s):</b>	GPS
<b>Flat Rate:</b>	1.5 Hours	<b>Model Year(s):</b>	2018

<b>Incident:</b>	Missing floor supports in the trailer frame could allow frame flexing that may cause cracks in the corner radius of the fiberglass.
<b>Affected Units:</b>	<b>2018 GPS Travel Trailer</b> J24A5050-5098 J24B5050-5116 J24L5050-5122 J24S5050 J24T5050-5113
<b>Parts:</b>	<b>Kit #: 20-025SC</b> <b>Contents:</b> 2 - CROSSMEMBER,C-CHN 3.00X1.50X1.50X.09XL14.00 16 GA Floor Support Channels
<b>Misc. Tools &amp; Supplies:</b>	C-Clamps & Tape Measure Grinder or Sander Steel Welder Wire Brush & Spray Paint (Black Rustoleum or Equivalent)

## INSPECTION

- Verify the VIN is in the TSB scope. All affected units require this remedy. #1
- Inspect unit for missing floor supports in frame and any signs of stress cracks at corner radius of fiberglass. #2





Step 1: Review instructions in their entirety, and ensure required tools and PPE are available before starting this repair.

Step 2: Obtain parts kit containing instructions and two floor support channels shown in picture #4.

Step 3: Confirm two floor support channels - 3" tall x 1 1/2" flange x 1/16" thick x 14" Length

Step 4: Measure placement of c-channels and prep area for welding by grinding or sanding paint from frame member.  
Picture #5



Step 5: Position c-channels equal distance between existing supports as shown in Figure 2. Raise the 3" c-channels upward and position flush to top of frames, bottom of floors as shown in section view Z-Z page 6. Clamp c-channels into position.

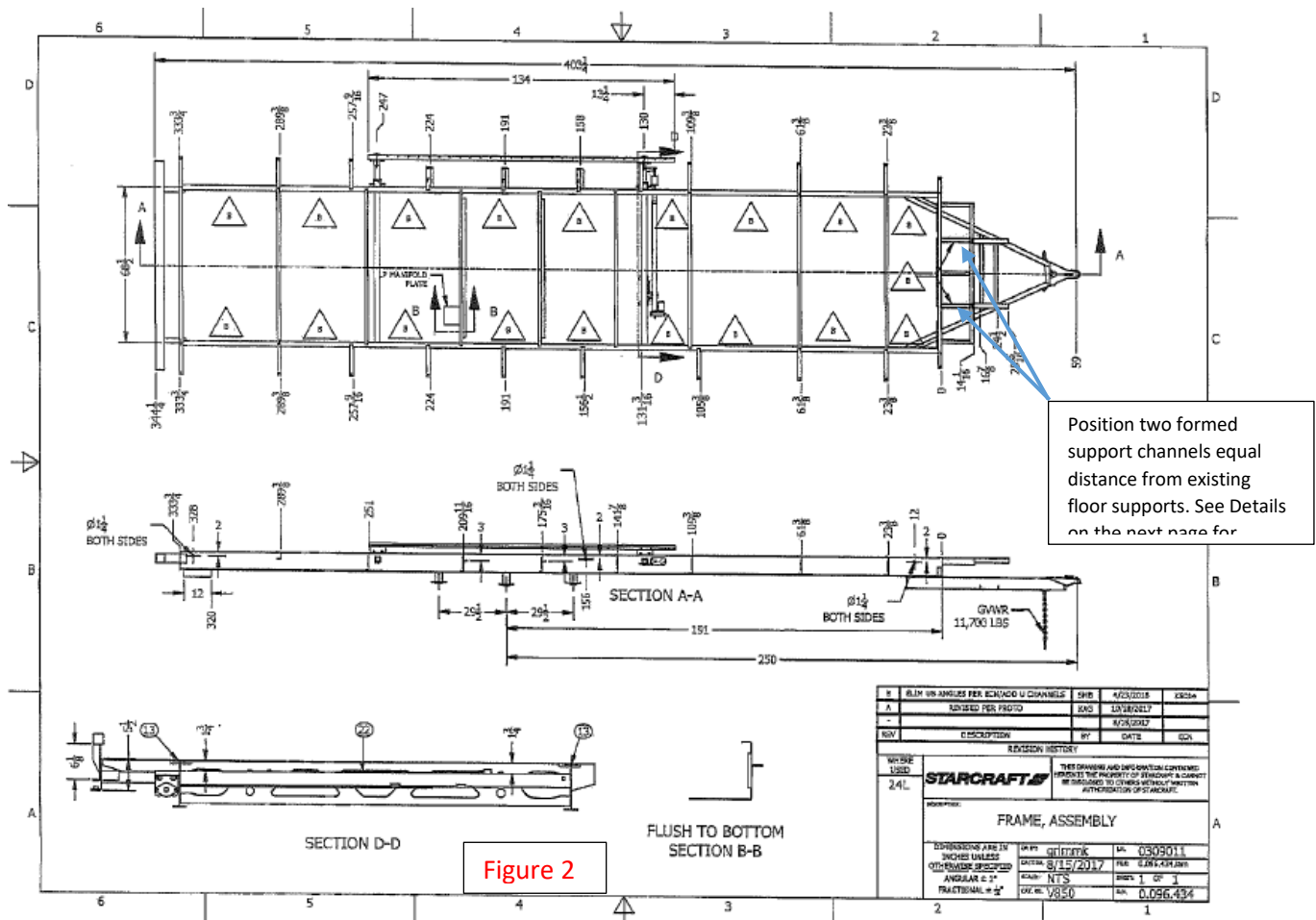

Step 6: Weld the two 3" c-channels into position as shown in figure 3 and section View Z-Z shown below.

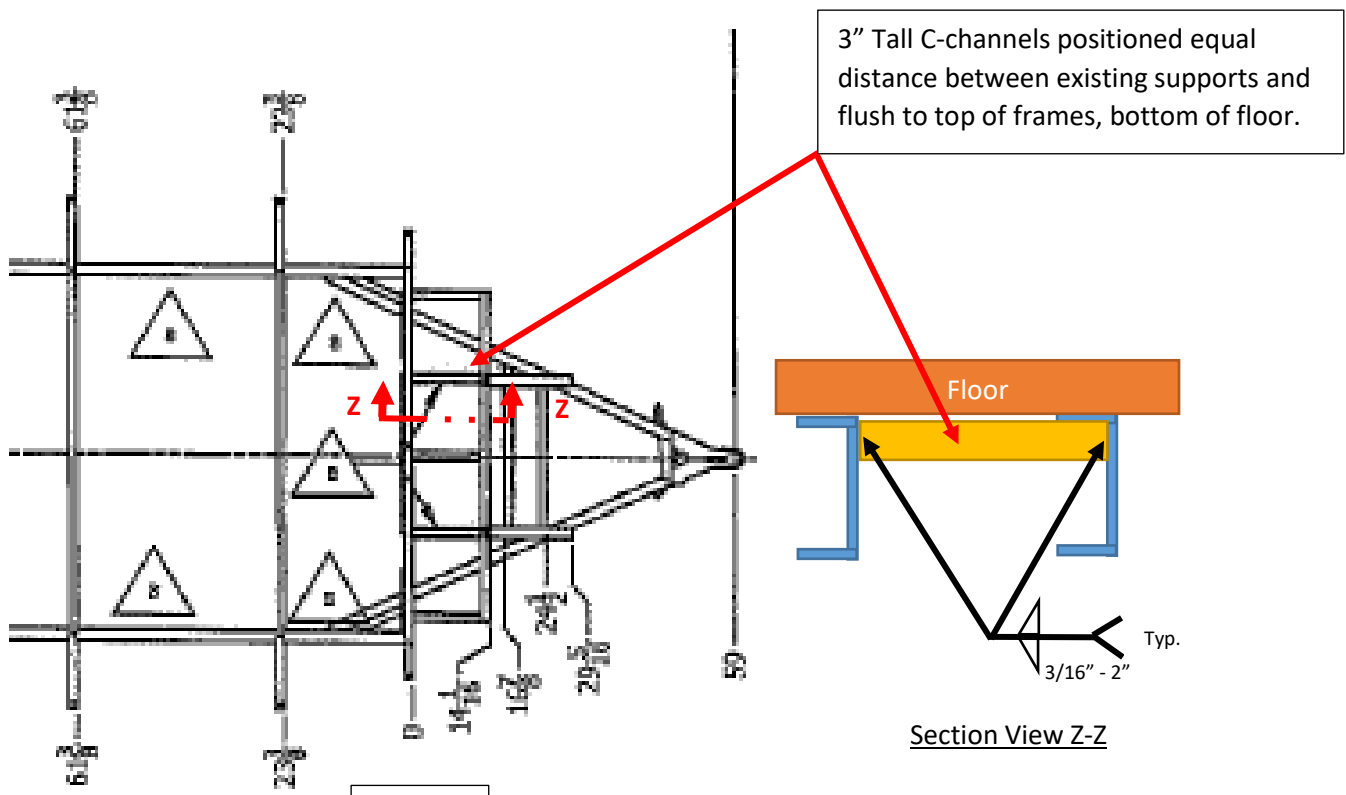

Figure 3



Step 7: After welding is complete, wire brush weld area (both channels) to remove all weld slag #6, #7.

Step 8: Touch up bare metal with a Rustoleum spray paint or equivalent. Allow to dry and apply two coats.  
#8



Step 9: If fiberglass is stress cracked submit a pre authorization request to perform a fiberglass repair.

Step 10: Prepare and submit your claim showing TSB as completed.

*Jayco's sole obligation under our limited warranty is to repair or replace defective materials and/or workmanship deemed our responsibility as determined by Jayco in our sole discretion. Jayco reserves the right to use new and/or remanufactured parts or materials of similar quality to complete any work, and to make parts and/or design changes as appropriate without notice to anyone. Jayco designs and/or materials changes are done without obligation to incorporate such changes in previously manufactured product. Jayco makes every reasonable effort to ensure field remedies will not adversely affect performance and/or safety of the unit. This field remedy is not intended to extend to future performance of this RV, or any of its materials, components or parts beyond the standard warranty period. The RV owner's obligation to notify Jayco, or one of its independent, authorized dealers, of a claimed defect does not modify any obligation placed on the RV owner to contact Jayco directly when attempting to pursue remedies under state or federal law. Jan. 2019.*

903 South Main Street • P.O. Box 460 • Middlebury, IN 46540