



## Thor Motor Coach Technical Service Bulletin

TSB #	<b>TSB 21-02</b>		
Description/Title:	<b>VS/XS 24.3 Gray Tank Securement</b>		
Affected Product Line(s):	<b>Certain model year 2021 24.3 Axis and Vegas motorhomes</b>		
Service Campaign # :	<b>RC000215</b>	Released Date:	<b>3/24/2021</b>
Codes:	<b>Inspect Only: TMCTS80266Y</b>  <b>Inspect &amp; Repair: TMCTS80266W</b>	Document Date:	<b>3/24/2021</b>
Time Allowed:	<b>Inspect Only: 0.1</b>  <b>Inspect with Repair: 0.4</b>	Document Revision:	<b>A</b>

**Issue:**

The steel tube backer in the coach floor may not have been installed in the correct location to adequately secure the gray water holding tank underneath the 2021 24.3 Axis & Vegas motorhomes.

This procedure is to be used to add a “Z” bracket to the bottom of the rear-most cross member in the chassis of the 24.3 Axis/Vegas product. This new bracket is intended to replace the “Z” brackets that are currently installed near the top of the tank above the cross member because of inadequate backer in the unit floor.

**Tools Required:**

Screw Gun  
3/8” Drive Bit and Extension

**Part(s) Required:**

**TMC Kit # 0497081**

Kit Includes:  
Z-Bracket (TFM7247)  
Darco Tape  
(3) J-brackets



## Thor Motor Coach Technical Service Bulletin

### **Instructions:**

#### **Inspection:**

1. Verify that motorhome has the correct sized Z-bracket screwed into the chassis cross-member supporting the gray tank. It is a possibility that on some coaches the incorrect Z-bracket was installed during production. Confirm that the bracket is 12" wide as show on TFM7247 (See page #4).

If the currently installed Z-bracket is less than 12" wide, please continue onto Step 2 for repair procedure.

If a 12" Z-bracket is installed, the inspection is complete and the repair is not needed.

#### **Repair:**

1. Place new "Z" bracket (TFM7247) against bottom of cross member. The 12 x 2-1/4" face of the bracket with holes in it should be on the bottom of the cross member with the bottom of the "Z" going rearward on the unit towards the back of the tank. The bracket should be approximately centered from side to side on the unit.
2. Screw through the holes in the "Z" bracket into the bottom of the cross member through all four holes provided in the bracket. Use (4) 1/4" hex head self-tapping screws 3/4" long for this.
3. After new "Z" bracket is installed, remove any existing brackets that are screwed to the main unit floor along the front side of the tank. (Note the brackets on the rear side of the tank are to remain installed.) Discard removed brackets. Use Darco tape or black sealant to cover/fill any holes in the main floor where these brackets were installed initially. (Be sure to clean the Darco surface on the bottom of the floor before applying the tape over the holes.)
4. Confirm that rear side of tank is secured with new J-brackets in 3 places and that (3) 1/4" hex head self-tapping screws 3/4" long are used in each J-bracket.

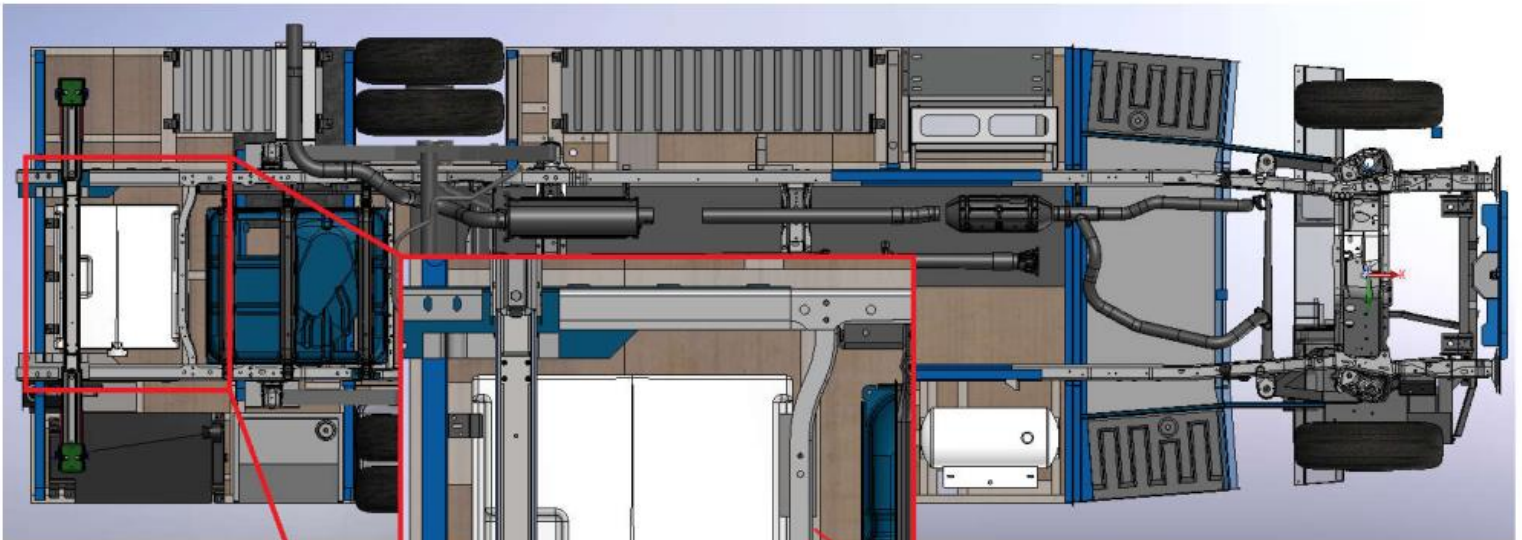

**VIEW FROM BOTTOM SIDE OF COACH.  
BOTTOM OF FLOOR IS TRANSPARENT IN THIS VIEW TO SHOW FRAMING.  
THESE TUBES IN THE FLOOR WERE OUT OF POSITION.**

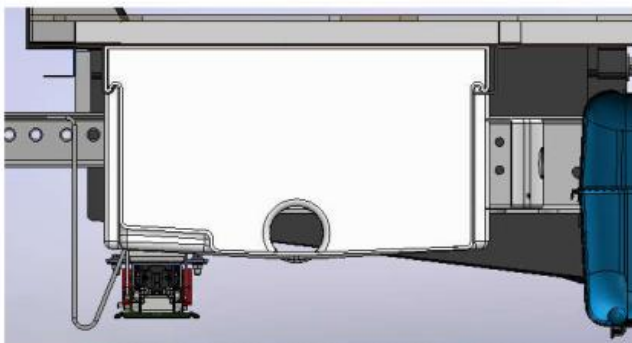

**SECTION VIEW SHOWING HOLDING TANK IN POSITION ON  
COACH WITH ORIGINAL HARDWARE INSTALLED.**

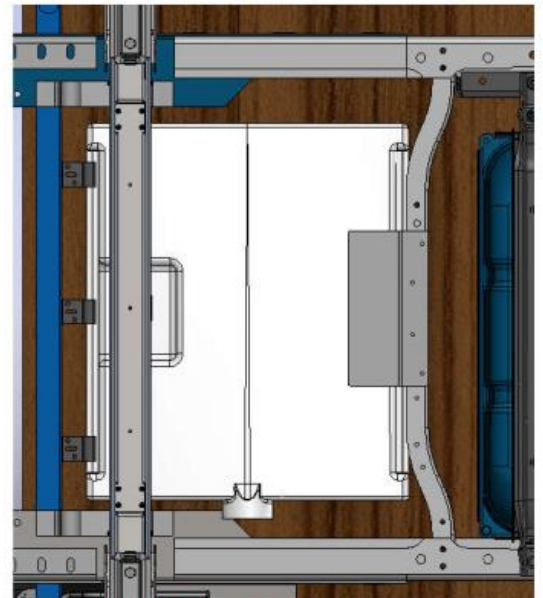

**IN THIS VIEW THE ORIGINAL BRACKETS ARE  
REMOVED AND REPLACED WITH TFM7247**

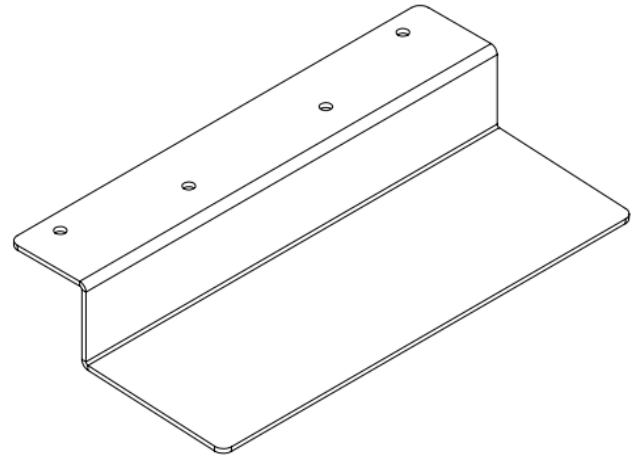
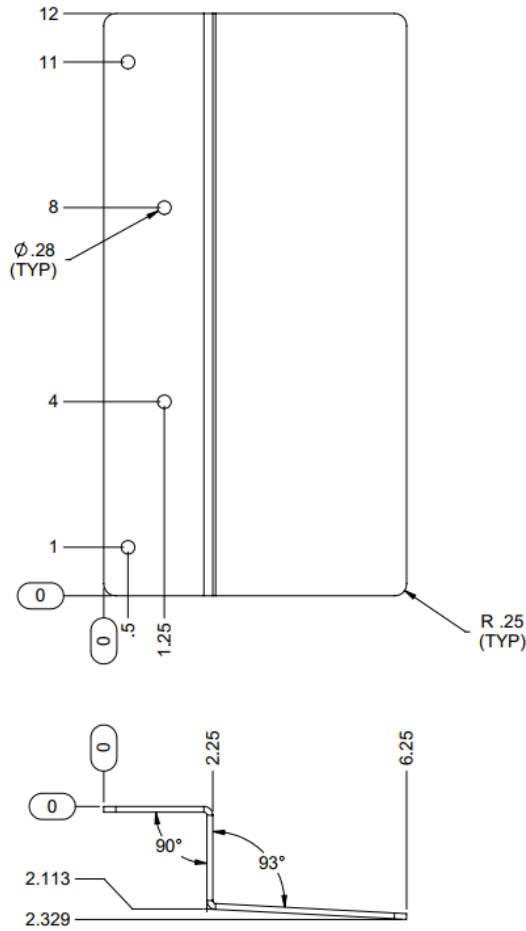

REV	DESCRIPTION	DATE	BY	ECN	ALL DIMENSIONS ARE OUTSIDE FORM MATERIAL: ASTM A1011 SS GRADE 306 MATERIAL THICKNESS: 11GA WELD TYPE: N/A FINISH: P.C. BLACK LASER CUT RADII: MIN, U.N.O. BEND RADII: .063"	THOR MOTOR COACH				
-	INITIAL RELEASE	2/10/2021	ZAW			DRAWN BY ZAW	SHEET 1	OF 1	DATE 2/10/2021	
						DESCRIPTION BRACKET, Z, TANK				
						MODEL 24.3 AXIS/VEGAS				
						TOLERANCE: SHEAR AND FORM: ± .030 HOLE LOCATIONS: ± .015 HOLE DIAMETERS: ± .005 ANGULAR: ± 1° FLATNESS: ± .125/5 FT		DRAWING NUMBER TFM7247		REVISION -