

## Model Series 167 - Seat Adjustment - Various Customer Complaints

---

Topic number	LI91.12-P-072069
Version	1
Function group	91.12 Rear seats
Date	12-18-2020
Validity	V/X 167 low lock code 567 (Rear seats, electrically adjustable)
Reason for change	
Reason for block	

---

### Complaint:

1. Front seat moves forwards (fore/aft adjustment) when the seat backrest is adjusted backwards. Only occurs if the seat backrest of the second seat row is folded over (video point 1).
2. Front seat backrest adjusts to the vertical position when the front seat is adjusted backwards (fore/aft adjustment). Only occurs if the seat backrest of the second seat row is folded over (video point 2).
3. Front seat moves forwards (fore/aft adjustment) when the seat backrest of the second seat row is folded over or the Easy Entry and exit feature is activated for the third seat row (videos point 3).
4. Front seat can no longer be adjusted backwards (fore/aft adjustment) when the second seat row is folded over.

Attachments	
File	Description
Video point 1.MOV	Video point 1
Video point 2.MOV	Video point 2
Video point 3 Easy Entry.MOV	Video point 3 Easy Entry
Video point 3 seats folded.MOV	Video point 3 seats folded

### Cause:

1. - 3.: Series production configuration in order to prevent collision with the head restraints on the second seat row.  
If the problem occurs when the seat backrest is not folded over, the cause is an unlocked second seat row  
(The head unit message "Rear backrest not locked" is displayed when all the doors are closed and the ignition is on).
4. If the second seat row has been folded over using the emergency release (red strap), the front seats are in the emergency position and consequently have only a limited adjustment range.

### Remedy:

- 1.-3.: Series production configuration (seat backrest of second seat row folded over).
- 1.-2.: (Seat backrest of second seat row not folded over):

# XENTRY TIPS

- Reset the emergency release: pull the red strap and release it again.
- Check microswitch mounting (see attachments). If the microswitch mounting is loose, install a new holder. The microswitch mounting is located under each seat frame base (40% / 60% side) on the left-hand side when viewed in the direction of travel.
- If the two steps described above are processed without success, create a TIPS case, read out the seat control unit logs, including "Add on 16503" and attach to the case.

4. Fold over the second seat row using the switch in the trunk.

Attachments	
File	Description
Microswitch.jpg	Microswitch
Microswitch 60% side_View direction of travel.jpg	Microswitch 60% side_View direction of travel
Microswitch 60% side_View against direction of travel.jpg	Microswitch 60% side_View against direction of travel

Symptoms
Body / Seat / Seat adjustment / Function error

Parts						
Part number	ES1	ES2	Designation	Quantity	Note	EPC
A 167 921 81 00			Microswitch holder	1		X

Validity		
Vehicle	Engine	Transmission
GLE (167)	*	*
GLS (167)	*	*

## Attachments

Microswitch.jpg:

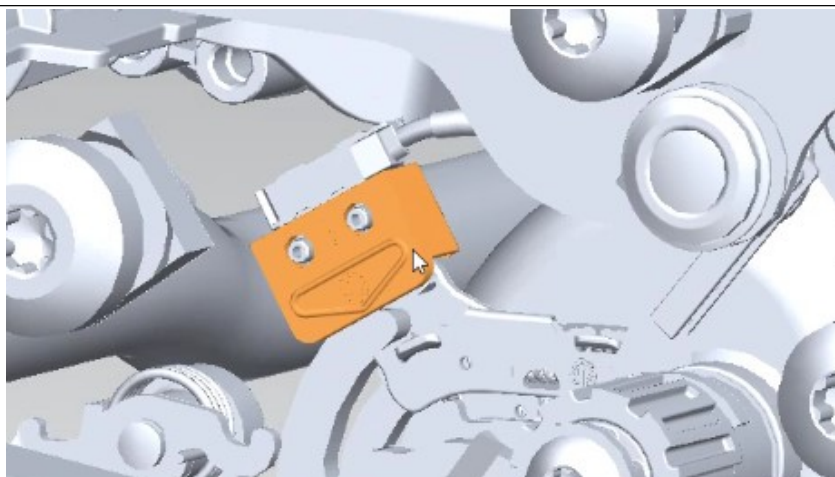

# XENTRY TIPS

---

Microswitch 60% side\_  
View direction of travel.  
jpg:

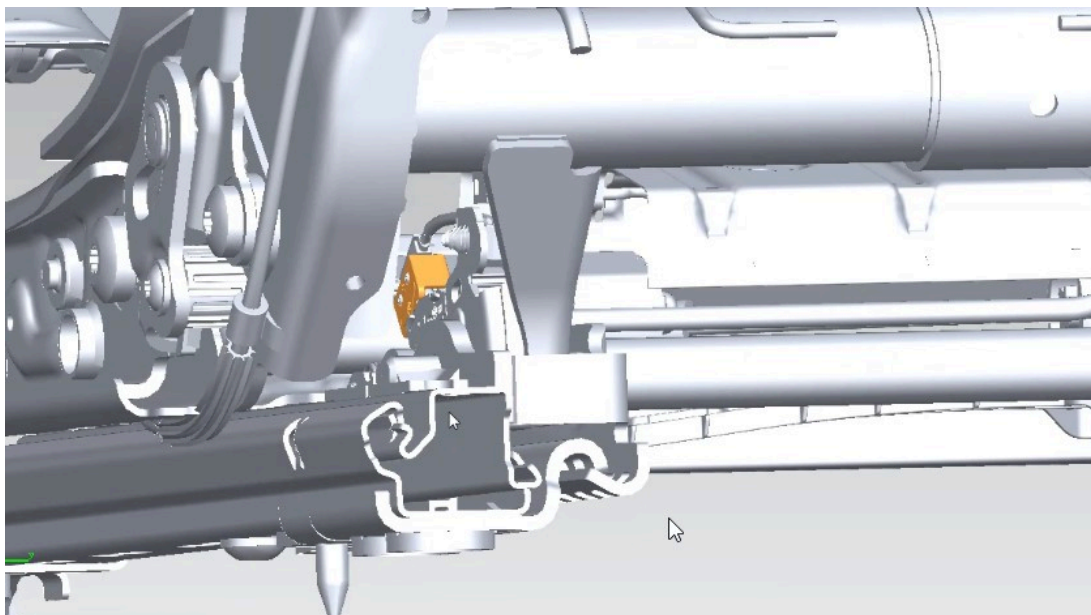

Microswitch 60% side\_  
View against direction of  
travel.jpg:

