



NUMBER: 23-022-20

GROUP: 23 - Body

DATE: August 20, 2020

This bulletin is supplied as technical information only and is not an authorization for repair. No part of this publication may be reproduced, stored in a retrieval system, or transmitted, in any form or by any means, electronic, mechanical, photocopying, or otherwise, without written permission of FCA US LLC.

This Service Bulletin is also being released as Rapid Response Transmittal (RRT) 20-047, dated August 20, 2020. All applicable Sold and Un-Sold RRT VINs have been loaded. To verify this RRT service action is applicable to the vehicle, use VIP or perform a VIN search in DealerCONNECT/Service Library. All repairs are reimbursable within the provisions of warranty.

SUBJECT:

Paint Delamination on Front Door Panel Pull Cups (Door Pulls)

OVERVIEW:

This bulletin involves replacing both the front door panel pull cups due to paint delamination.

MODELS:

2020 (B1) Jeep Renegade

NOTE: This bulletin applies to vehicles within the following markets/countries: LATAM.

NOTE: This bulletin applies to vehicles built on or after August 29, 2019 (MDH 0829XX) and on or before March 20, 2020 (MDH 0320XX).

SYMPTOM/CONDITION:

The customer may describe paint peeling on the left, right, or both front door panel pull cups.

DIAGNOSIS:

If a customer's VIN is listed in VIP or your RRT VIN list, perform the repair.

PARTS REQUIRED:

Qty.	Part No.	Description
1	6FJ85LXHAA (MOPAR) 735652375 (LATAM)	Pull-Cup Right Side
1	5UW85LXHAA (MOPAR) 735603977 (LATAM)	Pull-Cup Left Side

REPAIR PROCEDURE:

NOTE: Procedure is the same for both front doors on the vehicle.

Both pull caps must be replaced as a pair, do not replace just one.

1. Open the door.
2. Remove the pull cup rubber mat (Fig. 1) from the pull cup.
3. Remove the screw holding the pull cup to the door panel (Fig. 1) .

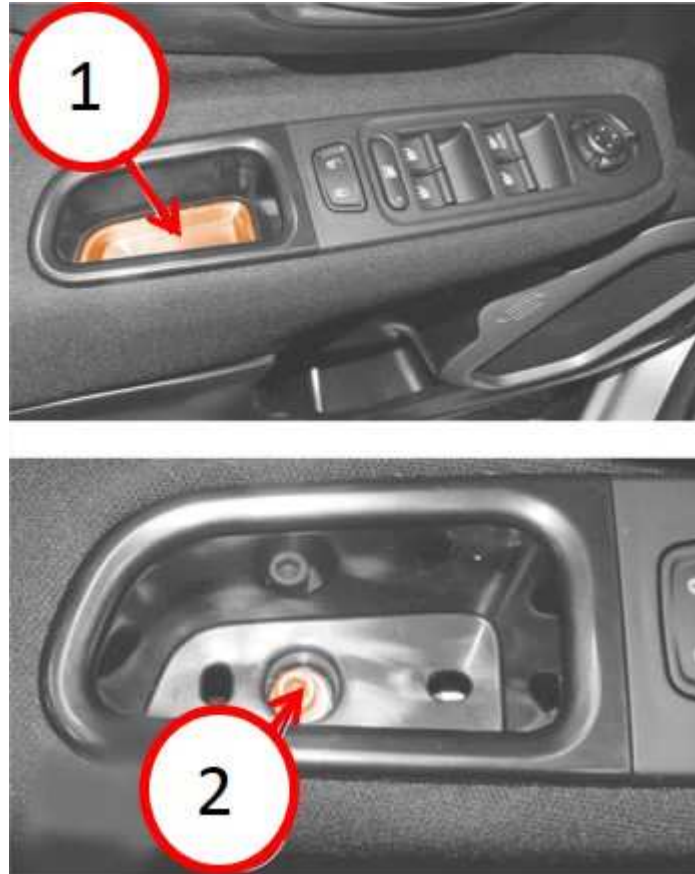

Fig. 1
Rubber Mat and Pull Cup

- 1 - Rubber Mat
2 - Screw
-

4. Remove and discard the pull cup from the door panel.
5. Install the new pull cup on the door panel.
6. Install the screw on the pull cup. Tighten screw securely.
7. Install the pull cup rubber mat in the pull cup.
8. Repeat the procedure for the other side.
9. Close the door.

POLICY:

Reimbursable within the provisions of the warranty.

TIME ALLOWANCE:

Labor Operation No:	Description	Skill Category	Amount
23-20-23-90	Cup Pull, Replace Both Sides (0 - Introduction)	6 - Electrical and Body Systems	0.2 Hrs.

FAILURE CODE:

ZZ	Service Action
----	----------------