

Removable Front Tow Hook Changes (WST176)

Thursday, August 20, 2020

Effective: Chassis Starts on November 9, 2020

Removable Front Tow Hooks Stored on the Chassis Frame (558-033) will be replaced by *Removable Front Tow/Recovery Device Stored on the Chassis Frame (558-070)* for Western Star 4700 and 5700 models effective with chassis start dates as noted.

The new tow device is a closed loop instead of a hook and includes a newly designed mounting bracket. With respect to vehicle towing and recovery, the towing receptacles in the front frame assembly will work with both the old tow hook and the new tow loop. The attached image shows the old tow hook versus the new tow loop and their respective mounting bracketry.

Truck Change Orders will be issued; there is no pricing impact.

Attachment: TOW_HOOK_VS_LOOP_gs.pdf

Ben Smith

Customer Application Engineering Manager

Western Star Trucks

benjamin.smith@daimler.com

Daimler Trucks North America

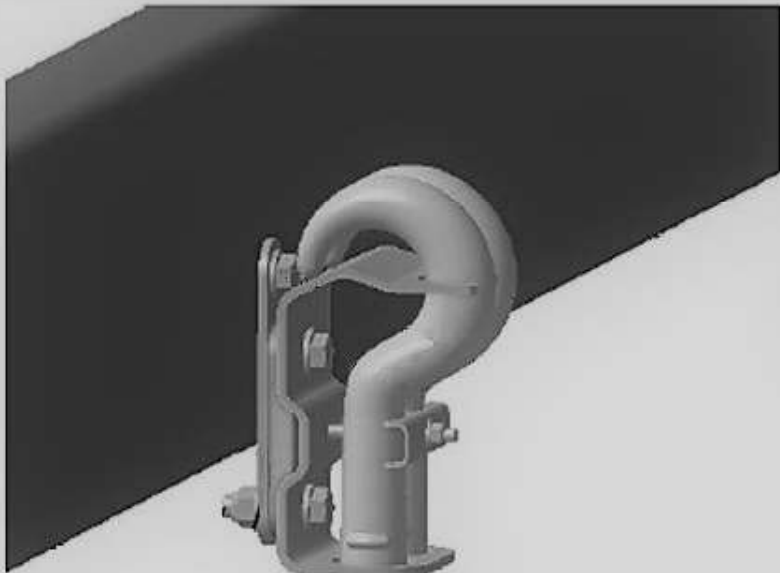

*Removable Tow Hook
(Discontinued)*

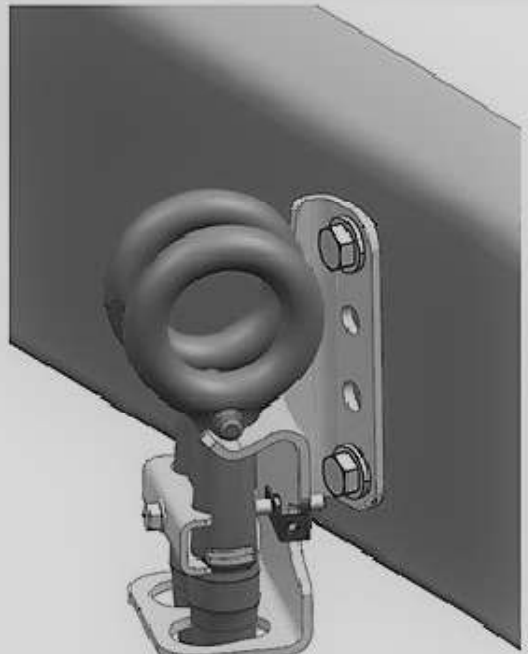

*Removable Tow/Recovery Device (Loop)
(New)*