

Service Alert

Mazda North American Operations
Irvine, CA 92618-2922



Subject: CX-30 SERVICE CAUTIONS FOR NEW AND REVISED FEATURES	Service Alert No.: SA-013/20
	Last Issued: 12/18/2020

BULLETIN NOTES

This Service Alert supersedes the previously issued bulletin(s) listed below. The changes are noted in Red text.

Previous Service Alerts:	Date(s) Issued:
SA-013/20	11/16/20, 02/28/20, 02/06/20, 1/24/20 and 1/15/20
SA-051/19	12/18/19, 12/13/19, and 12/03/19

APPLICABLE MODEL(S)/VINS

2020-2021CX-30

DESCRIPTION

The CX-30 has new and revised features that are different from previous models, and may be difficult to understand. This Service Alert provides valuable information to support potential dealer and customer concerns.

Index

- [PDI fuse](#)
- [Commander Switch Inoperative](#)
- [Auxiliary Key](#)
- [Connected Vehicle](#)
- [Connected Vehicle Maintenance Mode](#)
- [Mazda Connected Vehicle Viewer \(MCVV\)](#)
- [Off-Road Traction Assist](#)
- [Apple CarPlay™ / Android Auto™ Activation](#)
- [Blind Spot Monitoring System \(BSM\)](#)
- [Front Wiper Service Caution](#)
- [i-ACTIVSENSE Switch](#)
- [Traffic Sign Recognition\(TSR\) \(2021 CX-30\)](#)

Page 1 of 32

CONSUMER NOTICE: The information and instructions in this bulletin are intended for use by skilled technicians. Mazda technicians utilize the proper tools/equipment and take training to correctly and safely maintain Mazda vehicles. These instructions should not be performed by "do-it-yourselfers." Customers should not assume this bulletin applies to their vehicle or that their vehicle will develop the described concern. To determine if the information applies, customers should contact their nearest authorized Mazda dealership. Mazda North American Operations reserves the right to alter the specifications and contents of this bulletin without obligation or advance notice. All rights reserved. No part of this bulletin may be reproduced in any form or by any means, electronic or mechanical---including photocopying and recording and the use of any kind of information storage and retrieval system ---without permission in writing.

[Excessive Speed Warning](#)
[Traffic Jam Assist\(2021 CX-30\)](#)
[MAZDA CONNECT Power Function](#)
[MAZDA CONNECT Center Display View](#)
[In-Vehicle Digital Owner's Manual](#)
[Navigation System](#)
[SIRIUSXM Data Service](#)
[Power Door Locks](#)
[Walk-Away Auto Lock Function](#)
[Transmitter Battery Saving Function](#)
[Keyless Entry Using Auxiliary Key](#)
[Rear Door Child Safety Locks Operation](#)
[Theft-Deterrent System](#)
[Link Seat & Climate Control Temperatures](#)
[Seat Warmer Inoperative](#)
[Electric Parking Brake \(EPB\)](#)
[Tire Pressure Monitoring System \(TPMS\)](#)
[Condition Based Maintenance](#)
[M-MDS \(MDARS\)](#)
[Part Replacement](#)
[Web-Based Training Courses](#)

Item	Service Information
------	---------------------

CONSUMER NOTICE: The information and instructions in this bulletin are intended for use by skilled technicians. Mazda technicians utilize the proper tools/equipment and take training to correctly and safely maintain Mazda vehicles. These instructions should not be performed by "do-it-yourselfers." Customers should not assume this bulletin applies to their vehicle or that their vehicle will develop the described concern. To determine if the information applies, customers should contact their nearest authorized Mazda dealership. Mazda North American Operations reserves the right to alter the specifications and contents of this bulletin without obligation or advance notice. All rights reserved. No part of this bulletin may be reproduced in any form or by any means, electronic or mechanical---including photocopying and recording and the use of any kind of information storage and retrieval system ---without permission in writing.

Fuse to be Installed at PDI

Most vehicles have 1 fuse removed at the factory. Some vehicles have 2 fuses removed that must be installed at PDI.

1. All vehicles - Fuse F27 (25A) is removed from the engine compartment fuse block and is stored at the engine compartment fuse block lid.
2. Some vehicles - Fuse F7 (25A) is removed from the interior fuse block left side and is stored in the lower panel compartment on left side of the steering wheel.

- a. Open the driver's door.
- b. Locate the fuse box, which is along the bottom left side.
- c. Open the fuse box by holding the fuse box lid with the right hand and pressing on the clip with the thumb to release the cover.
- d. Remove the clip on the sides and carefully pull the lid out.
- e. Locate the 15 amp blue colored fuse hidden in the lower panel compartment on the left side of the steering wheel.
- f. Avoid touching the metal tabs of the fuse and carefully install the fuse into empty space F15. Space F15 can be verified by referencing the inside of the fuse box lid.

NOTE: Make sure the fuse is installed fully into position and flush with all of the other fuses.

- g. Reinstall the fuse box lid in the reverse order of removal.

CAUTION: Wait a minimum of 5 seconds after installing Fuse F7 to open the liftgate. DTC B1277:14 may be stored and/or back-up lights may be inoperative if you do not wait.

NOTE: Check for Connected Vehicle signal after installing room fuses. See the image below for how the connectivity signal bar looks (it's the vertical stack bar on the right bottom corner). This connectivity signal bar is not displayed on the "Home" screen. Go into the "Entertainment" or "Navigation" menu to check it. To confirm it is working properly, the bar should be white like the image below.

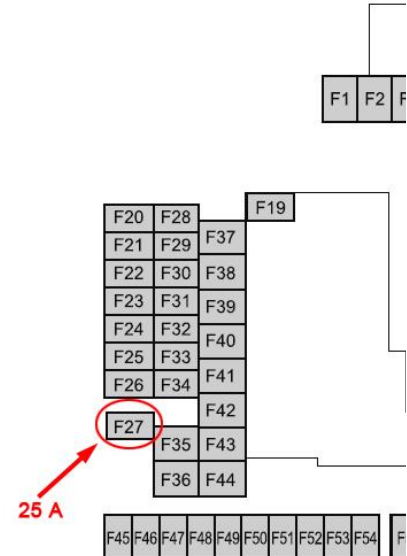
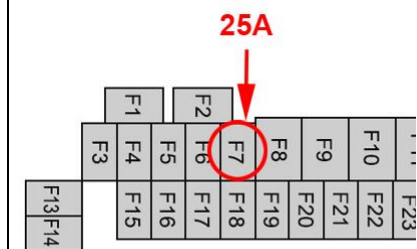
Fuse Block
(Engine Compartment)Fuse Block
(Interior, Left Side)

CONSUMER NOTICE: The information and instructions in this bulletin are intended for use by skilled technicians. Mazda technicians utilize the proper tools/equipment and take training to correctly and safely maintain Mazda vehicles. These instructions should not be performed by "do-it-yourselfers." Customers should not assume this bulletin applies to their vehicle or that their vehicle will develop the described concern. To determine if the information applies, customers should contact their nearest authorized Mazda dealership. Mazda North American Operations reserves the right to alter the specifications and contents of this bulletin without obligation or advance notice. All rights reserved. No part of this bulletin may be reproduced in any form or by any means, electronic or mechanical---including photocopying and recording and the use of any kind of information storage and retrieval system ---without permission in writing.



Commander Switch and Steering Wheel Switch Inoperative
Check for missing Audio F13 15A fuse

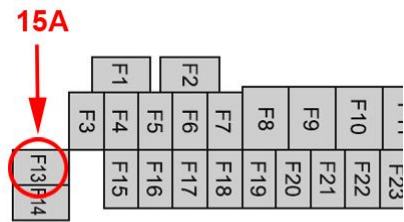

Fuse Block
(Left Side)



CONSUMER NOTICE: The information and instructions in this bulletin are intended for use by skilled technicians. Mazda technicians utilize the proper tools/equipment and take training to correctly and safely maintain Mazda vehicles. These instructions should not be performed by "do-it-yourselfers." Customers should not assume this bulletin applies to their vehicle or that their vehicle will develop the described concern. To determine if the information applies, customers should contact their nearest authorized Mazda dealership. Mazda North American Operations reserves the right to alter the specifications and contents of this bulletin without obligation or advance notice. All rights reserved. No part of this bulletin may be reproduced in any form or by any means, electronic or mechanical---including photocopying and recording and the use of any kind of information storage and retrieval system ---without permission in writing.

Auxiliary Key

The auxiliary keys need to be inserted into the transmitters during PDI.

Auxiliary Key	Transmitter
 <p>NOTE: The auxiliary keys are small and could be overlooked during PDI.</p>	

Vehicles arrive at the dealer with Auxiliary Keys located in the glove compartment*



Vehicles arrive at the dealer with one transmitter located in the front cup holder*

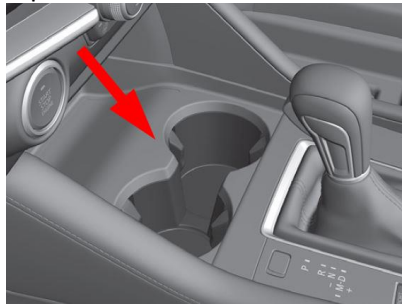

The 2nd transmitter is located near the spare tire (A) or next to the jack (B).

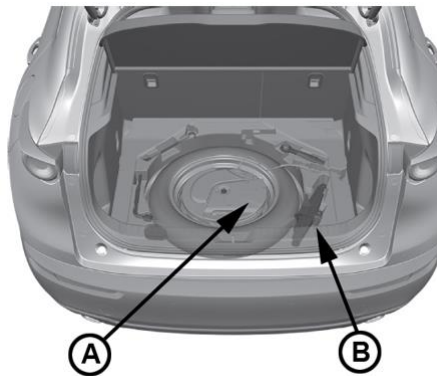

See Owner's Manual - Before Driving - Keys- [Auxiliary key](#)

CONSUMER NOTICE: The information and instructions in this bulletin are intended for use by skilled technicians. Mazda technicians utilize the proper tools/equipment and take training to correctly and safely maintain Mazda vehicles. These instructions should not be performed by "do-it-yourselfers." Customers should not assume this bulletin applies to their vehicle or that their vehicle will develop the described concern. To determine if the information applies, customers should contact their nearest authorized Mazda dealership. Mazda North American Operations reserves the right to alter the specifications and contents of this bulletin without obligation or advance notice. All rights reserved. No part of this bulletin may be reproduced in any form or by any means, electronic or mechanical---including photocopying and recording and the use of any kind of information storage and retrieval system ---without permission in writing.

*Vehicles that arrive at the dealer after business hours, one transmitter and auxiliary keys are located in the dealer's early bird key drop box.

Insert the auxiliary key into the transmitter.

Remove the transmitter lower cover by sliding the knob in the direction shown and then sliding the cover in the opposite direction.



Insert the auxiliary key.

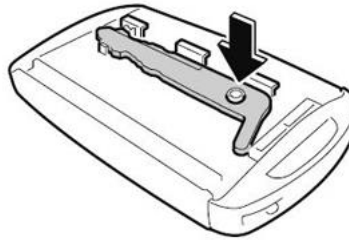

Install the transmitter lower cover by inserting the tabs of the lower cover into the slots of the transmitter.

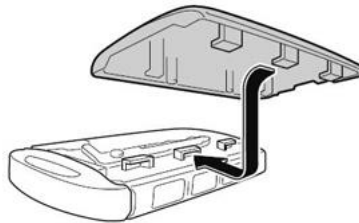

1. If one transmitter is lost, inform the customer to take cautions not to lose the 2nd transmitter.
2. If both transmitters are lost, the vehicle will be disabled. Use MDARS to program new transmitters.
3. Replacement battery type is CR2032 (3V, 225mAh), which is different than previous 6th generation transmitter battery type CR2025 (3V, 160mAh). If the wrong battery is installed, the transmitter might not work properly (malfunction).

CONSUMER NOTICE: The information and instructions in this bulletin are intended for use by skilled technicians. Mazda technicians utilize the proper tools/equipment and take training to correctly and safely maintain Mazda vehicles. These instructions should not be performed by "do-it-yourselfers." Customers should not assume this bulletin applies to their vehicle or that their vehicle will develop the described concern. To determine if the information applies, customers should contact their nearest authorized Mazda dealership. Mazda North American Operations reserves the right to alter the specifications and contents of this bulletin without obligation or advance notice. All rights reserved. No part of this bulletin may be reproduced in any form or by any means, electronic or mechanical---including photocopying and recording and the use of any kind of information storage and retrieval system ---without permission in writing.

Connected Vehicle

1. Connected Vehicle App remote requests below may take up to a minute to complete.

1. Engine Start
2. Engine Stop
3. Door Lock
4. Door Unlock
5. Quick Flash/Horn On
6. Hazard Off

2. Connected Vehicle App status is not updated in real time for the items below. Updates may take several minutes and may require a manual refresh.

1. Tire Pressure Status (last key cycle)
2. Doors
3. Trunk/Liftgate
4. Hood
5. Hazard Lights

NOTE: Tire pressures on the app are from the last time data was received before the ignition was turned off.

3. Multiple remote requests failure

1. Only a single request can be processed per minute.
2. Error messages are displayed if multiple requests are sent within 60 seconds.

Resources:

Educational Videos	Other Resources
<ol style="list-style-type: none"> 1. Overview 2. MyMazda remote 3. Using MyMazda App 4. Vehicle Health Notifications 5. In-car Wi-Fi 6. Saftey features 	<ol style="list-style-type: none"> 1. MAZDA CONNECTED SERVICES FAQ 2. MAZDA CONNECT and MAZDA CONNECTED SERVICES User Guide (see attachment) 3. MAZDA CONNECTED VEHICLE VIEWER (see attachment)

Note: Vehicle Maintenance due data is pulled from the vehicles MAZDA CONNECT system. The customer can change the settings at: MAZDA CONNECT - Information - Vehicle Status Monitor - Vehicle Maintenance Settings.

Remote Request

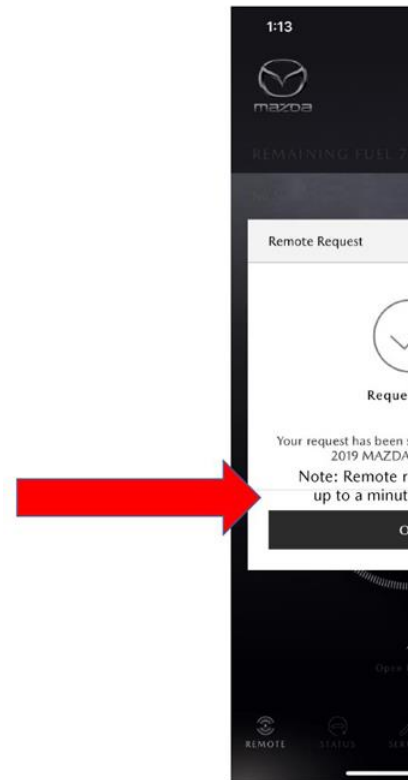

CONSUMER NOTICE: The information and instructions in this bulletin are intended for use by skilled technicians. Mazda technicians utilize the proper tools/equipment and take training to correctly and safely maintain Mazda vehicles. These instructions should not be performed by "do-it-yourselfers." Customers should not assume this bulletin applies to their vehicle or that their vehicle will develop the described concern. To determine if the information applies, customers should contact their nearest authorized Mazda dealership. Mazda North American Operations reserves the right to alter the specifications and contents of this bulletin without obligation or advance notice. All rights reserved. No part of this bulletin may be reproduced in any form or by any means, electronic or mechanical---including photocopying and recording and the use of any kind of information storage and retrieval system ---without permission in writing.

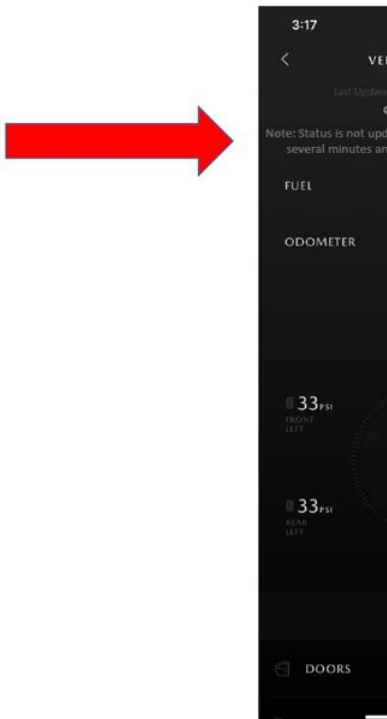
	<p>Vehicle Status</p> 
<p>Connected Vehicle Maintenance Mode When vehicle is being serviced, switch to Restricted Transmitting Mode.</p> <ol style="list-style-type: none"> 1. Restricts MyMazda App remote functions. 2. Prevents error messages being sent to the customer during vehicle service. <p>Cancel Restricted Transmitting Mode after completing vehicle service.</p>	<p>See SA-056/19 - CONNECTED VEHICLE MAINTENANCE MODE</p> <p>Go to MGSSERVICE CAUTIONS FOR VEHICLES WITH TELEMATICS COMMUNICATION SYSTEM [(US)].</p>
<p>Mazda Connected Vehicle Viewer (MCVV)</p> <p>The Mazda Connected Vehicle Viewer (MCVV) enhances the Mazda ownership experience by providing Mazda Service Advisors, Technicians and Call Center Associates access to real-time vehicle status information alerts for applicable Mazda connected vehicles.</p> <p>This powerful tool allows you to proactively understand and diagnose customer concerns and resolve potential issues, demonstrating how well you know the customer’s vehicle while establishing your</p>	<p>MAZDA CONNECTED VEHICLE VIEWER USER GUIDE (MCVV) - see attachment</p>

CONSUMER NOTICE: The information and instructions in this bulletin are intended for use by skilled technicians. Mazda technicians utilize the proper tools/equipment and take training to correctly and safely maintain Mazda vehicles. These instructions should not be performed by “do-it-yourselfers.” Customers should not assume this bulletin applies to their vehicle or that their vehicle will develop the described concern. To determine if the information applies, customers should contact their nearest authorized Mazda dealership. Mazda North American Operations reserves the right to alter the specifications and contents of this bulletin without obligation or advance notice. All rights reserved. No part of this bulletin may be reproduced in any form or by any means, electronic or mechanical---including photocopying and recording and the use of any kind of information storage and retrieval system ---without permission in writing.

readiness and willingness to assist.

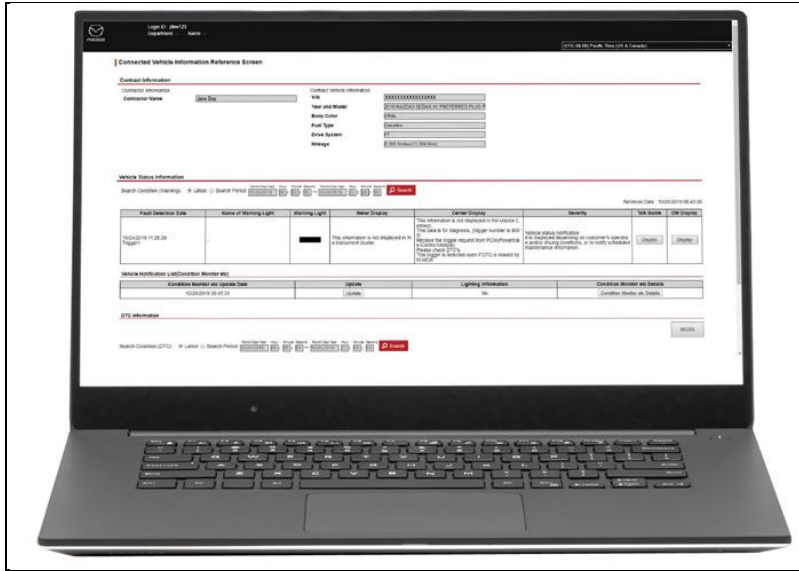

Off-Road Traction Assist

1. The Off-Road Traction Assist is a function to assist in freeing tires that are stuck when driving on rough ground (such as gravel roads or snow-covered roads).
2. The driver can switch the system to operational or non-operational using the Off-Road Traction Assist switch.



See MGSS [OFF-ROAD TRACTION ASSIST](#)

See Owner's Manual - When Driving - ABS/TCS/DSC/Off-Road - [Off-Road Traction Assist](#)

CONSUMER NOTICE: The information and instructions in this bulletin are intended for use by skilled technicians. Mazda technicians utilize the proper tools/equipment and take training to correctly and safely maintain Mazda vehicles. These instructions should not be performed by "do-it-yourselfers." Customers should not assume this bulletin applies to their vehicle or that their vehicle will develop the described concern. To determine if the information applies, customers should contact their nearest authorized Mazda dealership. Mazda North American Operations reserves the right to alter the specifications and contents of this bulletin without obligation or advance notice. All rights reserved. No part of this bulletin may be reproduced in any form or by any means, electronic or mechanical---including photocopying and recording and the use of any kind of information storage and retrieval system ---without permission in writing.

Apple CarPlay™ / Android Auto™ Activation

1. The 2020 CX-30 Standard is not equipped with Apple CarPlay™ / Android Auto™ (Equipped on all Option Packages)
2. Apple CarPlay™ / Android Auto™ MDARS Activation is available for the 2020 CX-30 Standard.

See [SA-001/19 - APPLE CARPLAY™ / ANDROID AUTO™ FREQUENTLY ASKED QUESTIONS \(FAQ\)](#)

See [Apple Carplay / Android Auto Activation Instructions](#)

Blind Spot Monitoring (BSM) System

1. BSM system indicates vehicle on the opposite side.
 2. i-ACTIVSENSE indicator ring will not turn green
 3. Rear Cross Traffic Alert (RCTA) does not work
 4. Rear side radar sensor aiming may fail
 5. TPMS DTC(s) stored
- This may be caused by BSM rear side radar sensor(s) installed facing the wrong direction.

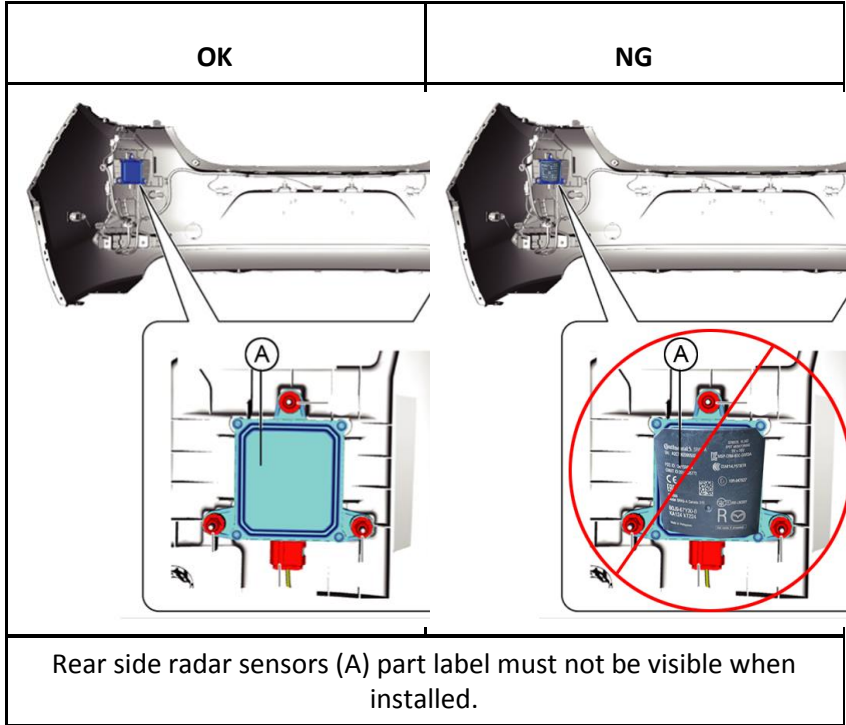

CONSUMER NOTICE: The information and instructions in this bulletin are intended for use by skilled technicians. Mazda technicians utilize the proper tools/equipment and take training to correctly and safely maintain Mazda vehicles. These instructions should not be performed by "do-it-yourselfers." Customers should not assume this bulletin applies to their vehicle or that their vehicle will develop the described concern. To determine if the information applies, customers should contact their nearest authorized Mazda dealership. Mazda North American Operations reserves the right to alter the specifications and contents of this bulletin without obligation or advance notice. All rights reserved. No part of this bulletin may be reproduced in any form or by any means, electronic or mechanical---including photocopying and recording and the use of any kind of information storage and retrieval system ---without permission in writing.

Front Wiper Service Caution

1. Wiper arm park position is located under the hood.
2. When servicing front wipers, front wiper service mode is required or damage to wiper arms may occur (see Service Information).
3. If wiper arms are replaced, M-MDS is needed for wiper arm adjustment (see Service Information)
4. DO NOT use wiper arms as markers when in dealer inventory.

See Owner's Manual -
Maintenance and Care
[Replacing Windshield Wiper
Blades](#)

MGSS: [WINDSHIELD WIPER ARM
AND BLADE ADJUSTMENT](#)

CONSUMER NOTICE: The information and instructions in this bulletin are intended for use by skilled technicians. Mazda technicians utilize the proper tools/equipment and take training to correctly and safely maintain Mazda vehicles. These instructions should not be performed by "do-it-yourselfers." Customers should not assume this bulletin applies to their vehicle or that their vehicle will develop the described concern. To determine if the information applies, customers should contact their nearest authorized Mazda dealership. Mazda North American Operations reserves the right to alter the specifications and contents of this bulletin without obligation or advance notice. All rights reserved. No part of this bulletin may be reproduced in any form or by any means, electronic or mechanical---including photocopying and recording and the use of any kind of information storage and retrieval system ---without permission in writing.

i-ACTIVSENSE Switch



If none of the systems are activated or if there is a problem with the system, the i-ACTIVSENSE status symbol (warning/risk avoidance support system) (white) is displayed.

Stand-by Status: **White**

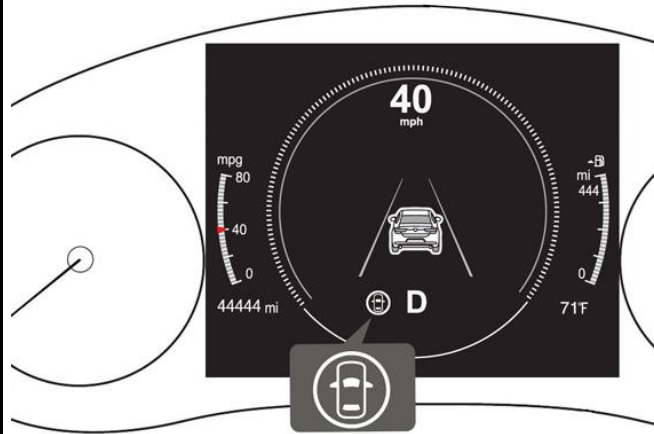

See Owner's Manual- When Driving - i-ACTIVSENSE - i-ACTIVSENSE

If any one of the systems is activated, the i-ACTIVSENSE status symbol (warning/risk avoidance support system) (green) is displayed.

Activated Status: **Green**

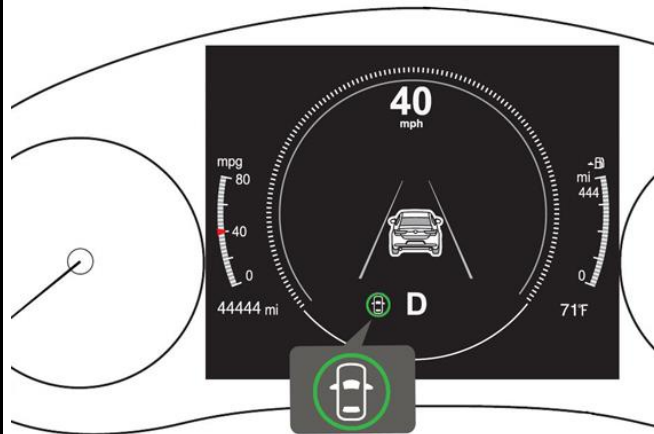

CONSUMER NOTICE: The information and instructions in this bulletin are intended for use by skilled technicians. Mazda technicians utilize the proper tools/equipment and take training to correctly and safely maintain Mazda vehicles. These instructions should not be performed by "do-it-yourselfers." Customers should not assume this bulletin applies to their vehicle or that their vehicle will develop the described concern. To determine if the information applies, customers should contact their nearest authorized Mazda dealership. Mazda North American Operations reserves the right to alter the specifications and contents of this bulletin without obligation or advance notice. All rights reserved. No part of this bulletin may be reproduced in any form or by any means, electronic or mechanical---including photocopying and recording and the use of any kind of information storage and retrieval system ---without permission in writing.

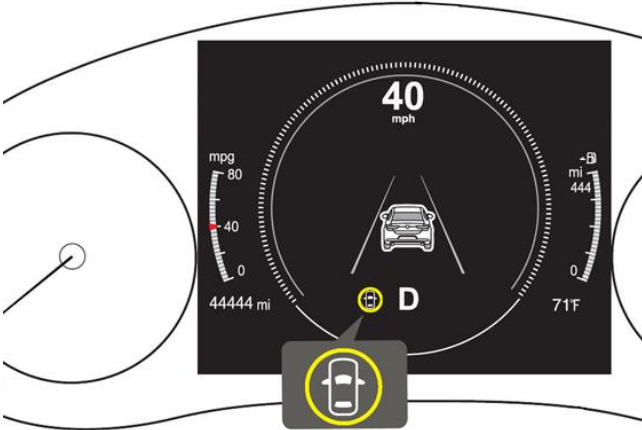
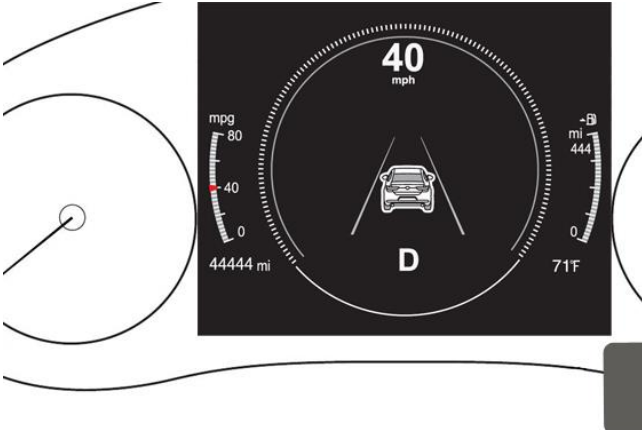
<p>If any system warning is activated, the i-ACTIVSENSE status symbol (warning/risk avoidance support system) (amber) is displayed.</p>	<p>Warning Status: Amber</p> 	
<p>When the i-ACTIVSENSE switch is pressed, the following systems are OFF and the i-ACTIVSENSE OFF indicator illuminates.</p> <ol style="list-style-type: none"> 1. Lane Departure Warning System (LDWS) 2. Blind Spot Monitoring (BSM) 3. Distance Speed Alert (DSA) 4. Rear Cross 	<p>OFF (Cancelled Status): I-ACTIVSENSE OFF INDICATOR IS ILLUMINATED</p> 	

CONSUMER NOTICE: The information and instructions in this bulletin are intended for use by skilled technicians. Mazda technicians utilize the proper tools/equipment and take training to correctly and safely maintain Mazda vehicles. These instructions should not be performed by "do-it-yourselfers." Customers should not assume this bulletin applies to their vehicle or that their vehicle will develop the described concern. To determine if the information applies, customers should contact their nearest authorized Mazda dealership. Mazda North American Operations reserves the right to alter the specifications and contents of this bulletin without obligation or advance notice. All rights reserved. No part of this bulletin may be reproduced in any form or by any means, electronic or mechanical---including photocopying and recording and the use of any kind of information storage and retrieval system ---without permission in writing.

<p>Traffic Alert (RCTA)</p> <p>5. Lane-keep Assist System (LAS)</p> <p>To turn the system back to ON, press the i-ACTIVSENSE switch once.</p> <p>NOTE:</p> <p>1. When the ignition is turned OFF - ON, i-ACTIVSENSE switches to ON.</p> <p>2. If MRCC is activated, i-ACTIVSENSE switches to ON.</p> <p>3. When MRCC is deactivated, i-ACTIVSENSE</p>		
--	--	--

CONSUMER NOTICE: The information and instructions in this bulletin are intended for use by skilled technicians. Mazda technicians utilize the proper tools/equipment and take training to correctly and safely maintain Mazda vehicles. These instructions should not be performed by "do-it-yourselfers." Customers should not assume this bulletin applies to their vehicle or that their vehicle will develop the described concern. To determine if the information applies, customers should contact their nearest authorized Mazda dealership. Mazda North American Operations reserves the right to alter the specifications and contents of this bulletin without obligation or advance notice. All rights reserved. No part of this bulletin may be reproduced in any form or by any means, electronic or mechanical---including photocopying and recording and the use of any kind of information storage and retrieval system ---without permission in writing.

<p>remains ON.</p> <p>4. The i-ACTIVSENSE switch does not cancel SBS. SBS can be deactivated using infotainment system settings.</p>																	
<p>Traffic Sign Recognition (TSR)* (2021 CX-30) NOTE:</p>		<p>See Owner's Manual - When Driving - i-ACTIVSENSE - i-ACTIVSENSE - Traffic Sign Recognition System (TSR)</p> <p>MGSS:Traffic Sign Recognition (TSR)</p>															
<table border="1"> <thead> <tr> <th>Year/Model</th> <th>TSR</th> <th>Excessive Speed Warning</th> <th>Display Location</th> <th>Note</th> </tr> </thead> <tbody> <tr> <td>2020 CX-30</td> <td></td> <td>✓</td> <td rowspan="2">Instrument Cluster and Active Driving Display</td> <td>- Requires Navigation SD Card</td> </tr> <tr> <td>2021 CX-30</td> <td>✓</td> <td></td> <td>- Disabled by Apple Carplay / Android Auto USB connection</td> </tr> </tbody> </table>	Year/Model		TSR	Excessive Speed Warning	Display Location	Note	2020 CX-30		✓	Instrument Cluster and Active Driving Display	- Requires Navigation SD Card	2021 CX-30	✓		- Disabled by Apple Carplay / Android Auto USB connection		
Year/Model	TSR	Excessive Speed Warning	Display Location	Note													
2020 CX-30		✓	Instrument Cluster and Active Driving Display	- Requires Navigation SD Card													
2021 CX-30	✓			- Disabled by Apple Carplay / Android Auto USB connection													
<p>* Some models</p>																	

CONSUMER NOTICE: The information and instructions in this bulletin are intended for use by skilled technicians. Mazda technicians utilize the proper tools/equipment and take training to correctly and safely maintain Mazda vehicles. These instructions should not be performed by "do-it-yourselfers." Customers should not assume this bulletin applies to their vehicle or that their vehicle will develop the described concern. To determine if the information applies, customers should contact their nearest authorized Mazda dealership. Mazda North American Operations reserves the right to alter the specifications and contents of this bulletin without obligation or advance notice. All rights reserved. No part of this bulletin may be reproduced in any form or by any means, electronic or mechanical---including photocopying and recording and the use of any kind of information storage and retrieval system ---without permission in writing.

Excessive Speed Warning *

NOTE:

1. Excessive Speed Warning function is only available with a dealer installed in-vehicle navigation system accessory**.
2. Excessive Speed Warning function is displayed in the Instrument Cluster and the Active Driving Display.
3. Excessive Speed Warning function is disabled when Apple CarPlay™ or Android Auto™ is connected.

* Some models

Below the Speed Limit	Above the Speed Limit
-----------------------	-----------------------

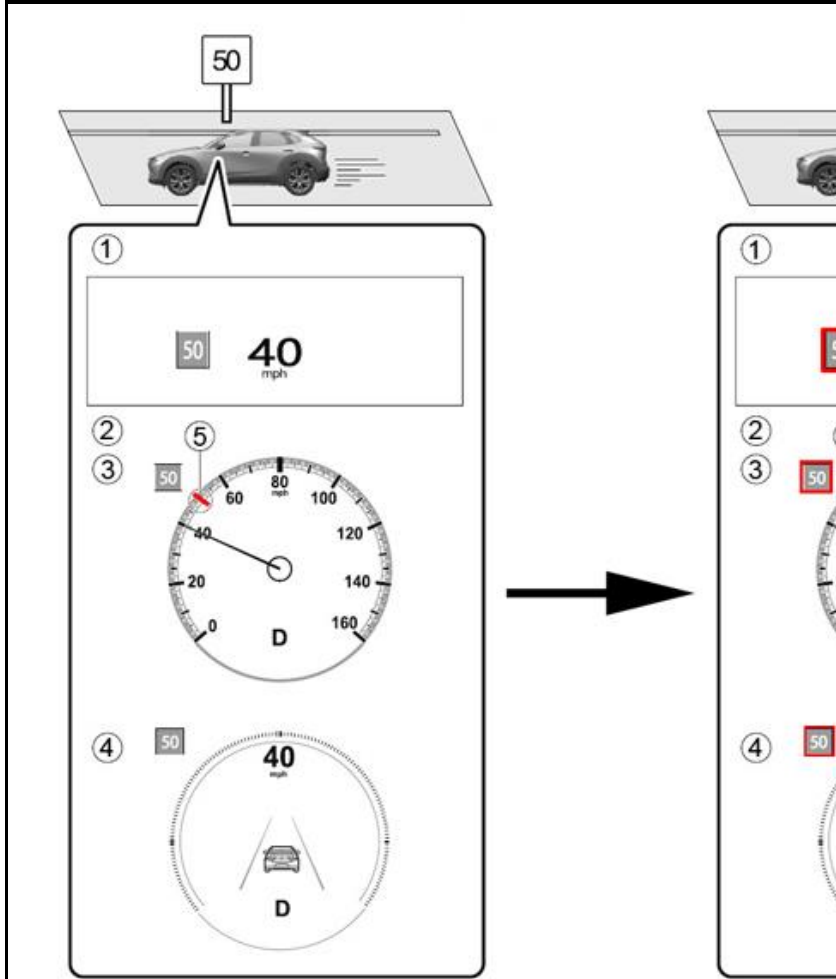

1. Active Driving Display
2. Instrument Cluster

See Owner's Manual - When Driving - i-ACTIVSENSE - i-ACTIVSENSE - Excessive Speed Warning

CONSUMER NOTICE: The information and instructions in this bulletin are intended for use by skilled technicians. Mazda technicians utilize the proper tools/equipment and take training to correctly and safely maintain Mazda vehicles. These instructions should not be performed by "do-it-yourselfers." Customers should not assume this bulletin applies to their vehicle or that their vehicle will develop the described concern. To determine if the information applies, customers should contact their nearest authorized Mazda dealership. Mazda North American Operations reserves the right to alter the specifications and contents of this bulletin without obligation or advance notice. All rights reserved. No part of this bulletin may be reproduced in any form or by any means, electronic or mechanical---including photocopying and recording and the use of any kind of information storage and retrieval system ---without permission in writing.

- 3. Basic Display
- 4. i-ACTIVSENSE Display
- 5. Speed Limit Indication

MAZDA CONNECT Excessive Speed Warning Customer Settings

- 1. Speed Limit Settings
 - 1. OFF
 - 2. Visual
 - 3. Visual + Audible
- 2. Speed Limit Threshold Settings
 - 1. 0 mph
 - 2. +5 mph
 - 3. +10 mph

** SD Card maps may contain information about the speed limits of the roads. The navigation system is able to warn driver if they exceed the current limit. This information may not be available in some areas or may not be fully correct for all roads on the map.

Traffic Jam Assist (TJA)* (2021 CX-30 only)

When lane lines are detected, the function assists the driver in keeping the vehicle within the lane lines. If lane lines are not detected, the function provides the driver driving assistance in keeping the vehicle along the motion path with the vehicle ahead. Steering assist function operates below 35 mph.

TJA Set Switch

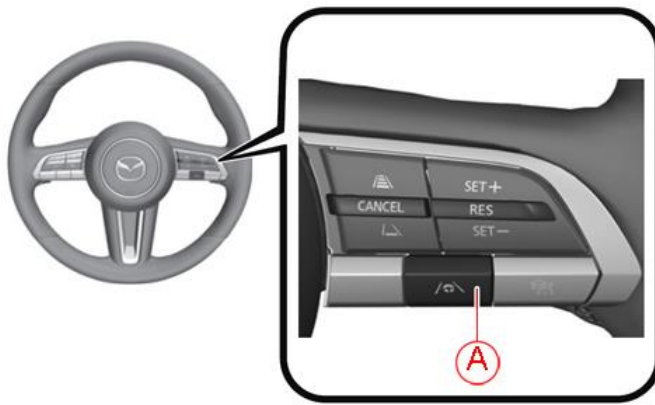

A: TJA Switch

See Owner's Manual - When Driving - i-ACTIVSENSE - i-ACTIVSENSE -Traffic Jam Assist

MGSS: [TRAFFIC JAM ASSIST \(TJA\)](#)

CONSUMER NOTICE: The information and instructions in this bulletin are intended for use by skilled technicians. Mazda technicians utilize the proper tools/equipment and take training to correctly and safely maintain Mazda vehicles. These instructions should not be performed by "do-it-yourselfers." Customers should not assume this bulletin applies to their vehicle or that their vehicle will develop the described concern. To determine if the information applies, customers should contact their nearest authorized Mazda dealership. Mazda North American Operations reserves the right to alter the specifications and contents of this bulletin without obligation or advance notice. All rights reserved. No part of this bulletin may be reproduced in any form or by any means, electronic or mechanical---including photocopying and recording and the use of any kind of information storage and retrieval system ---without permission in writing.

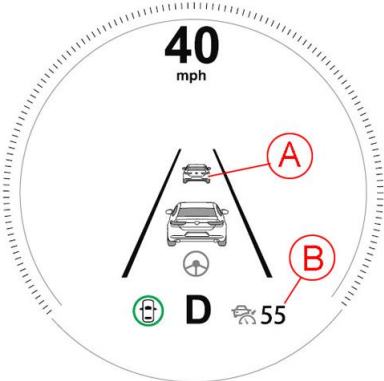
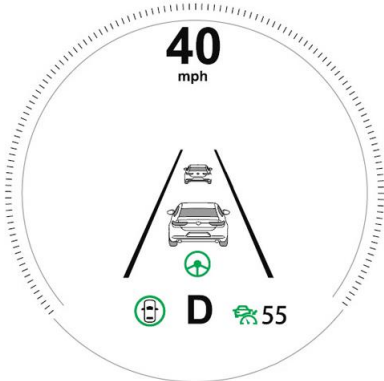
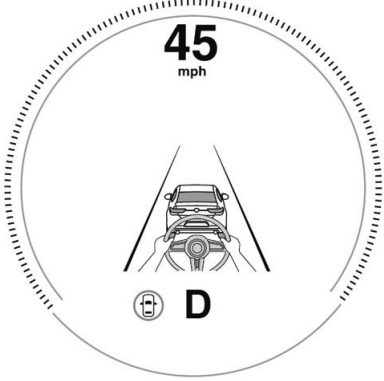
<p>TJA system is on standby</p>	 <p>A: Vehicle ahead display B: TJA vehicle speed set</p>	
<p>Vehicle ahead is detected</p>		
<p>Steering Assist Limit Warning</p>		
<p>*Some models</p>		

CONSUMER NOTICE: The information and instructions in this bulletin are intended for use by skilled technicians. Mazda technicians utilize the proper tools/equipment and take training to correctly and safely maintain Mazda vehicles. These instructions should not be performed by "do-it-yourselfers." Customers should not assume this bulletin applies to their vehicle or that their vehicle will develop the described concern. To determine if the information applies, customers should contact their nearest authorized Mazda dealership. Mazda North American Operations reserves the right to alter the specifications and contents of this bulletin without obligation or advance notice. All rights reserved. No part of this bulletin may be reproduced in any form or by any means, electronic or mechanical---including photocopying and recording and the use of any kind of information storage and retrieval system ---without permission in writing.

MAZDA CONNECT New Power Off Function



1. Audio Mute - Short press the volume knob (Press again to cancel)
2. Power Off - Press and hold the volume knob (Press and hold again to Power ON)

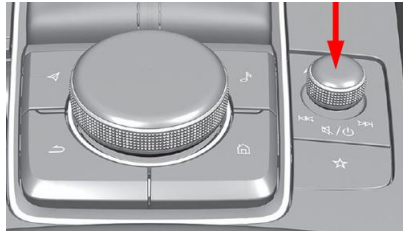

See Owner's Manual -
Interior Features -
[Mazda Connect](#)

MGSS: [ENTERTAINMENT SYSTEM](#)

CONSUMER NOTICE: The information and instructions in this bulletin are intended for use by skilled technicians. Mazda technicians utilize the proper tools/equipment and take training to correctly and safely maintain Mazda vehicles. These instructions should not be performed by "do-it-yourselfers." Customers should not assume this bulletin applies to their vehicle or that their vehicle will develop the described concern. To determine if the information applies, customers should contact their nearest authorized Mazda dealership. Mazda North American Operations reserves the right to alter the specifications and contents of this bulletin without obligation or advance notice. All rights reserved. No part of this bulletin may be reproduced in any form or by any means, electronic or mechanical---including photocopying and recording and the use of any kind of information storage and retrieval system ---without permission in writing.

MAZDA CONNECT Center Display View
 The rear-view monitor does not utilize all of the center display space.

Function	Display
Rear View Monitor	
MAZDA CONNECT FM	
Apple CarPlay	
Android Auto	

CONSUMER NOTICE: The information and instructions in this bulletin are intended for use by skilled technicians. Mazda technicians utilize the proper tools/equipment and take training to correctly and safely maintain Mazda vehicles. These instructions should not be performed by "do-it-yourselfers." Customers should not assume this bulletin applies to their vehicle or that their vehicle will develop the described concern. To determine if the information applies, customers should contact their nearest authorized Mazda dealership. Mazda North American Operations reserves the right to alter the specifications and contents of this bulletin without obligation or advance notice. All rights reserved. No part of this bulletin may be reproduced in any form or by any means, electronic or mechanical---including photocopying and recording and the use of any kind of information storage and retrieval system ---without permission in writing.

In-Vehicle Digital Owner's Manual

The in-vehicle digital OM can be displayed on the center display while the vehicle is stopped. Customer can search descriptions and watch videos of vehicle features and functions by operating the commander switch.

**NOTE:**



1. The digital owner's manual must be installed during PDI. Due to printing deadlines and later updates to the digital manual, the content of the digital manual may differ from the printed manual.
 1. DO NOT use the same file as Mazda3. Check [MGSS](#) and retrieve the correct file for the CX-30.
2. USB memory flash drive FAT16 or FAT32 format is required for installation.
3. The vehicle's infotainment system will only accept file names [contents.tar] and [contents.sig]. File names with additional suffixes will not be accepted.
4. The infotainment system may inadvertently be powered OFF if the diagnostic assist function buttons are not pressed correctly. Simply press and hold the volume knob to power back ON.

CONSUMER NOTICE: The information and instructions in this bulletin are intended for use by skilled technicians. Mazda technicians utilize the proper tools/equipment and take training to correctly and safely maintain Mazda vehicles. These instructions should not be performed by "do-it-yourselfers." Customers should not assume this bulletin applies to their vehicle or that their vehicle will develop the described concern. To determine if the information applies, customers should contact their nearest authorized Mazda dealership. Mazda North American Operations reserves the right to alter the specifications and contents of this bulletin without obligation or advance notice. All rights reserved. No part of this bulletin may be reproduced in any form or by any means, electronic or mechanical---including photocopying and recording and the use of any kind of information storage and retrieval system ---without permission in writing.

Navigation System

The 2020 CX-30 7th generation (Gen 7) infotainment system is not equipped with factory installed navigation system, however, it is available as a dealer installed accessory.

NOTE 1: Gen 6.5 Navi SD card with part number prefix BHP1 (CX-3) installed in the Gen 7 2020 CX-30 will not function.

Gen 7	Gen 7	Gen 6.5
		
P/N prefix BDTS	P/N prefix BDGF	P/N prefix BHP1
Interchangeable		

NOTE 2: The 2021 CX-30 with Premium Package is equipped with factory installed navigation system.

SIRIUSXM Data Service No Free Trial (Preferred Package and above)

1. Only available as a paid subscription.
2. SiriusXM Traffic Plus feature requires in-vehicle navigation SD card.
3. The 2020 CX-30 is not equipped with a factory installed navigation system, however, it is available as a dealer installed accessory.

See Owner's Manual - Interior Features - Mazda Connect - [Appendix](#)

SA-007/19 - [SIRIUSXM DATA SERVICES](#)

CONSUMER NOTICE: The information and instructions in this bulletin are intended for use by skilled technicians. Mazda technicians utilize the proper tools/equipment and take training to correctly and safely maintain Mazda vehicles. These instructions should not be performed by "do-it-yourselfers." Customers should not assume this bulletin applies to their vehicle or that their vehicle will develop the described concern. To determine if the information applies, customers should contact their nearest authorized Mazda dealership. Mazda North American Operations reserves the right to alter the specifications and contents of this bulletin without obligation or advance notice. All rights reserved. No part of this bulletin may be reproduced in any form or by any means, electronic or mechanical---including photocopying and recording and the use of any kind of information storage and retrieval system ---without permission in writing.

Power Door Locks

Doors cannot be unlocked using the outside door handle touch sensor
The door handle touch sensor system may not operate normally under the following conditions:

1. The front passenger (without key) grabs and holds the outside door handle before the driver (with key) touches the drivers outside door handle unlock touch sensor.
2. The driver touches the sensing area of the door lock touch sensor and the sensing area of the door release touch sensor at the same time.

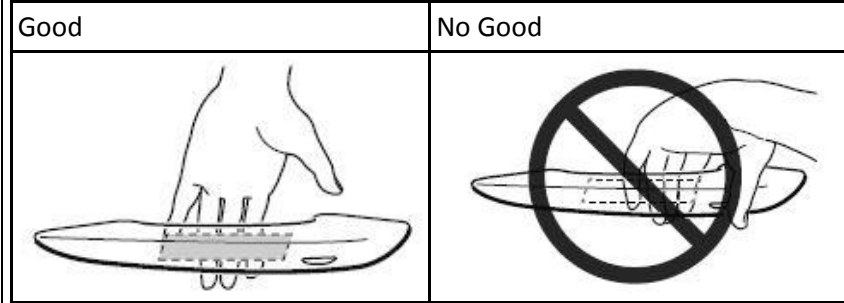

See Owner's Manual - Before Driving - [Doors and Locks](#)

Walk-Away Auto Lock Function

A beep sound is heard when all doors and the liftgate are closed while the transmitter is being carried. All the doors, fuel-filler lid, and liftgate are locked automatically when the transmitter is out of the operational range. Also, the hazard warning lights flash once. (Even if the driver is in the operational range, all the doors, fuel-filler lid, and liftgate are locked automatically after about 30 seconds.) If you are out of the operational range before the doors and the liftgate are completely closed or another transmitter is left in the vehicle, the walk-away auto lock function will not work. Always make sure that all doors and the liftgate are closed and locked before leaving the vehicle. The walk-away auto lock function does not close the power windows.

Operational Range

See Owner's Manual - Before Driving - [Doors and Locks](#)

CONSUMER NOTICE: The information and instructions in this bulletin are intended for use by skilled technicians. Mazda technicians utilize the proper tools/equipment and take training to correctly and safely maintain Mazda vehicles. These instructions should not be performed by "do-it-yourselfers." Customers should not assume this bulletin applies to their vehicle or that their vehicle will develop the described concern. To determine if the information applies, customers should contact their nearest authorized Mazda dealership. Mazda North American Operations reserves the right to alter the specifications and contents of this bulletin without obligation or advance notice. All rights reserved. No part of this bulletin may be reproduced in any form or by any means, electronic or mechanical---including photocopying and recording and the use of any kind of information storage and retrieval system ---without permission in writing.

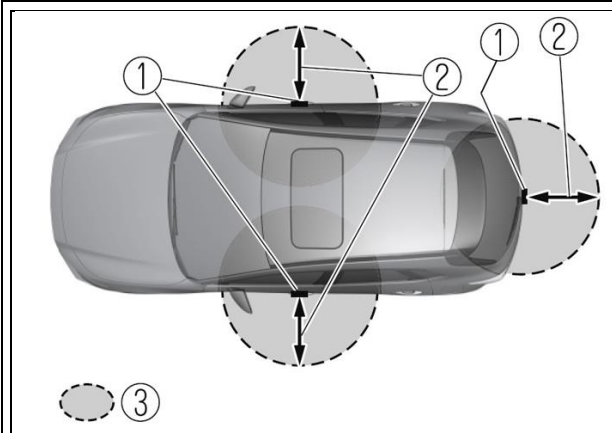

- 1. Exterior Antenna
- 2. 31 in (80 cm)
- 3. Operational range

Scenarios Where Walk-Away Lock Function May Not Work

	Scenario	Reason	Solution
1.	Key transmitter is outside of antenna range while any of the doors have not been closed.	1. By the time all the doors are closed, the key transmitter is already out of operational range, causing walk-away lock to not function.	Always make sure the key transmitter holder is in operational range and is the last person to leave after all doors/trunk/liftgate are closed.
2.	Key transmitter holder exits driver's door then opens rear left door to retrieve items.	1. Depending on the key transmitter holder's distance to the antenna when he/she is closing the driver side rear door, the walk-away lock may or may not function. 2. If standing closer to the rear bumper area when closing the rear door, the key transmitter may be	Be mindful of the key holder's position in relation to the door exterior antenna (31 in).

CONSUMER NOTICE: The information and instructions in this bulletin are intended for use by skilled technicians. Mazda technicians utilize the proper tools/equipment and take training to correctly and safely maintain Mazda vehicles. These instructions should not be performed by "do-it-yourselfers." Customers should not assume this bulletin applies to their vehicle or that their vehicle will develop the described concern. To determine if the information applies, customers should contact their nearest authorized Mazda dealership. Mazda North American Operations reserves the right to alter the specifications and contents of this bulletin without obligation or advance notice. All rights reserved. No part of this bulletin may be reproduced in any form or by any means, electronic or mechanical---including photocopying and recording and the use of any kind of information storage and retrieval system ---without permission in writing.

		<p>out of the operational range, causing walk-away lock to not function.</p> <p>3. If standing closer to the B-pillar when closing the rear door, the walk-away lock should function correctly.</p>		
3.	Key transmitter holder moves out of operational range too quickly.	<p>1. If the key transmitter holder is in a hurry to get out of the car and leaves the operational range too quickly before the audio beep, the walkaway lock function may not work.</p> <p>2. The key transmitter holder opens the driver's door, gets out, and walks away at a fast pace while shutting the door. It is possible that by the time the door is completely shut, the key transmitter holder is already out of operational range because she/he is moving away too fast, causing walk-away lock to not function.</p>	<p>Slow down and make sure the audio beep sounds before leaving the operational range, the audio beep sound will always sound to alert the key transmitter holder that the key was detected for walk-away door lock function.</p>	

CONSUMER NOTICE: The information and instructions in this bulletin are intended for use by skilled technicians. Mazda technicians utilize the proper tools/equipment and take training to correctly and safely maintain Mazda vehicles. These instructions should not be performed by "do-it-yourselfers." Customers should not assume this bulletin applies to their vehicle or that their vehicle will develop the described concern. To determine if the information applies, customers should contact their nearest authorized Mazda dealership. Mazda North American Operations reserves the right to alter the specifications and contents of this bulletin without obligation or advance notice. All rights reserved. No part of this bulletin may be reproduced in any form or by any means, electronic or mechanical---including photocopying and recording and the use of any kind of information storage and retrieval system ---without permission in writing.

Transmitter Battery Saving Function (Key Fob)

The CX-30 has a "power saving" function built into the keyless entry system where some key fob functions are disabled. This feature could accidentally be enabled and some concerns with the vehicle may be:

1. Engine does not start.
2. Engine does not start unless you hold the fob to the start/stop button.
3. Doors do not unlock using the door handle, but unlock with the remote.
4. Doors do not lock using the door handle, but lock with the remote.
5. Transmitter indicator light does not turn on/flash.

See Owner's Manual -

Before Driving - Keys - [Power saving function](#)

Keyless Entry Using Auxiliary Key

If the vehicle battery is discharged and/or the key battery is dead, vehicle entry is possible using the auxiliary key.

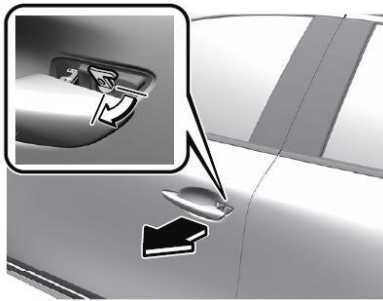

See Owner's Manual -

Before Driving - Keys - [Auxiliary Key](#)

Then refer to Owner's Manual - Before Driving - Doors and Locks - [Unlocking with Auxiliary Key](#)

CONSUMER NOTICE: The information and instructions in this bulletin are intended for use by skilled technicians. Mazda technicians utilize the proper tools/equipment and take training to correctly and safely maintain Mazda vehicles. These instructions should not be performed by "do-it-yourselfers." Customers should not assume this bulletin applies to their vehicle or that their vehicle will develop the described concern. To determine if the information applies, customers should contact their nearest authorized Mazda dealership. Mazda North American Operations reserves the right to alter the specifications and contents of this bulletin without obligation or advance notice. All rights reserved. No part of this bulletin may be reproduced in any form or by any means, electronic or mechanical---including photocopying and recording and the use of any kind of information storage and retrieval system ---without permission in writing.

Rear Door Child Safety Locks Operation

The auxiliary key is required to enable (lock) and disable (unlock) the rear door child safety locks.

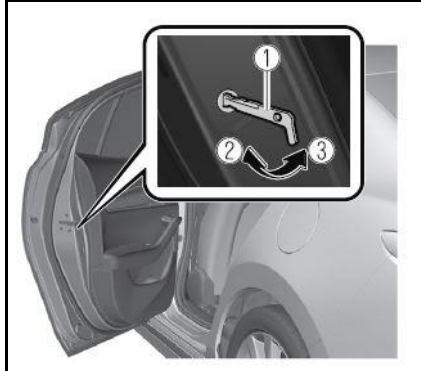

1. Auxiliary Key

2. Lock

3. Unlock

See Owner's Manual -
Before Driving - Doors and Locks
- [Rear Door Child Safety Locks](#)

CONSUMER NOTICE: The information and instructions in this bulletin are intended for use by skilled technicians. Mazda technicians utilize the proper tools/equipment and take training to correctly and safely maintain Mazda vehicles. These instructions should not be performed by "do-it-yourselfers." Customers should not assume this bulletin applies to their vehicle or that their vehicle will develop the described concern. To determine if the information applies, customers should contact their nearest authorized Mazda dealership. Mazda North American Operations reserves the right to alter the specifications and contents of this bulletin without obligation or advance notice. All rights reserved. No part of this bulletin may be reproduced in any form or by any means, electronic or mechanical---including photocopying and recording and the use of any kind of information storage and retrieval system ---without permission in writing.

Theft-Deterrent System



The CX-30 is not equipped with a Theft-Deterrent System. **CAUTION:** DO NOT use MDARS to enable:

1. Burglar Alarm
2. Intrusion Sensor

The CX-30 does not have the necessary Theft-Deterrent System hardware to function if enabled using MDARS, and MDARS cannot disable the Theft-Deterrent System after it has been enabled.

The following DTC's may be stored if the burglar alarm or intrusion sensor are enabled:

1. B109F:87 - Intrusion Sensor Module
2. B2002:87 - On Board Charger DC/DC Low Voltage Side

Contact Hotline if the Theft-Deterrent System has been accidentally enabled.

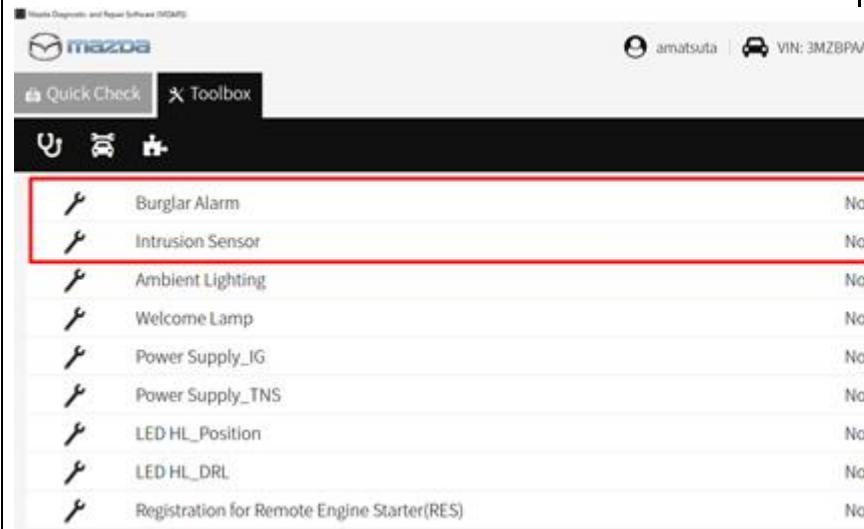

CONSUMER NOTICE: The information and instructions in this bulletin are intended for use by skilled technicians. Mazda technicians utilize the proper tools/equipment and take training to correctly and safely maintain Mazda vehicles. These instructions should not be performed by "do-it-yourselfers." Customers should not assume this bulletin applies to their vehicle or that their vehicle will develop the described concern. To determine if the information applies, customers should contact their nearest authorized Mazda dealership. Mazda North American Operations reserves the right to alter the specifications and contents of this bulletin without obligation or advance notice. All rights reserved. No part of this bulletin may be reproduced in any form or by any means, electronic or mechanical---including photocopying and recording and the use of any kind of information storage and retrieval system ---without permission in writing.

Seat Warmer and Heated Steering Wheel Auto Mode
 The driver and front passenger's seater warmers* and the heated steering wheel* can be set to be automatically controlled (turned on and off) by the climate control system, depending on the set temperature.

Auto Mode

1. Go to MAZDA CONNECT home screen and select "Settings"
2. Select "Vehicle Settings".
3. Enable "Link Seat Climate Control Temperatures".
4. Press the climate control AUTO switch.

Link Seat Climate Control Temperatures Setting

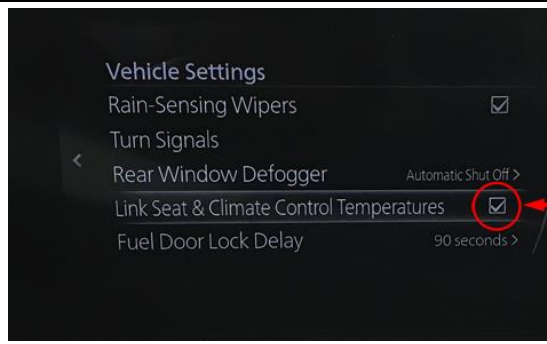

Climate Control Auto Switch



* if equipped

See Owner's Manual - Essential Safety Equipment - Seat Warmer/Heated Steering Wheel - [Seat Warmer/ Heated Steering Wheel](#)

Seat Warmer Will Not Turn ON After Previous Usage or being parked under the hot sun.

1. DTC B1030:13 (SEAT WARMER UNIT (LH) CIRCUIT MALFUNCTION (HEATER SIDE)) is stored.
2. Front seat warmer functions after seat cool down and ignition OFF - ON cycle.

Contact Hotline for latest repair information.

CONSUMER NOTICE: The information and instructions in this bulletin are intended for use by skilled technicians. Mazda technicians utilize the proper tools/equipment and take training to correctly and safely maintain Mazda vehicles. These instructions should not be performed by "do-it-yourselfers." Customers should not assume this bulletin applies to their vehicle or that their vehicle will develop the described concern. To determine if the information applies, customers should contact their nearest authorized Mazda dealership. Mazda North American Operations reserves the right to alter the specifications and contents of this bulletin without obligation or advance notice. All rights reserved. No part of this bulletin may be reproduced in any form or by any means, electronic or mechanical---including photocopying and recording and the use of any kind of information storage and retrieval system ---without permission in writing.

Electric Parking Brake (EPB)

Parking Brake Auto Operation

When the ignition is switched OFF, the parking brake will be applied automatically. The EPB indicator light in the instrument cluster and the EPB switch indicator light turn ON.



1. Indicator light

Canceling the Parking Brake Auto Operation

Parking brake auto operation can be canceled using the procedure in the Owner's Manual.

NOTE: When the ignition is cycled back ON, the parking brake auto operation is restored.

Parking Brake Automatic Release

If the accelerator pedal is depressed with the parking brake applied and all of the following conditions are met, the parking brake is automatically release. When the parking brake is released, the EPB indicator light in the instrument cluster and the EPB switch indicator light turn off.

Engine is running

Driver's door is closed

Driver's seat belt is fastened

Selector lever is in the D, M, or R position

See Owner's Manual - When Driving - Brake - [EPB Auto operation](#)

CONSUMER NOTICE: The information and instructions in this bulletin are intended for use by skilled technicians. Mazda technicians utilize the proper tools/equipment and take training to correctly and safely maintain Mazda vehicles. These instructions should not be performed by "do-it-yourselfers." Customers should not assume this bulletin applies to their vehicle or that their vehicle will develop the described concern. To determine if the information applies, customers should contact their nearest authorized Mazda dealership. Mazda North American Operations reserves the right to alter the specifications and contents of this bulletin without obligation or advance notice. All rights reserved. No part of this bulletin may be reproduced in any form or by any means, electronic or mechanical---including photocopying and recording and the use of any kind of information storage and retrieval system ---without permission in writing.

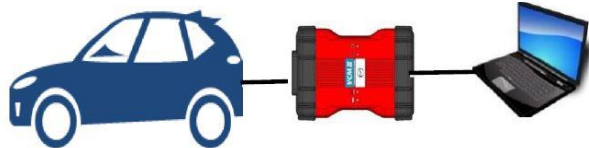
<p>Tire Pressure Monitoring System (TPMS) Change The TPMS system uses a new rubber type direct TPMS. NOTE: The new rubber type is not reusable. If the TPMS sensor is removed from the wheel, it must be replaced.</p> <div data-bbox="198 411 621 674" style="border: 1px solid black; text-align: center;">  </div> <table border="1" data-bbox="198 678 621 724" style="width: 100%; text-align: center;"> <tr> <td style="width: 50%;">New Rubber Type</td> <td style="width: 50%;">Old Metal Type</td> </tr> </table>	New Rubber Type	Old Metal Type	<p>MGSS: TIRE PRESSURE MONITORING SYSTEM (TPMS)</p>
New Rubber Type	Old Metal Type		
<p>Condition Based Maintenance (Except Canada) The vehicle calculates the maintenance (oil change) timing.</p> <ol style="list-style-type: none"> 1. This function cannot be turned OFF. 2. Distance until the oil change is available in MAZDA CONNECT. 3. Reset is required after every oil change. 	<p>MGSS: MAINTENANCE MONITOR OPERATION PROCEDURE</p>		
<p>New M-MDS (MDARS) A new M-MDS diagnostic tester (MDARS) for 7th generation vehicles (starting with the 2019 Mazda3) is used.</p> <ol style="list-style-type: none"> 1. Performs more maintenance service functions 2. Performs more complicated vehicle electrical system diagnostic 3. Reprograms more ECU's <div data-bbox="207 1360 792 1507" style="text-align: center;">  </div>	<p>MGSS: BASIC KNOWLEDGE</p>		

CONSUMER NOTICE: The information and instructions in this bulletin are intended for use by skilled technicians. Mazda technicians utilize the proper tools/equipment and take training to correctly and safely maintain Mazda vehicles. These instructions should not be performed by "do-it-yourselfers." Customers should not assume this bulletin applies to their vehicle or that their vehicle will develop the described concern. To determine if the information applies, customers should contact their nearest authorized Mazda dealership. Mazda North American Operations reserves the right to alter the specifications and contents of this bulletin without obligation or advance notice. All rights reserved. No part of this bulletin may be reproduced in any form or by any means, electronic or mechanical---including photocopying and recording and the use of any kind of information storage and retrieval system ---without permission in writing.

Parts Replacement

When replacing vehicle parts such as ECU's, motors, seats....etc, always refer to MGSS. Some new components may not operate if MGSS new part replacement procedure is not performed.

2020 CX-30 [Web-Based Training Courses](#)

Course	Description
30070	2020 Mazda CX-30 Exclusive Preview
30071	Mazda Premium
30072	Performance: Effortless, Joyful Driving
30073	Exterior: Artful Design
30074	Interior: Human Centricity
30075	Skyactiv® Philosophy
30076	Mazda Connect Essentials Web-based Training Course

CONSUMER NOTICE: The information and instructions in this bulletin are intended for use by skilled technicians. Mazda technicians utilize the proper tools/equipment and take training to correctly and safely maintain Mazda vehicles. These instructions should not be performed by "do-it-yourselfers." Customers should not assume this bulletin applies to their vehicle or that their vehicle will develop the described concern. To determine if the information applies, customers should contact their nearest authorized Mazda dealership. Mazda North American Operations reserves the right to alter the specifications and contents of this bulletin without obligation or advance notice. All rights reserved. No part of this bulletin may be reproduced in any form or by any means, electronic or mechanical---including photocopying and recording and the use of any kind of information storage and retrieval system ---without permission in writing.