

Type: Customer Satisfaction Campaign
 Year: 2020
 System: Electrical
 Sequence: 02

MODEL: Revero GT

TITLE: Installed Radar Assembly Verification

PURPOSE: Inspection of the AFRM date code to validate part for future updates (Fig 1).



Place the vehicle on a rack and raise up to service height. The inspection is from beneath the vehicle. (Fig 2).

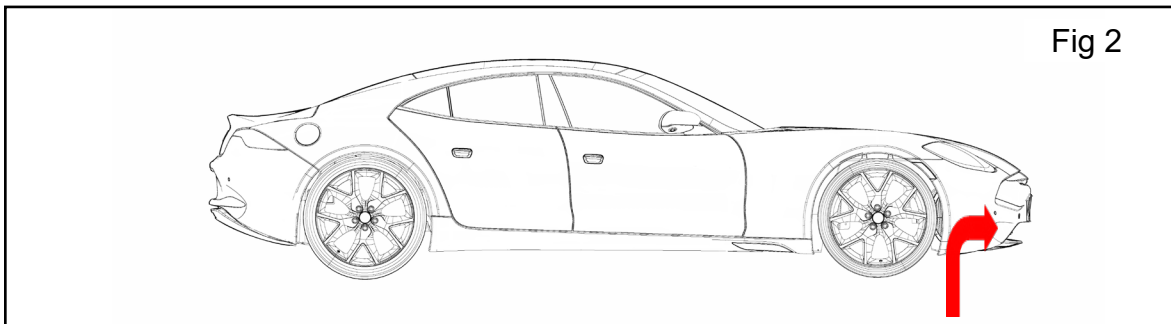

Required Tools: image capturing phone or camera, and an inspection mirror.



ALL Vehicles are to be inspected and a TSS case created.

Karma Automotive Bulletins and service documents are intended for use by experienced and trained Technicians. If you lack the skills, tools, equipment and a suitable workshop for any procedure described in this document, we suggest you leave such repairs to an Authorized Karma Service Provider or qualified service center. See your service provider for advice on whether your vehicle may benefit from the information contained within this document. The information contained in the Karma Bulletin is accurate at the date of publication. However, Karma Automotive regularly updates technical information. Please check with your Karma Automotive Service Provider that the bulletin you intend to use contains the latest available information.

50GK43SB4LA000002	50GK43SB8LA000049
50GK43SB3LA000010	50GK43SB4LA000050
50GK43SB5LA000011	50GK43SB6LA000051
50GK43SB7LA000012	50GK43SB3LA000055
50GK43SB9LA000013	50GK43SB7LA000057
50GK43SB0LA000014	50GK43SB0LA000059
50GK43SB2LA000015	50GK43SB6LA000065
50GK43SB4LA000016	50GK43SB8LA000066
50GK43SB6LA000017	50GK43SB3LA000069
50GK43SB8LA000018	50GK43SBXLA000070
50GK43SBXLA000019	50GK43SB8LA000147
50GK43SB6LA000020	50GK43SBXLA000151
50GK43SB8LA000021	50GK43SB1LA000152
50GK43SBXLA000022	50GK43SB3LA000153
50GK43SB1LA000023	50GK43SB1LA000166
50GK43SB5LA000025	50GK43SB3LA000170
50GK43SB7LA000026	50GK43SB7MA000187
50GK43SB9LA000027	50GK43SB9MA000188
50GK43SB0LA000028	50GK43SB7MA000190
50GK43SB2LA000029	50GK43SB9MA000191
50GK43SB9LA000030	50GK43SB0MA000192
50GK43SB0LA000031	
50GK43SB2LA000032	
50GK43SB4LA000033	
50GK43SB6LA000034	
50GK43SB8LA000035	
50GK43SBXLA000036	
50GK43SB1LA000037	
50GK43SB3LA000038	
50GK43SB5LA000039	
50GK43SB1LA000040	
50GK43SB5LA000042	
50GK43SB7LA000043	
50GK43SB9LA000044	
50GK43SB0LA000045	
50GK43SB2LA000046	
50GK43SB4LA000047	
50GK43SB6LA000048	

STEP 1. Using a telescopic mirror (you may also need a flashlight) and camera capture an image of the radar module (Fig 3a). this can be achieved through the lower fascia opening. Extend the mirror through the opening in the front of the fascia to the back side of the radar.



Fig. 3a

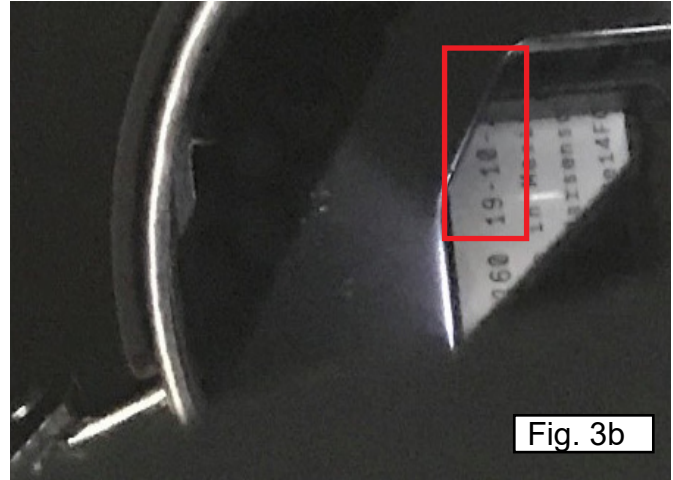

Fig. 3b

The boxed number (Fig. 3b) from the label on the AFRM will be the first item to inspect.

The image from Fig 3 above, displays a part of the AFRM unit serial label.

This visible number is the date code (as shown in Fig 4). The value shown is “Year – Month”. Below in (Fig 4a) shows “19-11” or 2019 – November.

Any date code “19-10” or earlier will require further inspection.

Any date greater than and including “19-11” does not require further inspection. For example units with “19-11”, “19-12”, “20-01” etc. do not need further inspection and the vehicle can be returned for regular use.



Fig. 4

Again any date earlier than and including “19-10” require inspection (go to step 2).

MODEL: Revero GT

TITLE: Installed Radar Assembly Verification

STEP 2. Using the mirror examine the three screws on the AFRM bracket. Confirm the plastic pin and screws are correctly inserted as shown in (Fig 5a).

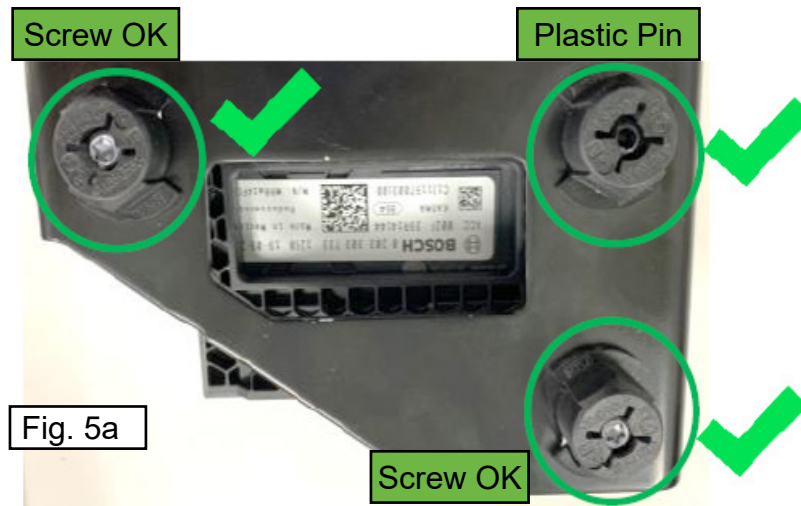

Using the same mirror, inspect each screw and retention pin for the condition, you will need to position the mirror to get the best view and make sure you have plenty of light, capturing images during this inspection is recommended for the TSS case as well. (Fig 5b)



Karma Automotive Bulletins and service documents are intended for use by experienced and trained Technicians. If you lack the skills, tools, equipment and a suitable workshop for any procedure described in this document, we suggest you leave such repairs to an Authorized Karma Service Provider or qualified service center. See your service provider for advice on whether your vehicle may benefit from the information contained within this document. The information contained in the Karma Bulletin is accurate at the date of publication. However, Karma Automotive regularly updates technical information. Please check with your Karma Automotive Service Provider that the bulletin you intend to use contains the latest available information.

MODEL: Revero GT

TITLE: Installed Radar Assembly Verification

NOTE: "Good" criteria for a AFRM module needs to have all three conditions must be satisfied:

1. Each of the 3 screws is near to the inner wall of its associated Plastic pin (the screw can be seen with the mirror) must be seated and fastened in place as shown in (Fig. 5a)
2. All three plastic pins are visually seated and not deformed (the outer flat edge of each plastic pin is parallel to the others)
3. No physical damage is seen on the Plastic Pins (Free of cracks/tears/holes)

Have a camera available and ready. Capture images of the part and serial numbers if the AFRM is to be replaced. These images must be attached to the warranty claim, the TSS case.

Any deformed or "popped-out" plastic pin or screw, is a defective condition (Fig. 6). The AFRM assembly (C131197003100) is to be replaced with a new unit.

It is recommended to inspect all inventory at the dealer.

Create a TSS case, capture and attach images of the AFRM Sticker, and plastic pin popped-out to the case, ship the removed AFRM assembly to:

Karma Automotive
 Attn: Warranty
 9950 Jeronimo
 Irvine, CA 92618

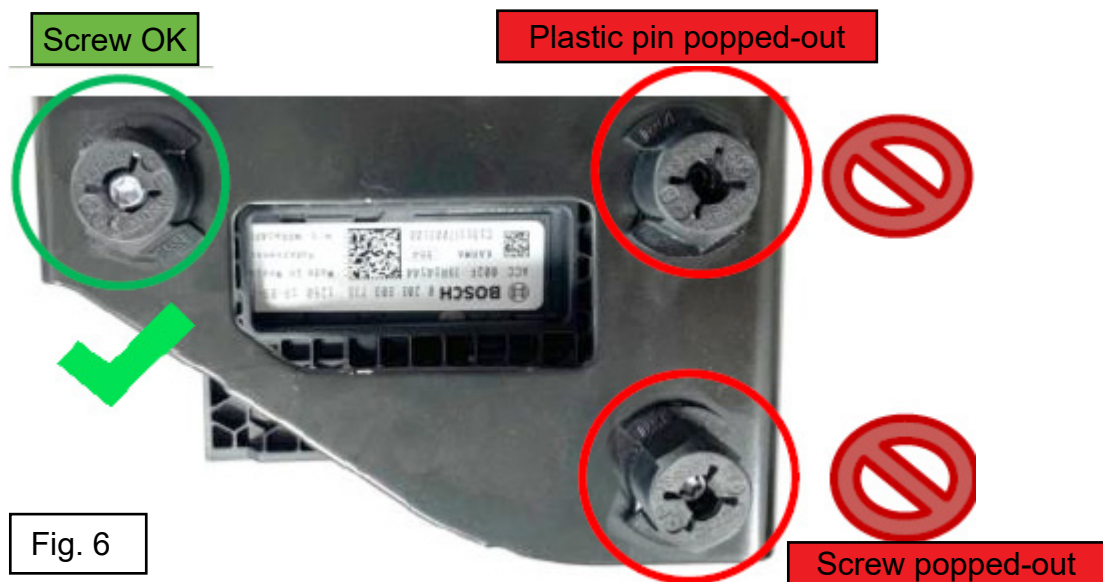

Fig. 6

Karma Automotive Bulletins and service documents are intended for use by experienced and trained Technicians. If you lack the skills, tools, equipment and a suitable workshop for any procedure described in this document, we suggest you leave such repairs to an Authorized Karma Service Provider or qualified service center. See your service provider for advice on whether your vehicle may benefit from the information contained within this document. The information contained in the Karma Bulletin is accurate at the date of publication. However, Karma Automotive regularly updates technical information. Please check with your Karma Automotive Service Provider that the bulletin you intend to use contains the latest available information.

Type: Customer Satisfaction Campaign

Year: 2020

MODEL: Revero GT

System: Electrical

TITLE: Installed Radar Assembly Verification

Sequence: 02

PART IF REQUIRED:

PART NUMBER	DESCRIPTION	QTY
C131197003100	Assembly - Radar Front K1 2.0	1

SHOP SUPPLIES:

DESCRIPTION
N/A

SPECIAL TOOLS and PARTS:

PART NUMBER	DESCRIPTION	QTY
N/A		

LABOR CODES:

CODE	DESCRIPTION	TIME	DEFECT CODE
90-25-16-08	Radar Module Inspection	0.5	90-25-16-10
Optional Labor Code			
90-25-16-10	AFRM R&R	4.0	90-25-16-10

WARRANTY NOTES:

Replacement of the AFRM, if required is as normal warranty for R&R including follow up calibration. Use only one operation code from this bulletin.

CAUSAL PART:

PART NUMBER	DESCRIPTION
C131197003100	Assembly - Radar Front K1 2.0

Karma Automotive Bulletins and service documents are intended for use by experienced and trained Technicians. If you lack the skills, tools, equipment and a suitable workshop for any procedure described in this document, we suggest you leave such repairs to an Authorized Karma Service Provider or qualified service center. See your service provider for advice on whether your vehicle may benefit from the information contained within this document. The information contained in the Karma Bulletin is accurate at the date of publication. However, Karma Automotive regularly updates technical information. Please check with your Karma Automotive Service Provider that the bulletin you intend to use contains the latest available information.