



NUMBER: 10-001-20

GROUP: 10 - Restraints

DATE: October 17, 2020

This bulletin is supplied as technical information only and is not an authorization for repair. No part of this publication may be reproduced, stored in a retrieval system, or transmitted, in any form or by any means, electronic, mechanical, photocopying, or otherwise, without written permission of FCA US LLC.

This bulletin supersedes Technical Service Bulletin (TSB) 10-002-18, date of issue November 17, 2020, which should be removed from your files. All revisions are highlighted with **asterisks**** and include Additional markets.**

SUBJECT:

Airbag Warning Lamp (AWL) Illuminated B0028-13 and B0020-13

OVERVIEW:

This bulletin involves inspecting and installing a jumper harness in the front seats if needed.

MODELS:

2014 - 2017	(KL)	Jeep Cherokee
2015 - 2017	(UF)	Chrysler 200

NOTE: This bulletin applies to vehicles within the following markets/countries: **North America, EMEA, APAC and LATAM.******

NOTE: This bulletin applies to vehicles equipped with Supplemental Frt Seat Side Airbag (Sales Code CJ1).

SYMPTOM/CONDITION:

Customers may experience a AWL illumination. Upon further investigation, the technician may find one or more of the following Diagnostic Trouble Codes (DTCs) set in memory:

- B0028-13 - Right Side Seat Deployment Squib 1 - Circuit Open.
- B0020-13 - Left Side Seat Deployment Squib 1 - Circuit Open.

DIAGNOSIS:

Using a Scan Tool (wiTECH) with the appropriate Diagnostic Procedures available in DealerCONNECT/Service Library, verify all related systems are functioning as designed. If DTCs or symptom conditions, other than the ones listed above are present, record the issues on the repair order and repair as necessary before proceeding further with this bulletin.

If the customer describes the symptom/condition listed above and the technician finds the DTC, perform the Repair Procedure.

PARTS REQUIRED:

Qty.	Part No.	Description
2 (AR)	68395045AA	Wiring, Airbag Jumper (UF Vehicles)
2 (AR)	68395046AA	Wiring, Airbag Jumper (KL Vehicles)
8	68248870AA	Bolt, Seat Back (UF Vehicles)
8	68104960AA	Bolt, Seat Back (KL Vehicles)
AR	06106188AA or Equivalent	Nylon Tie Strap

REPAIR PROCEDURE:

NOTE: Both jumper harnesses should be replaced, even if only one of the DTCs listed above were found.

CAUTION! Disconnect and isolate the battery negative (ground) cable, then wait two minutes for the system capacitor to discharge before performing further diagnosis or service. This is the only sure way to disable the SRS. Failure to follow these instructions may result in accidental airbag deployment.

1. Remove both front seats from the vehicle. Refer to the detailed service procedures available in DealerCONNECT> Service Library under: 23 - Body/Seats, Front/Seat/Removal.

NOTE: Remove and discard seat back bolts, new bolts will be needed when putting the seats back together.

2. Remove the seat back from the seat cushion. Refer to the detailed service procedures available in DealerCONNECT> Service Library under: 23 - Body/Seats, Front/Seat Back, Front/Removal.

NOTE: The headrest does not have to be removed. The seat back cover does not have to be completely removed, just opened, to gain access to the main seat harness.

3. Open the seat back cover. Refer to the detailed service procedures available in DealerCONNECT> Service Library under: 23 - Body/Seats, Front/Seat Back, Front/Disassembly.
4. Disconnect the seat wire harness connector from the top of the Seat Air Bag (SAB) inflator. Pull the Connector Position Assurance (CPA) lock straight out from the connector, then pull the connector straight out from the connector receptacle to disengage and disconnect it.
5. Cut off the SAB connector and apply tape over the wires to secure them into the harness bundle.

NOTE: The terminal location in the connector is the same for the right and left seats. See (Fig. 1) for connector end view on KL vehicles. See (Fig. 2) for connector end view on UF vehicles.

6. Remove the squib circuits from the seat to body in-line connector (left I401, right I400). The circuit numbers for the left seat is R5 and R7 and the right seat is R6 and R8.

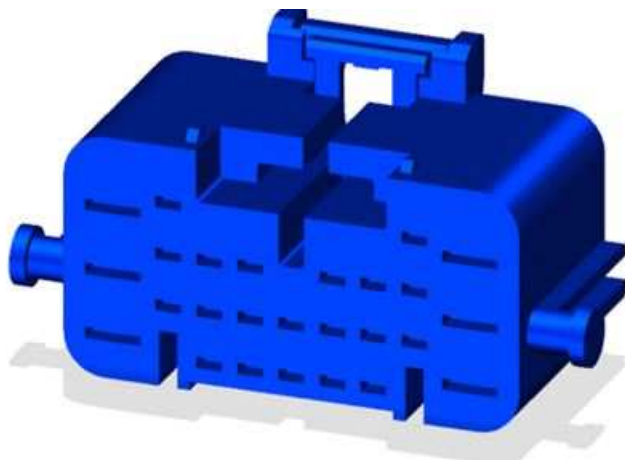
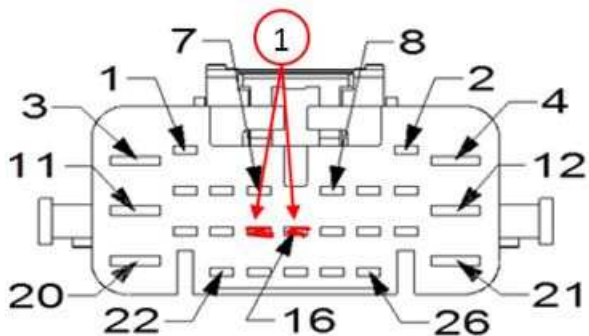

Fig. 1
Terminal Locations for KL Vehicles.

1 - **The cavity numbers for both left and right seats are 15 and 16.**

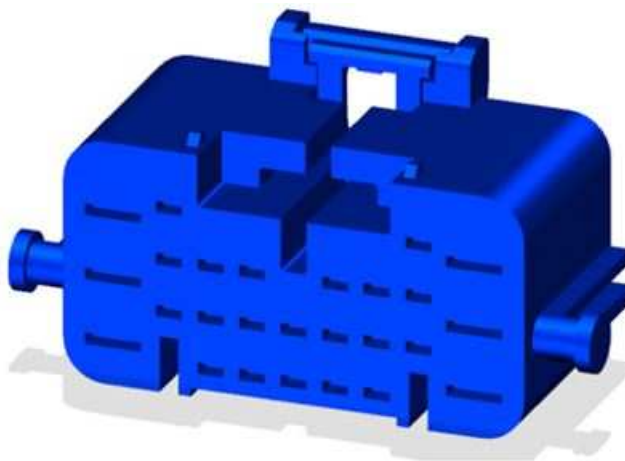
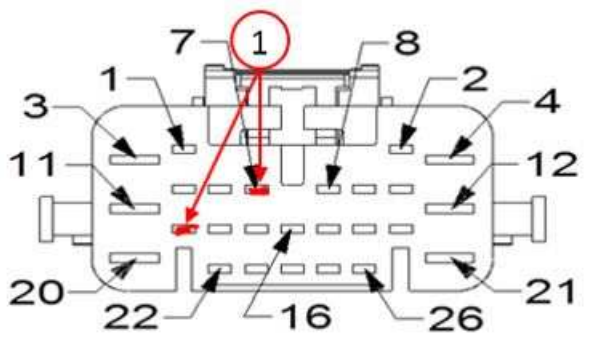

Fig. 2
Terminal Locations for UF Vehicles.

1 - **The cavity numbers for both left and right seats are 7 and 13.**

7. Cut the terminals off the circuits and apply tape over the wires to secure them onto the harness bundle.

- The jumper harness will be routed between the SAB and the Seat to Body in-line connector. The jumper harness will by-pass the seat cushion in-line connector. See (Fig. 3) for jumper harness routing.

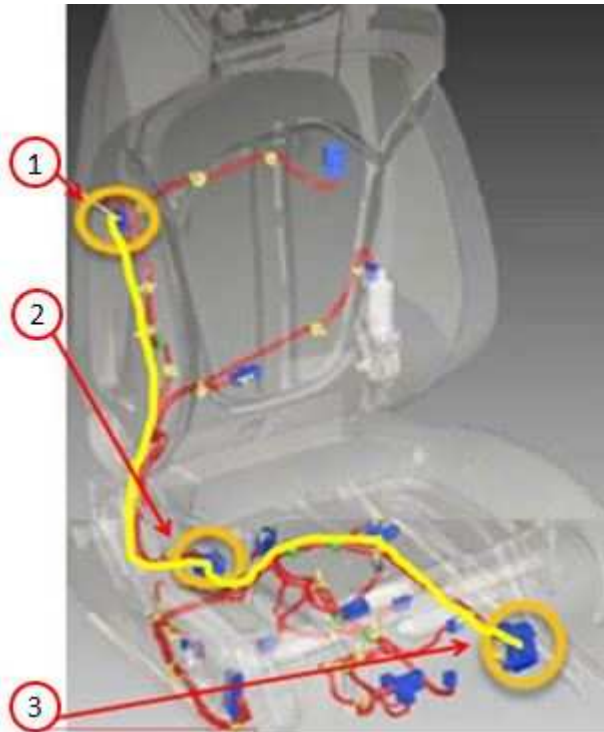

Fig. 3
Jumper Harness Routing

- 1 - SAB Connector
- 2 - Seat In-line Connector
- 3 - Seat to Body In-line Connector

9. Connect the jumper harness connector to the SAB inflator. Make sure that the connector is fully engaged by listening for an audible click noise as the connector snaps into place.
10. Push the CPA lock tab firmly into the SAB connector insulator until it is flush with the upper surface of the insulator.

11. Route and secure the jumper harness along the existing seat back harness, see (Fig. 4) .
By-pass the seat in-line and continue to route the jumper on the seat cushion harness, see (Fig. 5) .



Fig. 4
Seat Back

- 1 - SAB Connector
- 2 - Jumper Harness
- 3 - Seat Back Main Harness

NOTE: The KL jumper harness may be longer than the existing seat harness, this is normal. The jumper harness fits many KL seat configurations that need a longer harness. The extra wire harness should be attached to the seat back harness. Take care to attached it tight to the main seat harness, to avoid the jumper rubbing on the seat back cover.

NOTE: Nylon tie straps are to be used at all existing main harness attachment points.

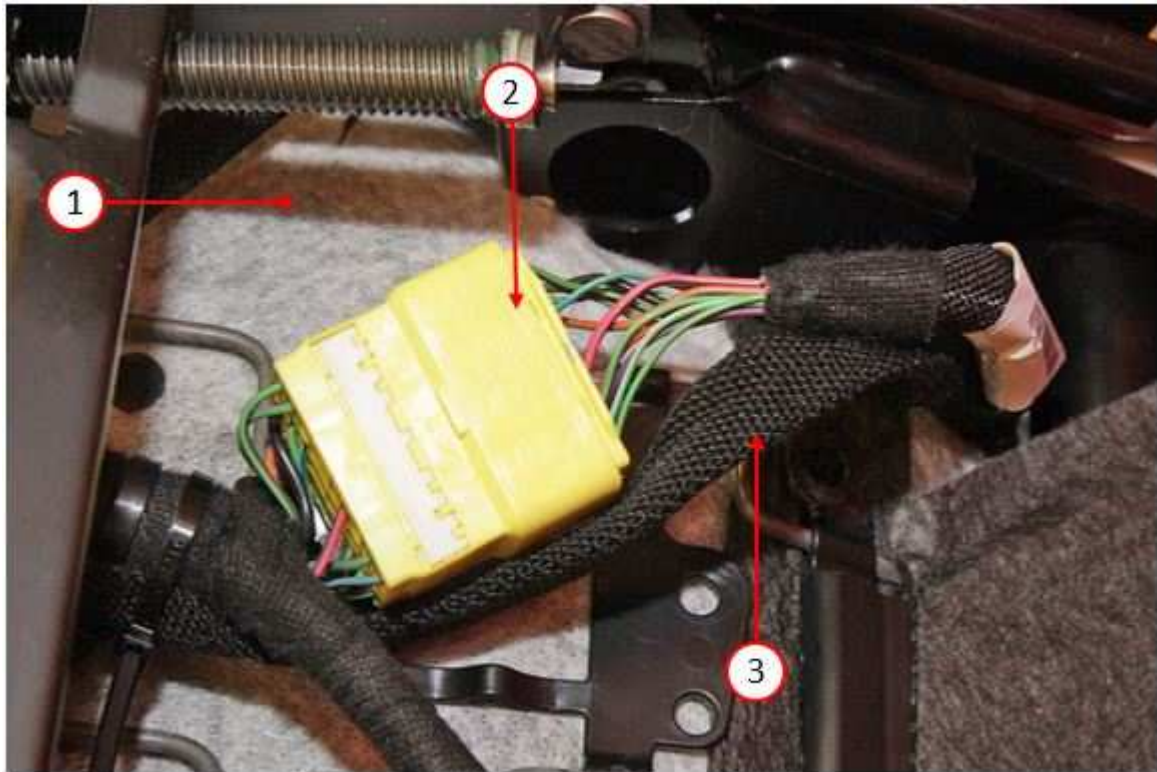

Fig. 5
Seat Bottom

- 1 - Bottom of Seat Cushion
- 2 - By-Passed, Seat Cushion Connector
- 3 - Jumper Harness

12. Install the squib circuits into the Seat to Body in-line connector (left I401, right I400). The circuit numbers are R5 and R7 for the left seat and R6 and R8 are for the right seat.
13. Close the seat back cover. Refer to the detailed service procedures available in DealerCONNECT> Service Library under: 23 - Body/Seats, Front/Seat Back, Front/Assembly
14. Install the seat back on to the seat cushion. Refer to the detailed service procedures available in DealerCONNECT> Service Library under: 23 - Body/Seats, Front/Seat Back, Front/Installation.
15. Repeat steps 2 through step 14 of the Repair Procedure, for the other front seat.

CAUTION! Before connecting the battery cable the Supplemental Restraint System (SRS) verification test needs to be performed.

16. Place the seats in the vehicle and connect the seat connector to the body harness, then perform the SRS verification test.
17. Complete the seat installation. Refer to the detailed service procedures available in DealerCONNECT> Service Library under: 23 - Body/Seats, Front/Seat/Install.
18. Using the scan tool (wiTECH) perform the Occupant Classification Module configure and the Electric Power Steering (EPS) verification test.
19. Use the scan tool (wiTECH) to clear all DTCs that may have been set.

POLICY:

Reimbursable within the provisions of the warranty.

TIME ALLOWANCE:

Labor Operation No:	Description	Skill Category	Amount
08-91-PW-90	Harness, Front Seat Side Airbag - Install Overlay (Both Sides) (2 - Skilled)	6 - Electrical And Body Systems	2.0 Hrs.

FAILURE CODE:

ZZ	Service Action
----	----------------