

STAR ONLINE PUBLICATION

Case Number: S2008000162

Release Date: 10/23/2020

Symptom/Vehicle Issue: Power Lift-gate Will Not Close From Power Lift-gate Button

Customer Complaint/ Technician Observation: Owner complains that the lift-gate will not close from the lift-gate button and a chime sounds rapidly when pressing the button. Technician observed the lift-gate will not respond to the button during testing and DTC, B1945-12 Power Liftgate Pinch Sensor 2-Circuit Short to Battery stored Fig 1, 2.

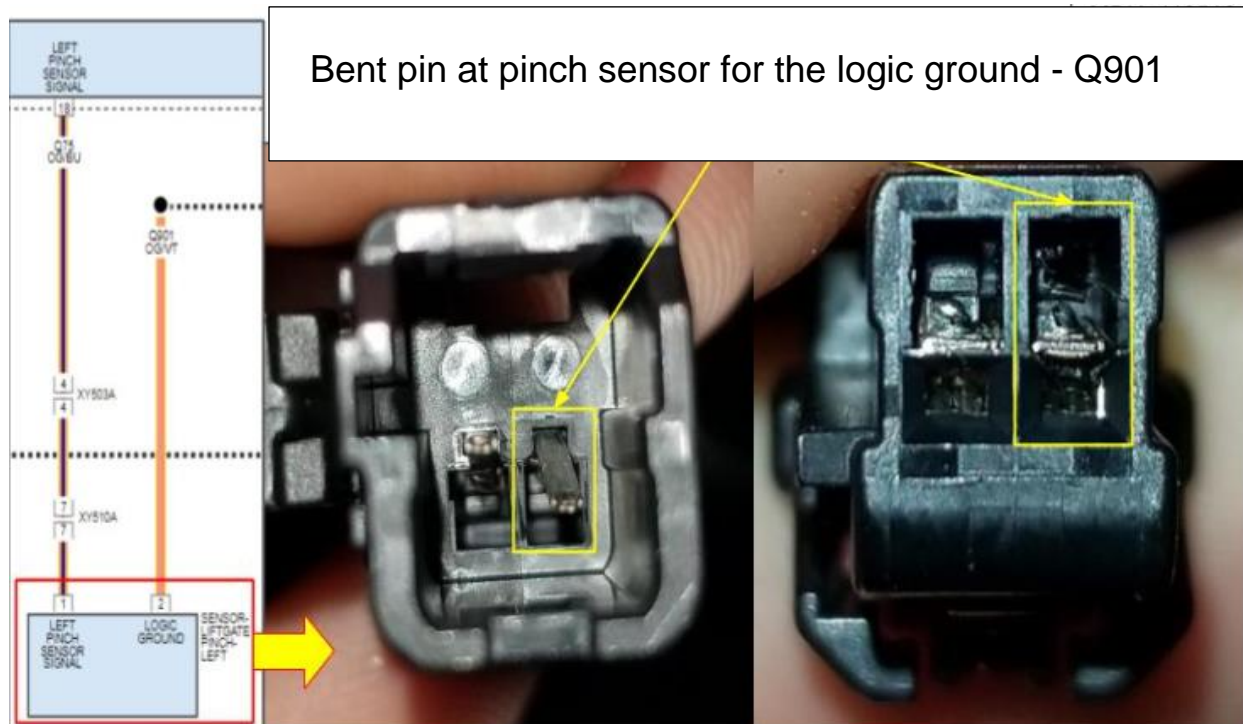

Fig 1

This document does not authorize warranty repairs. This communication documents a record of past experiences. STAR Online does not provide any conclusions about what is wrong with the vehicle. Rather, it captures all previous cases known that appear to be similar or related to the vehicle symptom / condition. You are the expert, and you are responsible for deciding on the appropriate course of action.

Contact STAR Center, or your Technical Assistance Center Via TechCONNECT or eCONTACT ticket if no solution is found

STAR ONLINE PUBLICATION

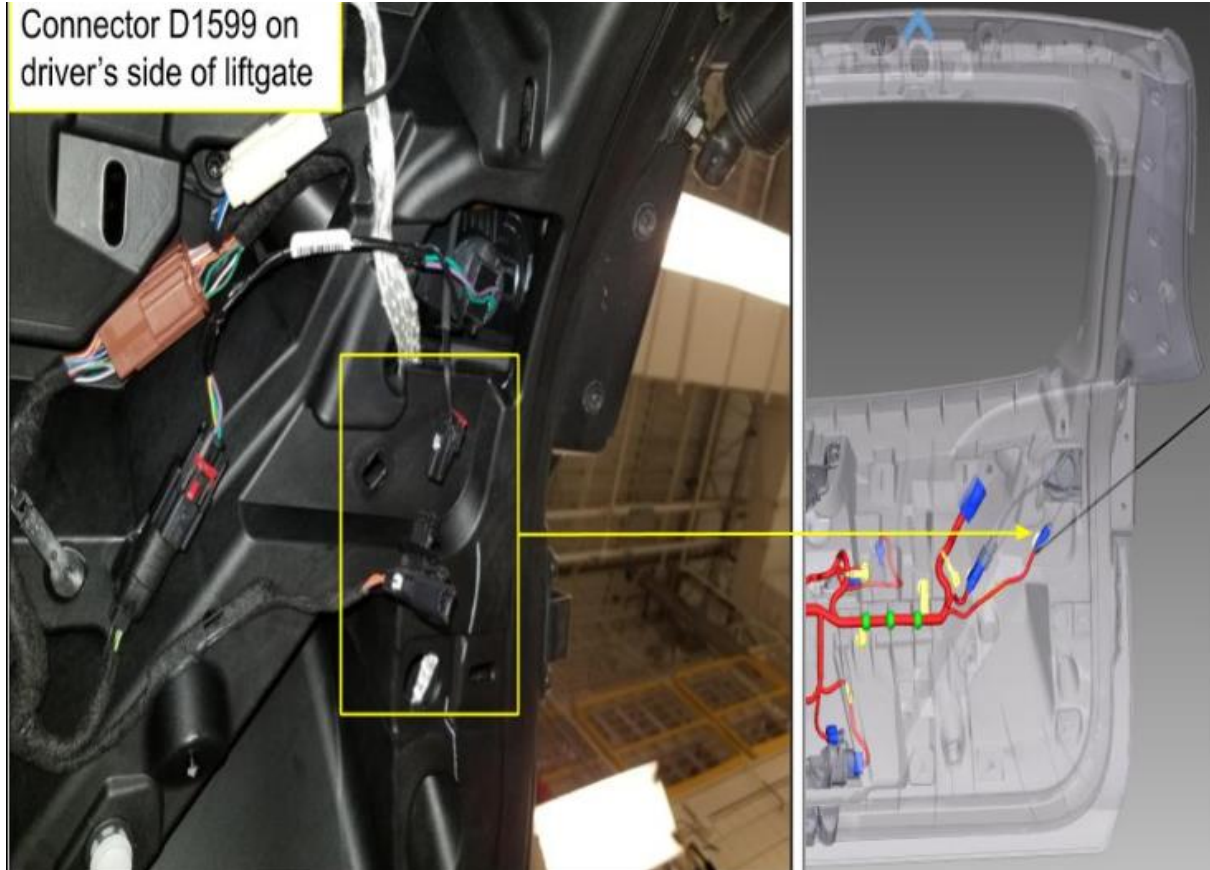

Fig 2

This document does not authorize warranty repairs. This communication documents a record of past experiences. STAR Online does not provide any conclusions about what is wrong with the vehicle. Rather, it captures all previous cases known that appear to be similar or related to the vehicle symptom / condition. You are the expert, and you are responsible for deciding on the appropriate course of action.

Contact STAR Center, or your Technical Assistance Center Via TechCONNECT or eCONTACT ticket if no solution is found