

# 2021 Camry, Camry HV Pre-Delivery Service (PDS)

**Service Category** General

**Section** Pre-Delivery Service

**Market** USA

Toyota Supports  
ASE Certification 

## Applicability

YEAR(S)	MODEL(S)	ADDITIONAL INFORMATION
2021	Camry, Camry HV	

## Introduction

Pre-Delivery Service (PDS) is a critical step in satisfying our new car customers. Customer feedback indicates the following areas deserve special attention when performing PDS:

- Careful inspection for paint chips/scratches and body dents/dings.
- Proper operation of electrical accessories (including interior light, clock, and radio reset).
- Interior cleanliness.
- Proper function of mechanical systems.

Customer retention and proper maintenance of vehicles are and have always been a major focus for Toyota. To help remind customers that regular service is essential to the proper maintenance of the vehicle, dealers are required to install a service reminder sticker before delivery. By doing this, customers will be reminded to return to your dealership for service. Your current service reminder sticker may be used. (See PDS Check Sheet item 8 of "Final Inspection and Cleaning.")

This bulletin contains the PDS procedures which apply specifically to 2021 model year Camry and Camry Hybrid vehicles. A universal PDS [Check Sheet](#) that contains PDS steps that apply to all 2021 model year Toyota vehicles has been developed. To properly perform a complete PDS, you must complete all procedures contained in this TSB as well as the universal PDS [Check Sheet](#).

In addition, if the vehicle is stored for over 30 days, be sure to follow [Long-Term Vehicle Storage Guidelines](#).

## 2021 Camry, Camry HV Pre-Delivery Service (PDS)

### Warranty Policy

If the need for additional repairs or adjustment is noted during PDS, the required service should be performed under warranty. Reimbursement will be managed under the warranty policy.

**The Warranty Policy and Procedures Manual requires that you maintain the completed Check Sheet in the customer's file.** If you cannot produce a completed form for each retailed vehicle upon TMS and/or Region/Distributor audit, the PDS payment amount will be subject to debit.

An additional Repair Order completed in conjunction with normal PDS MUST have time punch/flags for service. If multiple repairs are performed, separate time flags MUST be punched for each repair.

### Warranty Information

OP CODE	DESCRIPTION	MODEL	TIME	OFF	T1	T2
001013	Pre-Delivery Service (PDS)	Camry	1.0	—	—	—
		Camry HV	1.5			

### Required Tools & Equipment

REQUIRED EQUIPMENT	SUPPLIER	PART NUMBER	QTY
Techstream ADVi*	ADE	TSADVUNIT	1
Techstream 2.0		TS2UNIT	
Techstream Lite		TSLITEPDLR01	
Techstream Lite (Green Cable)		TSLP2DLR01	

\*Essential SST.

#### NOTE

- Only ONE of the Techstream units listed above is required.
- Software version 15.20.016 or later is required.
- Additional Techstream units may be ordered by calling Approved Dealer Equipment (ADE) at 1-800-368-6787.

## 2021 Camry, Camry HV Pre-Delivery Service (PDS)

---

### Procedures

• <a href="#"><u>D/C Cut Fuse Installation*</u></a> .....	4
• <a href="#"><u>Memorize Steering Angle Neutral Point*</u></a> .....	5
• <a href="#"><u>Steering Sensor Zero Point Calibration*</u></a> .....	5
• <a href="#"><u>Compass Calibration*</u></a> .....	6
• <a href="#"><u>Removal of Front Emergency Towing Eyelets</u></a> .....	8
• <a href="#"><u>Installation of Towing Eyelet Hole Covers</u></a> .....	9
• <a href="#"><u>Front Wheel Opening Extension Pad Installation</u></a> .....	10
• <a href="#"><u>Front License Plate and Mounting Bracket Installation*</u></a> .....	11
• <a href="#"><u>Tire Pressure Warning System (TPWS) Initialization</u></a> .....	12
• <a href="#"><u>Dealer Contact Information for Call Dealer Head Unit Function</u></a> .....	12
• <a href="#"><u>Entune™ 3.0 App Suite Connect Initialization/Update</u></a> .....	12

\*If applicable.

## 2021 Camry, Camry HV Pre-Delivery Service (PDS)

### D/C Cut Fuse Installation

To minimize battery discharge, the D/C cut fuse (25A) has been removed and is stored in the engine compartment relay block. Install the D/C cut fuse (25A) and confirm ALL related Diagnostic Trouble Codes (DTCs) are cleared.

#### NOTE

This step is ONLY necessary on Japan produced vehicles (VINs starting with “J”) marketed in the continental United States, and on ALL vehicles in Hawaii, Puerto Rico, Saipan, Guam, and American Samoa.

Figure 1.

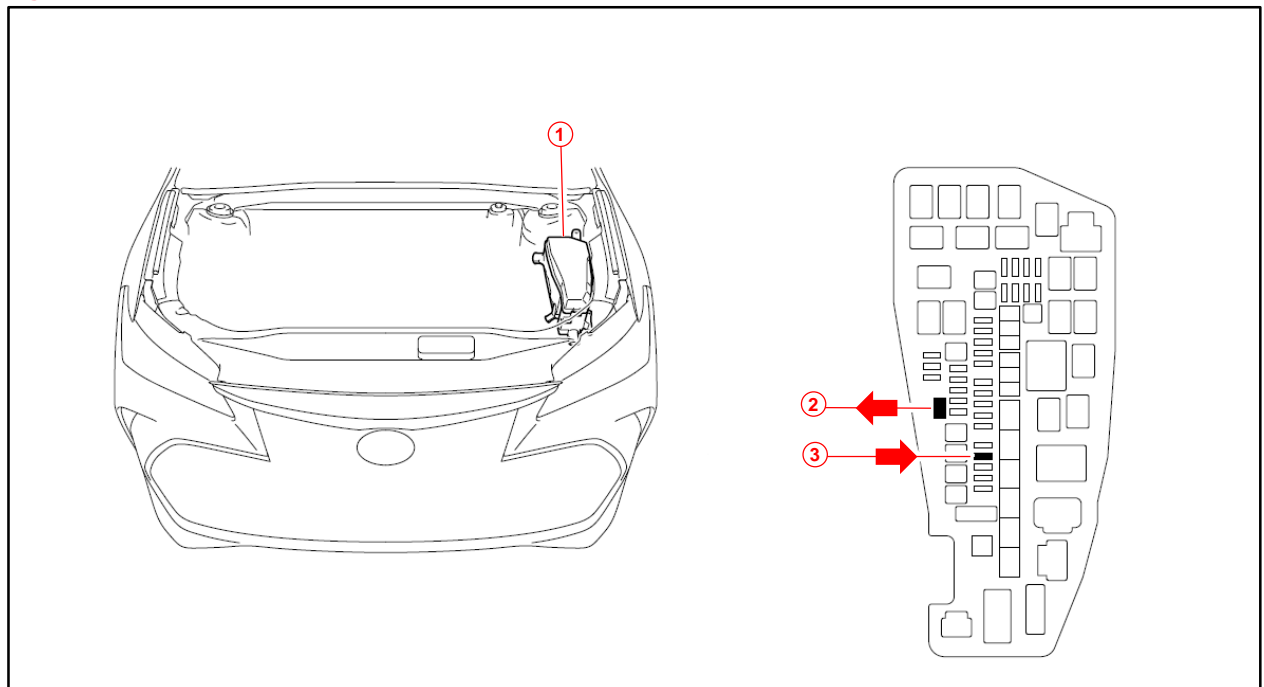

1	Relay Block
2	Remove D/C Cut Fuse (25A)
3	Install D/C Cut Fuse (25A)

## 2021 Camry, Camry HV Pre-Delivery Service (PDS)

---

### Memorize Steering Angle Neutral Point

As a result of the removal of the D/C cut fuse, the power source to the steering angle sensor is cut off. When the D/C cut fuse is reinstalled, the parking assist monitor system/panoramic view monitor system will be operative, but it cannot display guidelines to assist parking operation because the center position recognized by the steering angle sensor may not be in an initial position. Therefore, perform steering angle neutral point initialization AFTER installing the D/C cut fuse during PDS.

Refer to the applicable Repair Manual for the steering angle neutral point initialization procedure ([Camry](#) / [Camry HV](#)).

### Steering Sensor Zero Point Calibration

As a result of the removal of the D/C cut fuse, the steering angle sensor power source is cut off. When the D/C cut fuse is reinstalled, the center position recognized by the steering angle sensor may not be the appropriate position. Therefore, it is necessary to perform steering sensor zero point calibration AFTER installing the D/C cut fuse during PDS.

Refer to the applicable Repair Manual for the steering sensor zero point calibration procedure:

- Driving Method ([Camry](#) / [Camry HV](#)).
- Techstream Method ([Camry](#) / [Camry HV](#)) (procedure 4).

## 2021 Camry, Camry HV Pre-Delivery Service (PDS)

### Compass Calibration

The compass indicates the direction that the vehicle is heading by detecting the direction and strength of the Earth's magnetic field and processing this data using the compass sensor and microcomputer. Detection of the direction and strength of the Earth's magnetic field vary according to the area in which the vehicle is used and is affected by the residual magnetism of the vehicle. For this reason, the geographic direction displayed may also deviate from the direction determined by the Earth's magnetic field according to the area in which the vehicle is used. Therefore, please perform the initial calibration of the compass in your dealership prior to delivery to customers.

#### NOTE

- Do NOT perform calibration of the compass in a place where the Earth's magnetic field is subject to interference (underground parking, under a steel tower, between buildings, roof parking, near a railroad crossing, near a large vehicle, etc.).
- Do NOT operate electric systems during the calibration (moonroof, power windows, etc.), as they may interfere with the calibration.
- The dot on the compass display disappears when calibration has been completed.

Figure 2.

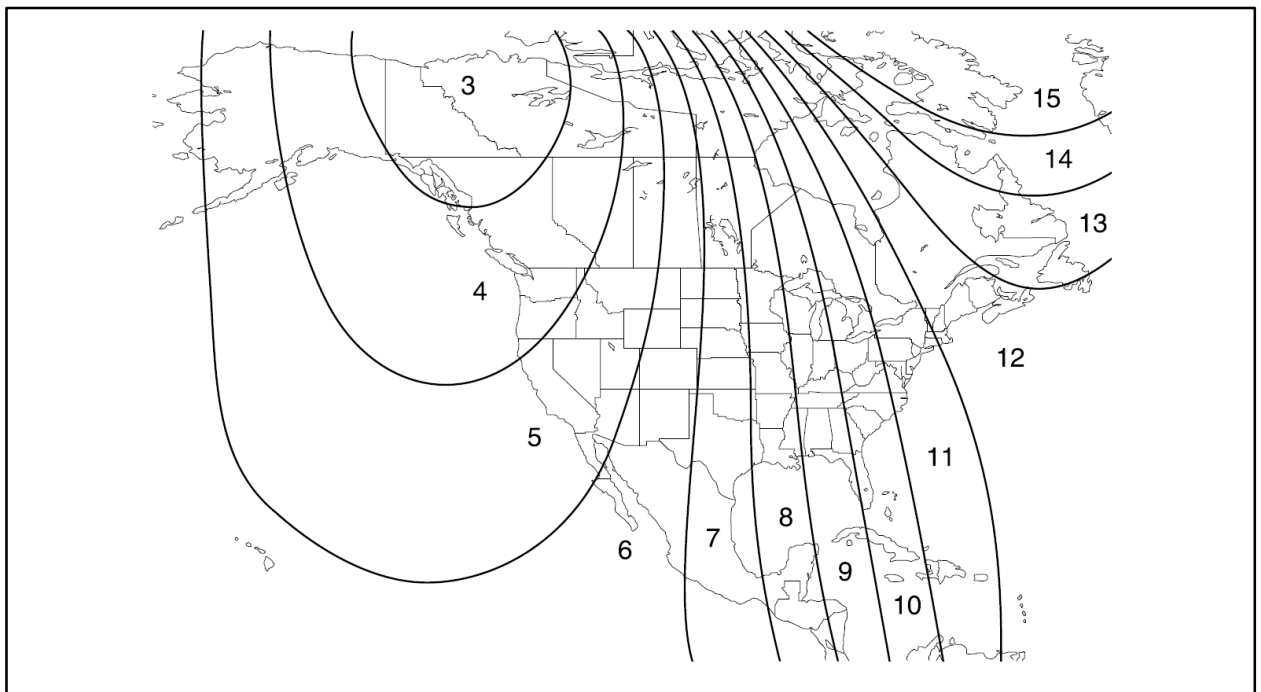

## 2021 Camry, Camry HV Pre-Delivery Service (PDS)

### Compass Calibration (continued)

#### Deviation Calibration Procedure

1. Turn the engine switch (ignition switch) to the ON position (ON mode). Then, push and hold the mirror switch until the zone number appears on the display.

#### HINT

Pushing the mirror switch turns the compass display ON or OFF.

2. Push the mirror switch to select the number of the zone where the vehicle is located. See Figure 2 for zone reference.

Figure 3.

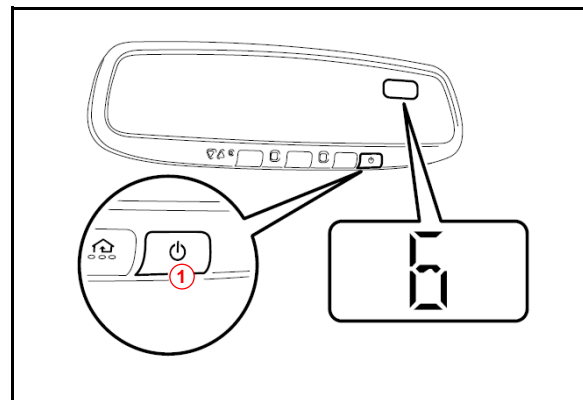

1 Mirror Switch

#### Circling Calibration Procedure

1. Start the engine (hybrid system) and push and hold the mirror switch until C appears on the display.
2. Drive the vehicle slowly at 5 mph (8 km/h) or lower in a circle. If there is not enough space to drive in a circle, turn the car around in the following manner, doing two three-point turns in succession. After driving in one to three circles in the above method, calibration has been completed and the direction is shown on the display.

#### NOTE

- Do NOT perform calibration of the compass in a place where the Earth's magnetic field is subject to interference (underground parking, under a steel tower, between buildings, roof parking, near a railroad crossing, near a large vehicle, etc.).
- Do NOT operate electric systems during the calibration (moonroof, power windows, etc.), as they may interfere with the calibration.

Figure 4.

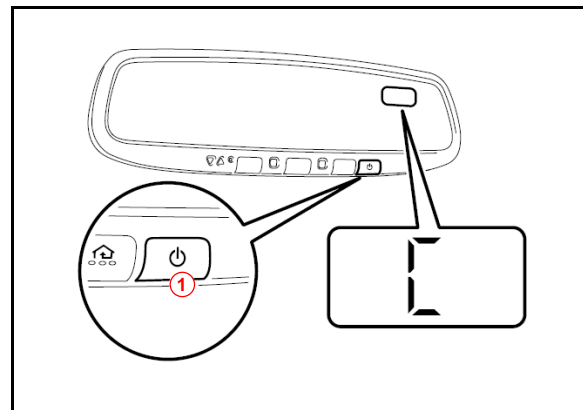

1 Mirror Switch

Figure 5.

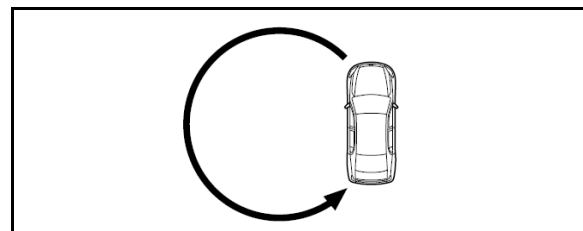

1 Drive Pattern

## 2021 Camry, Camry HV Pre-Delivery Service (PDS)

### Removal of Front Emergency Towing Eyelets

1. Remove the two front emergency towing eyelets from the front bumper by turning them counterclockwise.

#### HINT

If it is difficult to loosen the front emergency towing eyelet, use a steel bar.

Figure 6.

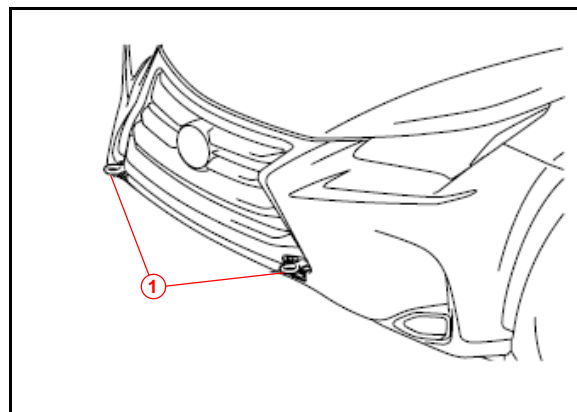

1 Front Emergency Towing Eyelets

2. Place one of the removed front emergency towing eyelets into the storage box in the luggage compartment.

#### HINT

Dispose of the other removed emergency towing eyelet.

Figure 7.

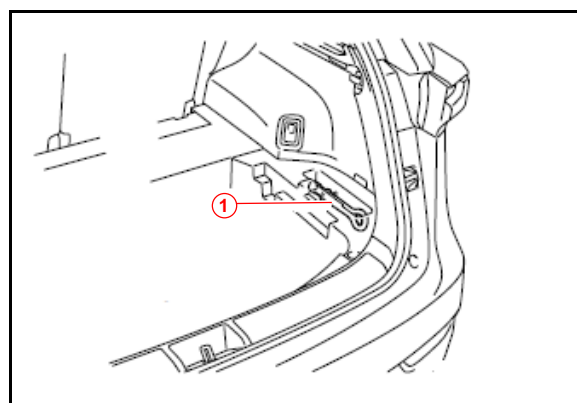

1 Emergency Towing Eyelet



## 2021 Camry, Camry HV Pre-Delivery Service (PDS)

### Installation of Towing Eyelet Hole Covers

1. Install the two front bumper No. 2 front emergency towing eyelet hole covers, which are stored in the glove compartment, onto the front bumper.

A. Insert the arrow-shaped part (A) of the front emergency towing eyelet hole covers into eyelet holes (B) as shown in the illustration.

B. Install the front emergency towing eyelet hole covers into the hole of the front bumper.

**Figure 8.**

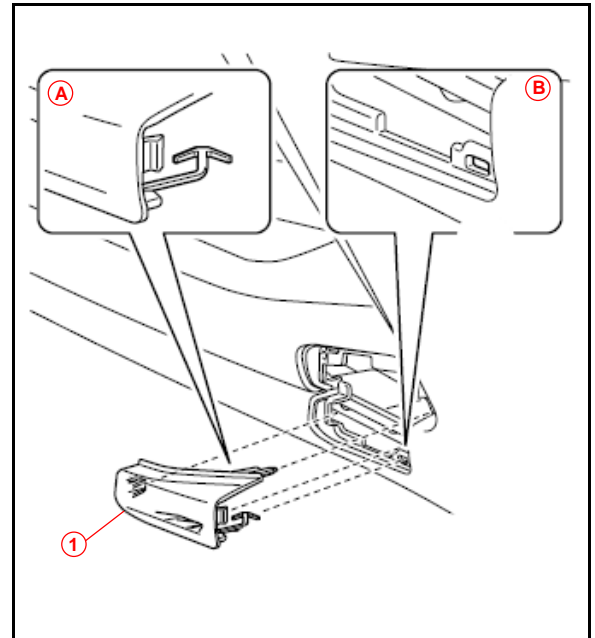

<b>A</b>	Arrow-shaped Part
<b>B</b>	Eyelet Hole
<b>1</b>	Front Emergency Towing Eyelet Hole Cover

## 2021 Camry, Camry HV Pre-Delivery Service (PDS)

### Front Wheel Opening Extension Pad Installation

The front wheel opening extension pad set (right and left front wheel opening extension pads) are located in the luggage compartment at the assembly plant to avoid damage in transit.

1. Remove the three self-tapping screws from the engine under cover (the self-tapping screws will be reused for installation).

**HINT**

The removed self-tapping screws are reused when installing the front wheel opening extension pad.

2. Place the left front wheel opening extension pad on the installation position as shown and tighten the three self-tapping screws.

**HINT**

There is a distinguishable mark on each pad.

3. Repeat steps 1 and 2 for the right-hand side.

**Figure 9.**

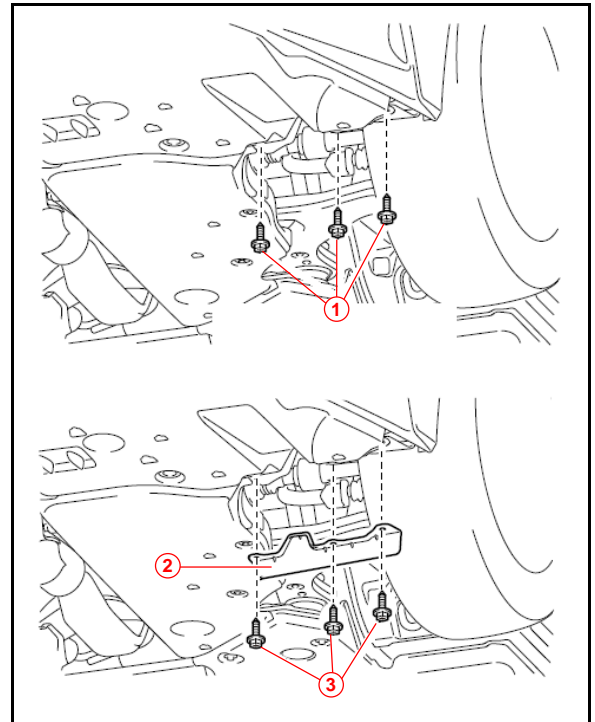

<b>1</b>	<b>Remove Self-tapping Screw</b>
<b>2</b>	<b>Front Wheel Opening Extension Pad</b>
<b>3</b>	<b>Install Self-tapping Screw</b>

## 2021 Camry, Camry HV Pre-Delivery Service (PDS)

### Front License Plate and Mounting Bracket Installation

The front license plate mounting bracket set (front license plate mounting bracket, four long self-tapping screws, and two short self-tapping screws) is loaded in the luggage compartment at the assembly plant. Follow this procedure to install the front license plate bracket and front license plate in states where it is required by law.

1. Align the holes on the front license plate mounting bracket with the dimples on the front of the lower grille.
2. Install the two long self-tapping screws through the holes on the front license plate mounting bracket into the lower grille.

**Long Self-tapping Screw: 37 mm (1.456 in.)**

#### NOTICE

- Do NOT pre-drill holes into the bumper.
- Do NOT overtighten the self-tapping screws.

3. Insert the license plate into the tabs on the bracket.
4. Align the holes on the license plate with the corresponding holes of the front license plate mounting bracket.
5. Install the two short self-tapping screws through the holes on the front license plate mounting bracket and license plate.

**Short Self-tapping Screw: 20 mm (0.787 in.)**

#### NOTICE

- Do NOT pre-drill holes through the front license plate mounting bracket.
- Do NOT overtighten the self-tapping screws.

**Figure 10.**

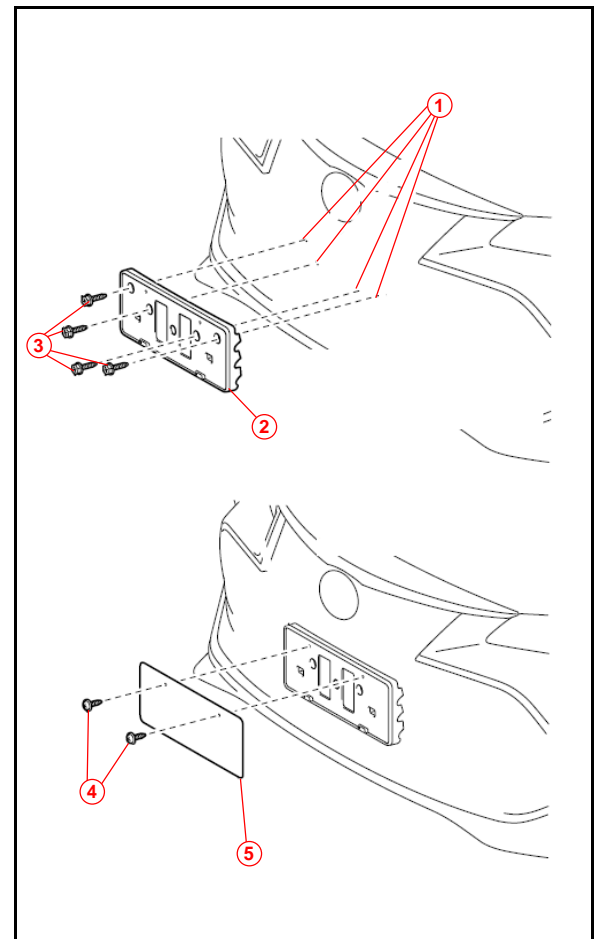

1	Dimple
2	Front License Plate Mounting Bracket
3	Long Self-tapping Screw
4	Short Self-tapping Screw
5	Front License Plate

## 2021 Camry, Camry HV Pre-Delivery Service (PDS)

---

### Tire Pressure Warning System (TPWS) Initialization

Refer to the applicable Repair Manual for the TPWS initialization procedure ([Camry](#) / [Camry HV](#)). Note the spare tire does NOT have a TPWS sensor.

#### NOTE

To adjust the tire pressure correctly when the outside temperature is significantly colder than shop temperature, perform a Health Check using Techstream and select the compensation tire pressure checkbox. Compensation pressures will display on the Health Check results screen. Adjust the tire pressure when the tires are cold.

### Dealer Contact Information for Call Dealer Head Unit Function

Refer to the *Multimedia System Owner's Manual* to add dealer contact information ([Camry](#) / [Camry HV](#)).

#### NOTE

This step is not applicable to the following Camry models without optional audio:

- L
- LE
- SE
- TRD
- Nightshade

### Entune™ 3.0 App Suite Connect Initialization/Update

Refer to [T-SB-0039-20](#) *Entune™ 3.0 App Suite Connect* to initialize/update the Entune™ 3.0 App Suite Connect.