

LTB00861NAS3



# TECHNICAL BULLETIN

05 OCT 2020

© Jaguar Land Rover North America, LLC

NOTE: The information in Technical Bulletins is intended for use by trained, professional Technicians with the knowledge, tools, and equipment required to do the job properly and safely. It informs these Technicians of conditions that may occur on some vehicles, or provides information that could assist in proper vehicle service. The procedures should not be performed by 'do-it-yourselfers'. If you are not a Retailer, do not assume that a condition described affects your vehicle. Contact an authorized Land Rover service facility to determine whether this bulletin applies to a specific vehicle.

## INFORMATION

---

**This reissue replaces all previous versions. Please destroy all previous versions.**

This bulletin supersedes TSB LTB00861NAS2/2016 dated 10 OCT 2016, which should either be destroyed or clearly marked to show it is no longer valid (e.g. with a line across the page). Only refer to the electronic version of this Technical Bulletin in TOPIx.

Changes are highlighted in blue

---

## SECTION:

501-08

## SUBJECT/CONCERN:

Roof Molding Loose / Adrift

## AFFECTED VEHICLE RANGE:

MODEL:

MODEL YEAR:

VIN:

ASSEMBLY PLANT:

MODEL:	MODEL YEAR:	VIN:	ASSEMBLY PLANT:
Range Rover Sport (LW)	2014	300000-399999	Solihull
Range Rover Sport (LW)	2014-2016	500000-599999	Solihull
Range Rover Sport (LW)	2014-2017	600000-688555	Solihull
Range Rover Sport (LW)	2016-2017	100000-156788	Solihull
Range Rover (LG)	2013-2017	001204-353188	Solihull

---

## MARKETS:

NORTH AMERICA

---

## CONDITION SUMMARY:

### SITUATION:

The roof molding(s) may be loose / adrift.

### CAUSE:

This may be caused by incorrect installation of the roof molding.

### ACTION:

Follow the instructions below.

---

## PARTS:

PART NUMBER	DESCRIPTION	QUANTITY
LR078295	Adhesive kit	1
LR056666	Roof molding fixing kit - Non-Panoramic Roof - Range Rover Sport (L494)	1
LR075337	Roof molding fixing kit - Right - No sunroof - Range Rover Sport (L494)	1
LR075339	Roof molding fixing kit - Left - No sunroof - Range Rover Sport (L494)	1
LR072887	Roof molding fixing kit - Right - Range Rover Sport (L494)	1

PART NUMBER	DESCRIPTION	QUANTITY
LR072889	Roof molding fixing kit - Left - Range Rover Sport (L494)	1
LR056667	Roof molding fixing kit - Panoramic Roof - Range Rover Sport (L494)	1
LR052896	Roof molding fixing kit - Non-Panoramic Roof - Range Rover (L405)	1
LR072882	Roof molding fixing kit - Right - Range Rover (L405)	1
LR072883	Roof molding fixing kit - Left - Range Rover (L405)	1
LR075344	Roof molding fixing kit - Right - Range Rover (L405)	1
LR075165	Roof molding fixing kit - Left - Range Rover (L405)	1
LR075166	Roof molding fixing kit - Long Wheelbase - Right - Range Rover (L405)	1
LR075291	Roof molding fixing kit - Long Wheelbase - Left - Range Rover (L405)	1
LR052895	Roof molding fixing kit - Panoramic Roof - Range Rover (L405)	1

## WARRANTY:

### NOTES:

- Repair procedures are under constant review, and therefore times are subject to change; those quoted here must be taken as guidance only. Use TOPIx to obtain the latest repair time.
- The JLR claims submission system requires the use of causal part numbers. Labor only claims must show the causal part number with a quantity of zero.

DESCRIPTION	SRO	TIME (HOURS)	CONDITION CODE	CAUSAL PART
Roof molding - Left - Repair	76.42.89.32	0.2	07	RZM500041
Roof molding - Right - Repair	76.42.89.33	0.2	07	RZM500041
Roof molding - Both sides - Repair	76.42.89.34	0.4	07	RZM500041

**NOTE:**

Normal Warranty procedures apply.

## SERVICE INSTRUCTION:

1.

**NOTE:**

Range Rover (L405) non-panoramic roof shown; all others similar.

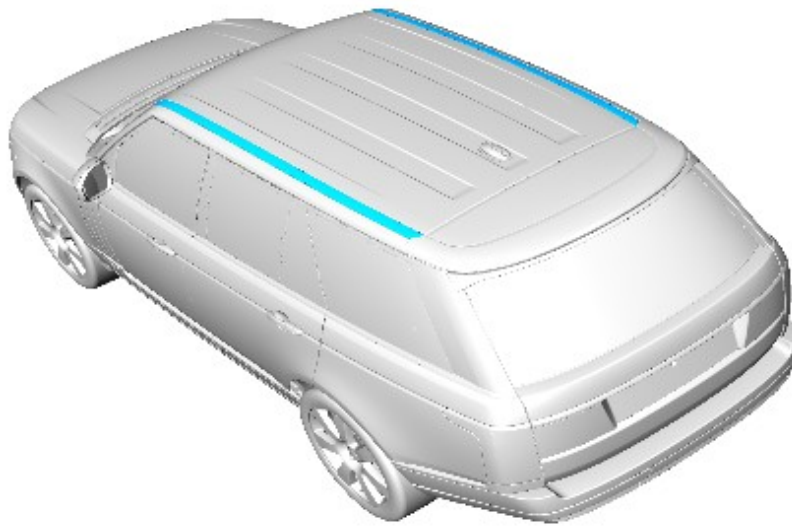

E183616

Location of components.

2.

**NOTE:**

If required, repeat this step on both sides of the vehicle.

Remove the roof molding (see TOPIx Workshop Manual section 501-08: Exterior Trim and Ornamentation - Roof Molding).

3.

**NOTES:**

- Use a suitable degreaser to clean any residue from the foam pads.
- Inspect the roof molding for damage.
- If required, repeat this step on both sides of the vehicle.

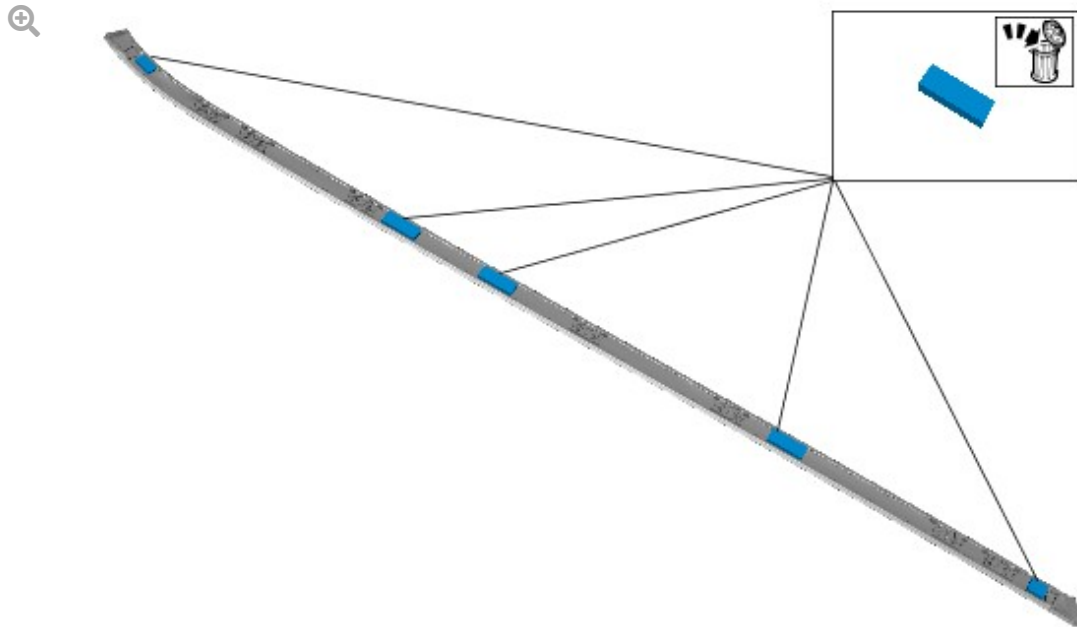

E183735

Remove and discard the foam pads.

---

4.

**NOTE:**

If required, repeat this step on both sides of the vehicle.

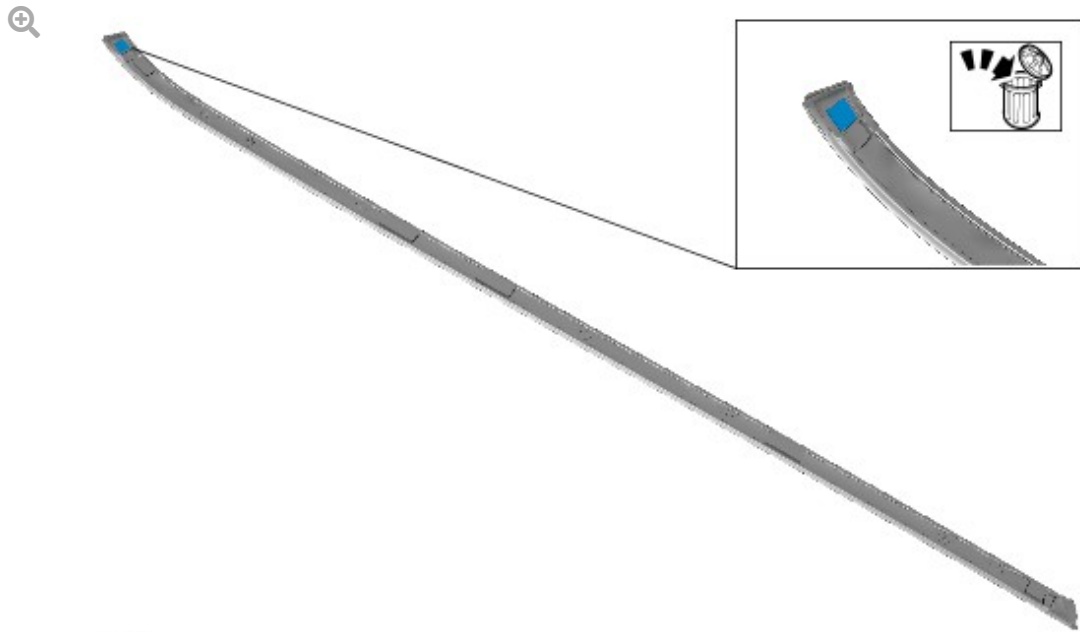

E183737

Remove the roof molding adhesive pad.

---

5.

**CAUTION:**

The roof molding clips are a one time installation only.

**NOTE:**

If required, repeat this step on both sides of the vehicle.

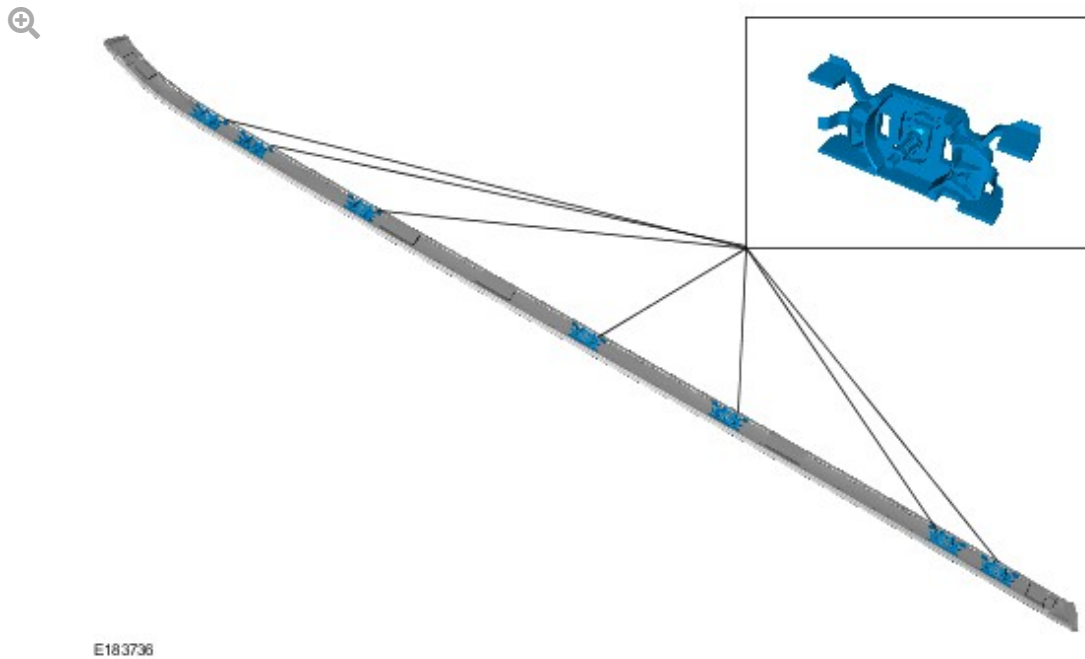

Remove the roof molding clips.

---

6.

**NOTES:**

- If required, repeat this step on both sides of the vehicle.
- Repeat this step on all roof molding clips.

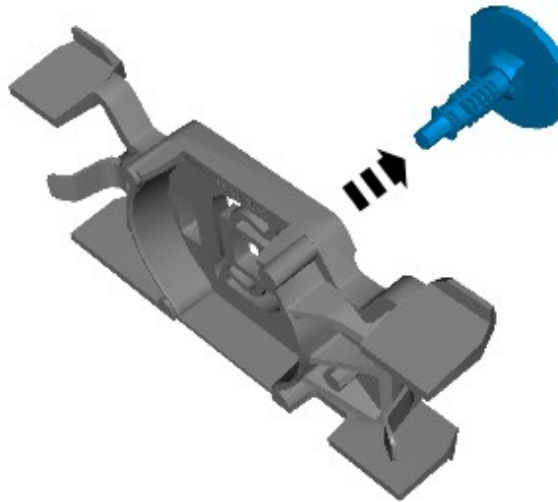

E183739

Remove and discard the original clips from the plastic retaining clips.

---



7.

**NOTES:**

- If required, repeat this step on both sides of the vehicle.
- Repeat this step on all roof molding clips.

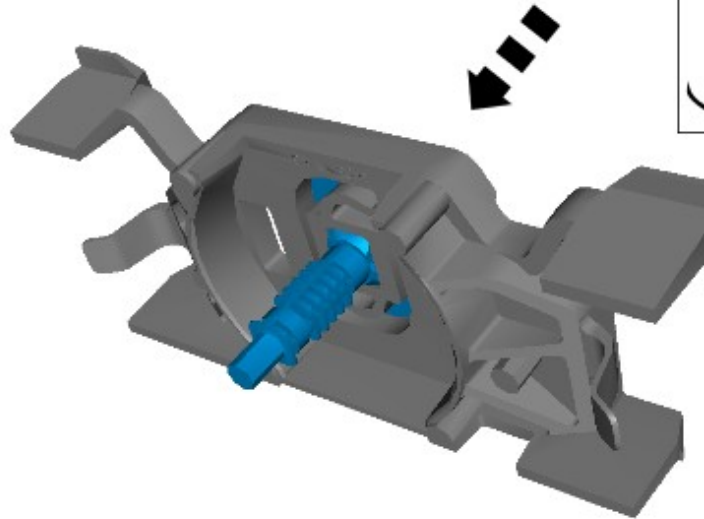

E183740

Install the new clips into the plastic retaining clips.

---

8.

**NOTE:**

If required, repeat this step on both sides of the vehicle.

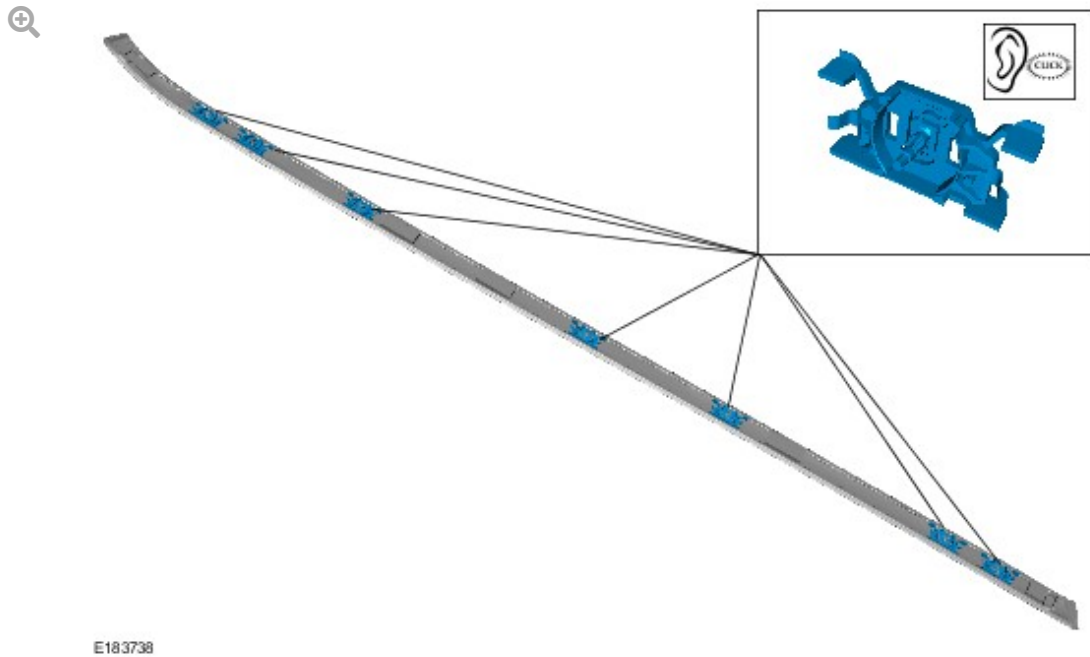

Install the roof molding clips into the roof molding.

---

9.

**NOTE:**

If required, repeat this step on both sides of the vehicle.

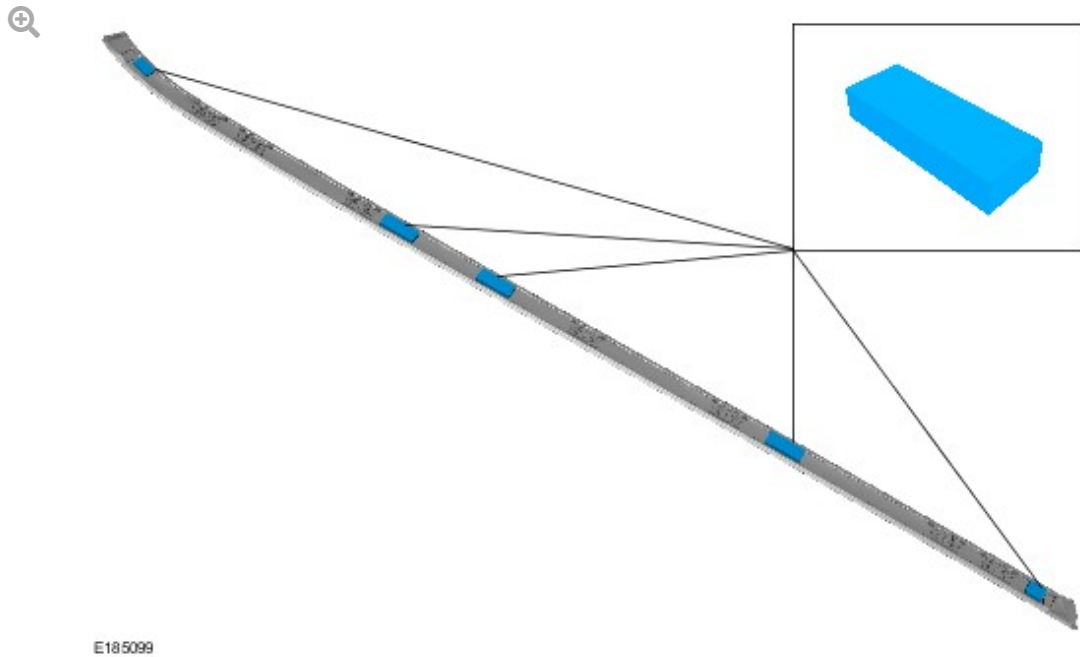

Install the new roof molding foam pads in the same location they were removed from.

---

10.

**NOTE:**

If required, repeat this step on both sides of the vehicle.

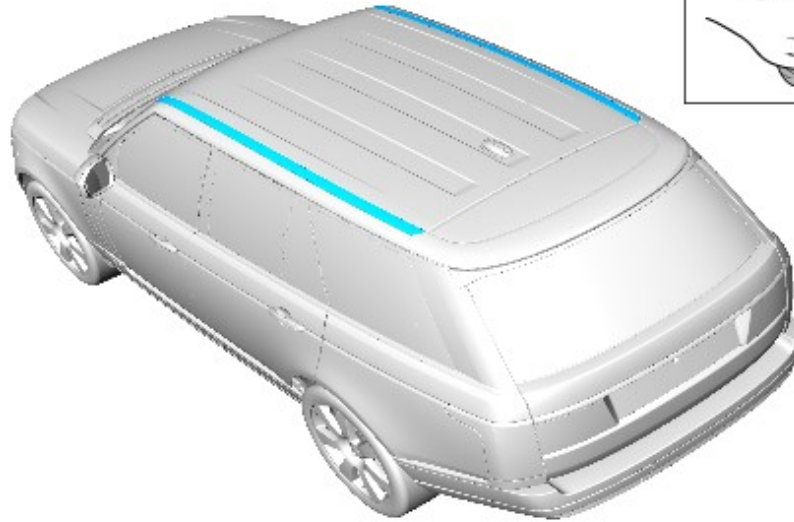

E183621

Clean the vehicle with a suitable cleaner in the area shown.

---

11.

**NOTE:**

Repeat this step on both sides of the vehicle.

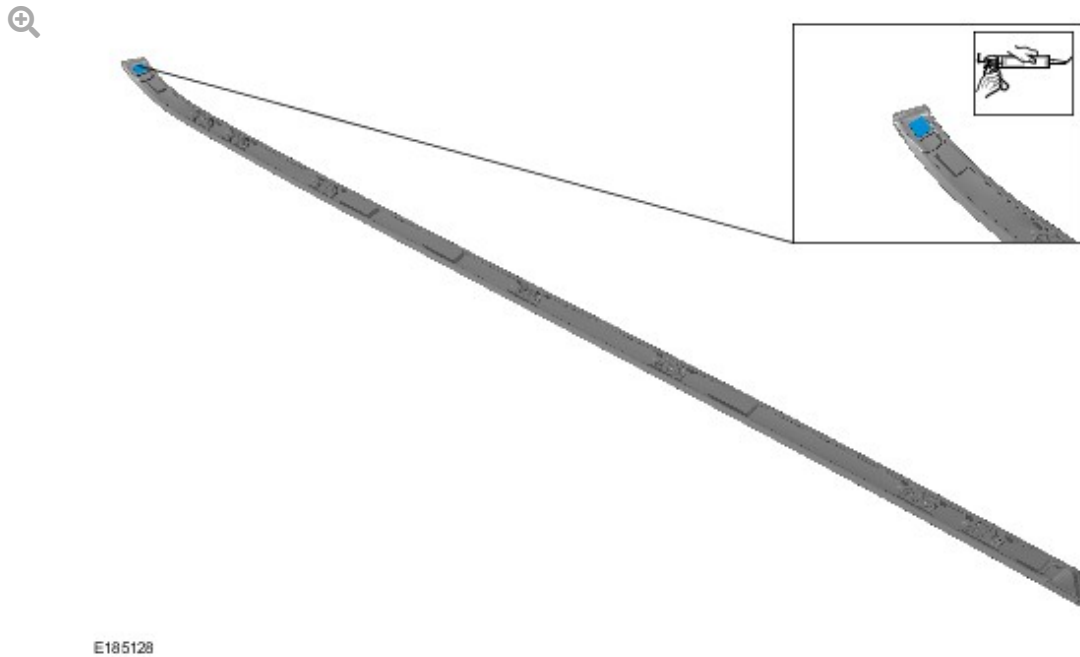

Apply the sealer in the area shown.

12.

**NOTE:**

If required, repeat this step on both sides of the vehicle.

Install the roof molding (see TOPIx Workshop Manual section 501-08: Exterior Trim and Ornamentation - Roof Molding).

13.

**NOTES:**

- If required, repeat this step on both sides of the vehicle.
- The roof molding must fit under the windshield aperture seal.
- Remove the securing tape and any residue from the tape with a suitable cleaner when the sealer has fully cured.

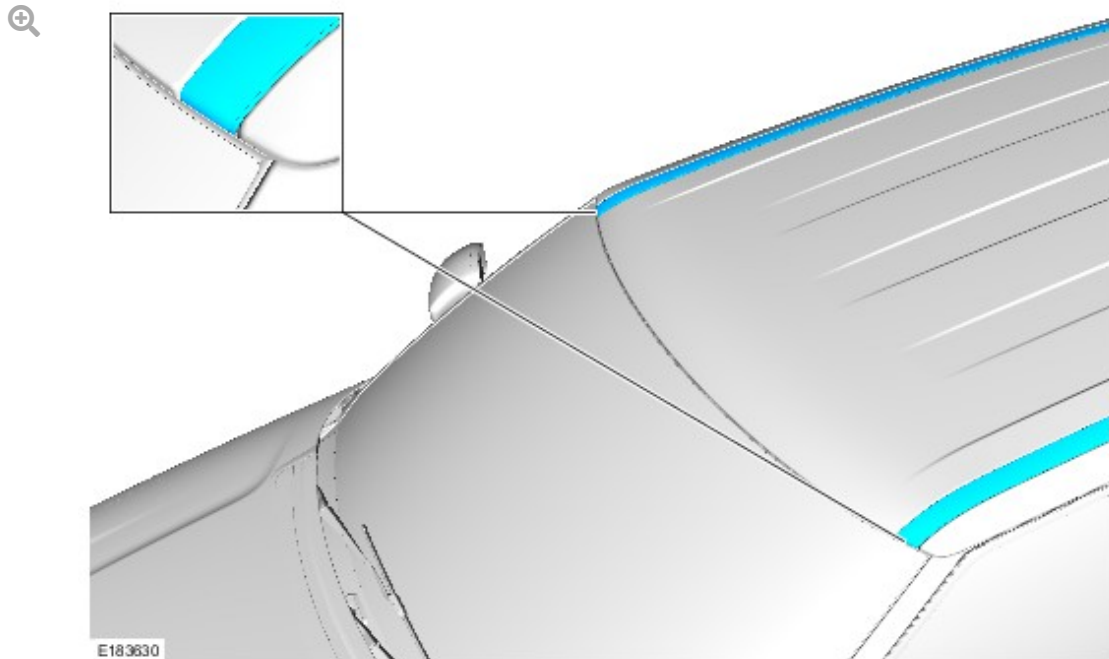

Make sure the roof molding is correctly installed.

- ▪ Use a suitable tape to hold down the roof molding in the area shown.