



<b>Subject:</b>  <b>CONNECTED VEHICLE SYMPTOM TROUBLESHOOTING</b>	<b>Service Alert No.:</b> SA-031/20
	<b>Last Issued:</b> 10/28/2020

## BULLETIN NOTES

This service alert supersedes the previously issued service alert listed below. The changes are noted in Red text.

Previous Service Alert	Date(s) Issued:
SA-031/20	06/16/20, 06/05/20, 06/01/20, 05/18/20, 04/14/2020, 04/02/20, 03/11/20 and 02/27/20

## APPLICABLE MODEL(S)/VINS

2019-2021 Mazda3  
 2020-2021 CX-30  
 2021 CX-5  
 2021 CX-9

## DESCRIPTION

**IMPORTANT NOTE:** Some 2020 Mazda3 vehicles may have incorrect infotainment software version 10042 installed. The incorrect software will cause MyMazda App Connected Vehicle enrollment errors. Go to [SSPC1](#).

Some customers may complain about any of the following:

- Infotainment Center Display does not provide the Authorization Code during the MyMazda App Connected Vehicle enrollment (and Software Update Error message on 2020 Mazda3 only).
- Remote function(s) inoperative.
  - Engine Start / Stop
  - Door Lock / Unlock
  - Lights ON / OFF

**CONSUMER NOTICE:** The information and instructions in this bulletin are intended for use by skilled technicians. Mazda technicians utilize the proper tools/equipment and take training to correctly and safely maintain Mazda vehicles. These instructions should not be performed by "do-it-yourselfers." Customers should not assume this bulletin applies to their vehicle or that their vehicle will develop the described concern. To determine if the information applies, customers should contact their nearest authorized Mazda dealership. Mazda North American Operations reserves the right to alter the specifications and contents of this bulletin without obligation or advance notice. All rights reserved. No part of this bulletin may be reproduced in any form or by any means, electronic or mechanical---including photocopying and recording and the use of any kind of information storage and retrieval system ---without permission in writing.



Confirm the customer's phone and vehicle have good to strong reception during the concern as shown in the table below.

- If the reception is weak, move the vehicle to a location where the reception is good to strong as shown in the table, then try to get the Authorization Code and/or operate the remote functions before proceeding to the Repair Procedure if there is still an issue.
- If the reception is good to strong, proceed to the Repair Procedure.

**CONSUMER NOTICE:** The information and instructions in this bulletin are intended for use by skilled technicians. Mazda technicians utilize the proper tools/equipment and take training to correctly and safely maintain Mazda vehicles. These instructions should not be performed by "do-it-yourselfers." Customers should not assume this bulletin applies to their vehicle or that their vehicle will develop the described concern. To determine if the information applies, customers should contact their nearest authorized Mazda dealership. Mazda North American Operations reserves the right to alter the specifications and contents of this bulletin without obligation or advance notice. All rights reserved. No part of this bulletin may be reproduced in any form or by any means, electronic or mechanical---including photocopying and recording and the use of any kind of information storage and retrieval system ---without permission in writing.



Indication	Explanation
	Radio waves are not being received. Move to a location with good reception.
	Weak reception.
	Good Reception
	Strong reception.
	Currently conducting an operation check of the communication unit. If this condition continues, consult an Authorized Mazda Dealer.
	<ol style="list-style-type: none"> <li>1. The Telematics Communication Unit (TCU) is unsubscribed</li> <li>2. Connected Service contract has ended</li> <li>3. TCU has not been initialized, go to <a href="#">SA-010/20</a></li> </ol>

**Remote Engine Start Will Not Function under the following conditions**

Item	Condition
1	Vehicle battery voltage low
2	AT shift position except "P"
3	Vehicle speed above 3 mi/h (5 km/h)
4	Brake pedal switch malfunction
5	Engine already started by remote engine start function
6	A registered key is detected in the vehicle
7	Brake pedal switch detects brake application
8	Low fuel warning message

**CONSUMER NOTICE:** The information and instructions in this bulletin are intended for use by skilled technicians. Mazda technicians utilize the proper tools/equipment and take training to correctly and safely maintain Mazda vehicles. These instructions should not be performed by "do-it-yourselfers." Customers should not assume this bulletin applies to their vehicle or that their vehicle will develop the described concern. To determine if the information applies, customers should contact their nearest authorized Mazda dealership. Mazda North American Operations reserves the right to alter the specifications and contents of this bulletin without obligation or advance notice. All rights reserved. No part of this bulletin may be reproduced in any form or by any means, electronic or mechanical---including photocopying and recording and the use of any kind of information storage and retrieval system ---without permission in writing.

9	Engine starts, then turns OFF due to abnormal high engine rpm detected. (Engine rotation over 3000 rpm continued for more than 0.2[s])
10	No engine rpm detected after sending engine start request. (Engine rotation 0 rpm continued for more than 0.2[s])
11	When the CAN data signal for engine shut off is present (e.g.: door ajar signal)
12	After 10 second maximum cranking time
13	Burglar alarm status is "Alarm" and "Alarm stand by" (CAUTION - DO NOT enable, see Theft-Deterrent System section in <a href="#">SA-013/20</a> )
14	Room fuse blown/missing
15	Connected Vehicle Maintenance Mode enabled (Restricted Transmitting Mode in MDARS)
16	Vehicle is parked (stored) for approximately 1 week or longer or in deep sleep mode. Drive the vehicle for a few miles to recover.
17	DTC Stored
18	Aftermarket Remote Engine Start accessory installed.
19	Mazda Remote Engine Start (BCKA-V7-620) accessory installed (No MyMazda app remote engine start function).
20	First remote control attempt fails, second attempt works fine. Go to TSB <a href="#">16-002/20</a> .

### Remote Engine Start Function Will turn engine OFF under the following conditions

Item	Condition
1	Vehicle door(s) opened
2	Vehicle trunk opened
3	Vehicle hood opened
4	Ignition switch push button "ON" detected
5	Remote engine STOP request
6	Brake pedal switch detects brake application
7	DTC Stored
8	After 15 minute run time limitation

## REPAIR PROCEDURE

**CONSUMER NOTICE:** The information and instructions in this bulletin are intended for use by skilled technicians. Mazda technicians utilize the proper tools/equipment and take training to correctly and safely maintain Mazda vehicles. These instructions should not be performed by "do-it-yourselfers." Customers should not assume this bulletin applies to their vehicle or that their vehicle will develop the described concern. To determine if the information applies, customers should contact their nearest authorized Mazda dealership. Mazda North American Operations reserves the right to alter the specifications and contents of this bulletin without obligation or advance notice. All rights reserved. No part of this bulletin may be reproduced in any form or by any means, electronic or mechanical---including photocopying and recording and the use of any kind of information storage and retrieval system ---without permission in writing.

**NOTE:** Vehicles stored for long periods may lose GPS clock synchronization. If the vehicle is stored for a long period, test drive the vehicle to give the GPS clock time to synchronize before enrolling or testing connected vehicle functions.

1. Verify customer concern.

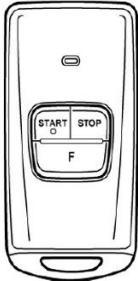
Customer Complaint	Action
<ol style="list-style-type: none"> <li>1. Vehicle Center Display does not provide the Authorization Code during the MyMazda App Connected Vehicle enrollment.</li> <li>2. Remote function(s) inoperative.                             <ol style="list-style-type: none"> <li>1. Engine Start / Stop</li> <li>2. Door Lock / Unlock</li> <li>3. Lights ON / OFF</li> </ol> </li> </ol>	<p>Go to Step 2.</p>
<ol style="list-style-type: none"> <li>1. 2020 Mazda3 only - Infotainment center display does not provide Authorization Code during the MyMazda App Connected Vehicle enrollment and infotainment Software Update Error message.</li> </ol> 	<p>Go to <a href="#">SSPC1</a>.</p>
<p>First remote control attempt fails, second attempt works fine.</p> <ol style="list-style-type: none"> <li>1. Engine Start / Stop</li> <li>2. Door Lock / Unlock</li> <li>3. Lights ON / OFF</li> </ol>	<p>Go to TSB <a href="#">16-002/20</a>.</p>
<ol style="list-style-type: none"> <li>1. Remote Engine Start inoperative due to:                             <ol style="list-style-type: none"> <li>1. Aftermarket Remote Engine Start accessory installed.</li> <li>2. Mazda Remote Engine Start (BCKA-V7-620) accessory installed.</li> </ol> </li> </ol> 	<ol style="list-style-type: none"> <li>1. Remove the aftermarket accessory.</li> <li>2. The customer can use either the Mazda Remote Engine Start accessory or the MyMazda app function. Cannot use both.</li> </ol>

**CONSUMER NOTICE:** The information and instructions in this bulletin are intended for use by skilled technicians. Mazda technicians utilize the proper tools/equipment and take training to correctly and safely maintain Mazda vehicles. These instructions should not be performed by "do-it-yourselfers." Customers should not assume this bulletin applies to their vehicle or that their vehicle will develop the described concern. To determine if the information applies, customers should contact their nearest authorized Mazda dealership. Mazda North American Operations reserves the right to alter the specifications and contents of this bulletin without obligation or advance notice. All rights reserved. No part of this bulletin may be reproduced in any form or by any means, electronic or mechanical---including photocopying and recording and the use of any kind of information storage and retrieval system ---without permission in writing.

2. Use MDARS to ID the vehicle and check for DTC's stored.

**Are DTC(s) stored?**

- Yes - Go to step 3.
- No - Perform [ODR Data Collection Procedure](#), then go to step 3.

3. Retrieve MAZDA CONNECT CMU log data. Go to [MGSSMAZDA CONNECT CMU Data Retrieval](#)

4. Perform "[Registration work of RES smartphone type](#)".

5. Clear DTC(s). **NOTE:** If DTC 2050:55 is stored, go to [SA-003/20](#) to clear DTC. 6. Perform KAM reset.

**NOTE:** Test drive vehicle after a KAM reset to allow the GPS clock to synchronize before retrying connected vehicle functions. 7. Contact Hotline for the latest repair information.

**ODR Data Collection Procedure**

<p>1. ID the vehicle using MDARS</p>	<p>---</p>
<p>2. Select "Toolbox"</p>	

**CONSUMER NOTICE:** The information and instructions in this bulletin are intended for use by skilled technicians. Mazda technicians utilize the proper tools/equipment and take training to correctly and safely maintain Mazda vehicles. These instructions should not be performed by "do-it-yourselfers." Customers should not assume this bulletin applies to their vehicle or that their vehicle will develop the described concern. To determine if the information applies, customers should contact their nearest authorized Mazda dealership. Mazda North American Operations reserves the right to alter the specifications and contents of this bulletin without obligation or advance notice. All rights reserved. No part of this bulletin may be reproduced in any form or by any means, electronic or mechanical---including photocopying and recording and the use of any kind of information storage and retrieval system ---without permission in writing.

3. Select Vehicle Icon

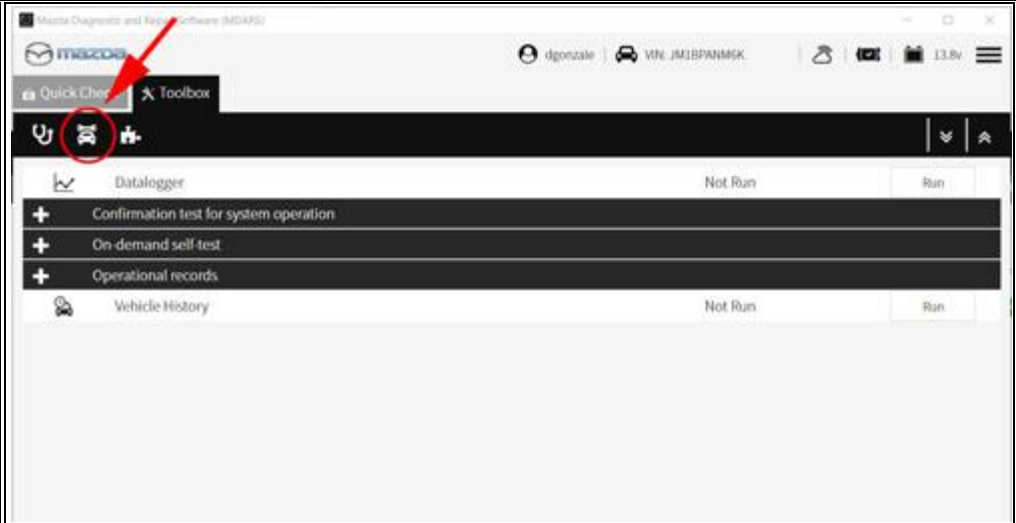

4. Select "Collect Diagnostic Information"

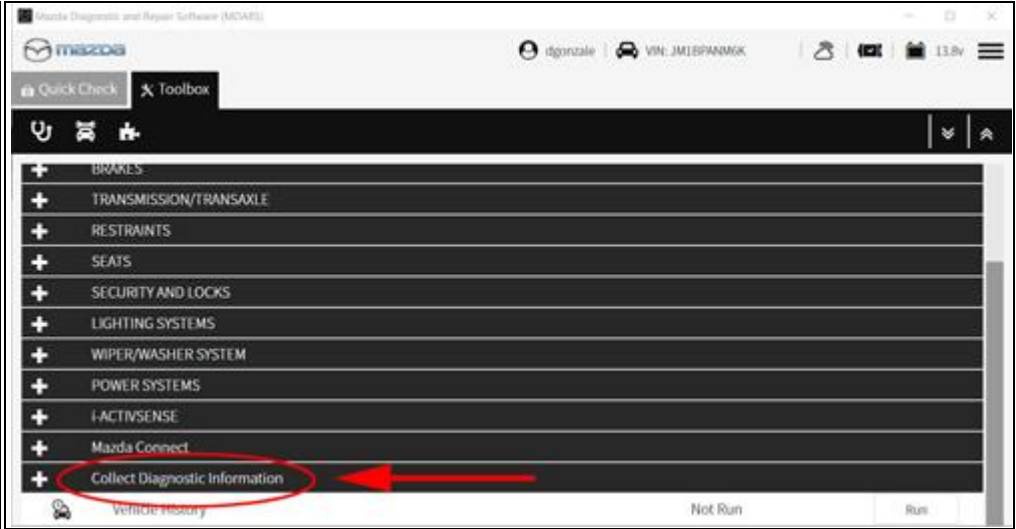

**CONSUMER NOTICE:** The information and instructions in this bulletin are intended for use by skilled technicians. Mazda technicians utilize the proper tools/equipment and take training to correctly and safely maintain Mazda vehicles. These instructions should not be performed by "do-it-yourselfers." Customers should not assume this bulletin applies to their vehicle or that their vehicle will develop the described concern. To determine if the information applies, customers should contact their nearest authorized Mazda dealership. Mazda North American Operations reserves the right to alter the specifications and contents of this bulletin without obligation or advance notice. All rights reserved. No part of this bulletin may be reproduced in any form or by any means, electronic or mechanical---including photocopying and recording and the use of any kind of information storage and retrieval system ---without permission in writing.

5. Select Collect Diagnostic Information "Run"

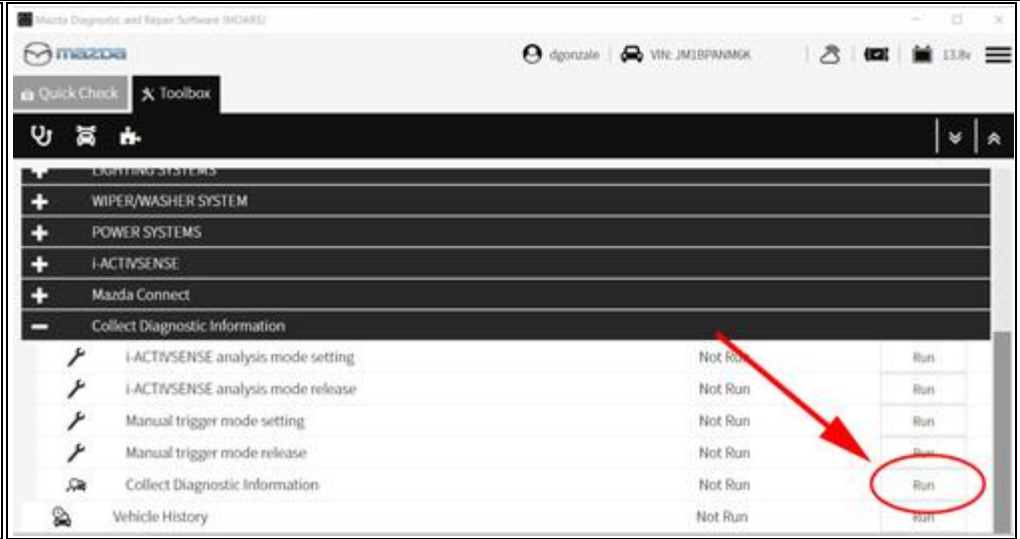

**CONSUMER NOTICE:** The information and instructions in this bulletin are intended for use by skilled technicians. Mazda technicians utilize the proper tools/equipment and take training to correctly and safely maintain Mazda vehicles. These instructions should not be performed by "do-it-yourselfers." Customers should not assume this bulletin applies to their vehicle or that their vehicle will develop the described concern. To determine if the information applies, customers should contact their nearest authorized Mazda dealership. Mazda North American Operations reserves the right to alter the specifications and contents of this bulletin without obligation or advance notice. All rights reserved. No part of this bulletin may be reproduced in any form or by any means, electronic or mechanical---including photocopying and recording and the use of any kind of information storage and retrieval system ---without permission in writing.



6. Turn Ignition ON, then select "Next"

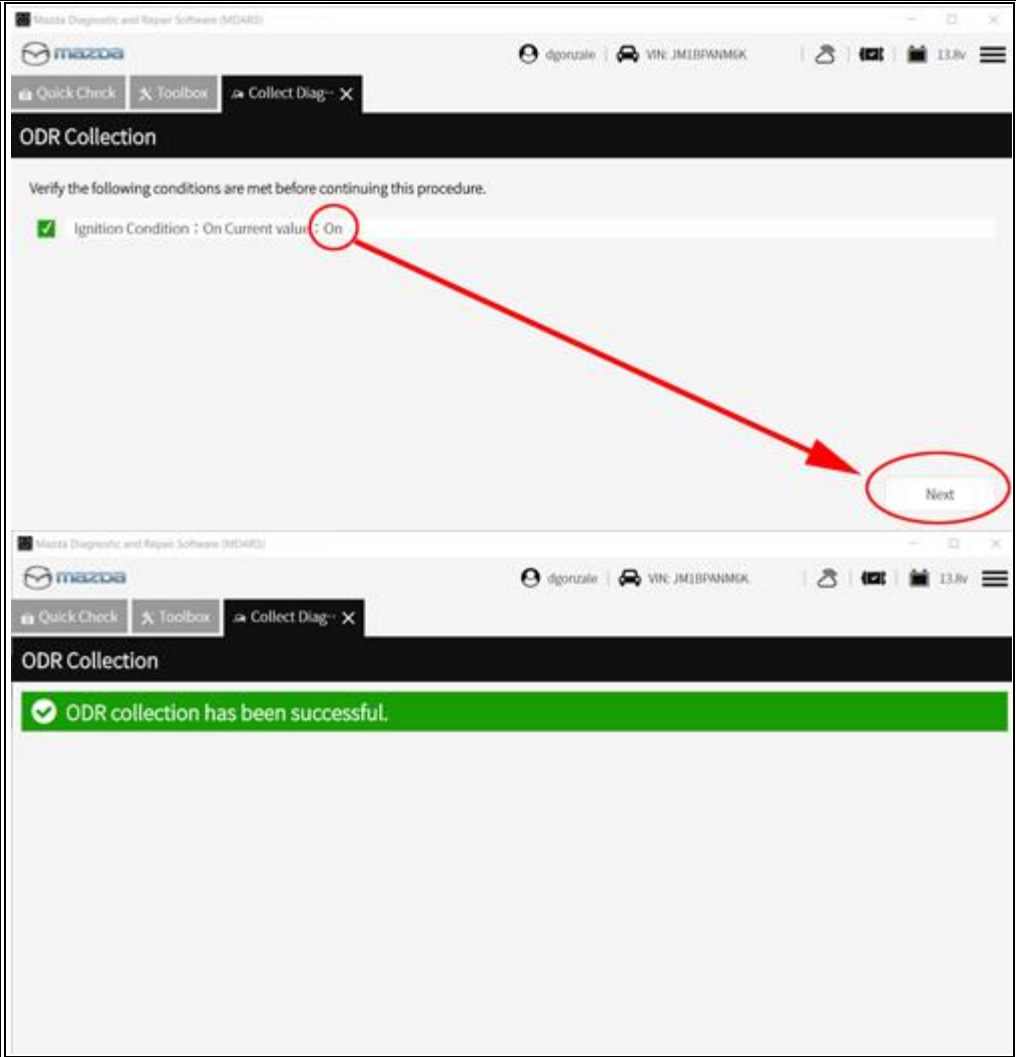

**CONSUMER NOTICE:** The information and instructions in this bulletin are intended for use by skilled technicians. Mazda technicians utilize the proper tools/equipment and take training to correctly and safely maintain Mazda vehicles. These instructions should not be performed by "do-it-yourselfers." Customers should not assume this bulletin applies to their vehicle or that their vehicle will develop the described concern. To determine if the information applies, customers should contact their nearest authorized Mazda dealership. Mazda North American Operations reserves the right to alter the specifications and contents of this bulletin without obligation or advance notice. All rights reserved. No part of this bulletin may be reproduced in any form or by any means, electronic or mechanical---including photocopying and recording and the use of any kind of information storage and retrieval system ---without permission in writing.



4. Follow the on-screen instructions and wait for process to complete.

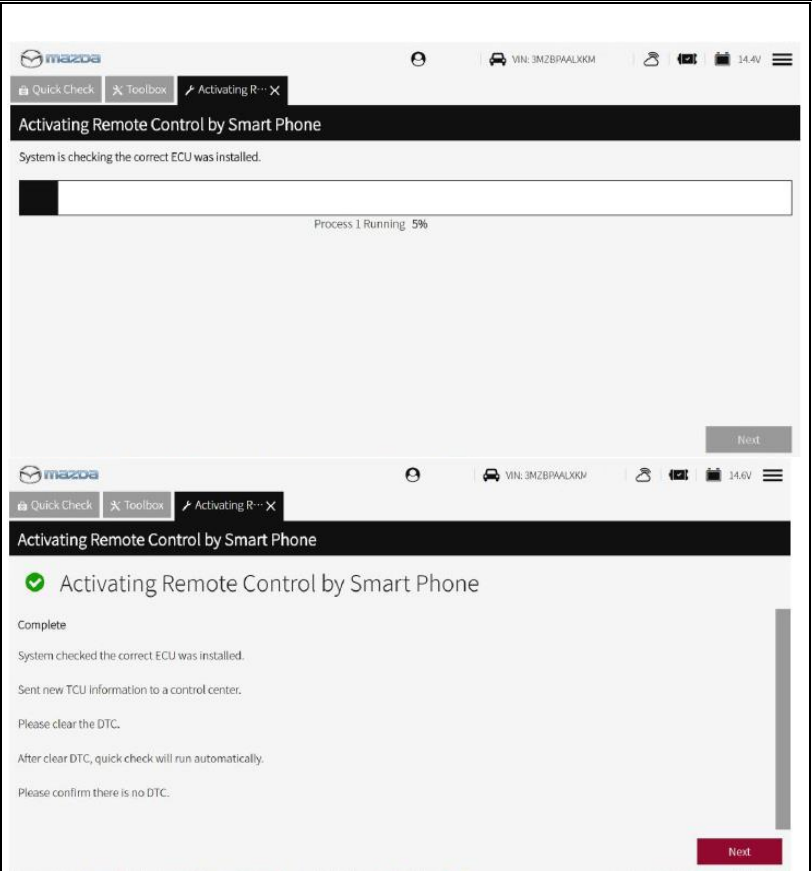

5. Select Quick Check (A), then start the engine and select the DTC Clear icon (B).

**CAUTION:** If the engine is not started, DTC P2610 is stored and cannot be erased.



**CONSUMER NOTICE:** The information and instructions in this bulletin are intended for use by skilled technicians. Mazda technicians utilize the proper tools/equipment and take training to correctly and safely maintain Mazda vehicles. These instructions should not be performed by "do-it-yourselfers." Customers should not assume this bulletin applies to their vehicle or that their vehicle will develop the described concern. To determine if the information applies, customers should contact their nearest authorized Mazda dealership. Mazda North American Operations reserves the right to alter the specifications and contents of this bulletin without obligation or advance notice. All rights reserved. No part of this bulletin may be reproduced in any form or by any means, electronic or mechanical---including photocopying and recording and the use of any kind of information storage and retrieval system ---without permission in writing.