



GROUP

Body

MODEL

Multiple Listed Models

NUMBER

PS299 (Rev 4, 10/06/2020)

DATE

March 2014



TECHNICAL OPERATIONS

SUBJECT:

## CORRECT PROCEDURE FOR RAISING WINDSHIELD WIPERS

### \* NOTICE

This bulletin has been revised to include additional information. New/revised sections of this bulletin are indicated by a black bar in the margin area.

When servicing windshield wipers on the below listed vehicles, including during PDI, ensure to raise the wiper arms to a vertical position to **avoid damaging the paint on the rear edge of the hood**. The wipers are recessed below the hood to provide an enhanced appearance and reduced wind noise characteristics. This procedure applies to both key start and SMK type ignition systems.

MY	Model	MY	Model
2015~	K900	2019~	Forte
2016~	Optima	2020~	Telluride
2017~	Cadenza	2021~	K5
2018~	Stinger	2021~	Sorento

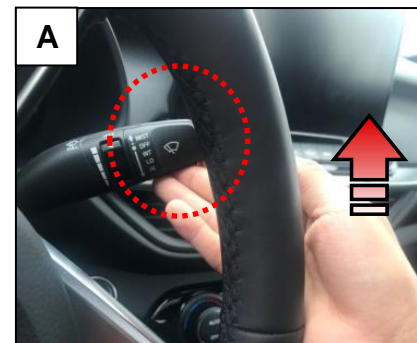

#### Raising the windshield wiper arms:

1. Turn the vehicle Ignition ON with the engine OFF and then turn the ignition OFF.
2. Within Three (3) seconds after turning the vehicle ignition OFF; raise the Wiper Blade Control Stalk, and hold it for more than Two (2) seconds (A).
3. The Wiper Arms will move upward, and stop in the vertical position (B). The Wiper Arms may now be moved away from the Windshield for servicing (also during PDI).
4. Once finished servicing the Wipers, turn the vehicle ignition ON with the engine OFF. Then, move the Wiper Blade Control Stalk up to return the Wipers to the "park" position.
5. Finally, turn the vehicle ignition to the OFF position.

**NOTE: All dealer personnel should become familiar with this procedure to prevent paint damage when using a raised wiper arm as a sign for vehicle readiness status, or for locating the vehicle in a storage yard. Vehicle damage resulting from failure to follow these instructions is NOT COVERED by Warranty. Such claims are subject to denial or chargeback by KMA.**