



## INVERTER SETTINGS MY21

<b>Bulletin Type:</b>	INC	<b>Publication Date:</b>	October 2020
<b>Bulletin #(s):</b>	20-032	<b>Make(s):</b>	JAYCO, ENTEGRA COACH
		<b>Model(s):</b>	EMBARK, REATTA, REATTA XL, ASPIRE, ANTHEM, CORNERSTONE
		<b>Model Year(s):</b>	MY2021

<b>Incident:</b>	Inverter charging settings on Vegatouch for models listed above
<b>Affected Units:</b>	All Embark, Reatta, Reatta XL, Aspire, Anthem, and Cornerstone units.

## INSTRUCTIONS

### **INVERTER SETTINGS MY2021**

**Aspire, two and optional four battery settings:**

**NOTE:** The number of batteries selected in the Vegatouch settings page must be the same as the number of house batteries installed in the unit (does not include chassis batteries).

The system charge rate percentage is set automatically when indicating number of batteries is selected in the additional options page.

**Embark, Reatta, Reatta XL:**

Battery Brand = **Relion**.

Inverter settings:

Battery Type = Custom

LBCO 10.7

ABSORB HOURS 1.5

Charge Rate 80% WITH 2 EA L16 BATTERIES

VAC DROPOUT 80

ABSORB: 14.5

FLOAT: 13.7

EQUALIZE 14.6

SRCH WATTS 0

## **Aspire:**

Battery Brand: **Relion.**

Inverter settings:

BATTERY TYPE = Custom

LBCO 10.7

ABSORB TIME: 1.5 HRS WITH 2 EA L16 BATTERIES  
2.5 HRS WITH 4 EA L16 BATTERIES

Charge Rate 80% WITH 2 EA L16 BATTERIES

Charge Rate 100% WITH 4 EA L16 BATTERIES

VAC DROPOUT80

ABSORB: 14.5

FLOAT: 13.7

EQUALIZE 14.6

SRCH WATTS 0

## **Anthem and Cornerstone:**

Battery Brand = **Relion.**

Inverter settings:

Battery Type = Custom

LBCO 10.7

ABSORB HOURS 2.5

VAC DROPOUT 80

ABSORB: 14.5

FLOAT: 13.7

EQUALIZE 14.6

SRCH WATTS 0

Push Gear icon, press and hold Inverter icon,

Using +/- change setting to Custom

## **Aspire, two and optional four battery settings:**

**NOTE:** The number of batteries selected in the Vegatouch settings page must be the same as the number of house batteries installed in the unit (does not include chassis batteries).

The system charge rate percentage is set automatically when indicating number of batteries is selected in the additional options page

At settings screen, press and hold "Floorplan" button for four seconds as shown below.

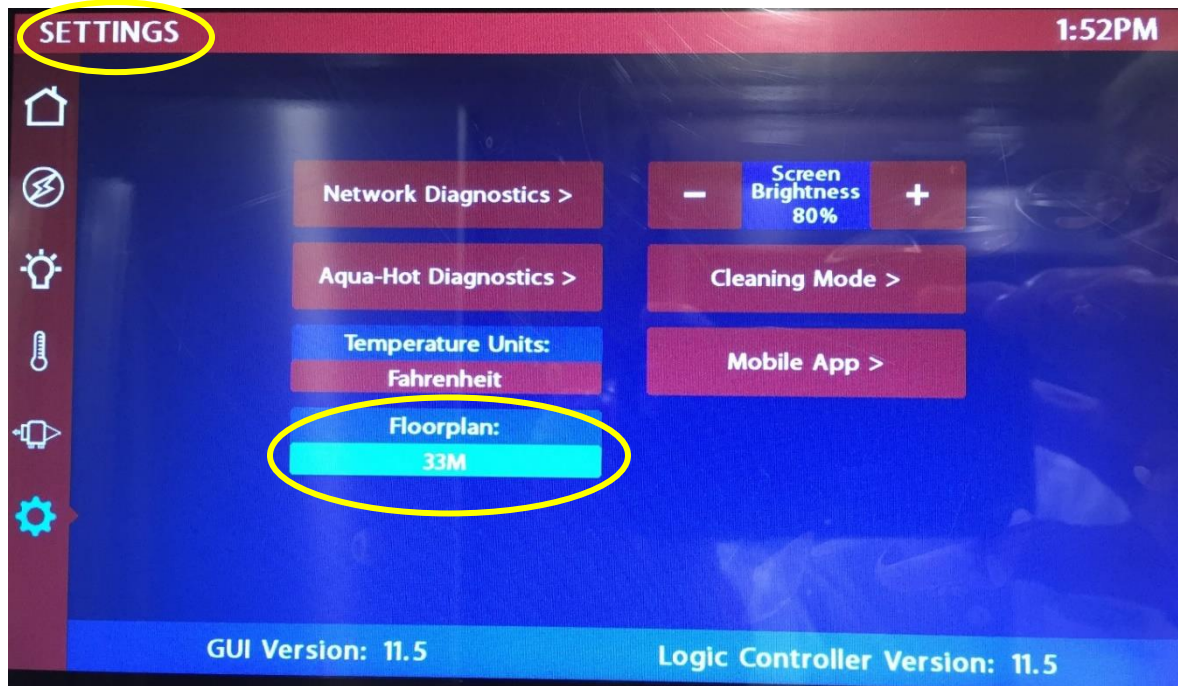

At next "ADDITIONAL OPTIONS" screen, press the "Proceed" button as shown below.

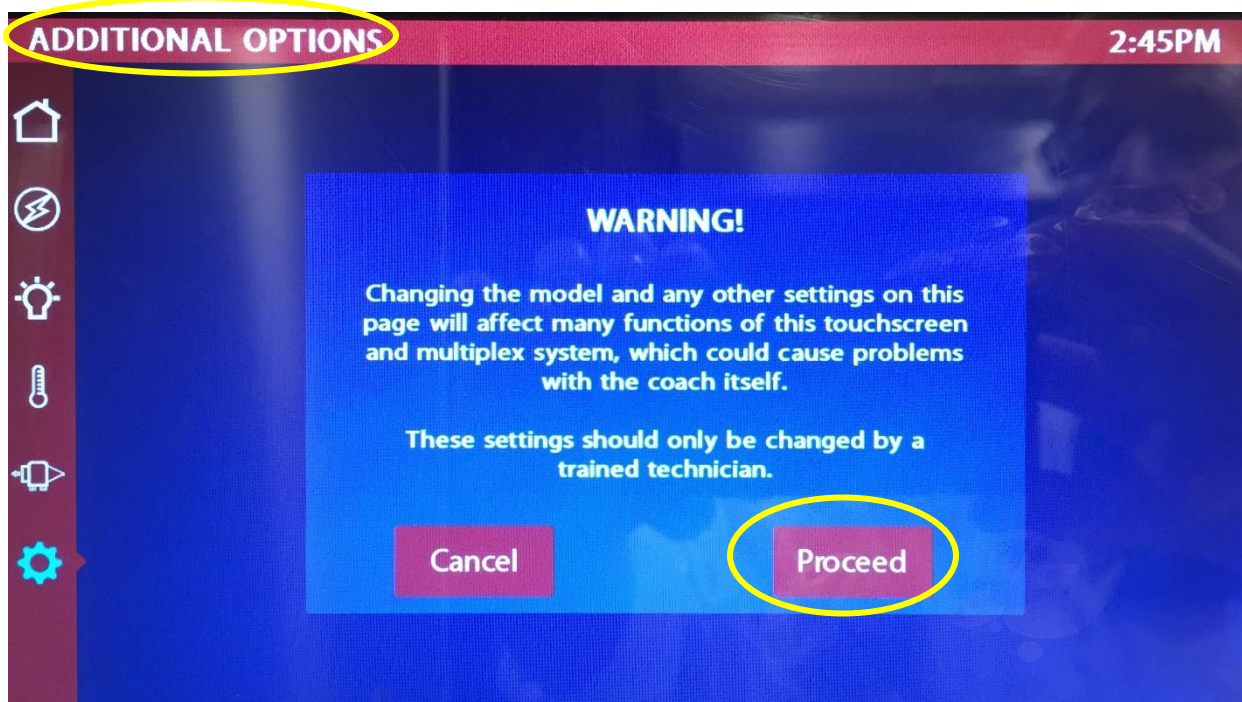

At next “ADDITIONAL OPTIONS” screen, select 2 or 4 Battery according to the number of house batteries (does not include chassis batteries) as shown below.

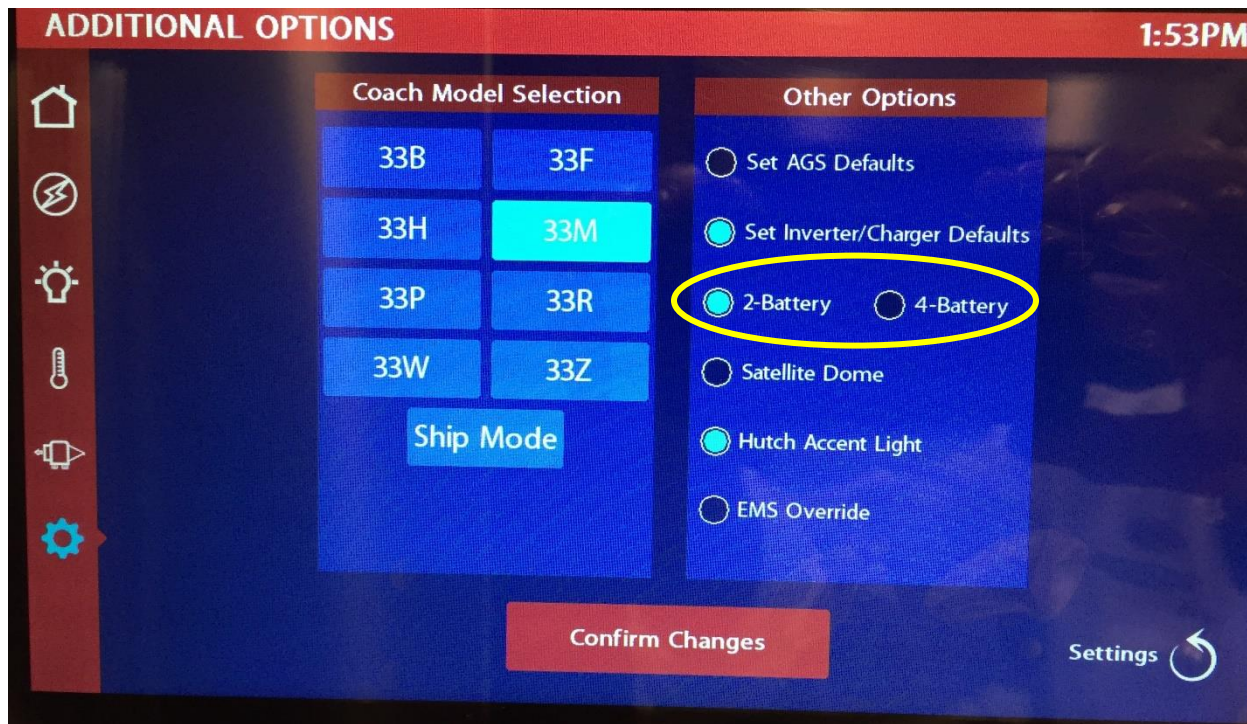

Jayco's sole obligation under our limited warranty is to repair or replace defective materials and/or workmanship deemed our responsibility as determined by Jayco in our sole discretion. Jayco reserves the right to use new and/or remanufactured parts or materials of similar quality to complete any work, and to make parts and/or design changes as appropriate without notice to anyone. Jayco designs and/or materials changes are done without obligation to incorporate such changes in previously manufactured product. Jayco makes every reasonable effort to ensure field remedies will not adversely affect performance and/or safety of the unit. This field remedy is not intended to extend to future performance of this RV, or any of its materials, components or parts beyond the standard warranty period. The RV owner's obligation to notify Jayco, or one of its independent, authorized dealers, of a claimed defect does not modify any obligation placed on the RV owner to contact Jayco directly when attempting to pursue remedies under state or federal law. Jan. 2019.

903 South Main Street • P.O. Box 460 • Middlebury, IN 46540