



# Service Bulletin

Bulletin No.: 17-NA-305

Date: September, 2020

## TECHNICAL

**Subject: Malfunction Indicator Lamp (MIL) Illuminated – DTCs P0615, P0617, P305C, P305D, P305E and/or P3054 Set**

Brand:	Model:	Model Year:		VIN:		Engine:	Transmission:
		from	to	from	to		
Chevrolet	Malibu (VIN Z)	2016	2016	—	—	—	—
	Malibu	2017	2018				

<b>Involved Region or Country</b>	North America, Israel
<b>Additional Options (RPOs)</b>	Wireless Charging (K4C), Stop/Start Engine System (KL9)
<b>Condition</b>	<p>Some customers may comment that the MIL is illuminated. The technician may find one or more of the following DTCs set:</p> <ul style="list-style-type: none"> <li>• P0615</li> <li>• P0617</li> <li>• P305C</li> <li>• P305D</li> <li>• P305E</li> <li>• P3054</li> </ul>
<b>Cause</b>	This condition may be caused by condensation on the cooling duct, used for the charging pad, dripping water on the DC/DC converter electrical connector.
<b>Correction</b>	If one or more of the above DTCs have been set, the wireless device charge port cooling duct must be inspected for condensation dripping onto the DC/DC converter. Refer to the Service Procedure section below.

## Service Procedure

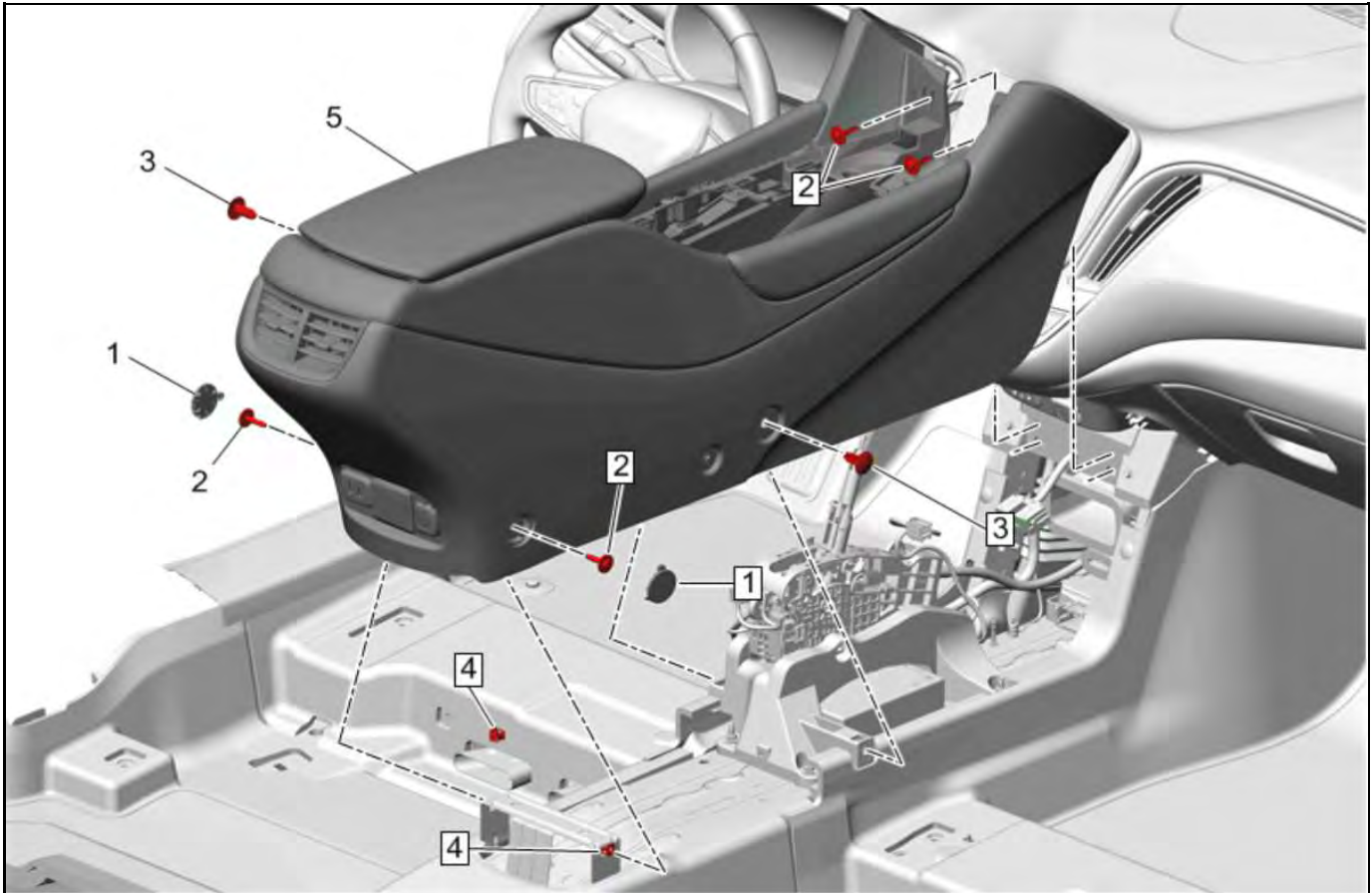

4225184

1. Remove the front floor console (5). Refer to *Front Floor Console Replacement* in SI.

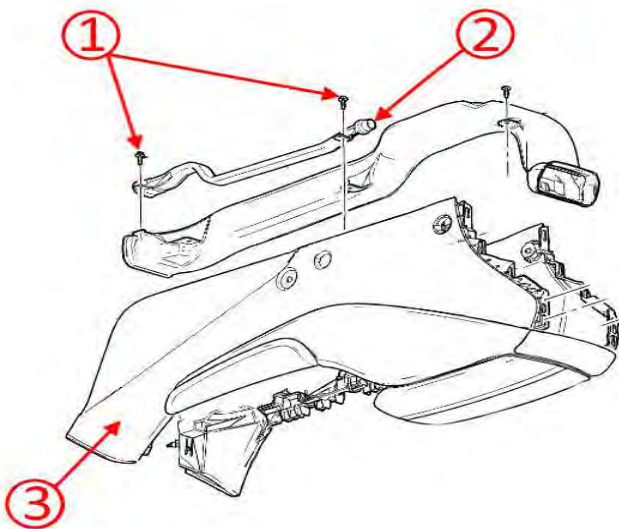

4866351

2. Remove the screws (1) that secure the wireless device charge port temperature control duct (2) to the underside of the floor console (3).



4866653

3. Wrap the duct (1) with a closed cell adhesive foam (2).

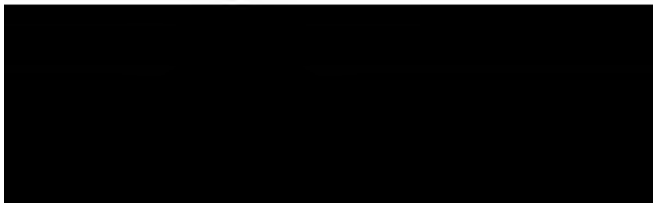

5646877

4. Inspect the DC/DC module electrical connector for signs of moisture.
  - If moisture is found in the connector, allow the connector to dry.
  - Utilizing ACDelco Dielectric Grease or equivalent, apply dielectric grease to the area.
5. Install the wireless device charge port temperature control duct.
6. Install the front floor console. Refer to *Front Floor Console Replacement* in SI.

### Parts Information

Causal Part	Description	Part Number	Qty
N/A	ACDelco Dielectric Lubricant*	12377900 (U.S.) 10953529 (Canada)	1
N/A	Foam	Local Source	As Required

\*There is enough material to do additional vehicles. Store the remaining material for future use.

### Warranty Information

For vehicles repaired under the Bumper-to-Bumper coverage (Canada Base Warranty coverage), use the following Labor Operation. Reference the Applicable Warranties section of Investigate Vehicle History (IVH) for coverage information.

Labor Operation	Description	Labor Time
4480668*	Wireless Device Charge Port Temperature Control Duct Wrap	1.4 hrs

\*This is a unique Labor Operation for bulletin use only.

<b>Version</b>	2
<b>Modified</b>	Released September 22, 2017 September 04, 2020 – Corrected RPO KC4 to K4C, added additional DTCs, added a graphic and lubricant information to step 4 and added a Parts Information table.

