

## STAR ONLINE PUBLICATION

---

**Case Number:** S2023000040

**Release Date:** 09/28/2020

**Symptom/Vehicle Issue:** Center Console Side Trim Poor Fit Or Warped Appearance

**Discussion:** Center console side panels may have an appearance of being warped due to not being fully snapped in place. Prior to replacing them remove and reinstall the panels to see if the fit improves. The panels have several metal retention clips that may not have been fully seated. Use a trim stick or carefully using a hand tool to release the clip(s). See images below. Note the clip locations on the part to aid in removal and reassembly.

This document does not authorize warranty repairs. This communication documents a record of past experiences. STAR Online does not provide any conclusions about what is wrong with the vehicle. Rather, it captures all previous cases known that appear to be similar or related to the vehicle symptom / condition. You are the expert, and you are responsible for deciding on the appropriate course of action.

**Contact STAR Center, or your Technical Assistance Center Via TechCONNECT or eCONTACT ticket if no solution is found**

## STAR ONLINE PUBLICATION

050 - Interior Trim 1605 - Floor Console, [CUF]

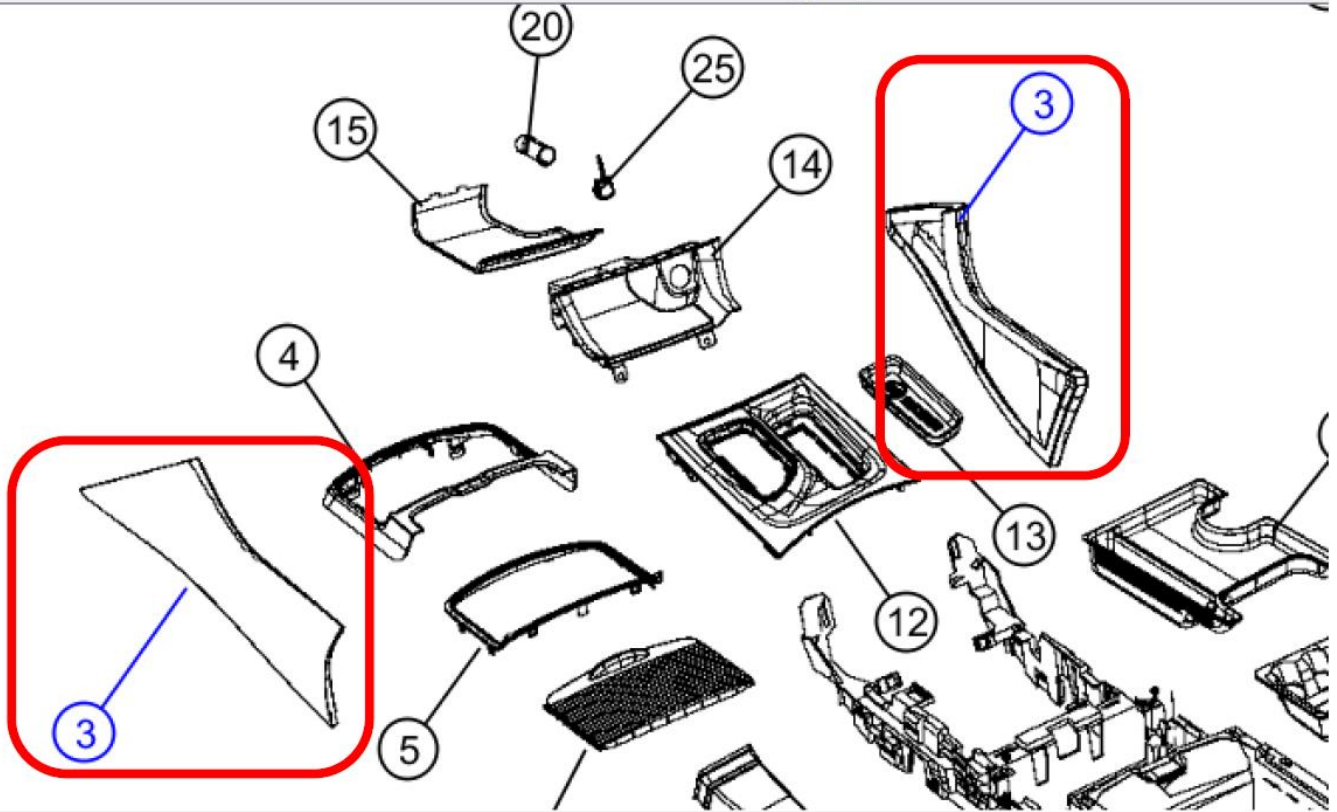

This document does not authorize warranty repairs. This communication documents a record of past experiences. STAR Online does not provide any conclusions about what is wrong with the vehicle. Rather, it captures all previous cases known that appear to be similar or related to the vehicle symptom / condition. You are the expert, and you are responsible for deciding on the appropriate course of action.

**Contact STAR Center, or your Technical Assistance Center Via TechCONNECT or eCONTACT ticket if no solution is found**

## STAR ONLINE PUBLICATION

---



This document does not authorize warranty repairs. This communication documents a record of past experiences. STAR Online does not provide any conclusions about what is wrong with the vehicle. Rather, it captures all previous cases known that appear to be similar or related to the vehicle symptom / condition. You are the expert, and you are responsible for deciding on the appropriate course of action.

**Contact STAR Center, or your Technical Assistance Center Via TechCONNECT or eCONTACT ticket if no solution is found**