

2021 Land Cruiser Pre-Delivery Service (PDS)

Service Category General

Section Pre-Delivery Service

Market USA

Toyota Supports
 ASE Certification 

Applicability

YEAR(S)	MODEL(S)	ADDITIONAL INFORMATION
2021	Land Cruiser	

Introduction

Pre-Delivery Service (PDS) is a critical step in satisfying our new car customers. Customer feedback indicates the following areas deserve special attention when performing PDS:

- Careful inspection for paint chips/scratches and body dents/dings.
- Proper operation of electrical accessories.
- Interior cleanliness.
- Proper function of mechanical systems.

Customer retention and proper maintenance of vehicles are and have always been a major focus for Toyota. To help remind customers that regular service is essential to the proper maintenance of the vehicle, dealers are required to install a service reminder sticker prior to delivery. By doing this, customers will be reminded to return to your dealership for service. Your current service reminder sticker may be used. (See PDS Check Sheet item 9 of “Final Inspection and Cleaning.”)

This bulletin contains the PDS procedures that apply specifically to 2021 model year Land Cruiser vehicles. A universal PDS [Check Sheet](#) that contains PDS steps that apply to all 2021 model year Toyota vehicles has been developed. To properly perform a complete PDS, you must complete all procedures contained in this TSB as well as the universal PDS [Check Sheet](#).

In addition, if the vehicle is stored for over 30 days, be sure to follow [Long-Term Vehicle Storage Guidelines](#).

2021 Land Cruiser Pre-Delivery Service (PDS)

Warranty Policy

If the need for additional repairs or adjustment is noted during the PDS, the required service should be performed under warranty. Reimbursement will be managed under the warranty policy.

The Warranty Policy and Procedures Manual requires that you maintain the completed PDS Check Sheet in the customer's file. If you cannot produce a completed form for each retailed vehicle upon TMS and/or Region/Distributor audit, the PDS payment amount will be subject to debit.

An additional Repair Order completed in conjunction with normal PDS MUST have time punch/flags for service. If multiple repairs are performed, separate time flags MUST be punched for each repair.

Warranty Information

OP CODE	DESCRIPTION	TIME	OFF	T1	T2
001013	Pre-Delivery Service (PDS)	1.2	-	-	-

Required Tools & Equipment

REQUIRED EQUIPMENT	SUPPLIER	PART NUMBER	QTY
Techstream ADVi*	ADE	TSADVUNIT	1
Techstream 2.0		TS2UNIT	
Techstream Lite		TSLITEPDLR01	
Techstream Lite (Green Cable)		TSLP2DLR01	

*Essential SST.

NOTE

- Only ONE of the Techstream units listed above is required.
- Software version 15.00.028 or later is required.
- Additional Techstream units may be ordered by calling Approved Dealer Equipment (ADE) at 1-800-368-6787.

2021 Land Cruiser Pre-Delivery Service (PDS)

Procedures

- [D/C Cut Fuse \(30A\) Installation*](#) 3
- [Tire Pressure Warning System \(TPWS\) Initialization](#) 4
- [Installation of Towing Wire Harness Connector](#) 4
- [Installation of Roof Rack Crossbars](#) 5
- [Front License Plate Installation*](#) 8

*If applicable.

D/C Cut Fuse (30A) Installation

To minimize battery discharge during transportation and storage, the D/C cut fuse (30A) has been removed at the assembly plant and temporarily stored in the blank space of the relay block in the engine compartment. During PDS, reinstall the D/C cut fuse (30A) into its original location and confirm ALL related Diagnostic Trouble Codes (DTCs) are cleared.

Remove the D/C cut fuse (30A) from the blank space of the relay block in the engine compartment and install the D/C cut fuse (30A) in the relay block as shown.

Figure 1.

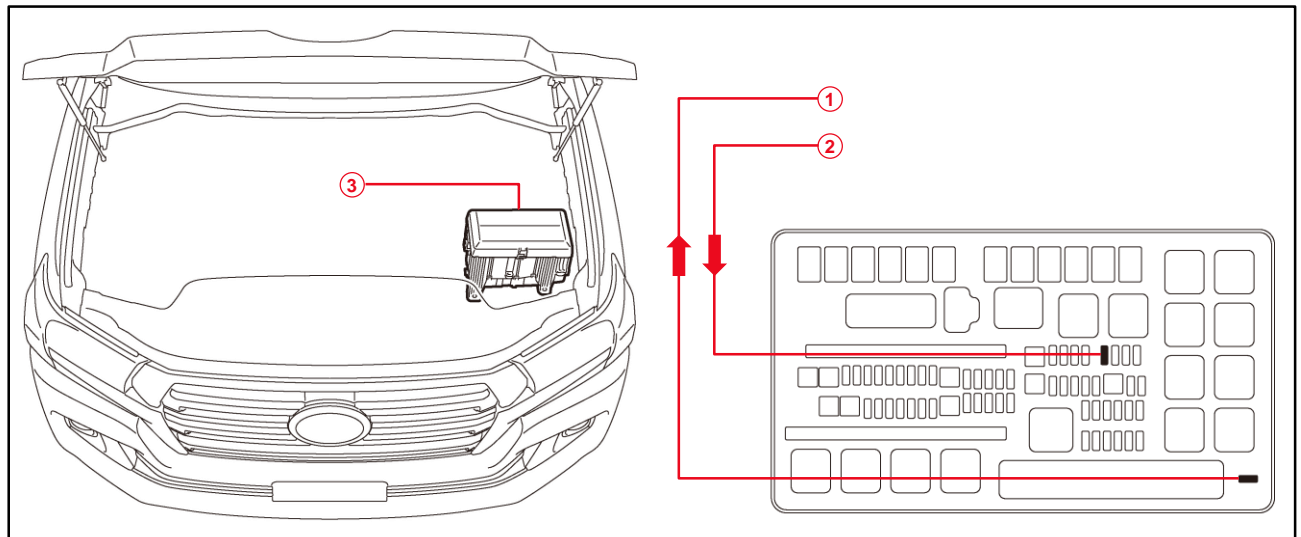

1	Remove D/C Cut Fuse (30A)
2	Install D/C Cut Fuse (30A) (Original Location)
3	Relay Block

2021 Land Cruiser Pre-Delivery Service (PDS)

Tire Pressure Warning System (TPWS) Initialization

Refer to the applicable Repair Manual for the [TPWS initialization procedure](#).

Note the spare tire does NOT have a TPWS sensor.

NOTE

To adjust the tire pressure correctly when the outside temperature is significantly colder than shop temperature, perform a Health Check using Techstream and select the compensation tire pressure checkbox. Compensation pressures will display on the Health Check results screen. Adjust the tire pressure when the tires are cold.

Installation of Towing Wire Harness Connector

The towing wire harness connector set (towing wire harness connector assembly and two bolts) is loaded in the vehicle at the assembly plant to avoid damage during transit.

During PDS, use the following procedure to install the towing wire harness connector to the vehicle.

1. Connect the towing wire harness connectors.
 - A. Remove the water-resistant caps from the two frame wire harness connectors.
 - B. Connect the two frame wire harness connectors and two towing wire harness connectors.

Figure 2.

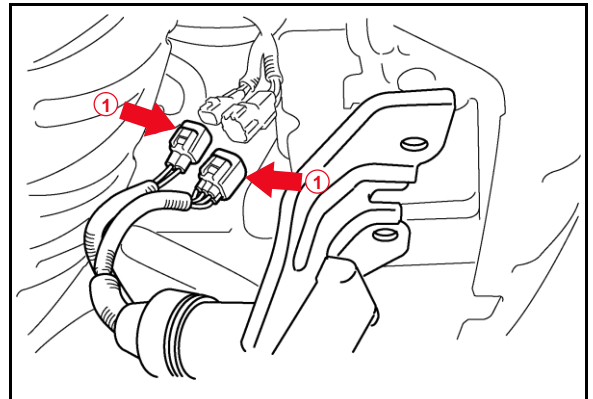

1	Towing Wire Harness Connector
----------	--------------------------------------

2021 Land Cruiser Pre-Delivery Service (PDS)

Installation of Towing Wire Harness Connector (continued)

2. Install the towing wire harness assembly bracket on the frame bracket using the two bolts provided.

Torque: 19.5 N*m (199 kgf*cm, 14 ft*lbf)

Figure 3.

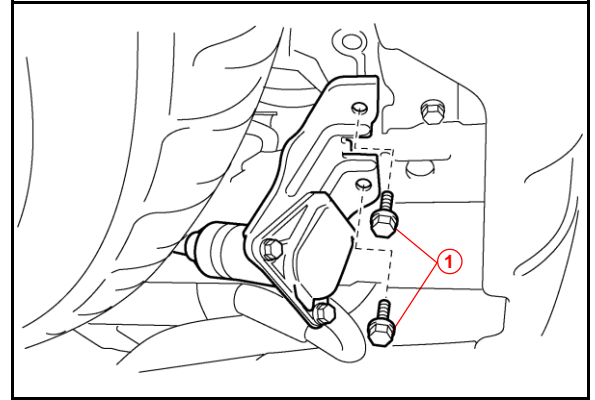

1	Bolt
----------	-------------

Installation of Roof Rack Crossbars

To avoid damage during transportation, the 2021 model year Land Cruiser roof rack crossbars have been placed inside the vehicle at the assembly plant.

Install the roof rack crossbars during PDS using the following procedure.

1. Loosen the adjustment knobs on each crossbar joint.

Figure 4.

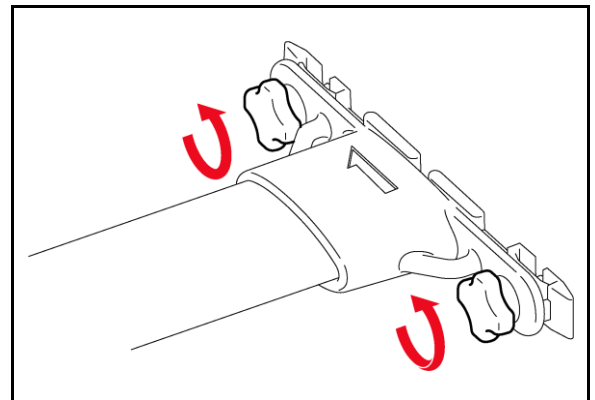

2021 Land Cruiser Pre-Delivery Service (PDS)

Installation of Roof Rack Crossbars (continued)

- Slide the crossbar joints into the grooves of the right and left roof rack rails with the arrow mark on each crossbar joint facing forward.

NOTE

There is a possibility that the crossbars will create wind noise if they are installed backward.

Figure 5.

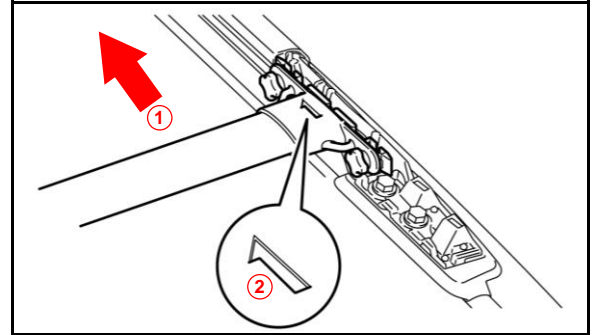

1	Front
2	Arrow Mark

- Position the front and rear crossbars so that they are parallel to each other.
- Securely tighten the knobs on each crossbar (A = A', B = B').

Figure 6.

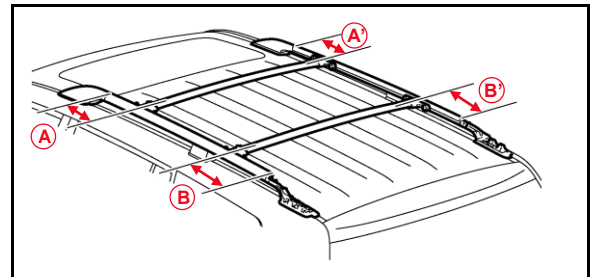

AREA	MEASUREMENT
A	250 mm (9.84 in.)
B	295 mm (11.60 in.)

NOTICE

If the knobs are NOT tightened securely, the knobs may come loose and rattle or possibly fall off the vehicle.

2021 Land Cruiser Pre-Delivery Service (PDS)

Installation of Roof Rack Crossbars (continued)

5. Install the right and left rear roof rack leg covers in the following sequence (labeled as shown):
 - A. Insert the tab at the front of the cover into the roof rack rail.
 - B. Place the cover on the leg and align the rear part of the cover. Do NOT press down.
 - C. Press the cover claws facing the outside of the vehicle into place.
 - D. Press the cover claws facing the inside of the vehicle into place.

NOTICE

Do NOT press on the claws facing the outside of the vehicle at the same time as pressing on the claws facing the inside. This may damage the leg cover.

Figure 7.

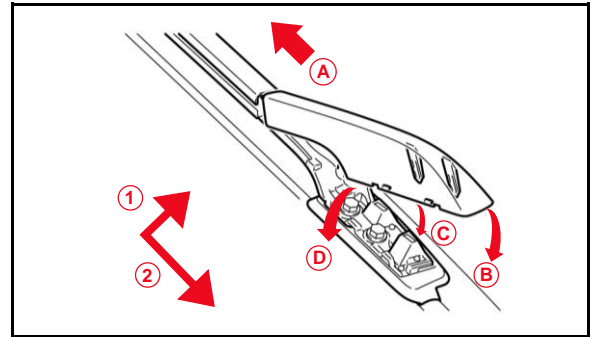

1	Outside
2	Rear

6. Check that the covers are installed securely.

2021 Land Cruiser Pre-Delivery Service (PDS)

Front License Plate Installation

1. Align the installation holes of the front license plate with the dimples of the front bumper.

Figure 8.

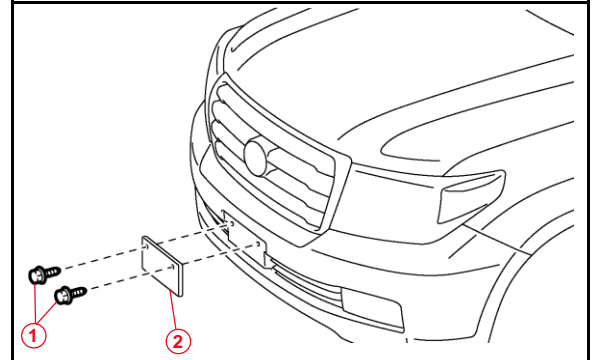

1	Self-tapping Screw
2	License Plate

2. Install the front license plate on the front bumper using two noncorroding self-tapping screws with the following dimensions:

Nominal Length: 20.0 mm (0.79 in.)

Diameter: 6.0 mm (0.24 in.)

NOTICE

- Do NOT pre-drill holes into the bumper.
- Do NOT overtighten the self-tapping screws.

Figure 9.

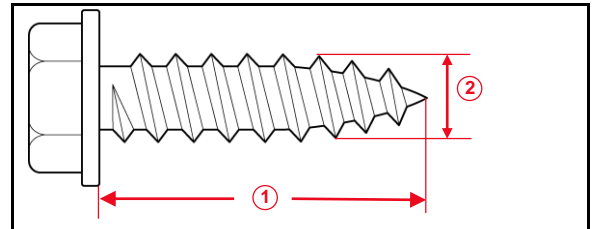

1	Nominal Length
2	Diameter