Parts Information

D501

13

Parts Withdrawal - Fuel Line (PAB13398600)

Replaces all previous bulletin bearing this number.

Attention: Porsche Parts Managers/Parts Personnel

Porsche Cars North America requests return of the following part(s) to PCNA if in stock at your dealership:

Part Number	Description	Instructions
PAB13398600	Fuel Line	All parts without white marking

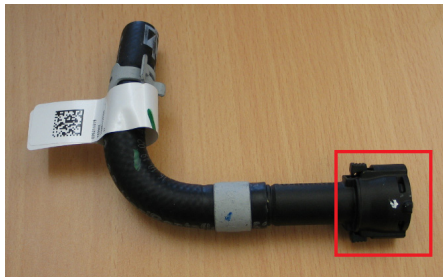

To avoid restocking charges and receive full credit, follow these steps:

- Please enter a return in PPL by Saturday August 15th, 2020.
- Please use **GR13D501** as a purchase order number.
- Parts returned to PCNA without a return delivery note will be sent back to the dealer at dealer's expense.
- Return requests received after the specified return date **will not be processed** and the parts will not be accepted for return. Parts will be coded non-returnable from that date on.
- These parts must be physically returned by close of business day on Saturday **August 22nd, 2020**, to your facing PDC.

Thank you for your cooperation in this matter.

Porsche Cars North America