

**June 19, 2020**

Version 1

## Front Door Lock(s) Do Not Work with Keyless Remote

### AFFECTED VEHICLES

Year	Model	Trim	VIN Range
2018	Odyssey	ALL	ALL
2019	Odyssey	ALL	5FNRL6...KB000001 thru 5FNRL6...KB094339

### SYMPTOM

The front door locks are not unlocking or locking the vehicle with the keyless remote.

### POSSIBLE CAUSES

There is too much friction in the door lock cable assembly.

### CORRECTIVE ACTION

Replace the affected door lock cable(s).

### PARTS INFORMATION

Part Name	Part Number	Quantity
Left Front Door Latch Cable Assembly	72174-THR-A01	1
Right Front Door Latch Cable Assembly	72134-THR-A01	1

**CUSTOMER INFORMATION:**The information in this bulletin is intended for use only by skilled technicians who have the proper tools, equipment, and training to correctly and safely maintain your vehicle. These procedures should not be attempted by "do-it-yourselfers," and you should not assume this bulletin applies to your vehicle, or that your vehicle has the condition described. To determine whether this information applies, contact an authorized Honda automobile dealer.

## WARRANTY CLAIM INFORMATION

The normal warranty applies.

Operation Number	Description	Flat Rate Time	Defect Code	Symptom Code	Template ID	Failed Part Number
8191B3	Replace the right front door lock cables.	0.6 hr	07403	03217	A20037A	72134-THR-A01
8181B6	Replace the left front door lock cables.	0.6 hr	07403	03217	A20037B	72174-THR-A01
8181E4	Replace both the left and right front door lock cables. <div><b>NOTE</b> Administration time is only paid once per operation number.</div>	1.0 hr	07403	03217	A20037C	72174-THR-A01

Skill Level: Repair Technician

## REPAIR PROCEDURE

### NOTE

The images in this repair procedure show the right side of the vehicle. Repair to the left side will be done the same way.

1. Carefully pry out the handle case cap, then remove the two screws.

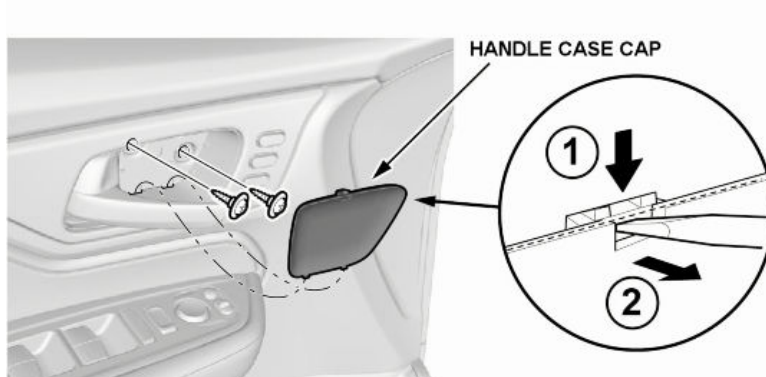

2. Remove the pull pocket cover, then remove the screw.

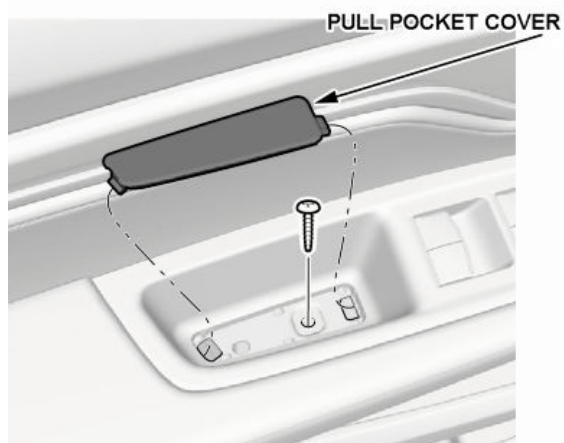

3. Starting at the bottom edge of the front door panel, remove the clips as shown.

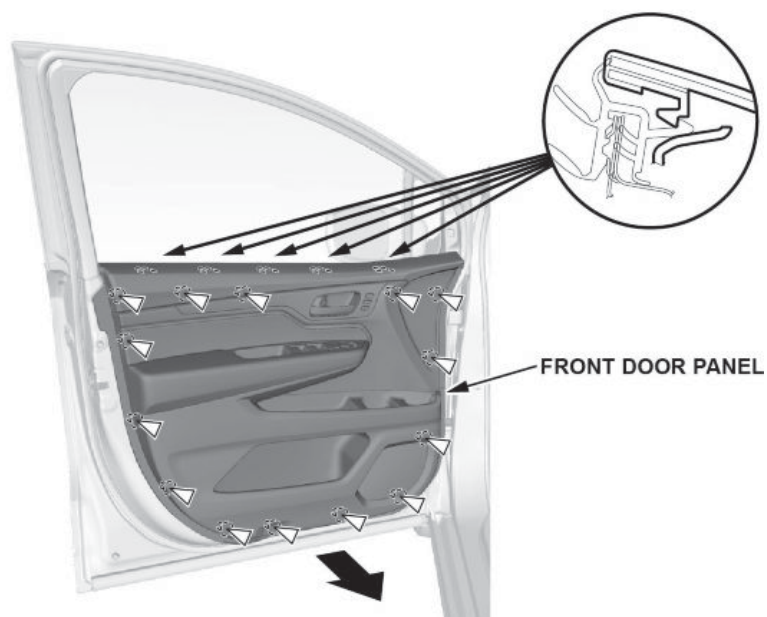

4. Release the inner handle from the inside of the front door panel. While holding the front door panel away from the door, disconnect the connectors.

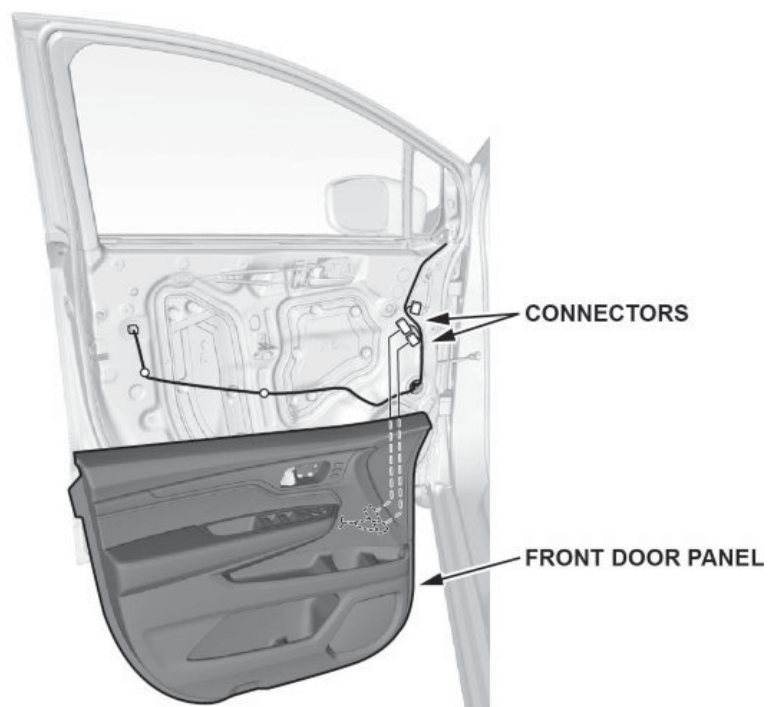

5. Disconnect the inner handle cable and latch cable from the inner handle.

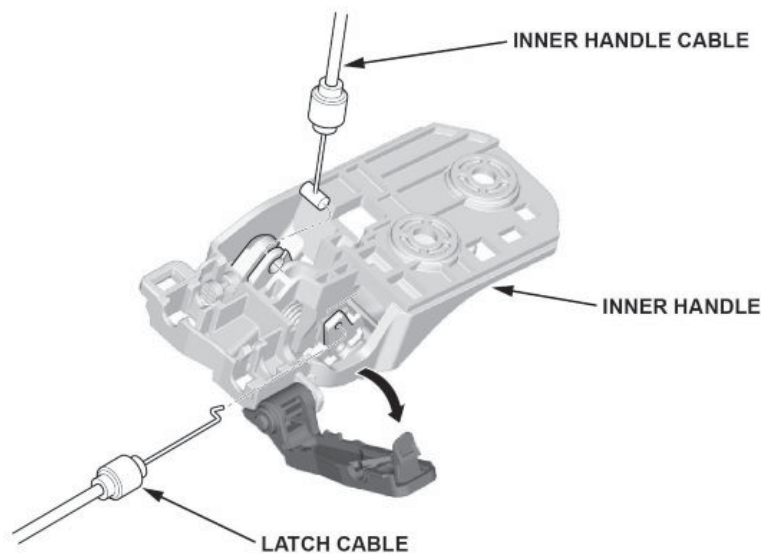

6. Remove panel barrier B.

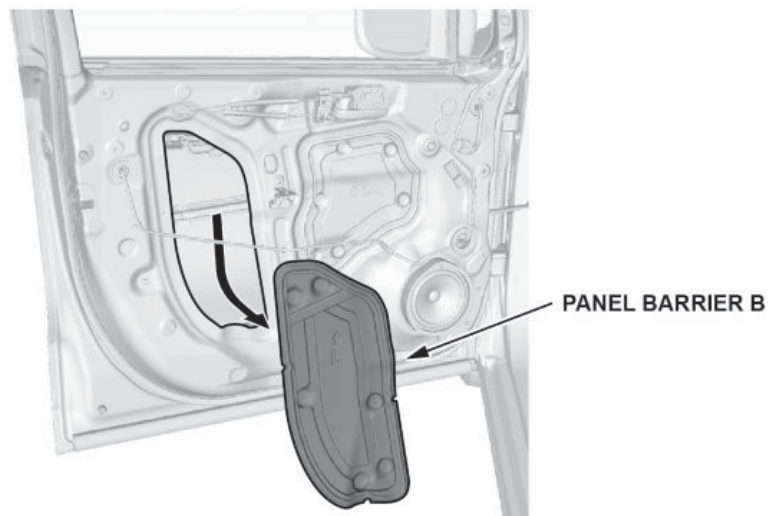

7. Disconnect the connector, and remove the bolt. Then remove the front window lower channel.

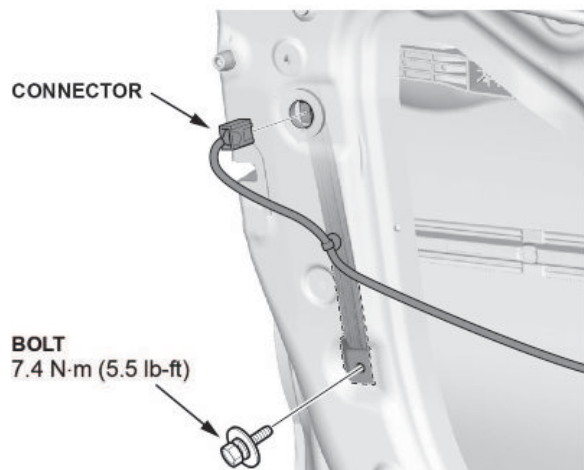

8. Remove the front door latch.
  - 8.1. Remove the three bolts.
  - 8.2. Remove the harness clip.
  - 8.3. Pull and rotate the front door latch to disconnect the cylinder rod.
  - 8.4. Pull the front door latch downward to disconnect the outer handle rod, then remove the front door latch.

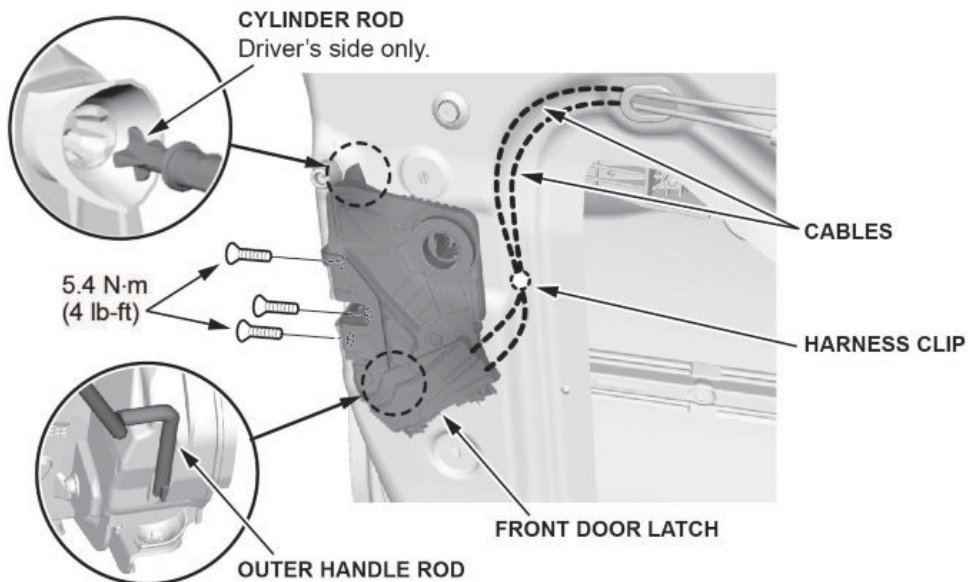

9. Open the latch protective cover, then disconnect the inner handle cable and latch cable from the front door latch.

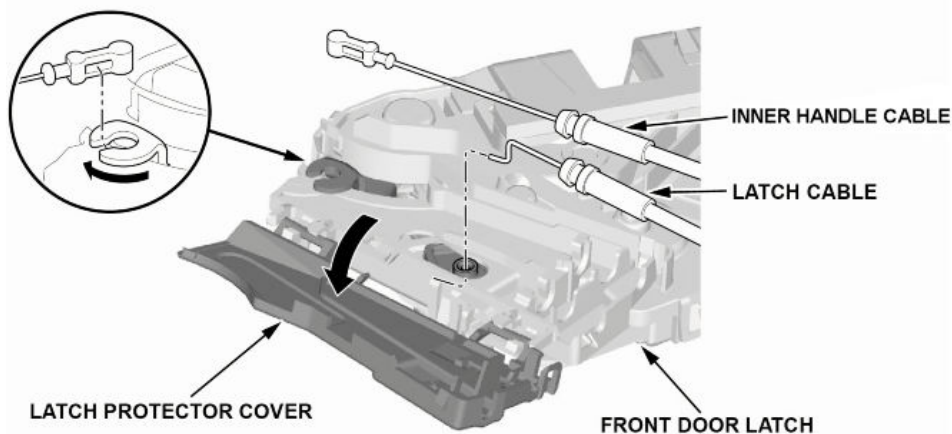

10. Remove and replace the door lock cables.

**NOTE**

Make sure to leave the clip loose as it came new in the packaging. Tightening this clip will result in premature failure. Cables must be able to move freely.

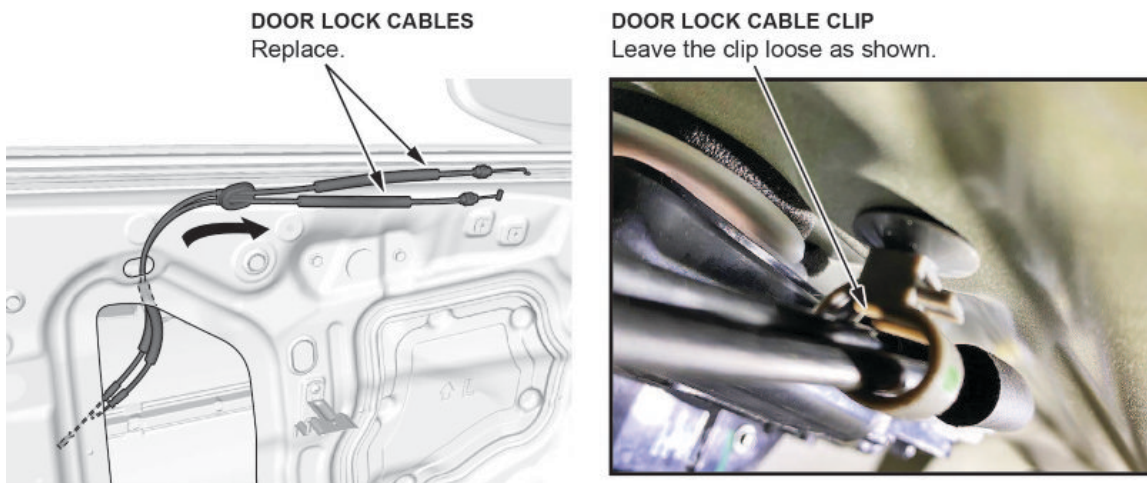

11. Install the cables to the front door latch in the reverse order of removal.

**NOTE**

When installing the driver side, make sure to apply multipurpose grease to the open lever clip and install the cable in to the door latch as shown.

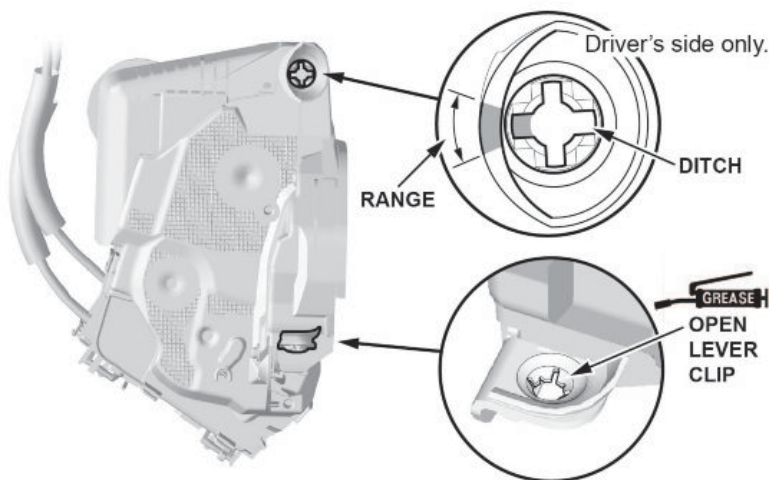

12. Install all remaining parts in the reverse order of removal.

13. Do a power window control unit reset. Refer to the service information.

14. Check the door lock operation with both the door switch and keyless remote.

END