



SIB 51 05 20 FUEL FILLER DOOR STICKING

This Service Information Bulletin (Revision 1) replaces SI B51 05 20 **dated February 2020**.

What's New (Specific text highlighted):

- Procedure
- Parts
- Warranty

MODEL

E-Series	Model Description
G06	X6 Sports Activity Coupe
G07	X7 Sports Activity Vehicle

SITUATION

The fuel filler door may be sticking, requiring multiple attempts to open.

CAUSE

The fuel filler door material can swell in wet conditions, causing the filler door to stick.

CORRECTION

Modify the fuel filler door.

PROCEDURE



1. Open the fuel filler door to inspect the orientation of the fuel filler door ejector.

Ensure the ejector is positioned straight up and down as shown to the left.

Is the ejector OK as shown to the left?

Yes: Continue to step 2.

No: Replace the complete insert (aka cover pot) and continue to step 3.

Repair instructions are attached to this bulletin and will be included within ISTA/AIR in a future release.

2. This is the area which will be modified (circled). **Do not modify the lower tab, only the upper.**



3. Remove 0.7 mm from the upper tab (arrow) using a file. A feeler gauge can be used (shown lying flat along top edge) to assist with measuring.



4. Close the filler flap and measure the distance between the upper tab and the filler door assembly. The gap must be at least 0.1 mm.



5. Open the filler door to measure the slotted opening of the filler flap as shown to the left.

6. Enlarge the slotted opening by 1 mm

by filing away the edge (arrows).



Note: File only the outer edges of the slotted opening, do not file the center section.



7. Apply a 5 mm section of butyl inside each locking tab of the filler door, in the area shown to the left.



8. The photo to the left shows correct installation of butyl.

9. Reassemble the vehicle.

PARTS INFORMATION

Labor Operation	Description	Labor Allowance
41 63 000	Removing and installing the fuel filler flap (Main work)	Refer to AIR
Or:		
41 63 500	Removing and installing the fuel filler flap (Plus work)	Refer to AIR
And:		
51 00 001	Work time to modify the fuel filler (flap) door	3 FRU

If you are using a Main labor code for another repair, use the Plus code labor operation 41 63 500 instead of 41 63 000.

Or:

Labor Operation	Description	Labor Allowance
41 63 003	Replace cover bowl (Main work) (includes removing and installing the fuel filler flap)	Refer to AIR
Or:		
41 63 503	Replace cover bowl (Plus work) (includes removing and installing the fuel filler flap)	Refer to AIR
And, if necessary:		

51 00 001	Work time to modify the fuel filler (flap) door	3 FRU
-----------	---	-------

If you are using a Main labor code for another repair, use the Plus code labor operation 41 63 503 instead of 41 63 003.

Refer to AIR for the corresponding flat rate unit (FRU) allowances.

Work time labor operation code 51 00 001 is not considered a Main labor operation. Also, since the work time FRU allowance to be claimed is specified, a separate punch time is not required. However; it still requires an explanation on the repair order and in the claim comments section.

And, as needed:

Sublet – Bulk Materials (RO and Claim Comments Required)

Sublet Code 4	See the sublet reimbursement calculations below	Reimbursement for the repair-related bulk materials (Do not use the BMW part numbers for claim submission)
----------------------	---	--

Sublet reimbursement calculation for claiming the applicable repair-related bulk materials (BMW part numbers) is at the dealer net price amount for the quantities used plus your center's handling.

Enter this material cost in sublet and itemize the amount on the repair order and in claim comment section.

Main Group (MG) "41" Flat Rate Labor Operations

The secondary "R" FRU value notation identifies the amount of inclusive "mechanical work" that is also contained in this MG 41 flat rate labor operation. For example, removing and installing related attached or associated assemblies and/or body components.

Since this notation identifies inclusive work, please **do not** claim the stated "R" FRU amount "separately and in addition" to the job item's primary FRU allowance which is listed next to the letter "R."

Other Repairs

If this Service Information Bulletin does not apply, but other eligible and covered work is performed as a result of diagnosing a similar issue, claim this work with the applicable defect code and the labor operations that are listed in AIR (including diagnosis with separate punch times).

Supporting Materials

[picture_as_pdf B51 05 20 Attachment 1.pdf](#)

Replace cover bowl



Necessary preliminary work:

- Remove right rear wheel
- Remove rear right wheel arch cover
- Remove flap for fuel filler neck
- Close the central locking system with open cap



Caution!

Deformation of the sheet metal flanges in the side wall and the wheel arch results in permanent vehicle leakage. Carry out removal/installation with great care.

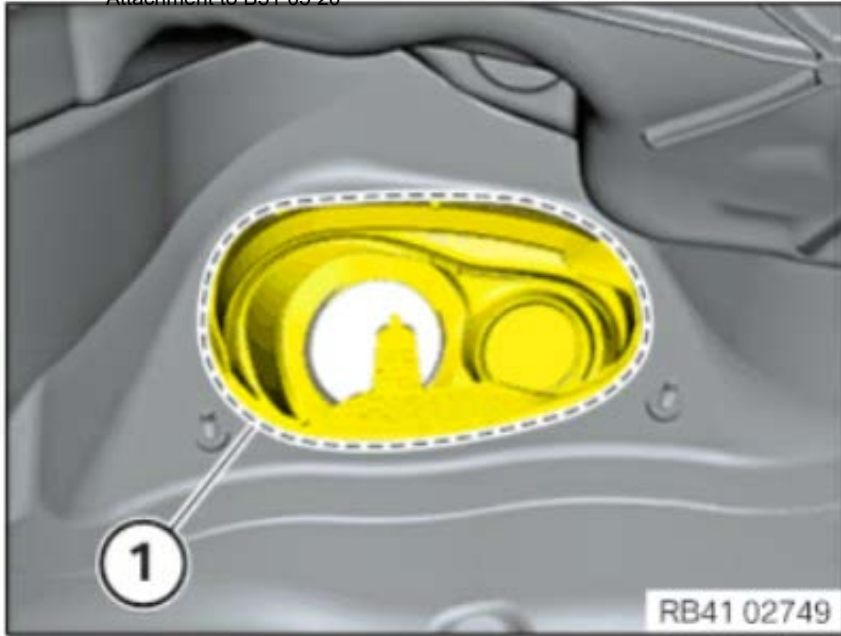

Press sealing cup (1) through to the outside.

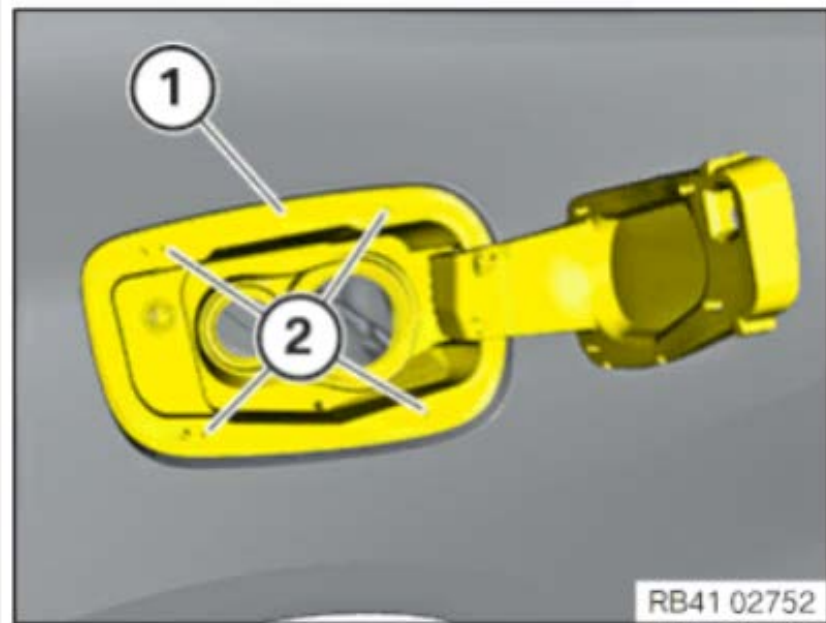

Pierce cover bowl at markings (3) with a small screwdriver.

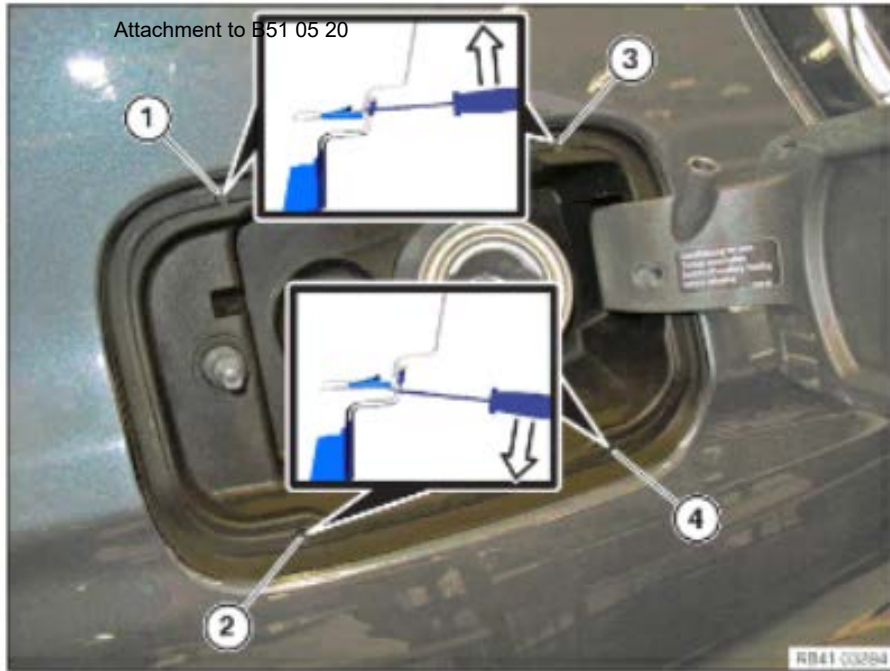

Keep cover bowl tensioned.

Unlock catches individually with screwdriver

Unlock catches in following order:

- 1.Top left
- 2.Bottom left
- 3.Top right
- 4.Bottom right

Move screwdriver in opposite direction at both lower catches.

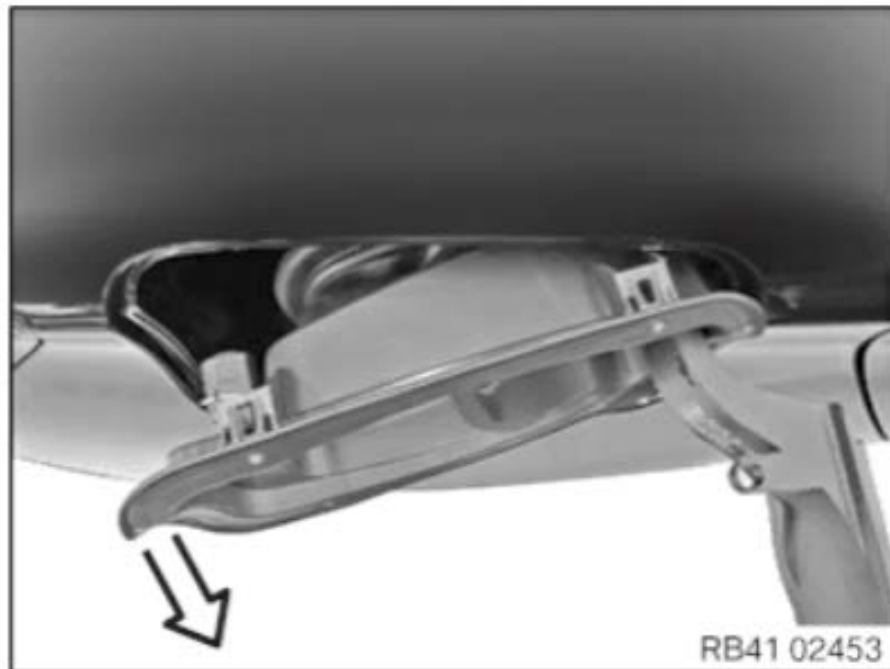

Close the hinge arm.

Caution!

Do not damage sheet metal flange of side wall.

Carefully twist out cover bowl at first at rear in direction of arrow from side wall and remove.