

WLE1 - Checking Wiper Arm Screw Connections or Replacing Wiper Arms (Delivery Stop/Workshop Campaign)

Model line: **Taycan (Y1A)**

Model Year: **2020**

Subject: **Left and right wiper arm**

Information: **Due to unfavorable tolerance pairings, the force transmission between the windscreen wiper arms and wiper linkage does not comply with specifications on the affected vehicles.**

If the windscreen wiper is operated at high load over a lengthy period of time, e.g. during heavy rain and at the highest wiper setting, this may result in damage to the wiper arms.

Remedial Action:



Information

The measure to be carried out during this campaign depends on the **relevant delivery status of the affected vehicles**.

Vehicles without registered warranty start date:

- Tighten wiper arm screw connections to a higher tightening torque
- Check that the wiper arms are installed securely to the wiper linkage
- Replace one or both wiper arms depending on the result of the check

For instructions, see ⇒ *Technical Information 'Checking wiper arm screw connections'*.

Vehicles with registered warranty start date:

- Replace both wiper arms and tighten to a higher tightening torque

For instructions, see ⇒ *Technical Information 'Replacing wiper arms'*.

Affected Vehicles: Only vehicles assigned to the campaign (see also PCSS Vehicle Information). This campaign affects 595 vehicles in North America.

Installation
Position:

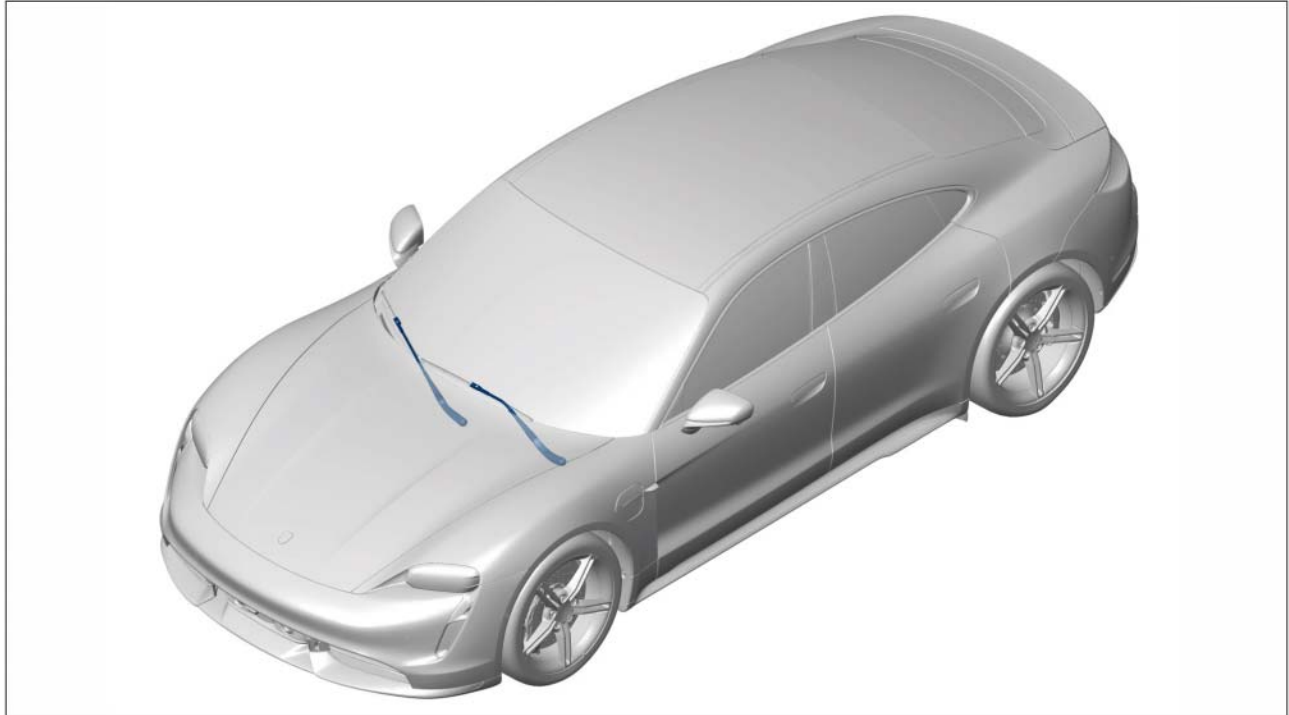

Installation position overview

Parts required

Parts Info:



Information

The required parts depend on the relevant delivery status of the affected vehicles.

On vehicles **without registered warranty start date**, the wiper arm screw connections must **first be checked** and the **required parts** then determined based on the **result of the test**.

On vehicles **with registered warranty start date**, **both wiper arm replacements are always required**.

Part No.	Designation	Qty.
9J1955409	⇒ Left wiper arm	1 ea. (as required)
9J1955410	⇒ Right wiper arm	1 ea. (as required)

Required tools

- Tools:
- Torque wrench, 6–50 Nm (4.5–37 ftlb.), e.g. **Torque wrench, 6-50 Nm (4.5-37 ftlb.), VAG 1331A**
 - **Pole terminal puller, VAS 6935 or equivalent**
 - Copper wire brush, commercially available

Tighten wiper arm screw connections and check that the wiper arms are installed securely.



Information

The **procedure described in this section** applies only to **vehicles without registered warranty start date**.

Both windscreen wiper arms must always be replaced on vehicles with registered warranty start date. This procedure is described in the section ⇒ *Technical Information 'Replacing wiper arms'* of this Technical Information.

- Work Procedure: 1 Move the windshield wipers to their original position.
- 1.1 Switch on ignition.
 - 1.2 Activate the windshield wipers once using the "one-touch wipe" function. For this purpose, press the wiper lever down once briefly.
 - 1.3 As soon as the windshield wipers have returned to their original position, switch off ignition.
- 2 Remove the driver's key from the vehicle and place it at a distance of **at least 16 feet** from the vehicle.
- 3 Tighten the wiper arm screw connections.
- 3.1 Open the front lid.
 - 3.2 Lever the caps ⇒ *Caps -1-* off the wiper arms using a suitable tool and remove them.

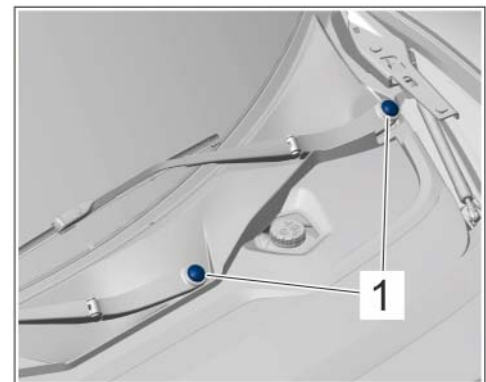

Caps

- 3.3 Tighten the fastening nuts ⇒ *Fastening nuts for wiper arms -1-* of both wiper arms using a torque wrench while countering at the relevant wiper arm.
Tightening torque 45 Nm (33 ftlb.)

- 3.4 Close the front lid.

- 4 Check that both wiper arms are installed securely.

- 4.1 Switch on ignition.

- 4.2 Switch on the windshield wipers in the "**slow continuous wiping**" setting. **Note: Not the intermittent position!**

For this purpose, press the wiper lever up as far as the second detent (setting 2).

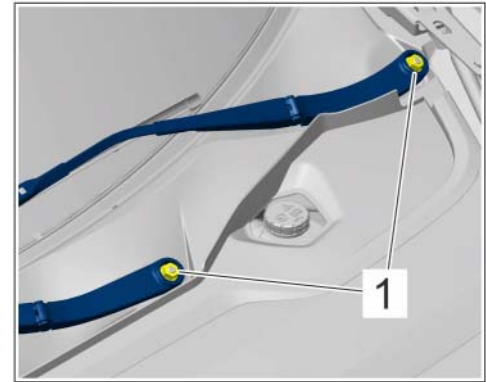

Fastening nuts for wiper arms

WARNING

Electrically moved components

- **Danger of extremities becoming trapped**
- ⇒ **Wear suitable gloves as protective gear.**

- 4.3 **Grasp the wiper arm** on the driver's side ⇒ *Checking wiper arm screw connections -1-* at the highest point and **hold** it firmly against the resistance of the wiper motor ⇒ *Checking wiper arm screw connections -Arrows-*.

- **The direction of rotation of the wiper motor changes briefly several times, then the wiper motor switches off:** The **held** wiper arm is **screwed on correctly**. Continue with step 4.4.
- **The wiper motor does not switch off and the wiper arm on the passenger's side continues to run:** The wiper arm that is held is **not screwed on correctly** and must be **replaced**. For this purpose, first repeat the test on the other wiper arm (step 4.4) and then replace one or both wiper arms depending on the results of the check.

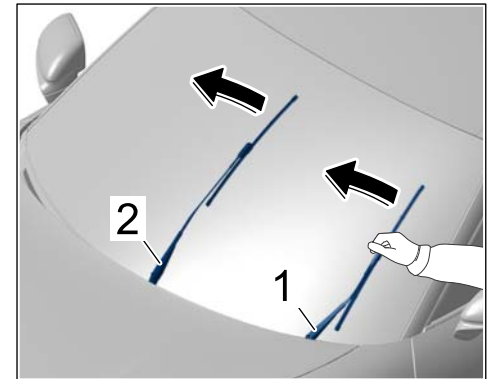

Checking wiper arm screw connections

- 4.4 Repeat the check for the wiper arm on the passenger's side ⇒ *Checking wiper arm screw connections -2-*. For this purpose, first switch the windshield wipers off and then switch them on again in the "**slow continuous wiping**" setting. **Note: Not the intermittent position!**

- If **both wiper arms are screwed on correctly**, continue with step 5.

- To **replace** one or both wiper arms, continue with ⇒ *Technical Information 'Replacing wiper arms'*.
- 5 Switch off the windshield wipers and switch off ignition.
 - 6 Press caps ⇒ *Caps -1*- onto both wiper arms until they engage securely.

End of action required

Do **not** enter the campaign in the Warranty and Maintenance booklet.

For warranty processing, see **Scope 1** under ⇒ *Technical Information 'Warranty processing'*.

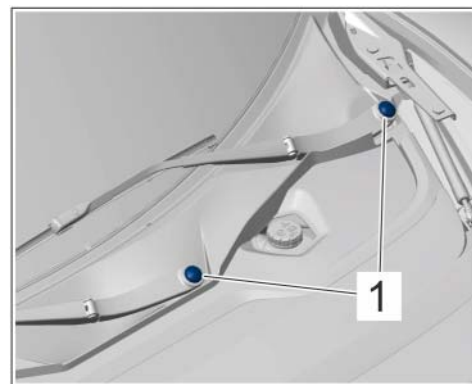

Caps

Replacing wiper arms



Information

The **procedure described in this section** applies to vehicles **with registered warranty start date**.

In addition, the following description applies to vehicles **without registered warranty start date** on which the **previous check** has resulted in the required replacement of one or both wiper arms.

Contrary to the description below, both wiper arms do not always have to be replaced on these vehicles, but those required **in accordance with the result of the previous check**.



Information

To counteract the deformation of the wiper rubber that occurs when it is at rest, the wiper arm is alternately moved to two different parked positions. This is done **for the first time after a total of 100 wiping actions**.

The wiper arm must only be removed and installed in the lower parked position. Before removing or installing the wiper arm, actuate the wipers once and check that the wiper moves slightly upwards into the upper parked position after reaching the lower parked position

. In this case, actuate the wipers again so that the wiper arm remains in the lower parked position.

Work Procedure: 1 Remove wiper arm at the left and right ⇒ *Workshop Manual '922519 Removing and installing wiper arm'*.

Prior to the removal of both arms: Remove the driver's key from the vehicle and place it at a distance of **at least 5 meters (17 feet)** from the vehicle.

2 Clean shaft for left and right wiper arm on the wiper linkage using a suitable copper wire brush.

3 Remove the wiper blade or transport wiper from the previously removed wiper arms and install onto the new wiper arms.

For instructions, see ⇒ *Workshop Manual '922719 Removing and installing wiper blade'*.

Part No.	Designation	Qty.
9J1955409	Left wiper arm	1 ea.
9J1955410	Right wiper arm	1 ea.

4 Install new left and right wiper arms ⇒ *Workshop Manual '922519 Removing and installing wiper arm'*.

Always observe the **increased tightening torque: Tightening torque 45 Nm (33 ftlb.)**

5 **Only for vehicles with registered warranty start date:**

Enter the campaign in the Warranty and Maintenance booklet.

End of action required

For warranty processing, see the section ⇒ *Technical Information '922519 Warranty processing'*:

- Vehicles **without registered warranty start date**: Scopes 2 – 4, depending on the result of the check
- Vehicles **with registered warranty start date**: Scope 5

Warranty processing

Scope 1: Check wiper arm screw connections – **no wiper arm** needs to be replaced

- **Only valid** for vehicles **without registered warranty start date**

Working time:

Checking wiper arm screw connections

Labor time: **44 TU**

Includes: Tightening screws securing both wiper arms to a higher tightening torque

Without: Removing and installing wiper arms

⇒ **Damage Code WLE1 066 000 1**

Scope 2: Checking wiper arm screw connections and **replacing left wiper arm**

- **Only valid** for vehicles **without registered warranty start date**

Working time:

Checking wiper arm screw connections Labor time: **63 TU**

Includes: Tightening screws securing both wiper arms to increased torque
 Removing and installing left wiper arm
 Removing and installing left wiper blade

Parts required:

9J1955409	Left wiper arm	1 ea. (as required)
-----------	----------------	------------------------

⇒ **Damage Code WLE1 066 000 2**

Scope 3: Checking wiper arm screw connections and **replacing right wiper arm**

- **Only valid** for vehicles **without registered warranty start date**

Working time:

Checking wiper arm screw connections Labor time: **63 TU**

Includes: Tightening screws securing both wiper arms to increased torque
 Removing and installing right wiper arm
 Removing and installing right wiper blade

Parts required:

9J1955410	Right wiper arm	1 ea. (as required)
-----------	-----------------	------------------------

⇒ **Damage Code WLE1 066 000 2**

Scope 4: Checking wiper arm screw connections and **replacing both wiper arms**

- **Only valid** for vehicles **without registered warranty start date**

Working time:		
Checking wiper arm screw connections		Labor time: 76 TU
Includes:	Tightening screws securing both wiper arms to increased torque	
	Removing and installing left and right wiper arms	
	Removing and installing left and right wiper blades	
Parts required:		
9J1955409	Left wiper arm	1 ea. (as required)
9J1955410	Right wiper arm	1 ea. (as required)
⇒ Damage Code WLE1 066 000 2		

Scope 5: **Replacing both wiper arms**

- **Only valid** for vehicles **with registered warranty start date**

Working time:		
Replacing both wiper arms		Labor time: 45 TU
Includes:	Removing and installing left and right wiper blades	
Parts required:		
9J1955409	Left wiper arm	1 ea.
9J1955410	Right wiper arm	1 ea.
⇒ Damage Code WLE1 66 000 2		

Important Notice: Technical Bulletins issued by Porsche Cars North America, Inc. are intended only for use by professional automotive technicians who have attended Porsche service training courses. They are written to inform those technicians of conditions that may occur on some Porsche vehicles, or to provide information that could assist in the proper servicing of a vehicle. Porsche special tools may be necessary in order to perform certain operations identified in these bulletins. Use of tools and procedures other than those Porsche recommends in these bulletins may be detrimental to the safe operation of your vehicle, and may endanger the people working on it. Properly trained Porsche technicians have the equipment, tools, safety instructions, and know-how to do the job properly and safely. Part numbers listed in these bulletins are for reference only. The work procedures updated electronically in the Porsche PIWIS diagnostic and testing device take precedence and, in the event of a discrepancy, the work procedures in the PIWIS Tester are the ones that must be followed.

© 2020 Porsche Cars North America, Inc.