



Service Bulletin 572

Issue 1 - 01.2020

Subject: Seat Finisher Panel				
Bulletin Number	Models Affected	VIN Range		Markets Affected
572	Rocket 3 GT Rocket 3 R Rocket 3 TFC	From 978634	to AA4338	All

Background Information

Internal investigations have identified the need to fit seat trim to the seat finishers to improve the cosmetic appearance on the above models.

Dealers are requested to fit the seat trim to the seat finishers as described in the procedure below.

Customer Contact Instructions

Motorcycles in the affected VIN range must be modified prior to delivery to the customer, or at the next visit to the dealership.

Identification of Affected Motorcycles

Rocket 3 GT, Rocket 3 R and Rocket 3 TFC motorcycles in the above VIN ranges.

Note:

- Some affected motorcycles listed in the VIN range will have been modified and repaired by Triumph prior to their release from the factory.
- Unmodified motorcycles can be identified by checking the 'VIN Enquiry' on www.triumphonline.net.

Warranty Claim Instructions

Bulletin Number	Model	Fault Code	Repair Code	Description	Repair Allowance	Time
572	Rocket 3 GT Rocket 3 R Rocket 3 TFC	023045972	99572	SB572 - Fit seat trim	0.12 Hours	

Genuine Parts Information

Bulletin Number	Model	Part Number	Description	Quantity
572	Rocket 3 GT	T2310543	Kit, Trim, Seat, Tour	1
	Rocket 3 R	T2310544	Kit, Trim, Seat, Sport	1
	Rocket 3 TFC			

Parts Ordering Instructions

For Triumph Subsidiary and Overseas Distributor dealers using Triumph Warranty On-Line with Parts Auto Ordering Flag switched on: Order all repair parts by submitting a New Prior through the Warranty On-Line system. Entering the above repair code in a New Prior will automatically add the parts required and labour times for this Service Bulletin.

For Overseas Distributor dealers NOT using Triumph Warranty On-Line or for Overseas Distributor dealers using Triumph Warranty On-Line with Parts Auto Ordering Flag switched off: Orders should be placed using the normal parts ordering procedure.

Other Instructions

Once completed, please mark the Service Record Book that the requirements of this bulletin have been complied with.

Before returning the motorcycle to the customer, download the latest calibration using the current version of the Triumph diagnostic software to the following:

- Engine electronic control module
- Chassis electronic control module (if fitted)
- Keyless electronic control module (if fitted)
- Suspension electronic control module (if fitted)
- Connectivity module (if fitted)
- Instruments (if applicable).

Fit seat trim to seat finisher

Fit the seat trim to the seat finishers following the procedures described below.

Warning

Make sure the motorcycle is stabilised and adequately supported.
A correctly supported motorcycle will help prevent it from falling.
An unstable motorcycle may fall, causing injury to the operator or damage to the motorcycle.

Caution

To prevent damage to the seats or seat covers, care must be taken not to drop the seats. Do not lean the seats against the motorcycle or any surface which may damage the seats or seat covers. Instead, place the seats, with the seat cover facing upwards, on a clean, flat surface which is covered with a soft cloth.
Do not place any item on the seats which may cause damage or staining to the seat covers.

1. Remove the seat as described in the Service Manual.

-
- Remove the four seat finisher fasteners.

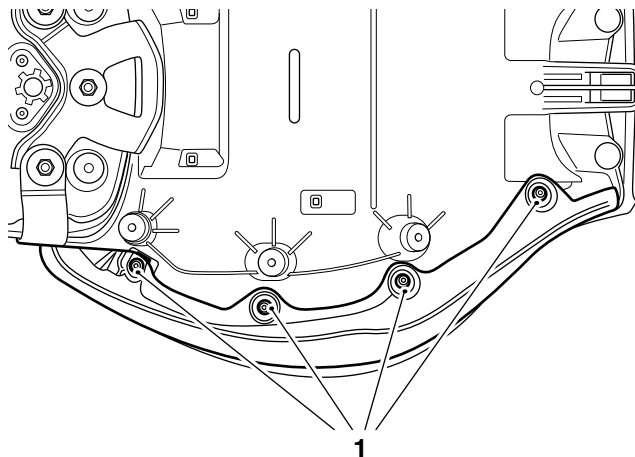

ckrd

1. Seat finisher fasteners

- Remove the seat finisher from the seat.

Note:

The seat trim has a longer lip on one side. The longer lip must be fitted to the inside of the seat finisher as shown.

Make sure that the seat trim is flush with the rear end of the seat finisher.

- Starting at the rear of the seat finisher, fit the seat trim to the seat finisher.

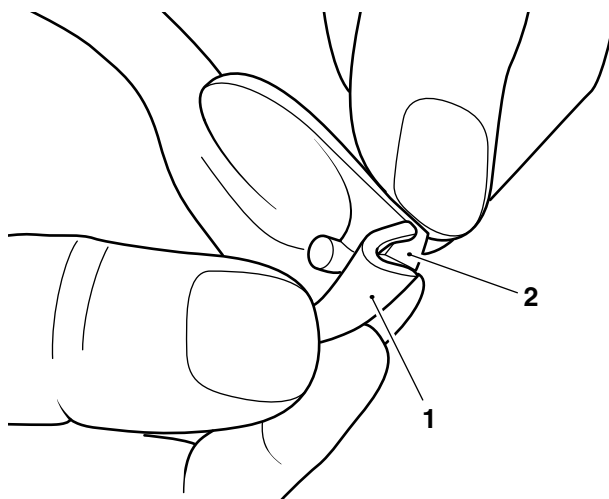

- Seat trim
- Seat finisher

-
5. Install the seat finisher to the seat but do not fully tighten at this stage.

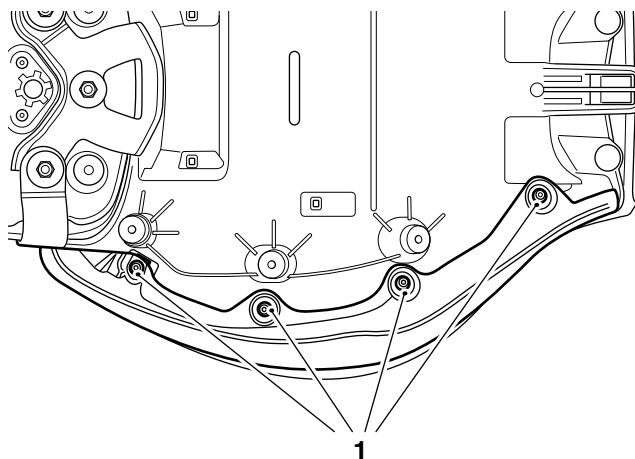

ckrd

1. Seat finisher fasteners

6. Hold the rear of the seat finisher, seat trim and seat together.

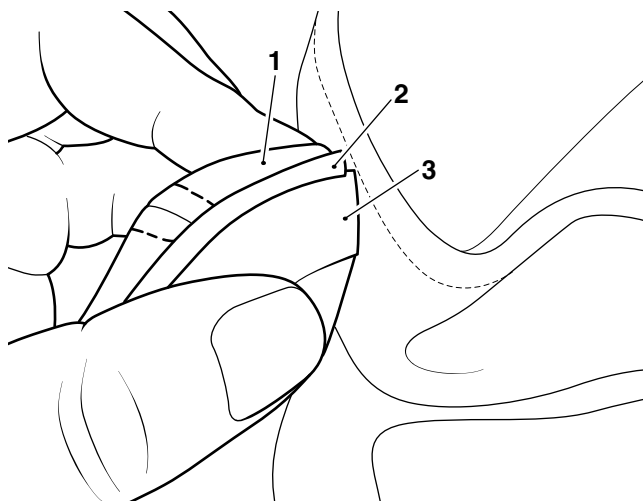

- 1. Seat**
2. Seat trim
3. Seat finisher

Note:

Making sure that the seat trim is located correctly, continue to hold the rear of the seat as shown in step 6 while tightening the rear fastener shown in step 7. Then tighten the remaining fasteners in the order shown.

7. Tighten the seat finisher fasteners in the order shown to 3 Nm.

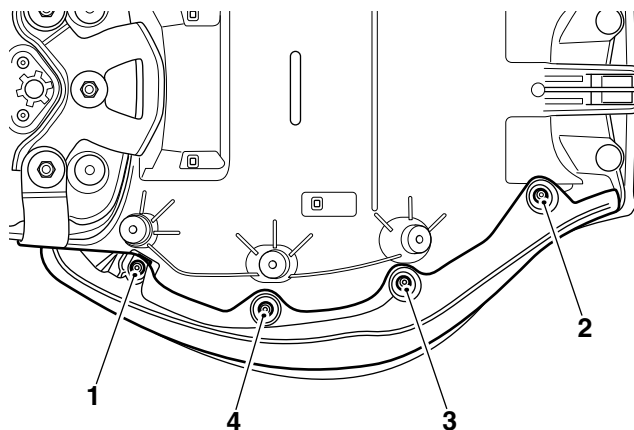

Note:

Make sure that there are no visible gaps between the seat and the seat trim.

- If there are visible gaps, push the seat trim upwards so that the seat trim is in contact with the seat.

8. Make sure that the seat trim is installed evenly across the length of the seat finisher.

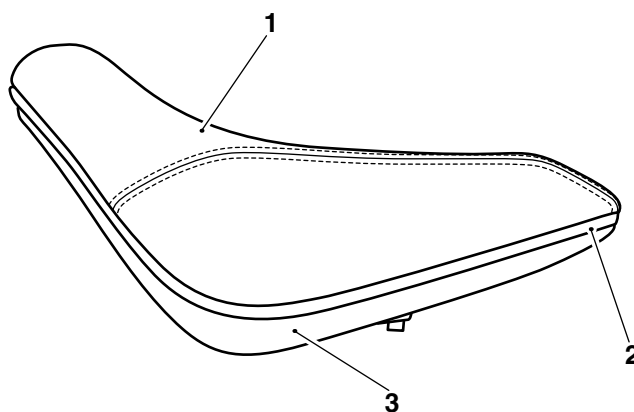

1. Seat
2. Seat trim
3. Seat finisher

9. Repeat steps 2 - 8 to the opposite side seat finisher.
10. Refit the seat as described in the Service Manual.

Circulation

Initial and date when read and return to central file holder

Service Manager	Parts Manager	Sales Manager	Workshop Supervisor	Technician 1	Technician 2