



HYUNDAI

Technical Service Bulletin

GROUP Body	NUMBER 20-BD-006H
DATE March, 2020	MODEL(S) Veloster (JS)

SUBJECT: DOOR LATCH GREASE APPLICATION

Description: This bulletin describes the procedure to apply grease to the coupling lever of a door latch that has difficulty opening.

Applicable Vehicles: Certain Veloster (JS) vehicles produced between 2/1/2018 – 3/20/2020

Parts Information:

PART NAME	PHOTO	PART NUMBER	REMARKS
HHS-K Hinge Lubricant		Product Code: 0893106050	This item should be purchased directly from Würth. Contact Würth (1-800-263-5002) or your local Würth representative.

Warranty Information:

MODEL	OP CODE	OPERATION	OP TIME	CAUSAL PART	NATURE CODE	CAUSE CODE
Veloster (JS)	81310F07	DOOR LATCH GREASE APPLICATION	0.5 M/H	81310-XXXXX	I21	ZZ6
				81320-XXXXX		

NOTE 1: Refer to the parts catalog for the applicable part number for the vehicle.

NOTE 2: The cost of the lubricant can be reimbursed through sublet.

Service Procedure:

1. Using the Veloster shop manual, remove the door trim panel and door latch assembly.

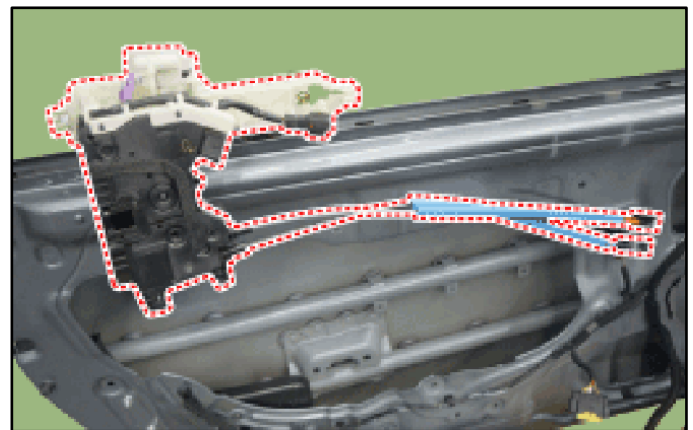
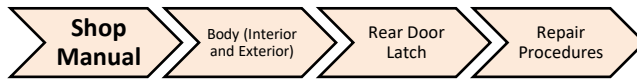
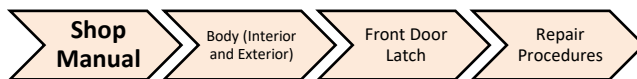
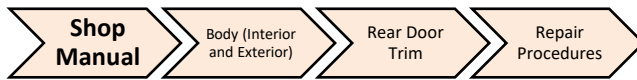
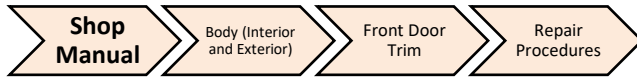

2. Locate the drain hole located at the bottom of the door latch assembly.

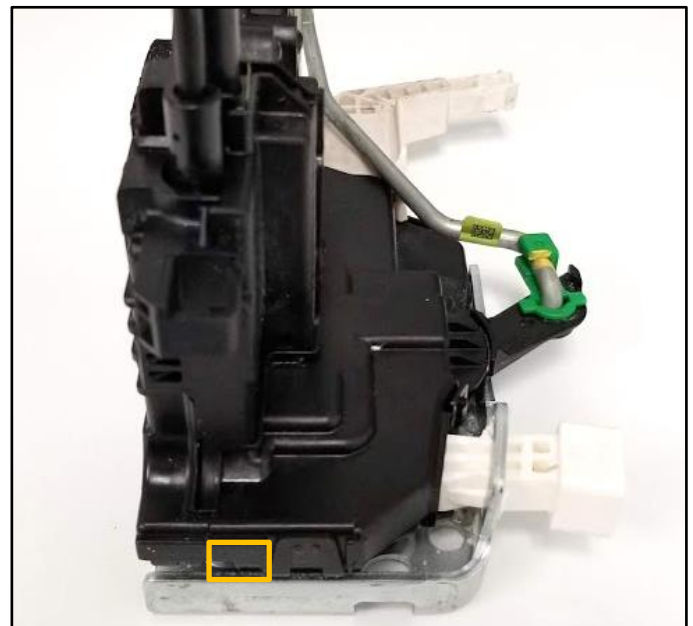

3. Insert the grease nozzle straw into the drain hole, and apply grease inside the door latch assembly. Apply grease generously.

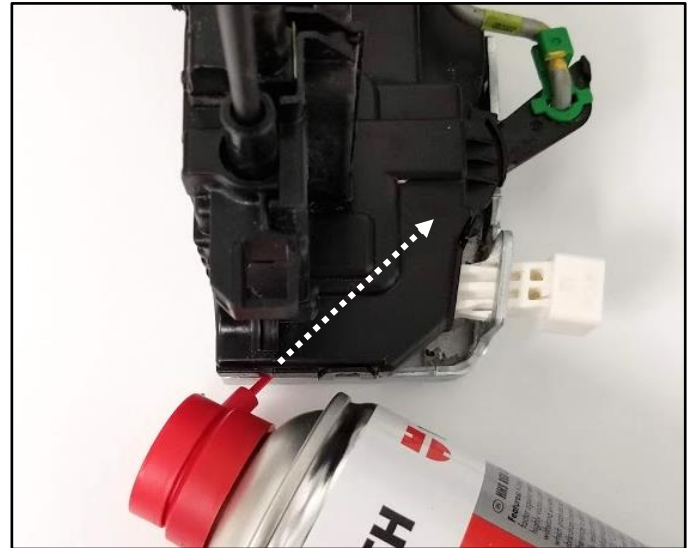

NOTICE

Cutaway view for reference only. Do not disassemble door latch assembly.

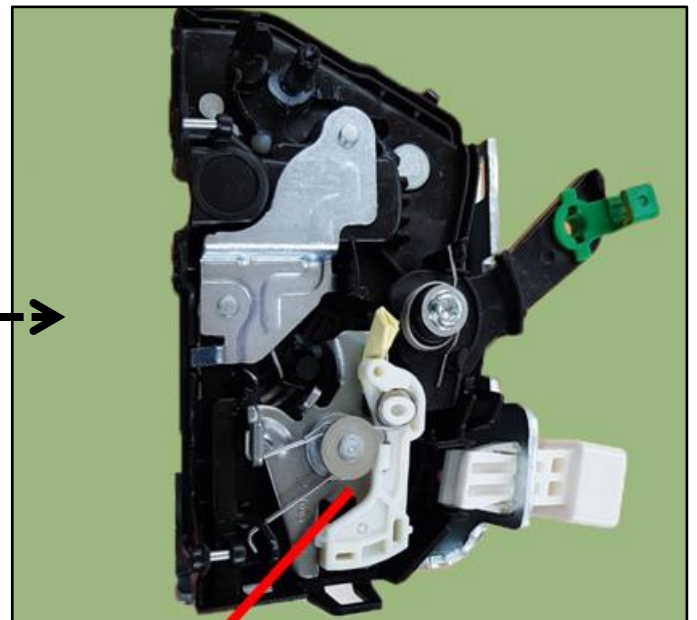

4. Reinstall all removed parts in reverse order of removal.

Confirm proper door handle operation.