

SportDesign Package (Step 2)

Information: **Retrofitting**

Model Year: **As of 2018**

Additional step: **Can be installed only for vehicles from week 14/18**

Roof spoiler for Cayenne Coupé not available

Note:



The SportDesign package comprises an independent SportDesign front apron painted in exterior color, an independent SportDesign rear apron and sculpted wheel arch extensions painted in exterior color. Including side skirts painted in exterior color.

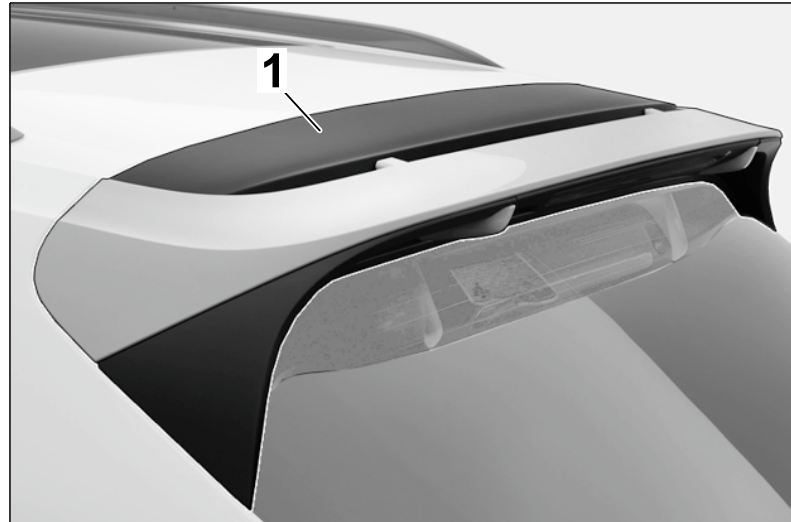

Figure 1

A painted roof spoiler can be ordered as an optional extra. Roof spoiler for Cayenne Coupé not available
The relevant legal regulations must be observed in the various countries.

The Porsche logo and part numbers are only visible when parts are removed.

Parts list:



Information

The scope of parts can vary in the different complete packages and can therefore differ from the lists of parts shown here. Dispose of parts that are not needed.

Package Order No.		Vehicle version
9Y0.044.850.A	1 x	SportDesign package, RoW
9Y0.044.860.A	1 x	SportDesign package, RoW + PLA Porsche Steering Assist (7X5)
9Y0.044.861.A	1 x	SportDesign package, USA
9Y0.044.862.A	1 x	SportDesign package, USA + PLA Porsche Steering Assist (7X5)

A painted roof spoiler ⇒ *Figure 1-1*- can be ordered as an optional extra. Roof spoiler for Cayenne Coupé not available

Roof spoiler		Optional
958.044.801.23	1 x	Roof spoiler, prime-coated

Important: The following parts **must** also be ordered, depending on **country** and **vehicle variant**.

Night vision system holder		Vehicle version	
9Y0.980.562	1 x	With Night vision system	
Supplementary set		Vehicle version	
9Y0.044.858.B	1 x	With ACC	
9Y0.044.858.A	1 x	Without ACC	
Number plate holder ⇒ Figure 2-17-		Country version	
9Y0.807.287.K	1 x	Number plate holder, ECE	
9Y0.807.287.L	1 x	Number plate holder, NAR	
9Y0.807.287.M	1 x	Number plate holder, China	
9Y0.807.287.N	1 x	Number plate holder, Japan	
9Y0.807.287.P	1 x	Number plate holder, RoW	
9Y0.807.287.S	1 x	Number plate holder, China - PHEV	
Scope of air guides ⇒ Figure 6-1 and 2-		Engine variant	
9Y0.117.335.D	1 x	Front left air guide for charge-air cooler	V6 petrol engine LK3 TV8
9Y0.117.336.D	1 x	Front right air guide for charge-air cooler	
9Y0.117.335.E	1 x	Front left air guide for charge-air cooler	V8 petrol engine T1M
9Y0.117.336.E	1 x	Front right air guide for charge-air cooler	
9Y0.117.335.F	1 x	Front left air guide for charge-air cooler	R4 petrol engine TW6, V6 petrol engine LK2 T9I
9Y0.117.336.F	1 x	Front right air guide for charge-air cooler	
Scope of sound absorber for bumper ⇒ Figure 6-3-		Country version	
9Y0.807.550.B	1 x	Sound absorber on bumper	For RoW
9Y0.807.550.E	1 x	Sound absorber on bumper	For NAR
9Y0.807.550.K	1 x	Sound absorber on bumper	For Korea

Important: The following parts are **included** in the package and do **not** have to be ordered. **The following parts lists are provided for overview purposes only! Part numbers can vary depending on country and package.**

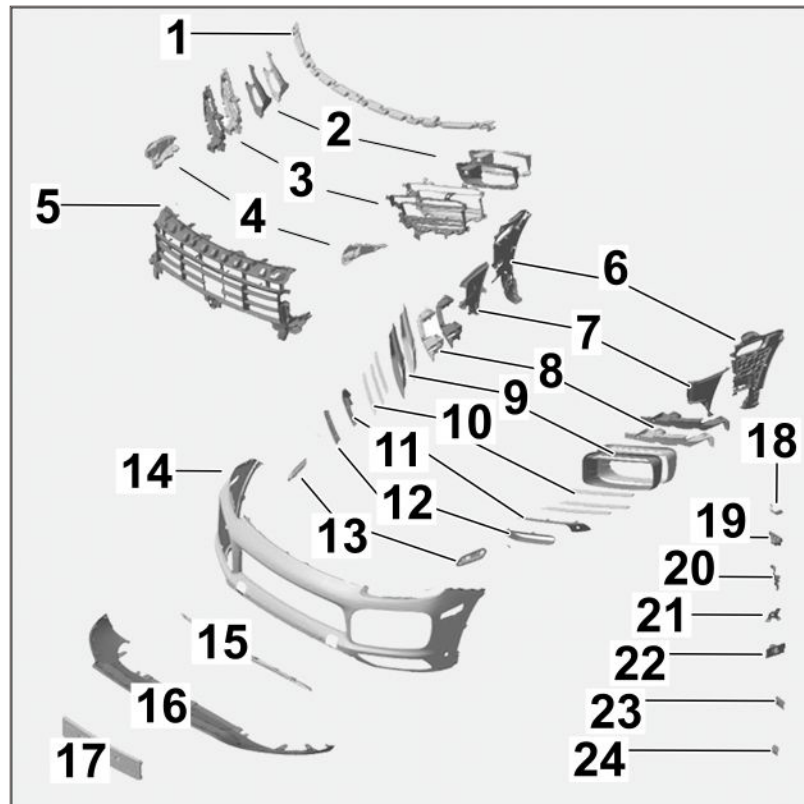

Figure 2

Scope of front apron

9Y0.807.665.D	1 x	Foam part, SDP ⇒ Figure 2-1-
9Y0.807.161.D/162.D	2 x	Side air guides, left and right, basic ⇒ Figure 2-2-
9Y0.807.161.E	1 x	Side air guides, left, basic Nivi ⇒ Figure 2-2-
9Y0.807.161.F/162.F	2 x	Side air guides, left and right, TOP ⇒ Figure 2-2-
9Y0.807.161.G/162.G	2 x	Side air guides, left and right, TOP Nivi ⇒ Figure 2-2-
9Y0.807.681.C/682.C	2 x	Side grille, left and right, SDP, basic ⇒ Figure 2-3-
9Y0.807.681.D/682.D	2 x	Side grille, left and right, SDP, TOP ⇒ Figure 2-3-
9Y0.807.049.B/050.B	2 x	Side guide section, left and right, carry-over part ⇒ Figure 2-4-
9Y0.807.683.M	1 x	center grille, SDP (included in air guide package) ⇒ Figure 2-5-
9Y0.807.683.N	1 x	center grille, SDP, ACC (included in air guide package) ⇒ Figure 2-5-
9Y0.807.177.B/178.B	2 x	Side guides, left and right ⇒ Figure 2-6-
9Y0.807.957.B/958.B	2 x	Side cooling-air guide, left and right ⇒ Figure 2-7-
9Y0.807.571.B/572.B	2 x	Lower guide element, left and right, carry-over part ⇒ Figure 2-8-
9Y0.807.795.B/796.B	2 x	Front cover, left and right, SDP ⇒ Figure 2-9-
9Y0.807.795.A/796.A	2 x	Front cover, left and right, SDP, TOP ⇒ Figure 2-9-

9Y0.807.685.C/686.C	2 x	Upper vane, left and right ⇒ <i>Figure 2-10-</i>
9Y0.807.877.C/878.C	2 x	center vane, left and right ⇒ <i>Figure 2-10-</i>
9Y0.807.973.C/974.C	2 x	Lower vane, left and right ⇒ <i>Figure 2-10-</i>
9Y0.807.823/824	2 x	Lower trim, left and right, SDP ⇒ <i>Figure 2-11-</i>
9Y0.807.675.B/676.B	2 x	Side grille, left and right, bottom ⇒ <i>Figure 2-12-</i>
9Y0.807.677.A/678.A	2 x	Position light holder, USA, SDP, basic and TOP ⇒ <i>Figure 2-13-</i>
9Y0.807.221.B	1 x	Front apron, ready-primed ⇒ <i>Figure 2-14-</i>
9Y0.807.684	1 x	center grille, lower, carry-over part ⇒ <i>Figure 2-15-</i>
9Y0.807.061.D	1 x	Front spoiler for bumper ⇒ <i>Figure 2-16-</i>
9Y0.807.644.A	1 x	RTV cover, TOP/basic ⇒ <i>Figure 2-18-</i>
9Y0.807.997.B	1 x	RTV holder, SDP ⇒ <i>Figure 2-19-</i>
9Y0.807.129.B/130.B	2 x	PDC holder, left and right, outer (already installed and bonded) ⇒ <i>Figure 2-21 and 22-</i>
9Y0.807.115.B/116.B	2 x	PLA holder, outer ⇒ <i>Figure 2-22-</i>
9Y0.807.295.B/296.B	2 x	Adhesive tape for PLA, SDP ⇒ <i>Figure 2-23-</i>
9Y0.807.155.B/156.B	2 x	Towing lug cover, left and right, ready-primed ⇒ <i>Figure 2-24-</i>

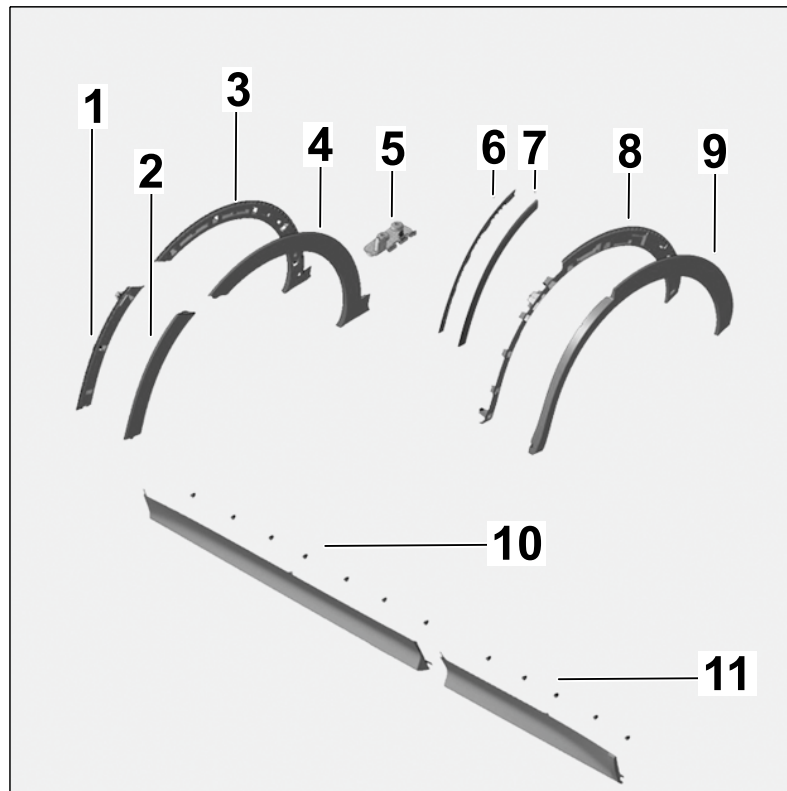

Figure 3

Items ⇒ *Figure 3-1, 3 and 8-* are supplied installed on the wheel covers. Item ⇒ *Figure 3-5-* is installed on the vehicle and must not be replaced.

Scope of wheel arch trims/door trim panels

9Y0 853 717 D G2X	1 x	Wheel cover, front left ⇒ <i>Figure 3-2-</i>
9Y0 853 718 D G2X	1 x	Wheel cover, front right ⇒ <i>Figure 3-2-</i>
9Y0 853 731 D G2X	1 x	Wheel cover, front, rear left ⇒ <i>Figure 3-4-</i>
9Y0 853 732 D G2X	1 x	Wheel cover, front, rear right ⇒ <i>Figure 3-4-</i>
9Y0 854 827 G2X	1 x	Wheel cover at door, rear left ⇒ <i>Figure 3-7-</i>
9Y0 854 828 G2X	1 x	Wheel cover at door, rear right ⇒ <i>Figure 3-7-</i>
9Y0 853 817 G2X	1 x	Wheel cover, rear left ⇒ <i>Figure 3-9-</i>
9Y0 853 818 G2X	1 x	Wheel cover, rear right ⇒ <i>Figure 3-9-</i>
9Y0.837.095.B	1 x	Door trim panel, front left ⇒ <i>Figure 3-10-</i>
9Y0.839.095.B	1 x	Door trim panel, rear left ⇒ <i>Figure 3-11-</i>
9Y0.837.096.B	1 x	Door trim panel, front right ⇒ <i>Figure 3-10-</i>
9Y0.839.096.B	1 x	Door trim panel, rear right ⇒ <i>Figure 3-11-</i>
9Y0.853.717.D	2 x	Front bracket, left and right ⇒ <i>Figure 3-1-</i>
9Y0.853.718.D		
9Y0.853.817.	2 x	Front bracket, rear left and right ⇒ <i>Figure 3-3-</i>
9Y0.853.818.		
9Y0.854.731.D	2 x	Rear bracket, left and right ⇒ <i>Figure 3-8-</i>
9Y0.854.732.D		

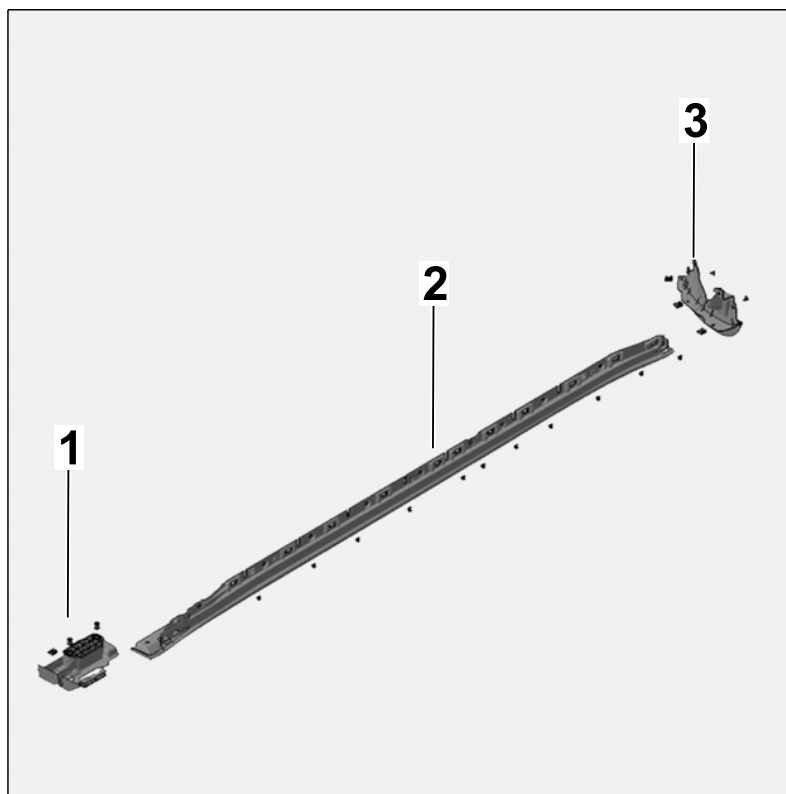

Figure 4

Scope of door entry guards

9Y0.802.845.A	2 x	Support, left and right (not included in set, not required) ⇒ <i>Figure 4-1-</i>
9Y0.802.846.A		
9Y0.853.751.C	2 x	Door entry guard, left and right, ready-primed ⇒ <i>Figure 4-2-</i>
9Y0.853.752.C		
9Y0.854.871.A	2 x	Wheel spoiler, rear left and right (not included in set, not required)
9Y0.854.872.A		⇒ <i>Figure 4-3-</i>



Information

Carry-over parts listed in the parts list are parts that are removed from the installed rear apron and installed on the new SDP spoiler/rear skirt and are not included in the scope of delivery.

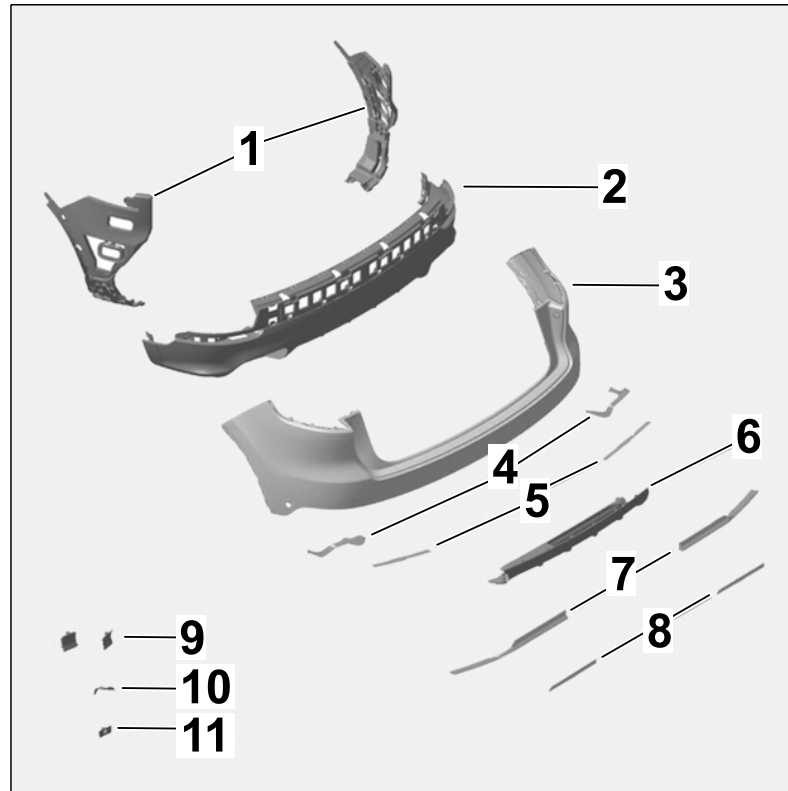

Figure 5

Scope of rear apron

9Y0.807.378.A	1 x	Guides for rear apron, left ⇒ Figure 5-1-
9Y0.807.378.A	1 x	Guide for rear apron, right ⇒ Figure 5-1-
9Y0.807.110.B	1 x	Spoiler for rear apron/rear skirt ⇒ Figure 5-2-
9Y0.807.421	1 x	Rear apron, carry-over part ⇒ Figure 5-3-
9Y0.807.837	1 x	Exhaust system cover, left, carry-over part ⇒ Figure 5-4-
9Y0.807.838	1 x	Exhaust system cover, right, carry-over part ⇒ Figure 5-4-
9Y0.807.983	1 x	Rear cover, bottom, RoW, carry-over part ⇒ Figure 5-5-
9Y0.807.984.B	1 x	Rear cover, bottom right, USA, carry-over part ⇒ Figure 5-5-
9Y0.807.983.B	1 x	Rear cover, bottom left, USA, carry-over part ⇒ Figure 5-5-
9Y0.807.834.C	1 x	Rear panel, closed ⇒ Figure 5-6-
9Y0.807.834.D	1 x	Rear panel, trailer hitch, RoW and USA, open ⇒ Figure 5-6-
9Y0.807.697	1 x	Grille on cover, RoW, carry-over part ⇒ Figure 5-7-
9Y0.807.925	1 x	Grille on cover, USA, left, carry-over part ⇒ Figure 5-8-
9Y0.807.926	1 x	Grille on cover, USA, right, carry-over part ⇒ Figure 5-8-
9Y0.807.499.B/500.B	2 x	Towing lug cover, carry-over part ⇒ Figure 5-9-
9Y0.807.139/140	2 x	PLA holder, carry-over part ⇒ Figure 5-10-

9Y0.807.595.A/596.A	2 x	PDC holder, pre-installed on rear apron ⇒ <i>Figure 5-11-</i>
9Y0.807.591.A/592.A	2 x	PDC holder, pre-installed on rear apron ⇒ <i>Figure 5-11-</i>

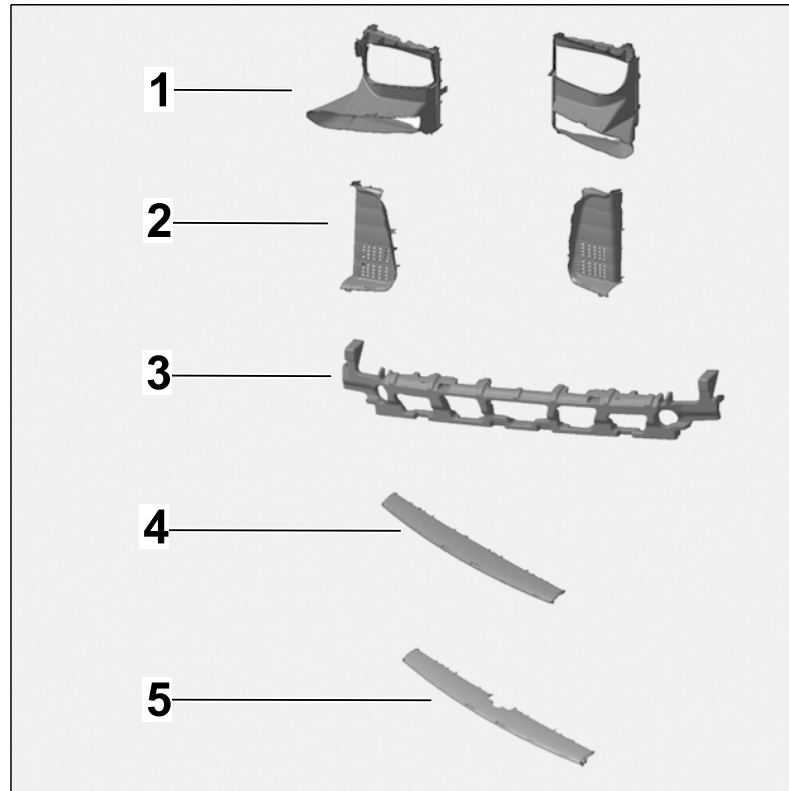

Figure 6

Scope of air guides ⇒ Figure 6-1 and 2-

		Engine variant	
9Y0.117.335.D	1 x	Front left air guide for charge-air cooler	V6 petrol engine LK3 TV8
9Y0.117.336.D	1 x	Front right air guide for charge-air cooler	
9Y0.117.335.E	1 x	Front left air guide for charge-air cooler	V8 petrol engine T1M
9Y0.117.336.E	1 x	Front right air guide for charge-air cooler	
9Y0.117.335.F	1 x	Front left air guide for charge-air cooler	R4 petrol engine TW6, V6 petrol engine LK2 T9I
9Y0.117.336.F	1 x	Front right air guide for charge-air cooler	

Scope of sound absorber for bumper ⇒ Figure 6-3-

		Country version	
9Y0.807.550.B	1 x	Sound absorber on bumper	For RoW

9Y0.807.550.E	1 x	Sound absorber on bumper	For NAR
9Y0.807.550.K	1 x	Sound absorber on bumper	For Korea

Scope of center air guides			Equipment variant
9Y0.121.710.B	1 x	center air guide ⇒ <i>Figure 6-5-</i>	Without ACC
9Y0.121.710.E	1 x	center air guide ⇒ <i>Figure 6-5-</i>	With ACC
9Y0.807.683.M	1 x	center grille, SDP ⇒ <i>Figure 2-4-</i>	Without ACC
9Y0.807.683.N	1 x	center grille, SDP, ACC ⇒ <i>Figure 2-4-</i>	With ACC

Work
Procedure:



Information

Some of the repair illustrations show only one side of the vehicle. Naturally, some steps also have to be performed on the opposite side of the vehicle as well. These must be carried out as a mirror image of the steps shown.



Information

The number of electric plug connections and clips will vary depending on equipment.



CAUTION

Painting components

- Risk of warping of components
 - Risk of damage to components
- ⇒ Observe the guidelines and instructions for painting components in the "Paint" Workshop Manual.
- ⇒ Always place parts without tension on the painting devices provided during painting and drying processes.

NOTICE

Voltage drop

- Risk of irreparable damage to control unit
 - Risk of damage to control unit
 - Fault entries in the control unit
 - Coding in the control unit is aborted
 - Malfunctions in control unit, even during programming
- ⇒ Before disconnecting the control unit, switch off ignition and remove ignition key.

- ⇒ **Make sure that the power supply is not interrupted during programming.**
- ⇒ **Connect battery charger/power supply - Suitable for AGM Type batteries, recommended current rating of 90A fixed voltage 13.5V to 14.5V.**

- 1 Raise the vehicle. ⇒ *Workshop Manual 'Lifting the vehicle'*
- 2 Connect battery charger. ⇒ *Workshop Manual 'Charging vehicle electrical system battery'*

3 **Paint work/Installing front apron**

Paint all ready-primed parts to match the vehicle's color code in accordance with instructions in the Paint Workshop Manual. Paint the following parts in vehicle color:

Front apron, front spoiler on bumper, towing lug covers, outer PLA holder (if Porsche Steering Assist (PLA) is installed)

- 3.1 Disassemble and assemble front apron .
 - 3.1.1 Replace front apron ⇒ *Workshop Manual 'Replacing front apron (basic)'*. After removing the standard front apron, replace air guides for radiator, charge-air cooler and sound absorber on bumper (see 3.1.2 and 3.1.3).
 - 3.1.2 Replace air guide for radiator with the supplied radiator guides ⇒ *Workshop Manual 'Removing and installing front air guide'*. Also replace sound absorber on bumper with the supplied new sound absorber ⇒ *Figure 6 -3-* and side air guides ⇒ *Figure 6 -2-*.
 - 3.1.3 Replace air guides for charge-air cooler with the supplied air guides ⇒ *Workshop Manual 'Removing and installing front air guide at the side (ahead of charge-air cooler)'*.

4 **Paint work/Installing wheel covers and door trim panels**

Paint all ready-primed parts to match the vehicle's color code in accordance with instructions in the Paint Workshop Manual. Paint the following parts in vehicle color:

Door trim panels, wheel covers, door covers

- 4.1 Remove and install door trim panels and wheel arch trims ⇒ *Figure 4* .
 - 4.1.1 Replace door trim panels at the front ⇒ *Workshop Manual 'Removing and installing trim for front door'* and rear ⇒ *Workshop Manual 'Removing and installing trim for rear door'*.
 - 4.1.2 Replace wheel covers at the front ⇒ *Workshop Manual 'Removing and installing front wheel cover'* and rear ⇒ *Workshop Manual 'Removing and installing rear wheel cover'*.

- 4.1.3 Install extended wheel arch trims ⇒ *Figure 7* at the rear left and right doors.
- 4.1.4 Carefully clean the bonding surface on the left and right doors and remove all grease using a suitable cleaner.
- 4.1.5 Remove protective film from the bonding surface on the wheel cover ⇒ *Figure 7*.
- 4.1.6 Install wheel cover at the door so that it is flush and looks right ⇒ *Figure 7*.

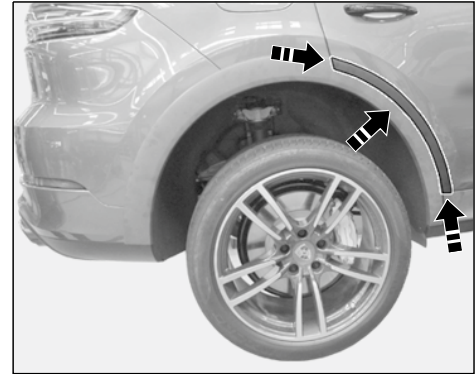

Figure 7

5 Paint work/Installing door entry guards

Paint all ready-primed parts to match the vehicle's color code in accordance with instructions in the Paint Workshop Manual. Paint the following parts in vehicle color:

Door entry guards

- 5.1 Remove and install door entry guards ⇒ *Figure 4-2-*.
 - 5.1.1 Replace door entry guards ⇒ *Workshop Manual 'Removing and installing door entry guard'*.

6 Paint work/Installing rear apron

Paint all ready-primed parts to match the vehicle's color code in accordance with instructions in the Paint Workshop Manual. Paint the following parts in vehicle color:

PDC spoiler/rear skirt

- 6.1 Remove and install PDC spoiler ⇒ *Figure 5-2-* and rear panel ⇒ *Figure 5-6-*.
 - 6.1.1 Remove and install rear apron ⇒ *Workshop Manual 'Removing and installing rear apron'*.
 - 6.1.2 Replace side guides ⇒ *Figure 5-1-*. Carry out this step in conjunction with Step 6.1.3.
 - 6.1.3 Remove and install PDC spoiler/rear skirt ⇒ *Workshop Manual 'Removing and installing rear skirt'*.
 - 6.1.4 Remove and install rear panel ⇒ *Workshop Manual 'Removing and installing rear panel'*. For vehicles with trailer hitch, RoW and USA (I-no. 1D3, 1D7, 1D8, 1D9): Install "open" panel.
 - 6.1.5 For vehicles with Lane Change Assist (I-no. 7Y1, 7Y2, 7Y3, 7Y4), continue with Step 6.1.4.

6.1.6 Calibrate Lane Change Assist ⇒ *Workshop Manual 'Calibrating Lane Change Assist'*.

7 Paint work/roof spoiler assembly. Roof spoiler for Cayenne Coupé not available

Paint all ready-primed parts to match the vehicle's color code in accordance with instructions in the Paint Workshop Manual. Paint the following parts in vehicle color:

Roof spoiler, roof spoiler brackets at the left and right

7.1 Disassemble and assemble roof spoiler.

7.1.1 Remove and install roof spoiler ⇒ *Workshop Manual 'Removing and installing rear spoiler'*.

7.1.2 Disassemble and assemble roof spoiler ⇒ *Workshop Manual 'Replacing rear spoiler'*. Install double-sided adhesive strips at the required positions. **Tightening torque for screws securing fender mounting to roof section (8x): 7.5 Nm (5.5 ftlb.)**.

8 Code SportDesign package.

8.1 **9900 - PIWIS Tester 3** must be connected and ignition switched on.

8.2 Select "Diagnostics". **9900 - PIWIS Tester 3** detects the model line. **Press Next**. PIWIS Tester III Diagnostics starts.

8.3 Update vehicle data.

8.3.1 **Additional menu** must be selected by pressing •F7" . Press •F11" to confirm the question "Create vehicle analysis log (VAL)?".

8.3.2 Select the **Maintenance of vehicle data** function. Press •F12" until PR numbers appears in the Value group column.

8.3.3 Select **Trim CD value** in the Family column. When you touch the cell behind Trim CD value, the drop-down menu opens.

Select the value **2D1 - Sport Design package**.

Press •F12" to change values.

8.3.4 The selected values appear. Press •F8" to write values. Wait until the following message appears: **Generation of vehicle data is complete**. **Press**

Press •F11" to switch to the control unit overview.

8.4 Adapt coding.

8.4.1 Select all control units by pressing •Ctrl A" . Press •F12" to continue.

8.4.2 Switch to the **Coding/programming** menu. Press •F12" to continue.

Select **Automatic coding** mode. Press •F12" to continue.

8.4.3 Wait until the following message appears: **Coding was completed successfully.**
Press **•F12** to continue.

Press **•F12** to return to the **Overview** menu.

8.5 Switch off ignition and disconnect **9900 - PIWIS Tester 3**.

8.6 Disconnect battery charger.

66992320:	Installing SportDesign package, complete Includes: Replacing front apron, replacing rear apron. Replacing door entry guards, replacing door trim panels, replacing wheel arch trims. Replacing air guides, replacing sound absorber on bumper. Without: Calibrating Lane Change Assist.	Labor time: 742 TU
66585500:	Replacing roof spoiler Includes: Removing and installing roof spoiler, disassembling and assembling roof spoiler	Labor time: 76 TU
66586161:	Painting new roof spoiler Includes: Roof spoiler and brackets Preparing body for painting	Labor time: 70 TU
66996173:	Painting new parts in SportDesign package, complete Includes: Painting new parts, Step 1: Front apron, towing lug cover, front spoiler on bumper, PLA holder, rear apron, towing lug, PDC spoiler, PLA holder, door entry guards, wheel covers, wheel covers at doors, wheel arch trims, door trim panels Preparing body for painting	Labor time: 560 TU

Important Notice: Technical Bulletins issued by Porsche Cars North America, Inc. are intended only for use by professional automotive technicians who have attended Porsche service training courses. They are written to inform those technicians of conditions that may occur on some Porsche vehicles, or to provide information that could assist in the proper servicing of a vehicle. Porsche special tools may be necessary in order to perform certain operations identified in these bulletins. Use of tools and procedures other than those Porsche recommends in these bulletins may be detrimental to the safe operation of your vehicle, and may endanger the people working on it. Properly trained Porsche technicians have the equipment, tools, safety instructions, and know-how to do the job properly and safely. Part numbers listed in these bulletins are for reference only. The work procedures updated electronically in the Porsche PIWIS diagnostic and testing device take precedence and, in the event of a discrepancy, the work procedures in the PIWIS Tester are the ones that must be followed.

© 2020 Porsche Cars North America, Inc.