



GROUP
ELE

MODEL
2010MY~
See table below

NUMBER
148

DATE
January 2020

TECHNICAL SERVICE BULLETIN

SUBJECT: HALOGEN HEAD LAMP
LOW BEAM BULB CONNECTOR REPLACEMENT

This bulletin provides information regarding the procedure to repair the bulb connector on some 2010MY~ vehicles listed on the table below, which may exhibit a bulb connector concern. To correct this concern, replace the connector with a new and improved part.

| Application Table | |
|-------------------|------------|
| Model | Model Code |
| Cadenza | VG, YG |
| Forte | TD, YD |
| Niro | DE |
| Optima | TF, JF |
| Optima Hybrid | TF/JF HEV |
| Rio | UB |
| Sedona | VQ, YP |
| Soul | AM, PS |
| Soul EV | PS EV |
| Sportage | SL, QL |
| Stinger | CK |

File Under: <Electrical>

Circulate To: General Manager Service Manager Parts Manager
 Service Advisors Technicians Body Shop Manager Fleet Repair

HALOGEN HEAD LAMP LOW BEAM BULB CONNECTOR REPLACEMENT

Repair Procedure:

1. Removal of the head lamp assembly may be required on some models for access. Remove the headlamp assembly by referring to the “Body electrical System → Lighting System → Head Lamps → Repair procedures” chapter in the applicable Shop Manual on KGIS.

2. Remove the dust cap (A) from the headlamp assembly.



3. Disconnect the head lamp bulb connector (C) and remove the headlamp light bulb (D) from the connector.

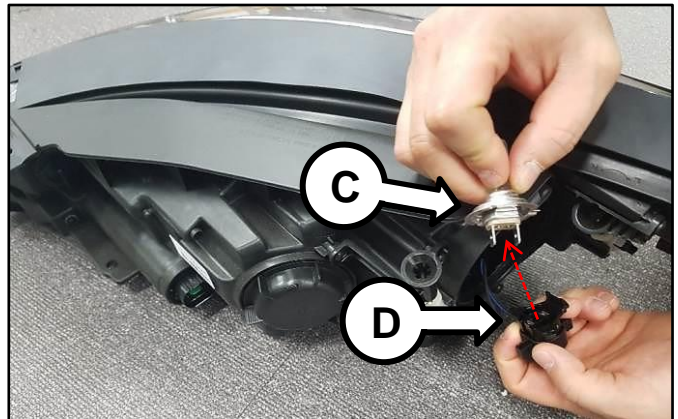

4. Using a set of wire cutters, cut the two (2) headlamp bulb connector wires as close to the connector (D) possible. Discard the bulb connector (D).

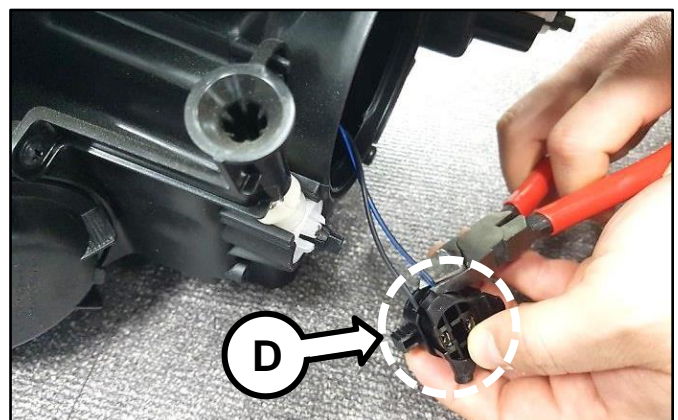

SUBJECT:

HALOGEN HEAD LAMP LOW BEAM BULB CONNECTOR REPLACEMENT

5. Using a set of wire strippers, strip the wire insulation approximately 10mm from the two (2) wire ends as shown.

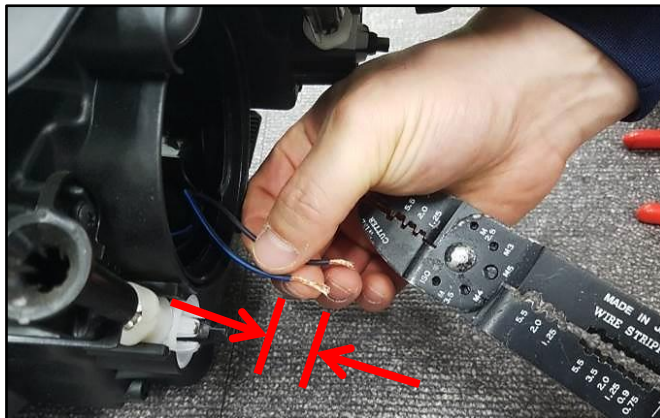

6. Insert the stripped headlamp wire end (F) into the butt connector (E). Crimp the connector to the headlamp wire. Repeat for the other wire.

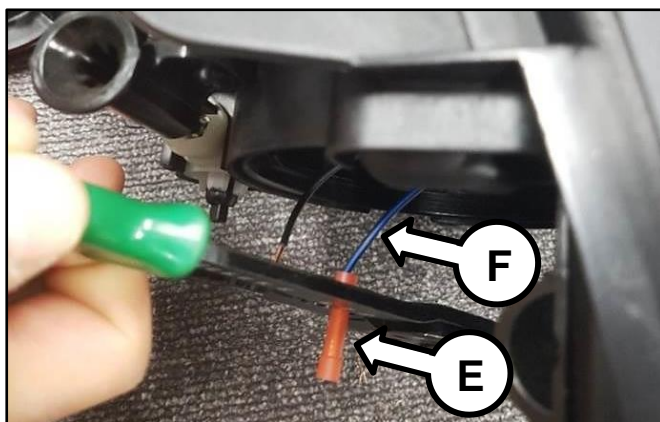

7. Insert the new connector wire (G) through the shrink sleeve (H) before inserting the connector wire end into the headlamp butt connector (E).

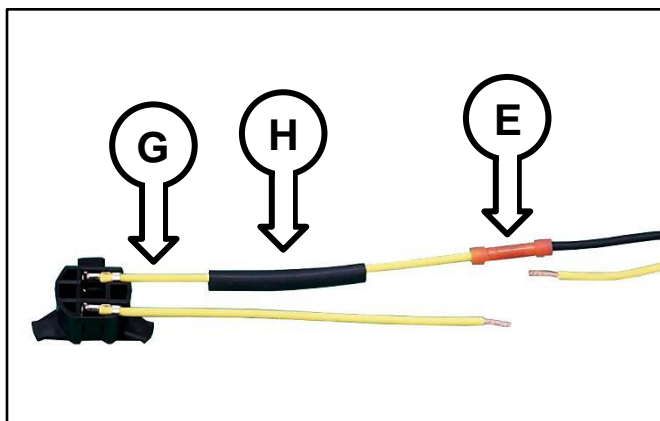

8. Crimp the new connector wire end to the head lamp butt connector as shown. Repeat steps 7 and 8 for the other wire.



* NOTICE

Lightly pull on the wires away from the connector to ensure a proper connection was made.

SUBJECT:

HALOGEN HEAD LAMP LOW BEAM BULB CONNECTOR REPLACEMENT

9. Ensure that the heat shrink sleeve (H) is completely covering the butt connector. Apply heat to the shrink sleeves with a heat gun (I) to adhere the shrink sleeves onto the two (2) wire/butt connectors.

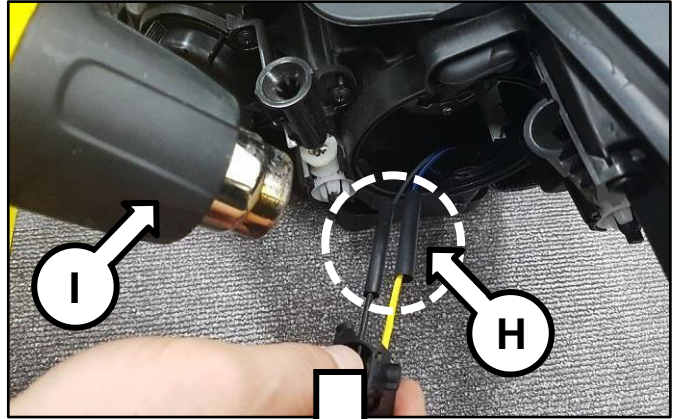

10. The completed repaired wires with new butt connector should look as shown.



11. Insert the removed headlamp bulb back into the new connector.

*** NOTICE**

Replace the headlamp bulb if it is burned or was damaged during removal.



12. Reinstall any removed parts in the reverse order of removal.

SUBJECT:

HALOGEN HEAD LAMP LOW BEAM BULB CONNECTOR REPLACEMENT

AFFECTED VEHICLE RANGE:

| Model | Production Date Range |
|--------------------------|-----------------------|
| Refer to table on page 1 | 2010MY~ |

REQUIRED PART: PER HEADLAMP (LH OR RH)

| Model | Part Number | Figure |
|--|----------------|---|
| TF, TF HEV, JF, JF HEV PS EV, VG, YG | 92170 1U000FFF |  |
| QL DE CK | 92170 D9000FFF |  |
| AM UB (4-door) | 92170 2K000FFF |  |
| SL | 92170 3W000FFF |  |
| TD UB (5-door) | 92170 1M000FFF |  |
| YD | 92170 A7000FFF |  |
| VQ | 92170 4D000FFF |  |
| YP | 92170 A9000FFF |  |
| PS (with 4 bulb headlamp system) | 92170 B2000FFF |  |

Note: One or two of each headlamp connector may be required per vehicle. Wire connector and heat shrink tube is included with each headlamp connector when ordering.

SUBJECT:

HALOGEN HEAD LAMP LOW BEAM BULB CONNECTOR REPLACEMENT

WARRANTY INFORMATION:

N Code: A31 C Code: ZZ2

| Claim Type | Causal P/N | Model | Qty. | Repair Description | Labor Op Code | Op Time | Replacement P/N | Qty. |
|------------|--------------|---|------|---|---------------|---------|--|------|
| W | Refer to EPC | UN TD SL XM | | Remove one headlamp and repair one bulb connector. (LH <u>or</u> RH) | 92170F02 | 0.6 M/H | Refer to table on pages 5 <u>and</u> 6 | 1 |
| | | | | Remove both headlamp, repair both bulb connectors. (LH <u>and</u> RH) | 921703F03 | 0.8 M/H | | 2 |
| W | Refer to EPC | VQ | | Remove one headlamp and repair one bulb connector. (LH <u>or</u> RH) | 92170F04 | 0.7 M/H | Refer to table on pages 5 <u>and</u> 6 | 1 |
| | | | | Remove both headlamp, repair both bulb connectors. (LH <u>and</u> RH) | 92170F05 | 1.0 M/H | | 2 |
| W | Refer to EPC | AM RP YD | | Remove one headlamp and repair one bulb connector. (LH <u>or</u> RH) | 92170F06 | 0.9 M/H | Refer to table on pages 5 <u>and</u> 6 | 1 |
| | | | | Remove both headlamp, repair both bulb connectors. (LH <u>and</u> RH) | 92170F07 | 1.1 M/H | | 2 |
| W | Refer to EPC | TF HEV PS EV VG, YG TF, PS QL, DE | | Remove one headlamp and repair one bulb connector. (LH <u>or</u> RH) | 92170F08 | 1.0 M/H | Refer to table on pages 5 <u>and</u> 6 | 1 |
| | | | | Remove both headlamp, repair both bulb connectors. (LH <u>and</u> RH) | 92170F09 | 1.2 M/H | | 2 |
| W | Refer to EPC | JF,JF HEV, YP,CK | | Remove one headlamp and repair one bulb connector. (LH <u>or</u> RH) | 92170F10 | 1.1 M/H | Refer to table on pages 5 <u>and</u> 6 | 1 |
| | | | | Remove both headlamp, repair both bulb connectors. (LH <u>and</u> RH) | 92170F11 | 1.2 M/H | | 2 |
| W | Refer to EPC | UM | | Remove one headlamp and repair one bulb connector. (LH <u>or</u> RH) | 92170F12 | 1.0 M/H | Refer to table on pages 5 <u>and</u> 6 | 1 |
| | | | | Remove both headlamp, repair both bulb connectors. (LH <u>and</u> RH) | 92170F13 | 1.1 M/H | | 2 |
| W | Refer to EPC | UB | | Remove one headlamp and repair one bulb connector. (LH <u>or</u> RH) | 92170F14 | 0.7 M/H | Refer to table on pages 5 <u>and</u> 6 | 1 |
| | | | | Remove both headlamp, repair both bulb connectors. (LH <u>and</u> RH) | 92170F15 | 0.9 M/H | | 2 |