

LTB01230NAS2



TECHNICAL BULLETIN

20 DEC 2019

© Jaguar Land Rover North America, LLC

NOTE: The information in Technical Bulletins is intended for use by trained, professional Technicians with the knowledge, tools, and equipment required to do the job properly and safely. It informs these Technicians of conditions that may occur on some vehicles, or provides information that could assist in proper vehicle service. The procedures should not be performed by 'do-it-yourselfers'. If you are not a Retailer, do not assume that a condition described affects your vehicle. Contact an authorized Land Rover service facility to determine whether this bulletin applies to a specific vehicle.

INFORMATION

This reissue replaces all previous versions. Please destroy all previous versions.

This bulletin supersedes TSB LTB01230NAS1/2018 dated 10 DEC 2018, which should either be destroyed or clearly marked to show it is no longer valid (e.g. with a line across the page). Only refer to the electronic version of this Technical Bulletin in TOPIx.

Changes are highlighted in blue

SECTION:

501-10

SUBJECT/CONCERN:

Third Row Seat(s) Not Latching in the Upright Position

AFFECTED VEHICLE RANGE:

MODEL:

MODEL YEAR:

VIN:

APPLICABILITY:

MODEL:	MODEL YEAR:	VIN:	APPLICABILITY:
Discovery (LR)	2017-2018	000004-073436	Vehicles With: 7 Seats

MARKETS:

NORTH AMERICA

CONDITION SUMMARY:

SITUATION:

On vehicles with third row seating, the third row seats may not latch in the upright position.

CAUSE:

Debris in the latch, limiting operation.

ACTION:

Follow the instructions below.

PARTS:

PART NUMBER	DESCRIPTION	QUANTITY
LR123774	Latch assembly kit	1

WARRANTY:

NOTES:

- Repair procedures are under constant review, and therefore times are subject to change; those quoted here must be taken as guidance only. Use TOPIx to obtain the latest repair time.
- The JLR claims submission system requires the use of causal part numbers. Labor only claims must show the causal part number with a quantity of zero.

DESCRIPTION	SRO	TIME (HOURS)	CONDITION CODE	CAUSAL PART
Third row seat - Latch assembly kit - Install	78.85.89.76	0.6	42	LR123774

NOTE:

Normal Warranty procedures apply.

SERVICE INFORMATION:

1.

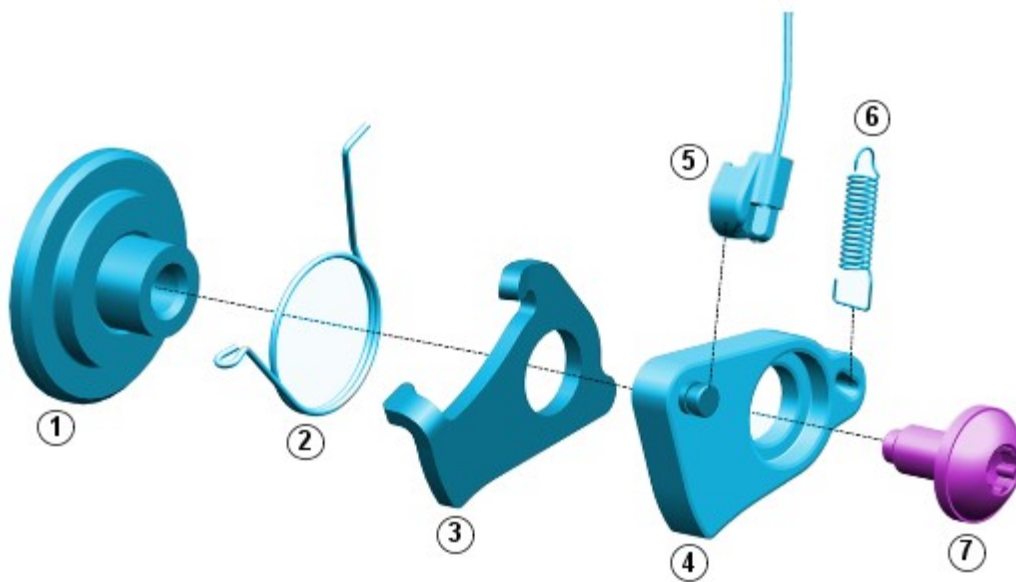

E231098

Component overview:

- **1.** Boss
- **2.** Free play spring
- **3.** Free play cam
- **4.** Crash lock
- **5.** Bowden cable
- **6.** Crash lock spring
- **7.** Fastener

SERVICE INSTRUCTION:

1.

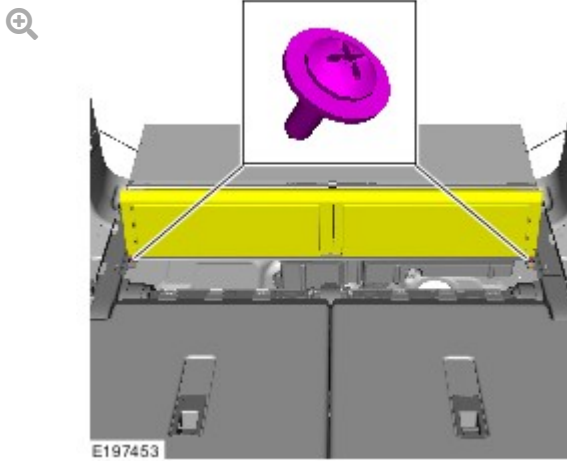

Remove the load space interior trim panel.

- ■ Torque: 2 Nm

2.

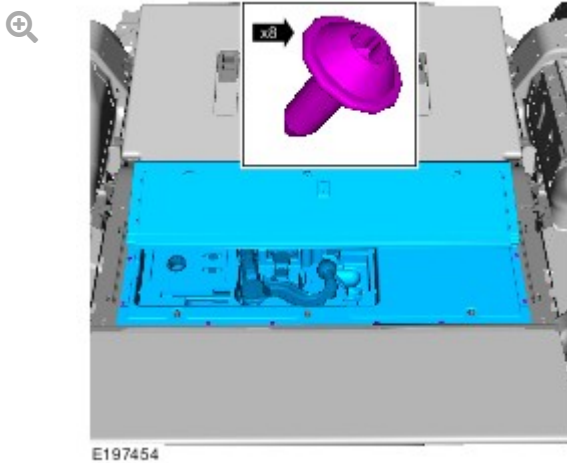

Remove the load space tool kit and housing.

- ■ Torque: 2 Nm

3.

NOTE:

For electric seats only: If the latch is in a failed state the seat will not latch into the upright position. To retain the seat in its upright position, deploy the seat and manually hold the seat back in the most upright position which will induce a none fail state and allow the seat to remain in this position.

Put the third row seats into the upright position.

4.

CAUTION:

When the seat base cushions have been removed, take care to protect the third row seat backrest trims when maneuvering the seat backrests.

Remove both seat base cushions (see TOPlx Workshop Manual section 501-10: Seating - Removal and Installation - Third Row Seat Cushion Cover - Steps 1 to 2 only).

5. Remove both third row seat backrest covers (see TOPlx Workshop Manual section 501-10: Seating - Removal and installation - Third Row Seat Backrest Cover - Steps 1 to 4 only).
-

6.

NOTE:

Do not attempt to fully remove the trim at this point.

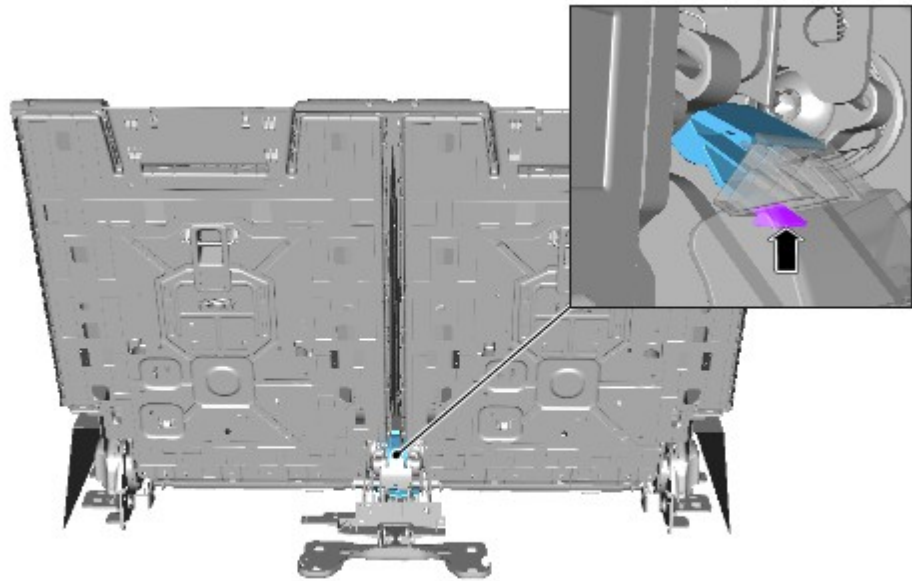

E231095

Release the trim tab only.

7.



E231599

Release both sides of the seatbelt trim cowl.

8.

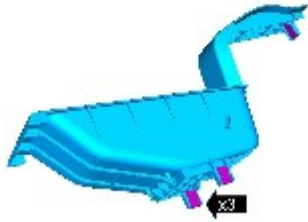
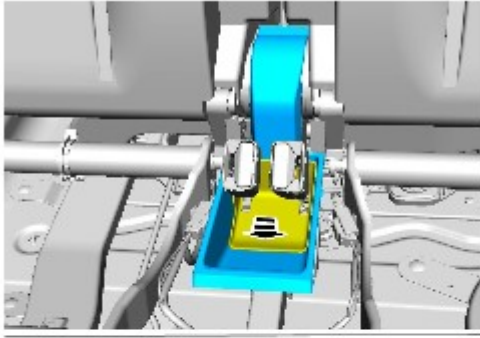

E156401

Remove the seatbelt trim.

NOTE:

Steps 9 to 28 should be completed on both seats.

9.

NOTE:

Do not fully remove.



E231598

Unclip the backrest seat trim for access only.

10.

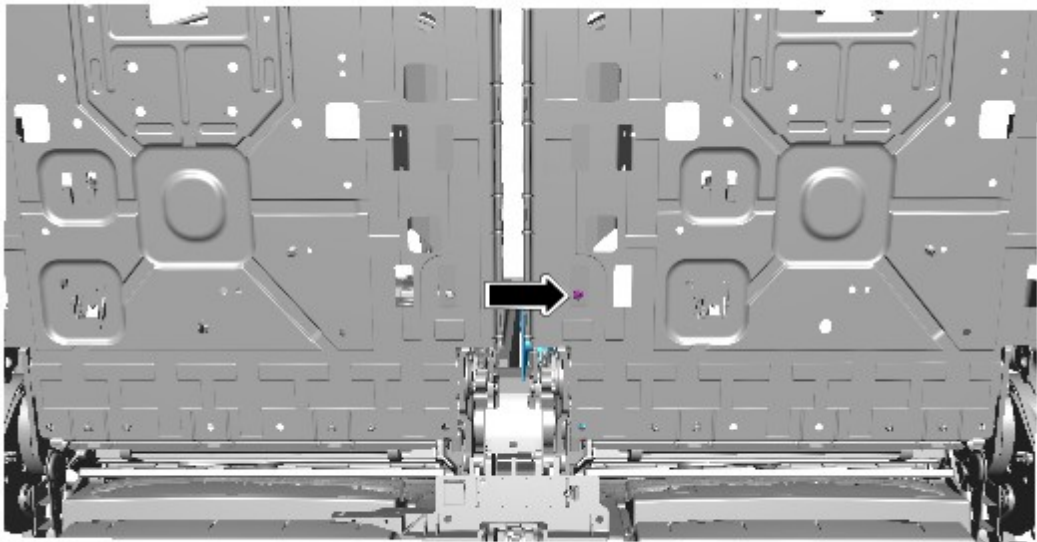

E231104

Remove the securing trim clip.

11.

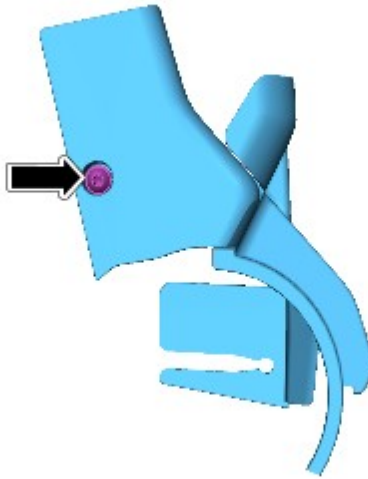

E231597

Remove the retaining screw and remove the trim.

12.

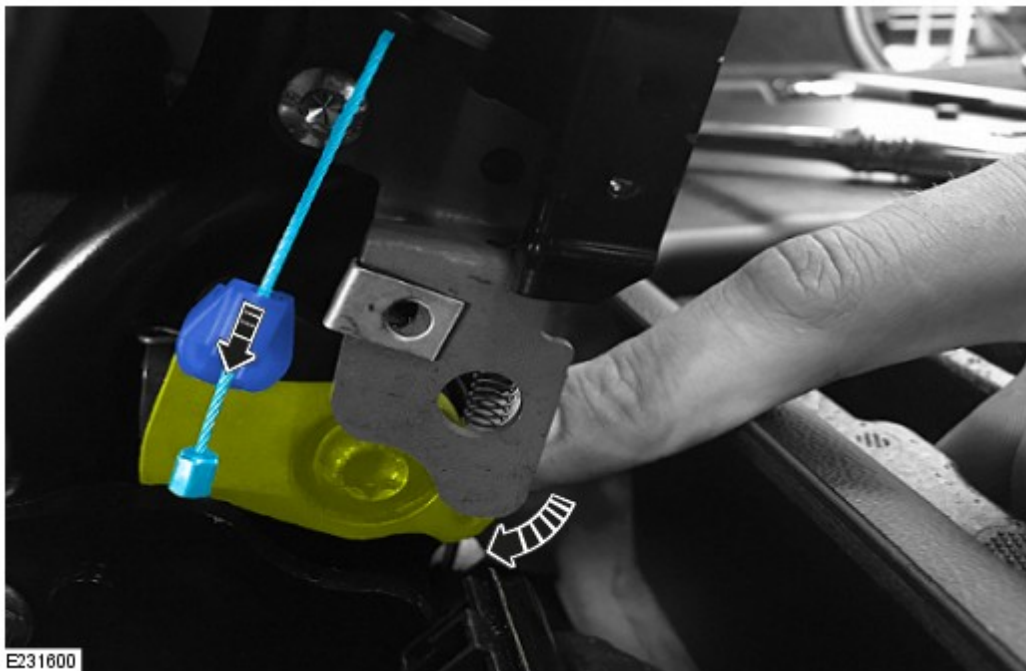

Rotate the crash lock cam and release the bowden cable.

13.

CAUTION:

Do not remove the bowden cable from the plastic fixing on the bracket.

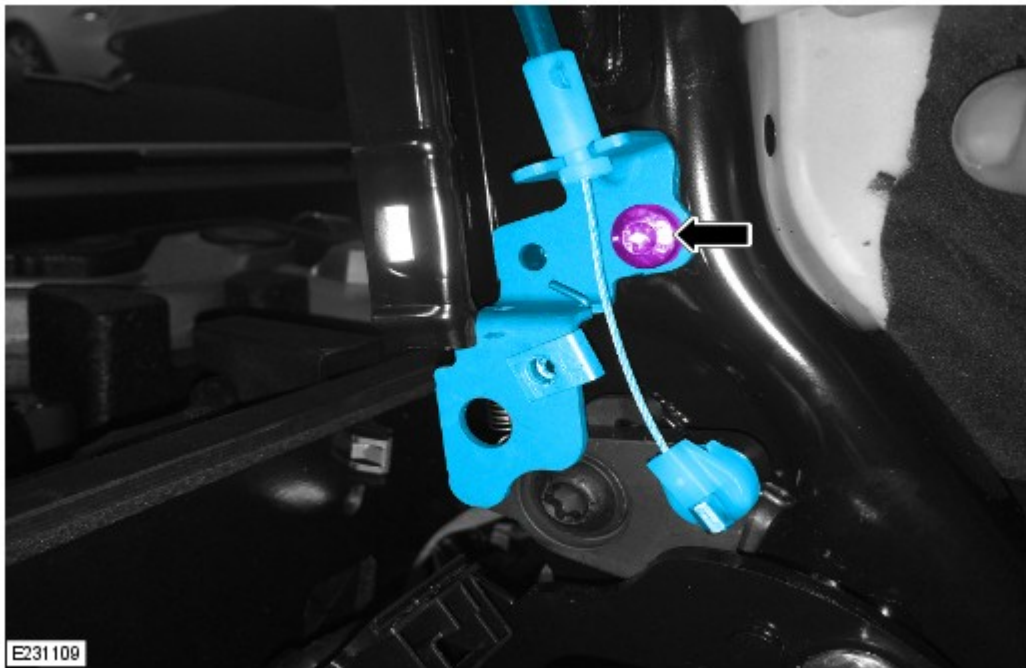

Remove the bowden cable bracket securing bolt.

14.

NOTE:

The bowden cable bracket is held under tension by the freeplay cam spring.



E231601

Compress the free play spring to allow movement of the bracket and position to allow access to the crash lock securing bolt.

15.

CAUTION:

You must identify the type of crash lock securing bolt used.

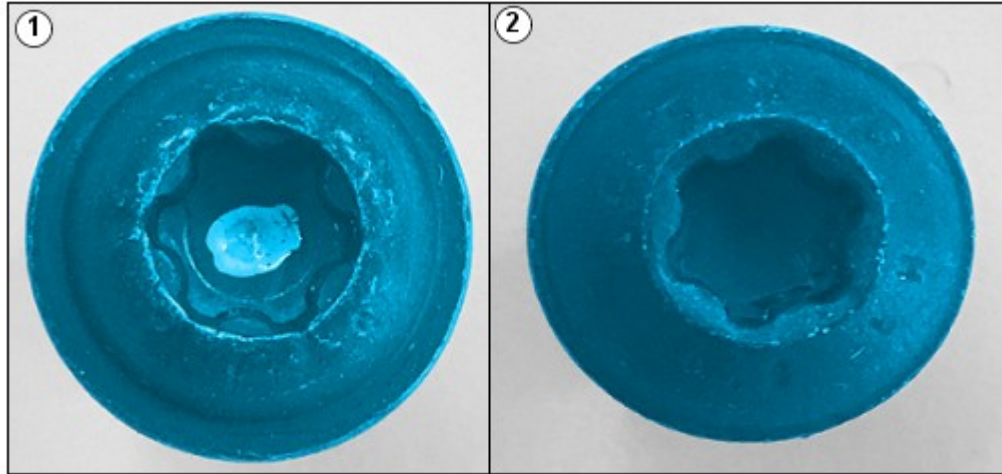

E231102

Identify the type of crash lock securing bolt used:

- **1.** Right hand thread - Large flat flange around the head of the bolt.
- **2.** Left hand thread - Small flange around the head of the bolt.

16.

NOTE:

Take note of the orientation of the components.

Remove and discard the crash lock.

17. Remove and discard the crash lock spring.

18.

NOTE:

Do not discard the free play cam.

Remove the free play cam.

19. Remove and discard the free play cam spring.

20.

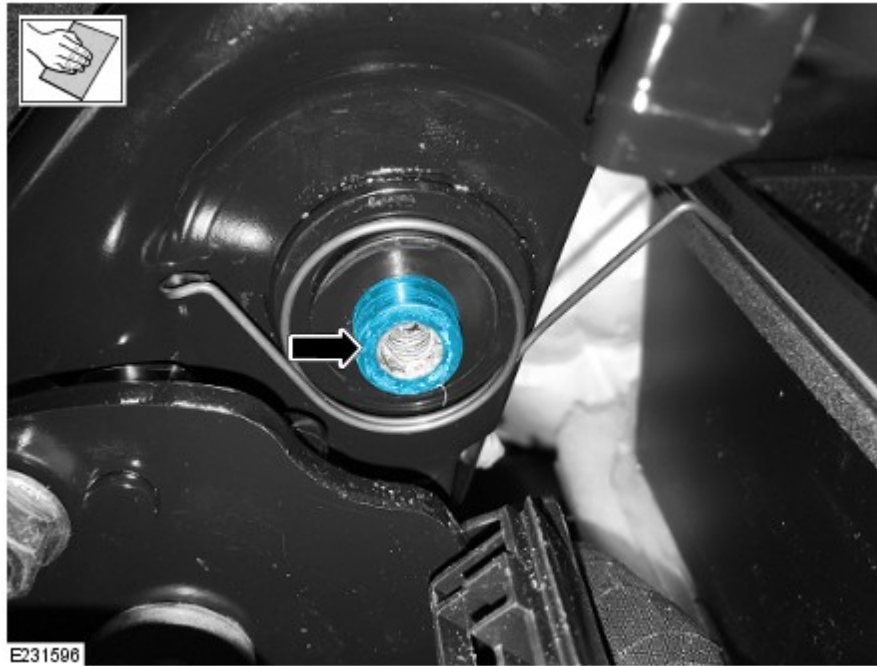

Clean the area highlighted using **ONLY** the Scotch-Brite™ supplied within the kit.

21.

NOTE:

Take note of the installed position shown in the illustration above making sure the free play cam spring is seated on the boss.

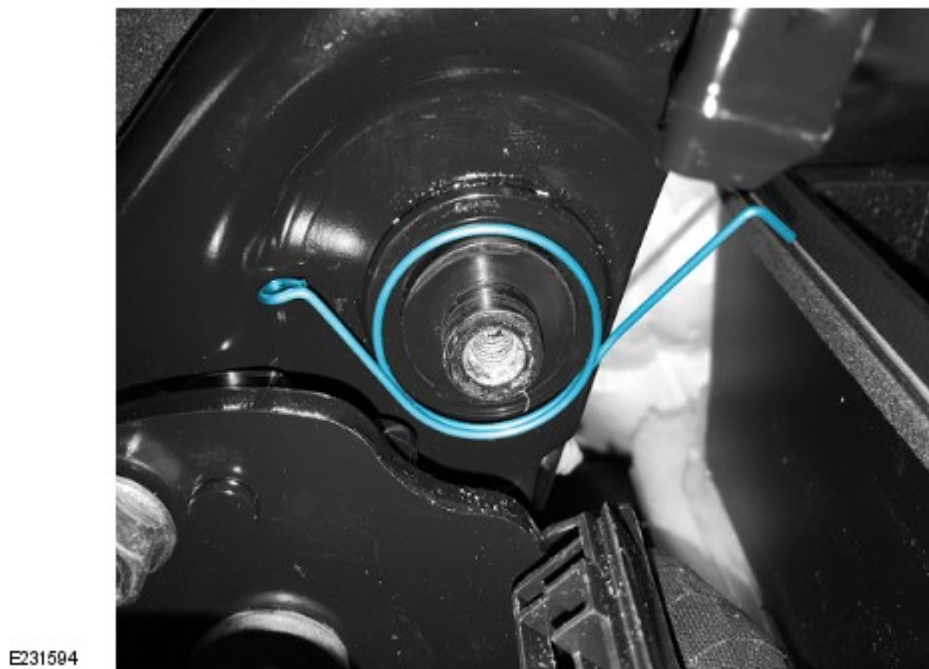

Install a new free play cam spring.

22.



Install the original free play cam.

23.

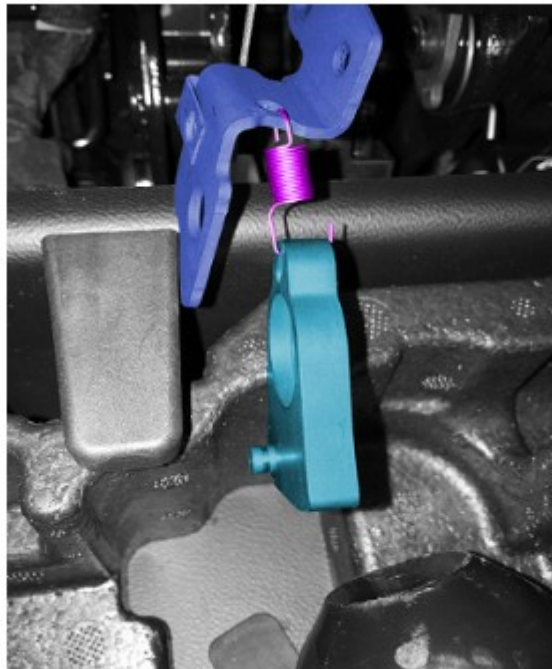

Attach a new crash lock spring to the crash lock and bowden cable bracket.

24.

CAUTION:

Make sure the free play cam and spring are seated correctly before tightening the retaining bolt.



Install a new crash lock and a new retaining bolt.

- ■ Torque: 25 Nm

25.

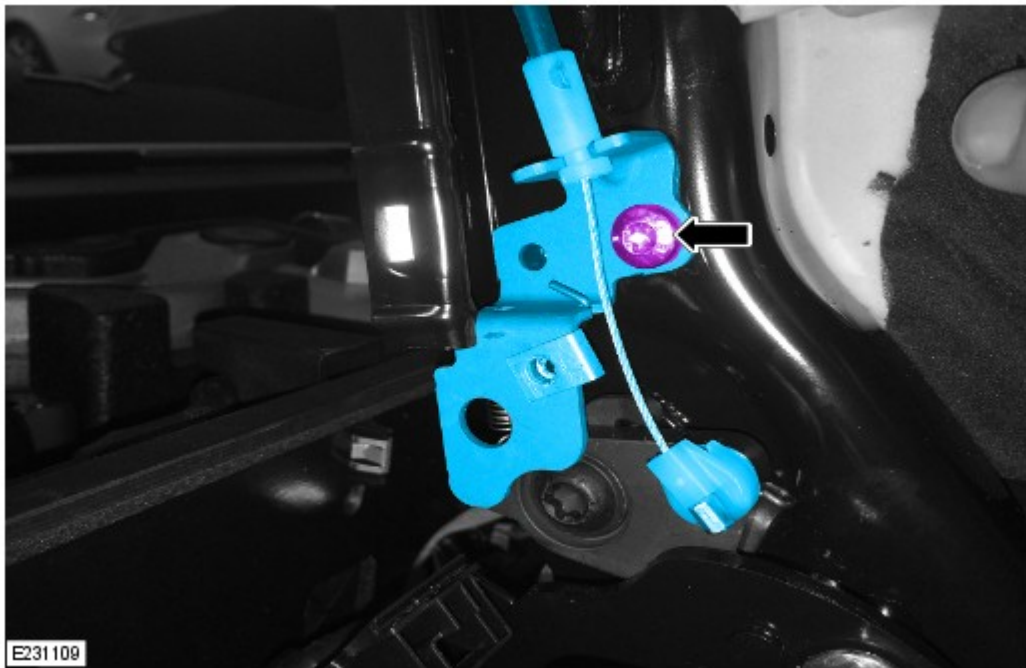

Using a new bowden cable bracket bolt, install the bowden cable bracket and attach the bowden cable to the crash lock.

- ■ Torque: 10 Nm

26.

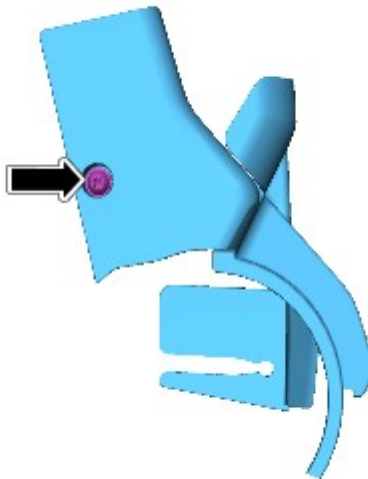

E231597

Install the trim piece and retaining screw.

- ■ Torque: 1.5 Nm

27.



E231097

Install the seat trim.

-
28. Before continuing with this service instruction, deploy the third row seat to make sure operation is correct.
-

29.

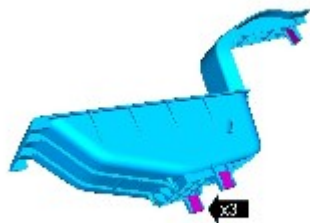
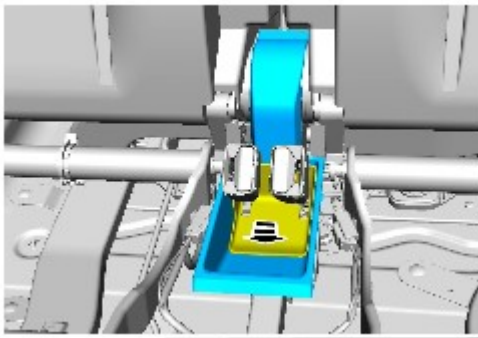

E156401

Install the seatbelt trim piece and cowl.

30. Install the seat base cushions (see TOPlx Workshop manual section 501-10: Seating - Removal and Installation - Third Row Seat Cushion Cover).

31. Install the backrest trim (see TOPlx Workshop Manual section 501-10: Seating - Removal and installation - Third Row Seat Backrest Cover).

32. Install the load space tool kit and housing.

33. Install the load space interior trim.