

**Noise Symptom - Noises From Around the Steering Shaft: Replacing intermediate steering shaft (SY 17/14)**

Revision: This bulletin replaces bulletin, Group 4, #17/14, dated August 23, 2017.



**Information**

These symptom-based repair instructions replace the instructions dated June 30, 2016

**Changes/additions** compared to the previous instructions:

- Additional information for affected vehicles after the date of introduction: Also rework with lubricant.



**Information**

These symptom-based repair instructions replace the instructions dated August 14, 2014

**Changes/additions** compared to the previous instructions:

- The 'Remedial action' section was changed - the modified procedure must be observed from now on.
- Modified intermediate steering shafts are listed in the 'Tools and materials' section. As a result, the subsequent work for the bellows is no longer required.

Model Year: **As of 2014 up to 2018**

Model Line: **Macan**

Subject: **Intermediate steering shaft**

Symptom: Customers complain about disturbing noises coming from the footwell area on the driver's side while steering.

Cause: The surface of the foam rubber seal in the sealing sleeves starts to wear and crumble due to high temperatures. This effect causes the reported noise.

Remedial Action: In the event of a customer complaint on a vehicle that:

- **was produced before the date of introduction** (June 02, 2016), replace the existing intermediate steering shaft with a new, **modified intermediate steering shaft with felt ring**, see Workshop Manual ⇒ *Workshop Manual '482819 Removing and installing intermediate steering shaft'*,
- **was produced after the date of introduction** (June 02, 2016) or was already replaced **by the new type of intermediate steering shaft** (with felt ring),

**also rework** the steering shaft/plastic sealing ring **in the engine compartment using** temperature-resistant **lubricant**, see "Procedure" section.

Date of Introduction: A modified intermediate steering shaft has been used in production since June 02, 2016.

Parts Info:

Part No.:	Designation:
95B.419.753.D – <b>NEW</b> –	⇒ Intermediate steering shaft (NEW, <b>with felt ring</b> , LHD, I-no. LOL)
999.917.828.00	⇒ Lubricant spray (Osixio Anti Squeak – Aerosol 32)

Tools:

- Clean cloth
- Safety glasses

Work Procedure: **Rework sealing bellows in the engine compartment:**



#### Toxic substances

- **Danger of poisoning or suffocation**
  - **Danger of burns to the eyes and skin**
- ⇒ **Wear personal protective gear.**
- ⇒ **Ventilate the work area well.**
- ⇒ **Never ingest or inhale.**
- ⇒ **Read specific information on the Hazard Sheet.**
- ⇒ **Do not smoke, eat or drink in the work area.**

- 1 Remove front underbody panelling, see ⇒ *Workshop Manual '519219 Removing and installing cover for front underbody - section on "Removing"*.

- 2 Carefully pull the rubber on the steering shaft duct (⇒ *Position of the spray nozzle at the steering shaft duct at the engine compartment side -item 1-*) away from the steering shaft in order to access the blue friction ring (⇒ *Position of the spray nozzle at the steering shaft duct at the engine compartment side -item 2-*).
- 3 Push the spray nozzle (⇒ *Position of the spray nozzle at the steering shaft duct at the engine compartment side -item 3-*) under the sealing lip as far as the blue friction ring (⇒ *Position of the spray nozzle at the steering shaft duct at the engine compartment side -item 2-*).
- 4 Spray the top and bottom.
- 5 For optimal distribution of the lubricant, turn the steering fully to the left and right several times immediately after spraying and also change the fore-and-aft adjustment position as far as it will go.
- 6 Install front underbody panelling, see ⇒ *Workshop Manual '519219 Removing and installing cover for front underbody - section on "Installing"*.

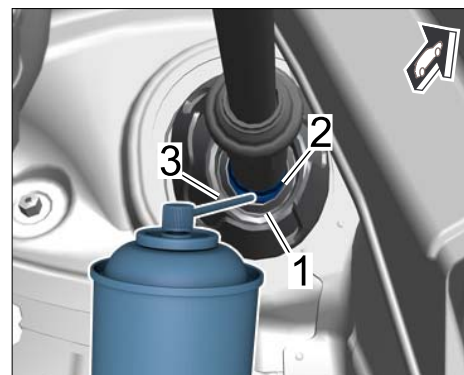

*Position of the spray nozzle at the steering shaft duct at the engine compartment side*

**Lubricating the Macan Steering Shaft Seals (Inner & Outer)**

- The steering shaft has two blue rings that need to be lubricated individually (Figure 1). Lubricant can't effectively flow from one to another.
- Each ring needs to be lubricated while the shaft is held vertically.
- This means the shaft has to be removed from the vehicle.
- The top ring is lubricated, and then the shaft is turned over and the other ring is lubricated.

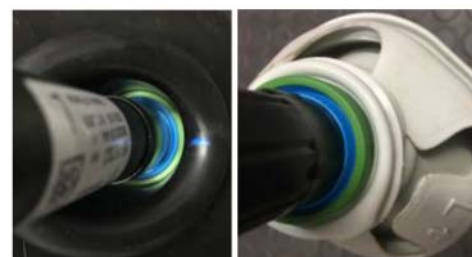

*Figure 1 — On the left is the passenger compartment side and on the right is the engine compartment side.*

**Two rings** can be seen in the assembly view on Figure 2.

Both rings are identical, the passenger compartment ring is cut away for clarity. Notice the felt insulator between them.

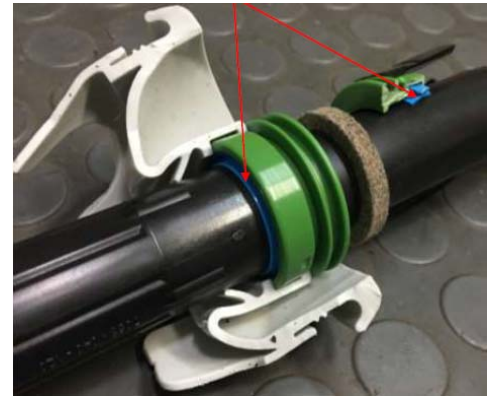

Figure 2

Lubricate the blue ring at its contact surfaces with the shaft and with the green ring (Figure 3).

Lubricate the blue ring on both contact areas (it doesn't take much). Move the large bulkhead seal up and down. Rotate the seal around the shaft to distribute the lubricant. Flip the shaft over and repeat for the other blue ring.

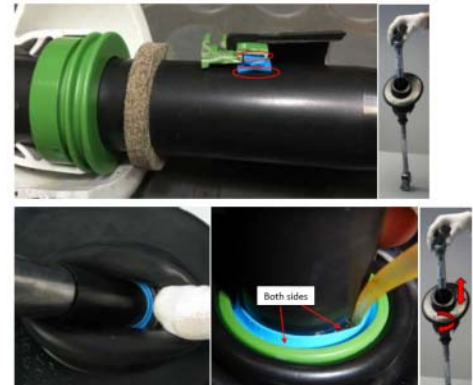

Figure 3

Invoicing: The work involved is invoiced under the labor operation:

APOS	Labor operation	I No.
48281900	Removing and installing bottom joint	
48554940	Reworking sealing bellows	

For invoicing and documentation using PQIS, enter the following coding:

Location (FES5)	48550	Sealing bellows
Damage type (SA4)	2019	Squeaking

References: ⇒ *Workshop Manual '482819 Removing and installing intermediate steering shaft'*

**Important Notice:** Technical Bulletins issued by Porsche Cars North America, Inc. are intended only for use by professional automotive technicians who have attended Porsche service training courses. They are written to inform those technicians of conditions that may occur on some Porsche vehicles, or to provide information that could assist in the proper servicing of a vehicle. Porsche special tools may be necessary in order to perform certain operations identified in these bulletins. Use of tools and procedures other than those Porsche recommends in these bulletins may be detrimental to the safe operation of your vehicle, and may endanger the people working on it. Properly trained Porsche technicians have the equipment, tools, safety instructions, and know-how to do the job properly and safely. Part numbers listed in these bulletins are for reference only. The work procedures updated electronically in the Porsche PIWIS diagnostic and testing device take precedence and, in the event of a discrepancy, the work procedures in the PIWIS Tester are the ones that must be followed.

© 2019 Porsche Cars North America, Inc.