



GROUP
BOD

MODEL
2020MY
Telluride (ON)

NUMBER
193

DATE
November 2019

TECHNICAL SERVICE BULLETIN

SUBJECT: CROSS BAR KEY COVER
SERVICE PART/REPLACEMENT

This bulletin provides the procedure to replace the roof cross bar key covers on some 2020MY Telluride (ON) vehicles, which may exhibit the cross bar key cover(s) falling off or noise while driving. Follow the procedure outlined in this bulletin to replace the four (4) cross bar key covers.

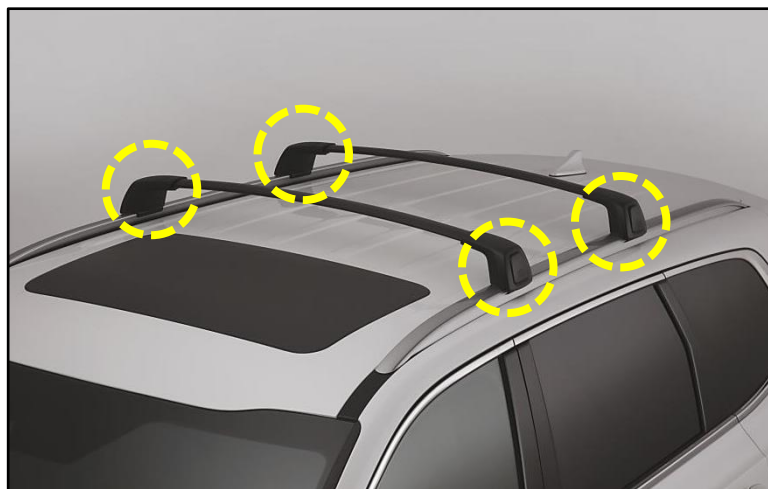

File Under: <Body>

Circulate To: General Manager Service Manager Parts Manager
 Service Advisors Technicians Body Shop Manager Fleet Repair

SUBJECT: CROSS BAR KEY COVER REPLACEMENT

Replacement Procedure:

1. Release the four (4) roof cross bar key cover(s) by pressing down on the "Kia" logo at the bottom of the cover(s).

*** NOTICE**
If needed, use a step ladder to reach over the vehicle. Protect the roof of the vehicle to prevent paint scratches and/or damage.

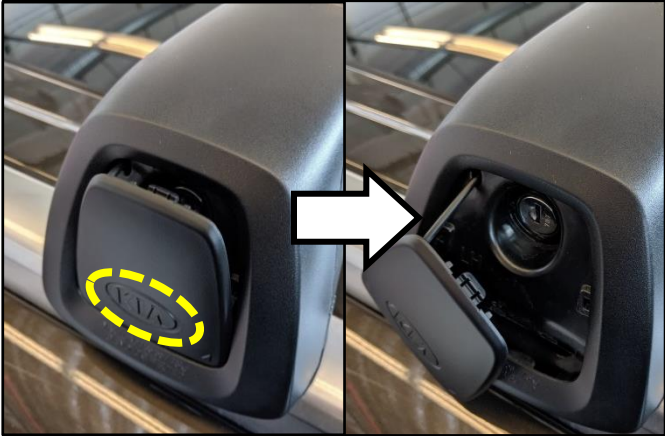

2. Using the supplied accessory key, unlock the four (4) cross bar end covers from both front and rear crossbars.

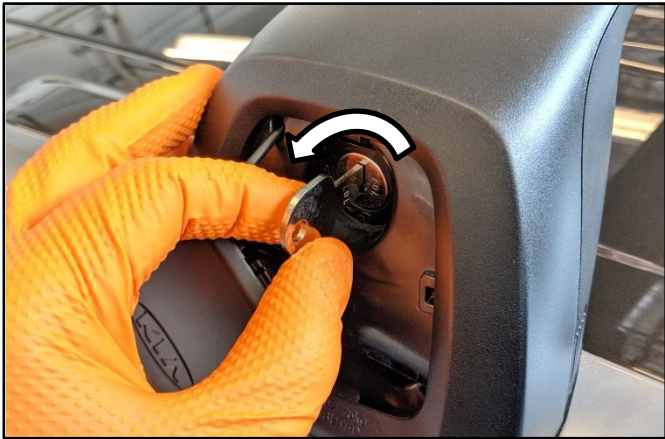

3. Remove all four (4) cross bar end caps.



5. Place the removed cross bar end cap(s) on a table and cut off the plastic tether from the key covers using a set of side cutters.

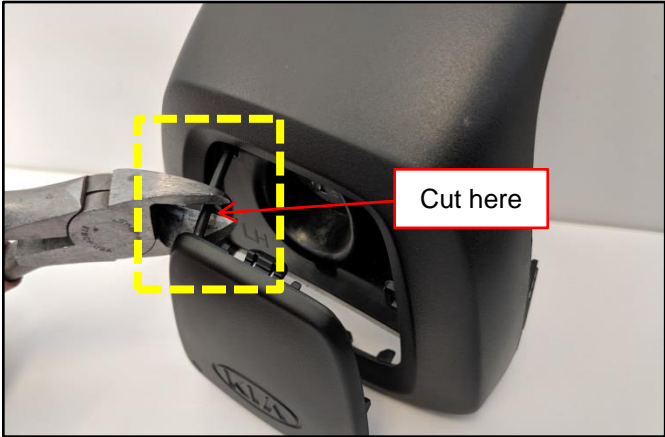

SUBJECT:

CROSS BAR KEY COVER REPLACEMENT

- 6a. Take the new updated cross bar key cover and feed the attached tether in through the front upper left hand hole of the cross bar end cap.



- 6b. On the reverse side of the cross bar end cap, pull the key cover plastic tether through the hole using a set of pliers to retain the key cover to the end cap.

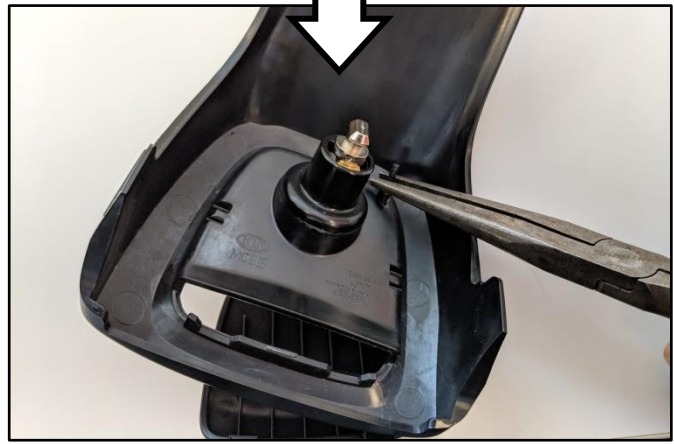

7. Repeat steps 6a through 6b to install the remaining cross bar key covers.



8. Reinstall the four (4) end caps onto the roof cross bars in the reverse order of removal. Ensure to lock all four (4) of the end caps with key.



9. Insert the bottom of the key cover into the cross bar end cap.



10. Push the top of the key cover to secure the cover to the cross bar end cap.



11. Repeat steps 9 and 10 to secure the remaining cross bar key covers.

SUBJECT:

CROSS BAR KEY COVER REPLACEMENT

AFFECTED VEHICLE RANGE:

Model	Production Date Range
Telluride (ON)	2020MY

REQUIRED PART:

Part Name	Part Number	Figure	Qty.
Cross bar Key Cover Kit	S9F21 AC900		1

WARRANTY INFORMATION:

N Code: I22 C Code: ZZ1

Claim Type	Causal P/N	Qty.	Repair Description	Labor Op Code	Op Time	Replacement P/N	Qty.
W	S9F21 AC000	0	Cross Bar End Caps Key Cover Replacement	F0620R00	0.2 M/H	S9F21 AC900	1