

Subject: HEADLIGHTS NOT AS BRIGHT AS THEY HAD PREVIOUSLY BEEN	Bulletin No.: 09-038/19
	Last Issued: 11/04/2019

APPLICABLE MODEL(S)/VINS

2014-2015 Mazda6 (with discharge type front combination light)

DESCRIPTION

Some customers may complain that the headlights are not as bright as they had previously been. This is caused by a dulled headlight reflector in the front combination light. To correct this issue, a service part reflector (internal part for discharge type front combination light) has been established instead of having to replace the whole front combination light.

Customers having this concern should have their vehicle repaired using the following repair procedure.

Outline of Repair

- 1) Remove the front combination light (4).
- 2) Remove the discharge headlight control module (1).
- 3) Remove the headlight HI/LO bulb (2).
- 4) Replace the reflector (3).
- 5) Assemble in the reverse order of removal.
- 6) Adjust the headlight aiming.

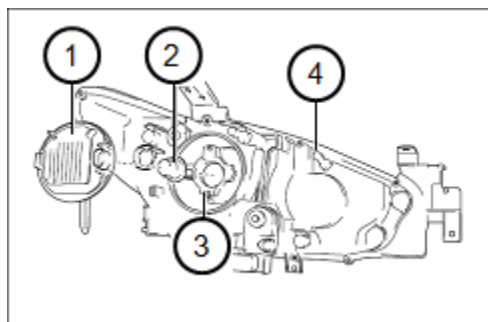

CONSUMER NOTICE: The information and instructions in this bulletin are intended for use by skilled technicians. Mazda technicians utilize the proper tools/equipment and take training to correctly and safely maintain Mazda vehicles. These instructions should not be performed by "do-it-yourselfers." Customers should not assume this bulletin applies to their vehicle or that their vehicle will develop the described concern. To determine if the information applies, customers should contact their nearest authorized Mazda dealership. Mazda North American Operations reserves the right to alter the specifications and contents of this bulletin without obligation or advance notice. All rights reserved. No part of this bulletin may be reproduced in any form or by any means, electronic or mechanical---including photocopying and recording and the use of any kind of information storage and retrieval system ---without permission in writing.

Recommended Tool(s)

#2 Phillips screwdriver with 150 mm (6 in.) round shaft and magnetic tip.

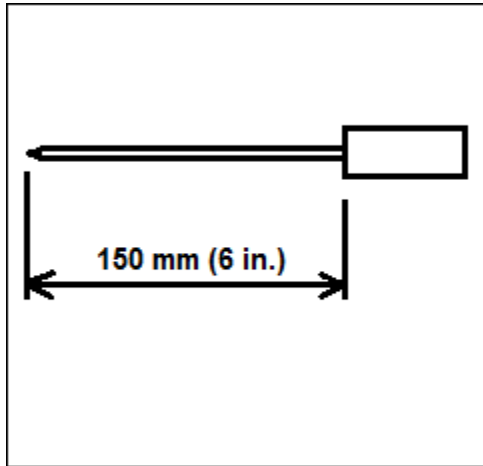
**REPAIR PROCEDURE**

1. Verify customer concern.
2. Remove the front combination light according to the instructions on MGSS (FRONT COMBINATION LIGHT REMOVAL/INSTALLATION).

NOTE: Place the headlight assembly on a soft cloth to protect the lens.

3. Disconnect the discharge headlight control module connector (2).
4. Rotate the discharge headlight control module (1) in the direction of the arrow (counterclockwise) (3), then remove it in the direction of the arrow (outward) (4).

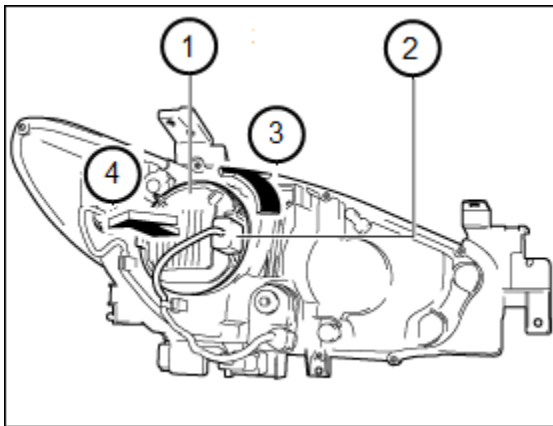

CONSUMER NOTICE: The information and instructions in this bulletin are intended for use by skilled technicians. Mazda technicians utilize the proper tools/equipment and take training to correctly and safely maintain Mazda vehicles. These instructions should not be performed by "do-it-yourselfers." Customers should not assume this bulletin applies to their vehicle or that their vehicle will develop the described concern. To determine if the information applies, customers should contact their nearest authorized Mazda dealership. Mazda North American Operations reserves the right to alter the specifications and contents of this bulletin without obligation or advance notice. All rights reserved. No part of this bulletin may be reproduced in any form or by any means, electronic or mechanical---including photocopying and recording and the use of any kind of information storage and retrieval system ---without permission in writing.

5. Rotate the igniter (1) in the direction of the arrow (counterclockwise) (2) to remove it in the direction of the arrow (outward) (3).

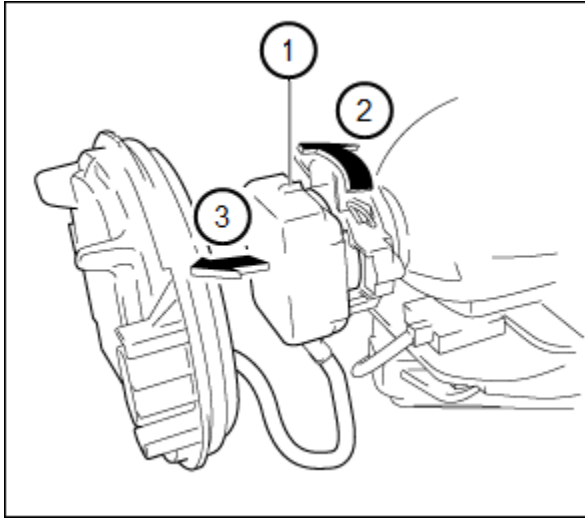

NOTE: For later in the repair procedure, try assembling the igniter to remember the feeling of the locked position.

6. Move section (1) of the bulb retaining wire (3) in the direction of the arrow (squeeze) (4), then pull it in the direction of the arrow (outward) (5), and detach the bulb retaining wire (3) and hook (2).

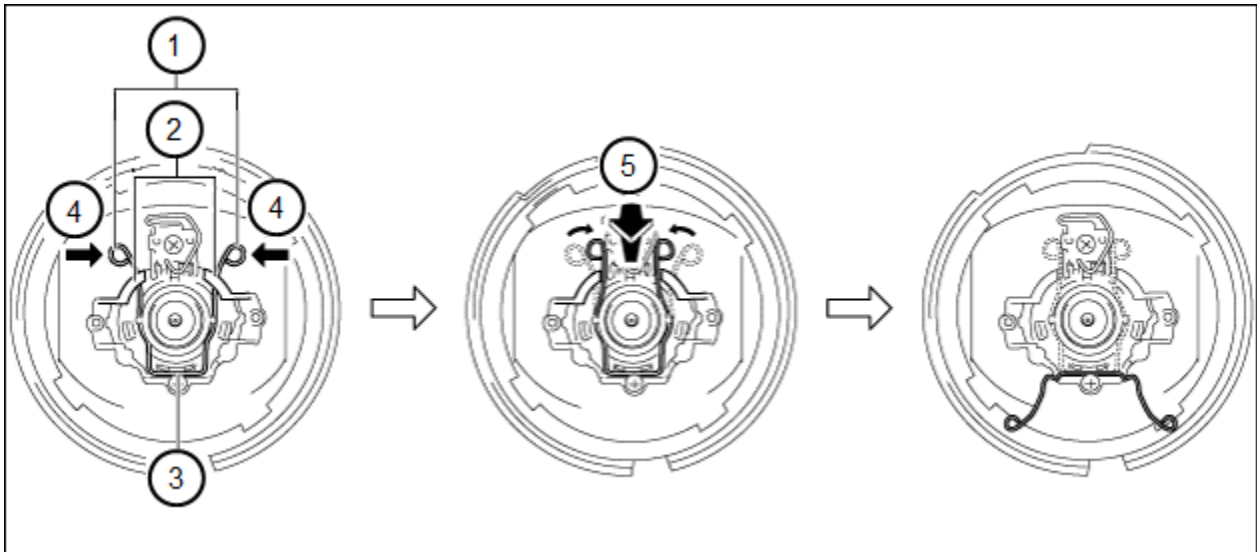

CONSUMER NOTICE: The information and instructions in this bulletin are intended for use by skilled technicians. Mazda technicians utilize the proper tools/equipment and take training to correctly and safely maintain Mazda vehicles. These instructions should not be performed by "do-it-yourselfers." Customers should not assume this bulletin applies to their vehicle or that their vehicle will develop the described concern. To determine if the information applies, customers should contact their nearest authorized Mazda dealership. Mazda North American Operations reserves the right to alter the specifications and contents of this bulletin without obligation or advance notice. All rights reserved. No part of this bulletin may be reproduced in any form or by any means, electronic or mechanical---including photocopying and recording and the use of any kind of information storage and retrieval system ---without permission in writing.

7. Remove the headlight HI/LO bulb (1).

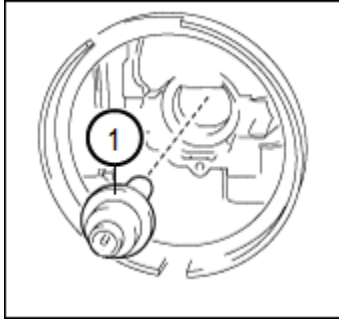

CAUTION: A discharge headlight bulb generates extremely high heat when it is illuminated. When replacing the bulb, hold the metal flange, not the glass. If the surface of the bulb gets dirty (i.e. fingerprints), excessive heat will build up and the life of the bulb will be shortened.

8. Attach the bulb retaining wire to the hook.

9. Remove the fixing screws for the reflector following the notes below.

NOTE:

- To avoid damage, move the swivel actuator slowly when needed for accessing the screw.

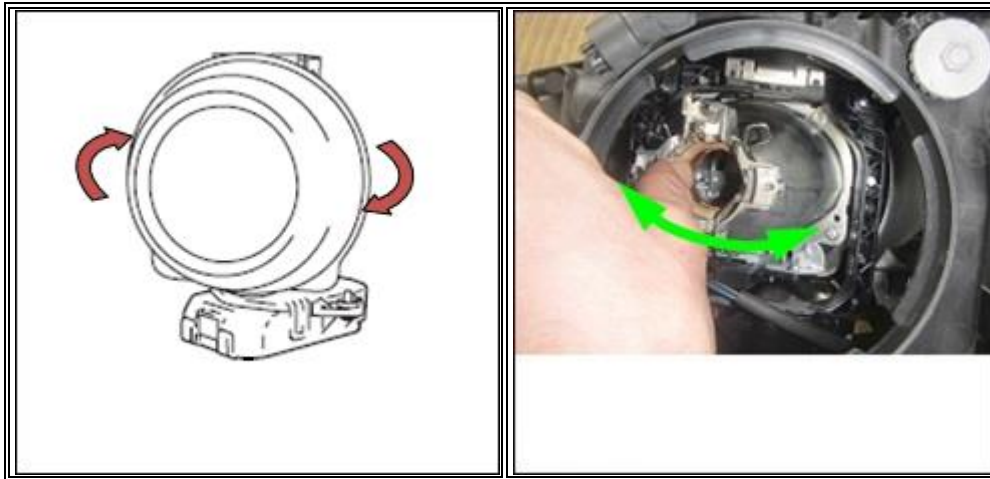

- Since the swivel actuator moves, hold the bulb mount of the reflector.



- To avoid damaging the screw head, properly align the screwdriver to the screw so the torque is applied on the screw head.
- Use special care for screw 'A' as the inner frame (2) interferes with the screwdriver (1).

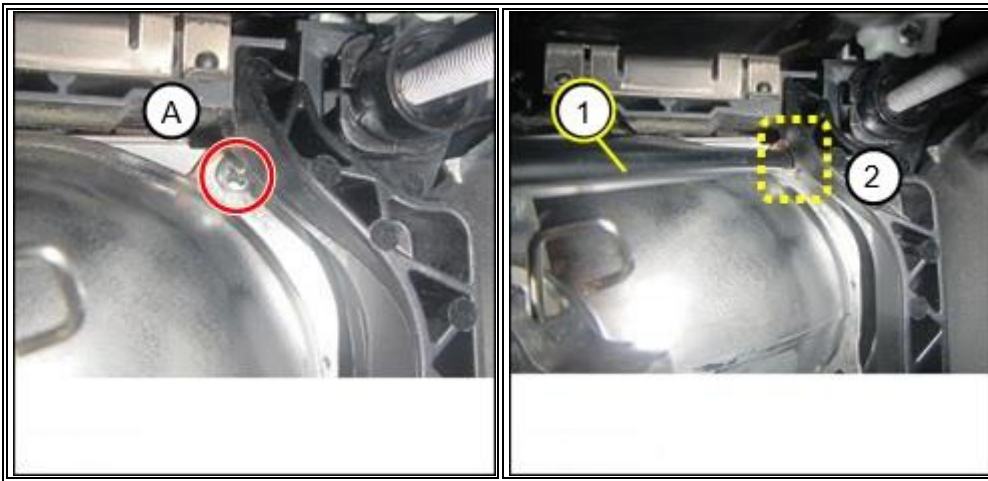

- Remove the loosened screw with a magnetic tip screwdriver, taking care not to drop it in the combination light.

- Loosen the screws in the order of A, B, C and D as shown below.

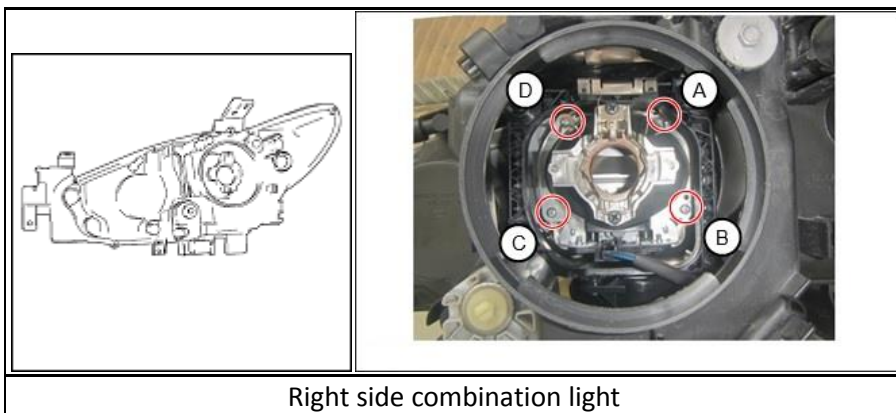
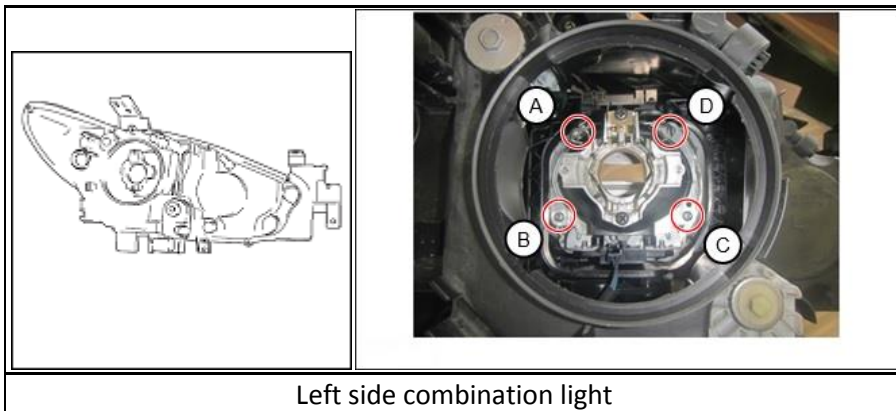

CONSUMER NOTICE: The information and instructions in this bulletin are intended for use by skilled technicians. Mazda technicians utilize the proper tools/equipment and take training to correctly and safely maintain Mazda vehicles. These instructions should not be performed by "do-it-yourselfers." Customers should not assume this bulletin applies to their vehicle or that their vehicle will develop the described concern. To determine if the information applies, customers should contact their nearest authorized Mazda dealership. Mazda North American Operations reserves the right to alter the specifications and contents of this bulletin without obligation or advance notice. All rights reserved. No part of this bulletin may be reproduced in any form or by any means, electronic or mechanical---including photocopying and recording and the use of any kind of information storage and retrieval system ---without permission in writing.

10. After removing all of the screws, hold the bulb mount and pull out the reflector.

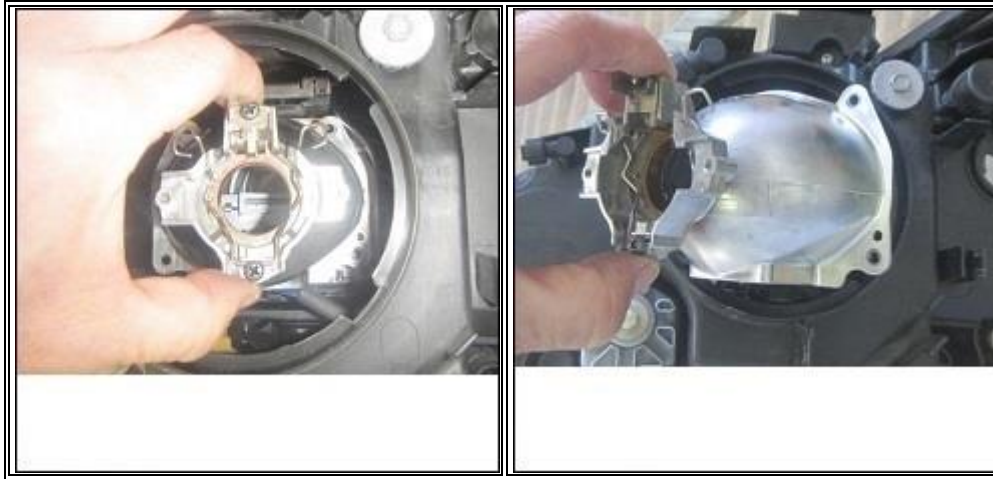

Internal structure of the combination light

The concerned section consists of three parts, Inner Lens (1), Shade (2) and Reflector (3).

The Inner lens (1) has a threaded hole and holds the shade (2) between it and the reflector (3).

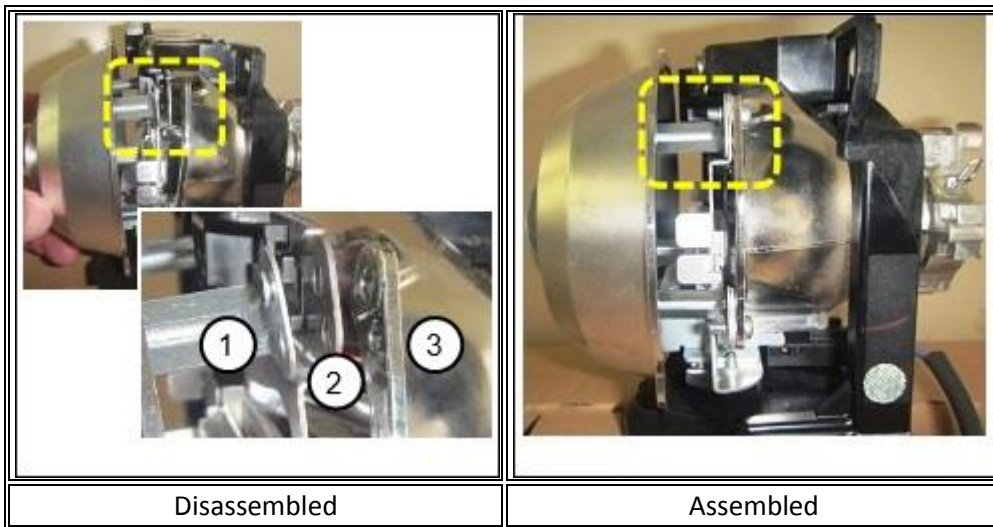

CONSUMER NOTICE: The information and instructions in this bulletin are intended for use by skilled technicians. Mazda technicians utilize the proper tools/equipment and take training to correctly and safely maintain Mazda vehicles. These instructions should not be performed by "do-it-yourselfers." Customers should not assume this bulletin applies to their vehicle or that their vehicle will develop the described concern. To determine if the information applies, customers should contact their nearest authorized Mazda dealership. Mazda North American Operations reserves the right to alter the specifications and contents of this bulletin without obligation or advance notice. All rights reserved. No part of this bulletin may be reproduced in any form or by any means, electronic or mechanical---including photocopying and recording and the use of any kind of information storage and retrieval system ---without permission in writing.

11. Place the combination light upside down on a soft cloth.



12. Hold the combination light in the air and lightly shake it so that the four holes for the inner lens and shade are aligned. Slowly place the combination light in an upside down position.

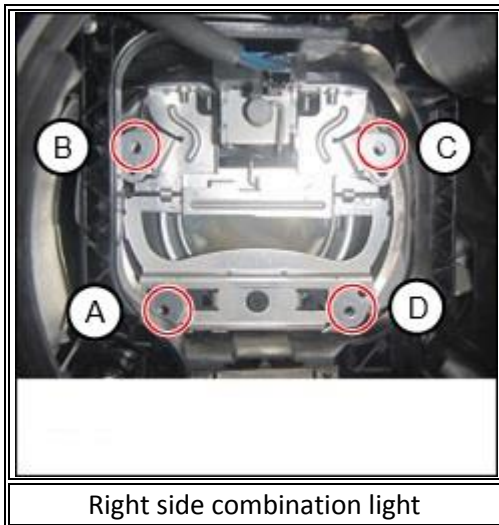

CONSUMER NOTICE: The information and instructions in this bulletin are intended for use by skilled technicians. Mazda technicians utilize the proper tools/equipment and take training to correctly and safely maintain Mazda vehicles. These instructions should not be performed by "do-it-yourselfers." Customers should not assume this bulletin applies to their vehicle or that their vehicle will develop the described concern. To determine if the information applies, customers should contact their nearest authorized Mazda dealership. Mazda North American Operations reserves the right to alter the specifications and contents of this bulletin without obligation or advance notice. All rights reserved. No part of this bulletin may be reproduced in any form or by any means, electronic or mechanical---including photocopying and recording and the use of any kind of information storage and retrieval system ---without permission in writing.

13. Hold the bulb mount of the new reflector and place it in the combination light, then align the screw hole of the reflector to the holes of the inner lens and the shade.

NOTE: Due to the weight of the inner lens, screw holes B and C will not completely align at first. When tightening screw D, the inner lens will move to the shade and screw holes C, B and A will be aligned.

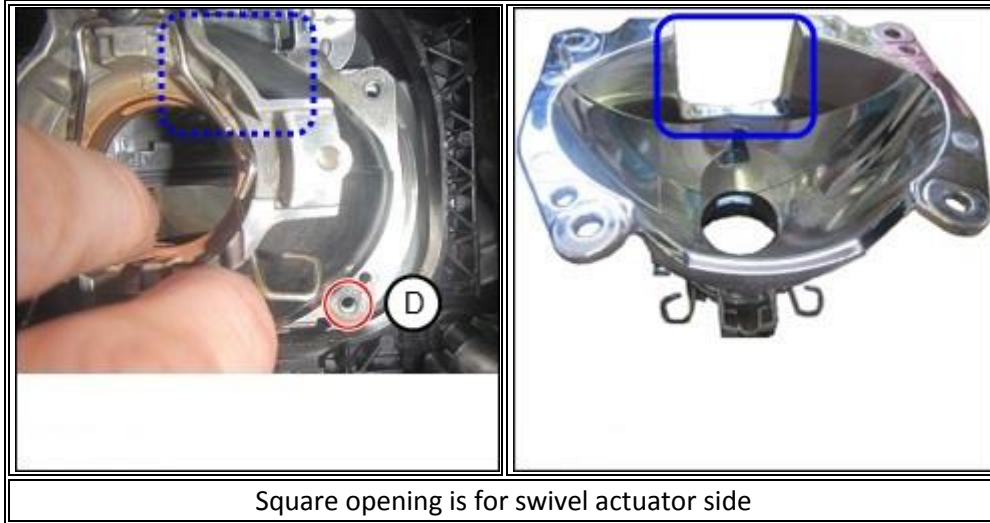

14. Attach a new screw on the magnetic tip of the screwdriver, then taking care not to drop it in the combination light, insert the screw at the screw hole D and lightly tighten the screw until seated so that the reflector can be moved to align the other screw holes.

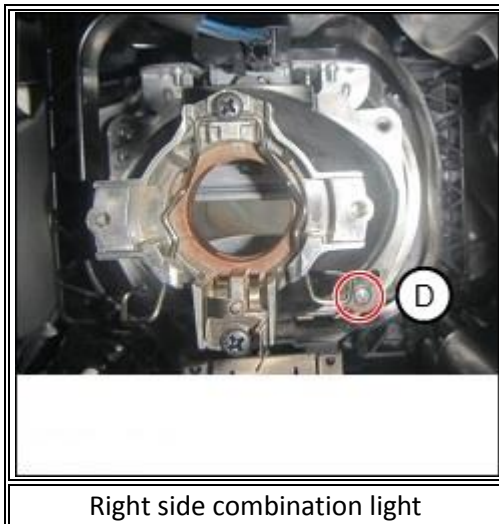

NOTE:

- If the screw hole of the inner lens does not align correctly, attempting to tighten the screw should press the inner lens without the screw moving into the threaded hole. If the screw does not seem to be moving into the threaded hole, align the holes and try again.

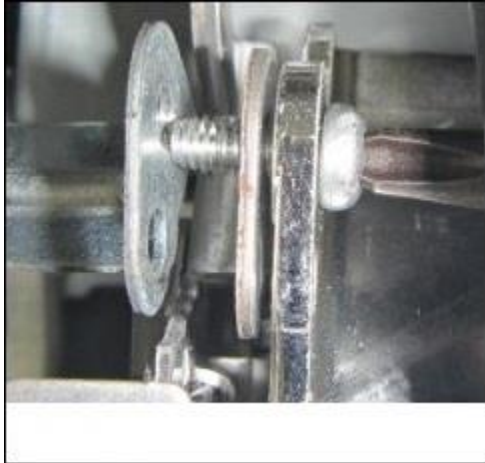

- If it is still difficult, hold the combination light so that the outer lens is at the top and look into the hole from the bottom.



15. Lightly tighten screw C, B and A in that order.

16. Tighten screw B, C, D and A in that order.

Reference torque: 8.7 in·lbf (0.98 N·m, 10 kgf·cm)

17. Place the combination light right side up.

CONSUMER NOTICE: The information and instructions in this bulletin are intended for use by skilled technicians. Mazda technicians utilize the proper tools/equipment and take training to correctly and safely maintain Mazda vehicles. These instructions should not be performed by "do-it-yourselfers." Customers should not assume this bulletin applies to their vehicle or that their vehicle will develop the described concern. To determine if the information applies, customers should contact their nearest authorized Mazda dealership. Mazda North American Operations reserves the right to alter the specifications and contents of this bulletin without obligation or advance notice. All rights reserved. No part of this bulletin may be reproduced in any form or by any means, electronic or mechanical---including photocopying and recording and the use of any kind of information storage and retrieval system ---without permission in writing.

18. Hold the bulb mount of the reflector and confirm that no play can be felt when force is applied in all directions.



CONSUMER NOTICE: The information and instructions in this bulletin are intended for use by skilled technicians. Mazda technicians utilize the proper tools/equipment and take training to correctly and safely maintain Mazda vehicles. These instructions should not be performed by "do-it-yourselfers." Customers should not assume this bulletin applies to their vehicle or that their vehicle will develop the described concern. To determine if the information applies, customers should contact their nearest authorized Mazda dealership. Mazda North American Operations reserves the right to alter the specifications and contents of this bulletin without obligation or advance notice. All rights reserved. No part of this bulletin may be reproduced in any form or by any means, electronic or mechanical---including photocopying and recording and the use of any kind of information storage and retrieval system ---without permission in writing.

19. In the reverse order of removal, install the headlight HI/LO bulb, the igniter and the discharge headlight control module to the front combination light.

NOTE: When assembling, extend the bulb retaining wire until completely locked.

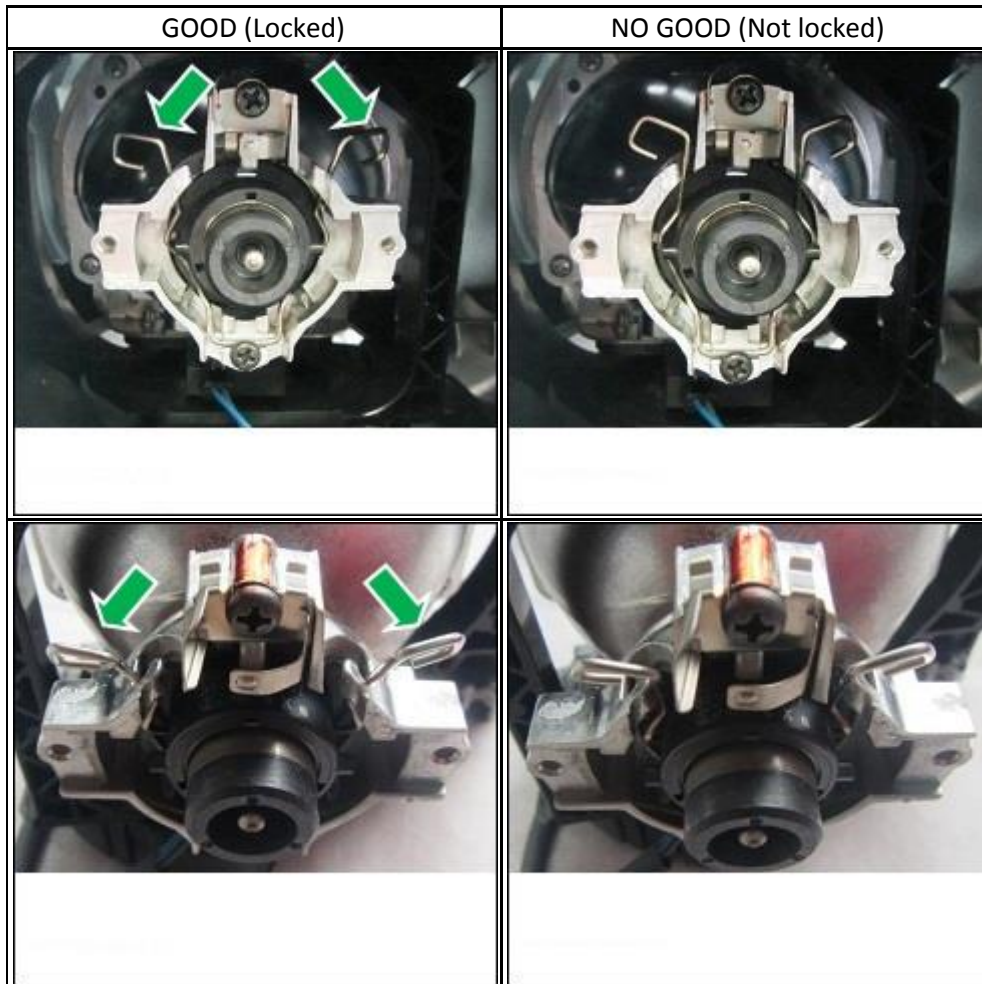

CONSUMER NOTICE: The information and instructions in this bulletin are intended for use by skilled technicians. Mazda technicians utilize the proper tools/equipment and take training to correctly and safely maintain Mazda vehicles. These instructions should not be performed by "do-it-yourselfers." Customers should not assume this bulletin applies to their vehicle or that their vehicle will develop the described concern. To determine if the information applies, customers should contact their nearest authorized Mazda dealership. Mazda North American Operations reserves the right to alter the specifications and contents of this bulletin without obligation or advance notice. All rights reserved. No part of this bulletin may be reproduced in any form or by any means, electronic or mechanical---including photocopying and recording and the use of any kind of information storage and retrieval system ---without permission in writing.

NOTE: When installing the igniter, rotate clockwise. If it does not go to the locked position with light force (as confirmed when disassembling), confirm if the combination light is upside down. If the combination light is upside down, the igniter will touch the reflector and will not go to the locked position with light force. Realign and lock the igniter in place as shown.

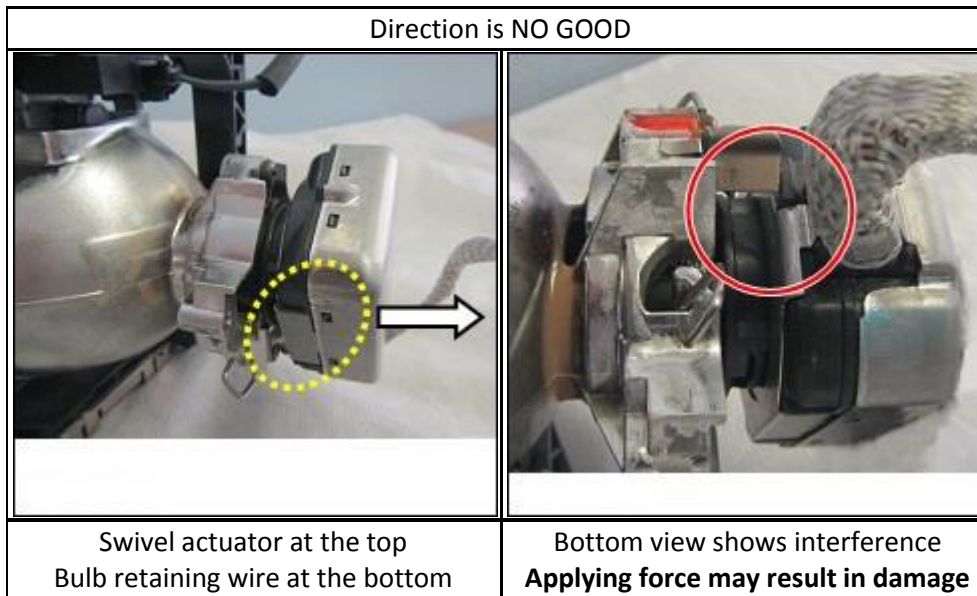
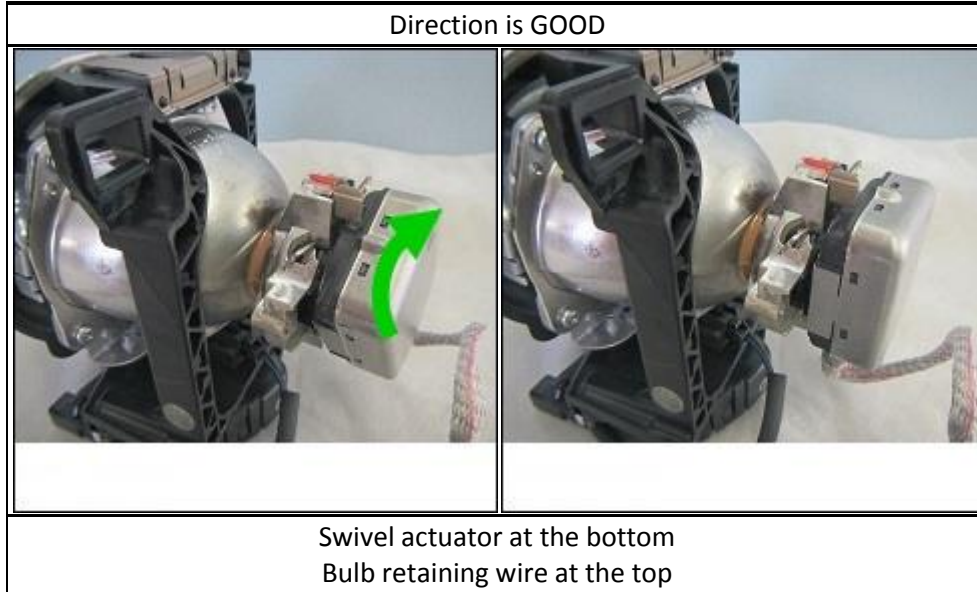

CONSUMER NOTICE: The information and instructions in this bulletin are intended for use by skilled technicians. Mazda technicians utilize the proper tools/equipment and take training to correctly and safely maintain Mazda vehicles. These instructions should not be performed by "do-it-yourselfers." Customers should not assume this bulletin applies to their vehicle or that their vehicle will develop the described concern. To determine if the information applies, customers should contact their nearest authorized Mazda dealership. Mazda North American Operations reserves the right to alter the specifications and contents of this bulletin without obligation or advance notice. All rights reserved. No part of this bulletin may be reproduced in any form or by any means, electronic or mechanical---including photocopying and recording and the use of any kind of information storage and retrieval system ---without permission in writing.

20. Repeat the procedure on the other front combination light.
21. Install the front combination lights to the vehicle in the reverse order of removal.
22. Adjust the headlight aiming according to the instruction on MGSS (HEADLIGHT AIMING).
23. Verify repair.

PARTS INFORMATION

Part Number	Description	Qty.
GJY1-51-493B	Reflector Assembly	1

NOTE:

- Each assembly includes a reflector and four (4) screws.
- For both sides, order two (2) assemblies.
- For applicable headlamp unit, refer to the table below.

Reflector Assembly Part Number	Applicable Headlamp Unit Part Number	
GJY1-51-493B	GJS1-51-031 (R)	GJS1-51-041 (L)

WARRANTY INFORMATION

NOTE:

- This warranty information applies only to verified customer complaints on vehicles eligible for warranty repair.
- This repair will be covered under Mazda's New Vehicle Limited Warranty term.
- Additional diagnostic time cannot be claimed for this repair.

Warranty Type	A
Symptom Code	87
Damage Code	9A
Part Number Main Cause	GJY1-51-493B
Quantity	1
Operation Number / Labor Hours:	XXR5PXRX / 1.3 Hrs.

CONSUMER NOTICE: The information and instructions in this bulletin are intended for use by skilled technicians. Mazda technicians utilize the proper tools/equipment and take training to correctly and safely maintain Mazda vehicles. These instructions should not be performed by "do-it-yourselfers." Customers should not assume this bulletin applies to their vehicle or that their vehicle will develop the described concern. To determine if the information applies, customers should contact their nearest authorized Mazda dealership. Mazda North American Operations reserves the right to alter the specifications and contents of this bulletin without obligation or advance notice. All rights reserved. No part of this bulletin may be reproduced in any form or by any means, electronic or mechanical---including photocopying and recording and the use of any kind of information storage and retrieval system ---without permission in writing.

CONSUMER NOTICE: The information and instructions in this bulletin are intended for use by skilled technicians. Mazda technicians utilize the proper tools/equipment and take training to correctly and safely maintain Mazda vehicles. These instructions should not be performed by "do-it-yourselfers." Customers should not assume this bulletin applies to their vehicle or that their vehicle will develop the described concern. To determine if the information applies, customers should contact their nearest authorized Mazda dealership. Mazda North American Operations reserves the right to alter the specifications and contents of this bulletin without obligation or advance notice. All rights reserved. No part of this bulletin may be reproduced in any form or by any means, electronic or mechanical---including photocopying and recording and the use of any kind of information storage and retrieval system ---without permission in writing.