	GROUP ELE	MODEL 2020MY Telluride (ON)
	NUMBER 189	DATE October 2019
TECHNICAL SERVICE BULLETIN		
SUBJECT: SERVICE ACTION: RAIN SENSOR INSPECTION AND/OR REPLACEMENT (SA402)		

This bulletin provides the procedure to inspect and if necessary, replace the windshield rain module and sensor assembly on some 2020MY Telluride (ON) vehicles produced from June 24, 2019 through July 17, 2019, which may have the incorrect rain sensor installed. Before conducting the procedure, verify that the vehicle is included in the list of affected VINs.



* NOTICE

A Service Action is a repair program without customer notification that is performed during the warranty period. Any dealer requesting to perform this repair outside the warranty period will require DPSM approval.

Repair status for a VIN is provided on WebDCS (Service → Warranty Coverage → Warranty Coverage Inquiry → Campaign Information). Not completed Recall / Service Action reports are available on WebDCS (Consumer Affairs → Not Completed Recall → Recall VIN → Select Report), which includes a list of affected vehicles.

This issue number is **SA402**.

File Under: <Electrical>

Circulate To: General Manager Service Manager Parts Manager
 Service Advisors Technicians Body Shop Manager Fleet Repair

Rain Module and Sensor Inspection – Testing:

1. Turn the engine 'ON' and set the front wiper function to "AUTO" mode in the instrument cluster (A). Set the wiper switch (B) setting also in the "AUTO" position.

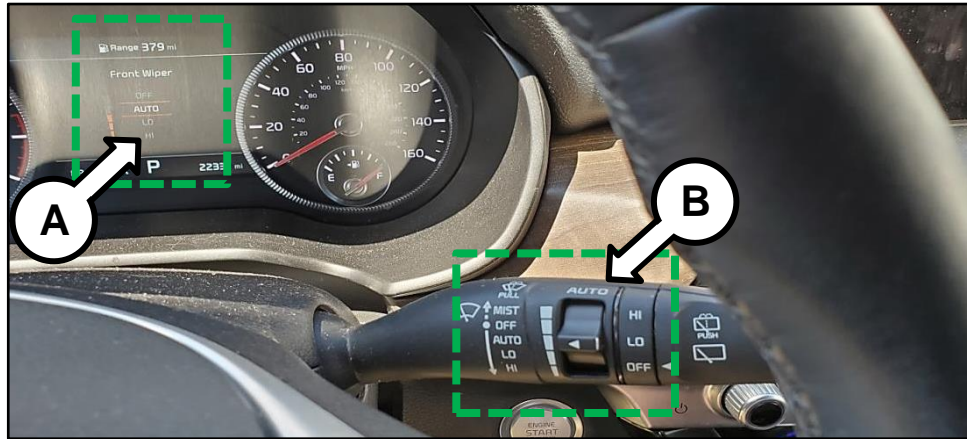

2. Ensure that the windshield (C) is clean and free from dirt or debris especially around the upper center area (outlined in green).

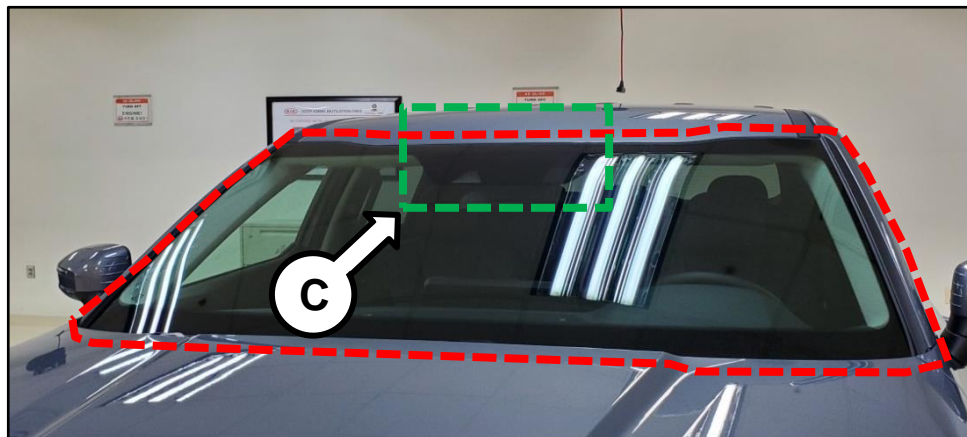

3. With the engine 'ON' and vehicle in 'PARK', use a water spray bottle begin to spray water in the top center windshield area, in front of the rear view mirror. If the front wipers operate automatically, this action is complete. No further action is required. If the front wipers **do not** operate automatically, then proceed to page 3.



SUBJECT:

SERVICE ACTION: RAIN SENSOR INSPECTION AND REPLACEMENT (SA402)

Rain Module and Sensor Inspection and/or Replacement Procedure:

1. Remove the inside rearview mirror cover by referring to the "Body Electrical System → Wiper/Washer → Rain Sensor → Repair procedures" chapter in the applicable Shop Manual on KGIS.

* NOTICE

Do not remove the rain module and sensor assembly at this time. Proceed to step 2.

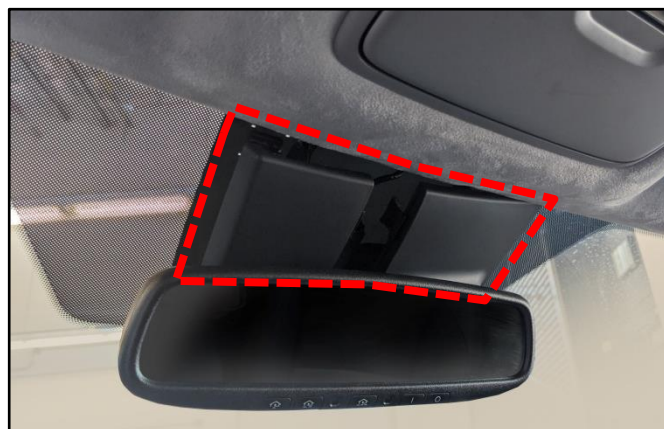

2. If the existing rain module and sensor assembly part number (A) does **not** match (P/N 96000 J3000), remove the existing rain module and sensor and replace it with the **96000 J3000FFF** part listed in page 5 as outlined on KGIS.

If the existing rain sensor is the correct part number (P/N 96000 J3000), proceed to diagnose and repair according to normal service guidelines and procedures.

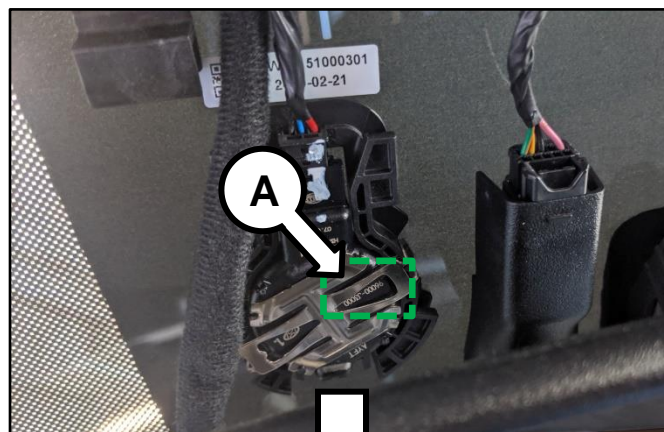

3. Replace all of the other removed parts in the reverse order of removal.

* NOTICE

The windshield facing side (B) of the rain sensor has a film of silicone that is sensitive to foreign substances. Be careful not to touch.

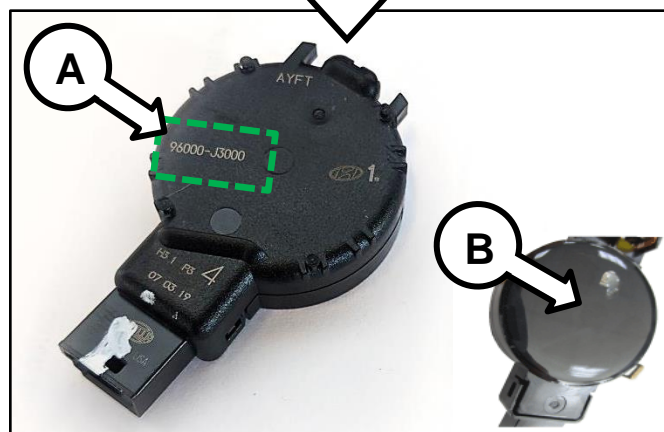

4. Ensure that the rain sensor operates as designed by following the inspection procedure outlined on page 1 of this bulletin.

SUBJECT:

SERVICE ACTION: RAIN SENSOR INSPECTION AND REPLACEMENT (SA402)

AFFECTED VEHICLE RANGE:

Model	Production Date Range
Telluride (ON)	June 24, 2019 through July 17, 2019

REQUIRED PART:

Part Name	Part Number	Figure
Rain Module and Sensor Assembly	96000 J3000FFF	

WARRANTY INFORMATION:

N Code: N99 C Code: C99

Claim Type	Causal P/N	Qty.	Repair Description	Labor Op Code	Op Time	Replacement P/N	Qty.
V	96000 J3000	0	(SA402) Rain Sensor Inspection	190A26I0	0.2 M/H	N/A	0
			(SA402) Rain Sensor Inspection & Replacement	190A26R0	0.3 M/H	96000 J3000FFF	1

*** NOTICE**

VIN inquiry data for this repair is provided for tracking purposes only. Kia retailers should reference SA402 when accessing the WebDCS system.