

VOLVO CAR SERVICE AND PARTS BUSINESS				
<h1>Special Tools Bulletin</h1>				
TITLE: <b>Newsletter 101: Mandatory Tools</b>				
NO: <b>234</b>	ISSUE DATE: 2019-08-27		CAR MARKET: <b>United States and Canada</b>	Page 1 of 7
	STATUS DATE: 2019-08-27			

**“Right first time in Time”**

**All tools have been classified as required, and will be allocated and billed to all U.S. and Canadian retailers by Volvo.**

**All tool allocations and tool orders are being handled by the Volvo Parts Operations and the Volvo Parts Distribution Centers.**

**Overview of content: Kit 33300332**

<u><b>Part Number</b></u>	<u><b>Description</b></u>
9513126	Extension Cable BECM
9513133	Adapter
9513163	BOB Overlay Kit
9989912	Screw Replacement
9997712	Mandrel
9997715	Fixture/Puller
9997721	Fixture
9997736	Mandrel
9997737	Mandrel
9997738	Mandrel
9997739	Mandrel
9997741	Puller
9997751	Mandrel
9997752	Mandrel

Service Personnel: Read and initial	SERVICE MANAGER	PARTS MANAGER	WORKSHOP FOREMAN	SERVICE TECHNICIANS											

9513126

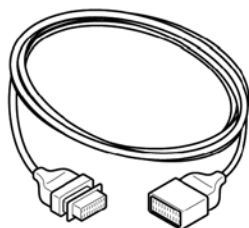

**VOLVO**

31

## Extension cable BECM

Extension to 9513074 BECM Adapter.

<b>Tool standard</b>	C2-E
<b>Tool group</b>	31
<b>Tool bulletin</b>	423
<b>Model</b>	Hybrid SPA, B4204T28, B4204T34, B4204T45, B4204T46
<b>Tool board</b>	39
<b>Weight</b>	0.58 kg / 1.27 lbs
<b>Material</b>	Mix of plastics and metals
<b>Country of origin</b>	Sweden, SE
<b>Supplier</b>	AEPT1

9513133

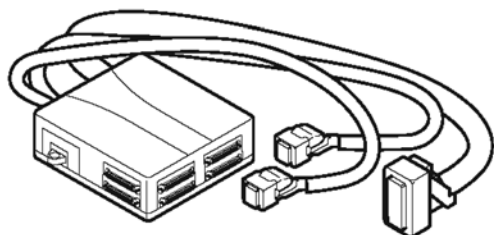

**VOLVO**

39

## Adapter

ECM ECU adapter for VEA Gen3, similar to 9513052, 519A.

<b>Tool standard</b>	C1
<b>Tool group</b>	39
<b>Tool bulletin</b>	423
<b>Model</b>	8G30/45/55
<b>Tool board</b>	39
<b>Weight</b>	3.5 kg / 7.72 lbs
<b>Material</b>	Mix of plastics and metals
<b>Country of origin</b>	Sweden, SE
<b>Supplier</b>	AEPT1

9513135

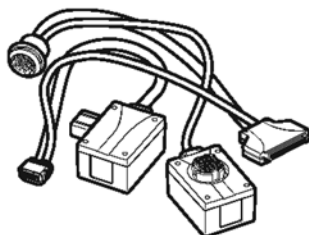

**VOLVO**

39

## Adapter

TCM ECU adapter for AW8G transmission, similar to 9513055, 519A.

<b>Tool standard</b>	C2
<b>Tool group</b>	39
<b>Tool bulletin</b>	423
<b>Model</b>	AW8G30/45/55
<b>Tool board</b>	39
<b>Weight</b>	Not available, see upcoming tool bulletin
<b>Material</b>	Mix of plastics and metals
<b>Country of origin</b>	Sweden, SE
<b>Supplier</b>	BLTLA

**9513135 will be sent out separately!**



9513163

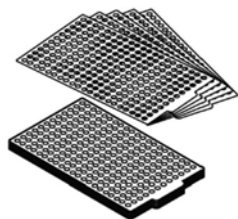

**VOLVO**

39

### BOB overlay kit

BOB overlay kit: 1 pc. 9513130 VCU1, 1 pc. 9513131 ESM, 2 pcs. 9513133 ECM, 1 pc. 9513135.

<b>Tool standard</b>	C1
<b>Tool group</b>	39
<b>Tool bulletin</b>	423
<b>Model</b>	D4204T14, D4204T16, D4204T23, D4204T2, D420T8, D4204T7, D4204T4, B4204T20, B4204T23, B4204T26, B4204T27, B4204T29, B4204T31, B4204T34, B4204T35, B4204T39, B4204T44, B4204T45, B4204T46, B4204T48, B4204T49
<b>Tool board</b>	39
<b>Weight</b>	0.38 kg / 0.84 lbs
<b>Material</b>	Plastics
<b>Country of origin</b>	Sweden, SE
<b>Supplier</b>	AEPT1

9995893E

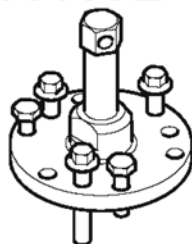

**VOLVO**

46

### Screw replacement 9989912

Exchange existing screw on tool 9995893 to this.

<b>Tool standard</b>	C1
<b>Tool group</b>	43
<b>Tool bulletin</b>	422
<b>Model</b>	All models
<b>Tool board</b>	43
<b>Weight</b>	Not available, see upcoming tool bulletin
<b>Material</b>	Steel
<b>Country of origin</b>	Sweden, SE
<b>Supplier</b>	DLOUA



9997712

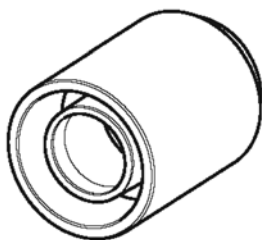

**VOLVO**

46

## Mandrel

Drive shaft sealing right, 519A.

<b>Tool standard</b>	C1
<b>Tool group</b>	46
<b>Tool bulletin</b>	422
<b>Model</b>	D420T2 D420T8 B420T2 B420T
<b>Tool board</b>	46
<b>Weight</b>	0.88 kg / 1.94 lbs
<b>Material</b>	POM and steel
<b>Country of origin</b>	Hungary, HU
<b>Supplier</b>	AEP4Y

9997715

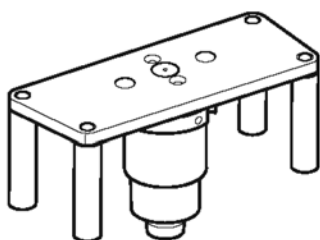

**VOLVO**

46

## Fixture/puller

To change the ERAD bearings.

<b>Tool standard</b>	C2-E
<b>Tool group</b>	46
<b>Tool bulletin</b>	422
<b>Model</b>	All
<b>Tool board</b>	46
<b>Weight</b>	5.35 kg / 11.8 lbs
<b>Material</b>	Mixture of different steel and white nylon
<b>Country of origin</b>	Sweden, SE
<b>Supplier</b>	DLOUA

9997721

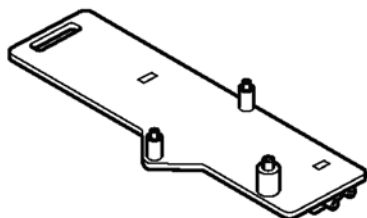

**VOLVO**

43

## Fixture

To change the gearbox.

<b>Tool standard</b>	C1
<b>Tool group</b>	43
<b>Tool bulletin</b>	422
<b>Model</b>	8G30/45/55
<b>Tool board</b>	43
<b>Weight</b>	4.54 kg / 10.01 lbs
<b>Material</b>	Steel
<b>Country of origin</b>	Hungary, HU
<b>Supplier</b>	AEP4Y



9997736



**VOLVO**

### Mandrel

Mandrel for replacement of sealing ring angular gear, front right.

Tool standard	C1
Tool group	43
Tool bulletin	422
Model	D420T2, D420T1, B420T2, B420T
Tool board	43
Weight	0.17 kg / 0.37 lbs
Material	POM
Country of origin	Poland, PL
Supplier	AEP14

43

9997737

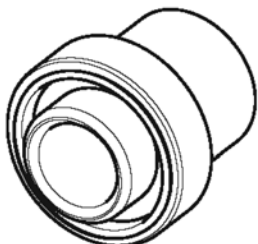

**VOLVO**

### Mandrel

Mandrel for replacement of sealing ring carrier, rear gear.

Tool standard	C1
Tool group	43
Tool bulletin	422
Model	D420T2, D420T9, B420T2, B420T
Tool board	43
Weight	0.09 kg / 0.203 lbs
Material	POM
Country of origin	Poland, PL
Supplier	AEP14

43

9997738



**VOLVO**

### Mandrel

Mandrel for replacement of seal ring rear drive shaft, driveshaft left and right.

Tool standard	C1
Tool group	46
Tool bulletin	422
Model	D420T2, D420T8, B420T2, B420T
Tool board	46
Weight	0.1 kg / 0.22 lbs
Material	POM
Country of origin	Poland, PL
Supplier	AEP14

46



9997739

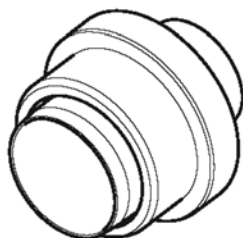

**VOLVO**

43

## Mandrel

Mandrel for replacement of sealing ring angular gear, front left.

<b>Tool standard</b>	C1
<b>Tool group</b>	43
<b>Tool bulletin</b>	422
<b>Model</b>	D420T2, D420T12, B420T2, B420T
<b>Tool board</b>	43
<b>Weight</b>	0.174 kg / 0.384 lbs
<b>Material</b>	POM
<b>Country of origin</b>	Poland, PL
<b>Supplier</b>	AEP14

9997741

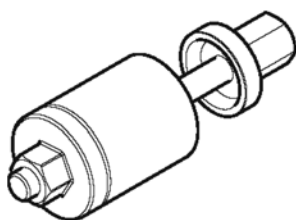

**VOLVO**

21

## Puller

Tool for changing bushing on oil sump.

<b>Tool standard</b>	C1
<b>Tool group</b>	21
<b>Tool bulletin</b>	422
<b>Model</b>	D4204T14, D4204T16, D4204T23, D4204T2, D420T8, D4204T7, D4204T4, B4204T20, B4204T23, B4204T26, B4204T27, B4204T29, B4204T31, B4204T34, B4204T35, B4204T39, B4204T44, B4204T45, B4204T46, B4204T48, B4204T49, B3154T5
<b>Tool board</b>	21
<b>Weight</b>	0.472 kg / 1.041 lbs
<b>Material</b>	Steel
<b>Country of origin</b>	Poland, PL
<b>Supplier</b>	AEP14



9997751



**VOLVO**

### Mandrel

Mandrel for replacement of sealing ring, angular gear outer right, 8G55 519A.

<b>Tool standard</b>	C1
<b>Tool group</b>	43
<b>Tool bulletin</b>	422
<b>Model</b>	D420T2, D420T13, B420T2, B420T
<b>Tool board</b>	43
<b>Weight</b>	0.156 kg / 0.344 lbs
<b>Material</b>	POM
<b>Country of origin</b>	Poland, PL
<b>Supplier</b>	AEP14

9997752



**VOLVO**

### Mandrel

Mandrel for replacement of sealing ring, angular gear cardan shaft seal, 8G55 519A.

<b>Tool standard</b>	C1
<b>Tool group</b>	43
<b>Tool bulletin</b>	422
<b>Model</b>	D420T2, D420T14, B420T2, B420T
<b>Tool board</b>	43
<b>Weight</b>	0.16 kg / 0.353 lbs
<b>Material</b>	POM
<b>Country of origin</b>	Poland, PL
<b>Supplier</b>	AEP14