

Subject Supra Battery Testing		Market USA
Service Category Power Source/Network	Section Battery/Charging	
Applicability 2020 Supra		

APPLICABLE VEHICLES

2020	Supra
-------------	--------------

CONDITION

- When testing the battery during PDS with either the DSS-5000 or DCA-8000 battery diagnostic tools, the battery tester may provide inaccurate results if it is connected to the remote battery posts under the hood.

RECOMMENDATIONS

- To accurately test the battery,
 - Access the battery in the rear of the vehicle.
 - Connect the positive clamp directly to the positive post.
 - Connect the negative clamp to either end of the ground wire after the intelligent battery sensor (IBS).
- Connecting directly to the negative post or area before the IBS sensor may set battery fault codes or damage to the IBS sensor.
- The image below shows the correct area to connect the negative clamp of the tester.

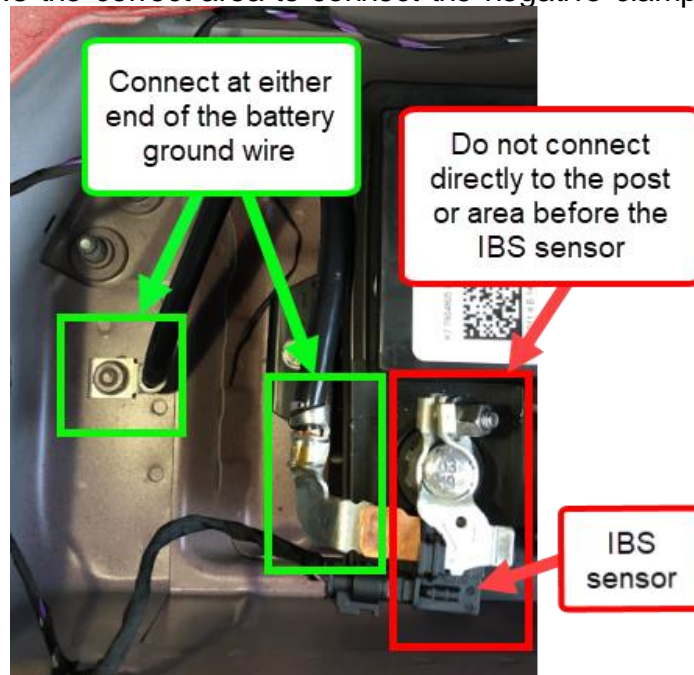

- For battery charging, use the remote battery posts under the hood of the vehicle.

LINK REFERENCES

This Tech Tip does not contain any link references