



Ferrari North America

Technical Information

Date: May 2019
Bulletin #: 2583
Campaign #:
Supersedes: 2253
Section: 9

Model Type: 458 Italia/Spider/Speciale/SpecialeA, F12 Berlinetta, California
Model Year: All
Subject: SABELT Racing seats

Please note that the following individual components are now available as spare parts for the aforementioned models:

- Electric motor **Part No. 86974700** Q.ty 1 (applicable for **California**);
- Electric motor **Part No. 86974800** Q.ty 1 (applicable for **F12 Berlinetta**);
- Gear motor Bowden cable **Part No. 82998700** Q.ty 1 (applicable for **California**);
- Gear motor Bowden cable **Part No. 86770800** Q.ty 1 (applicable for **F12 Berlinetta**);

- IMPORTANT -

The separate seat bottoms and seat backrests can **NO LONGER** be ordered as spare parts for the aforementioned models. If necessary, you must order the complete seat, referring to the Spare Parts Catalog for the respective model.



Ferrari North America

Procedure

REPLACING ELECTRIC MOTOR AND BOWDEN CABLE - Ferrari California and F12 Berlinetta.

- Remove the seat from the vehicle as described in the Workshop Manual.
- Place the seat on a clean surface in a suitably protected area for the following operations.

- Remove the cover (1), undoing the indicated screws – Fig. 1.

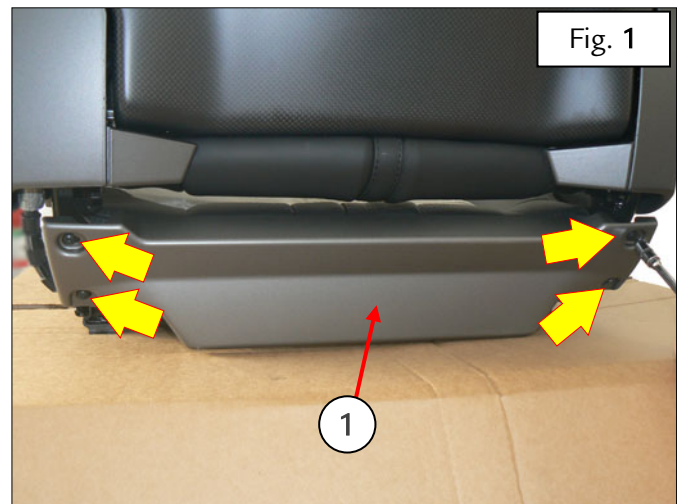

- Move the two retainer tabs in the direction indicated by the arrows – Fig. 2.
- Disconnect the connector (2) – Fig. 2.

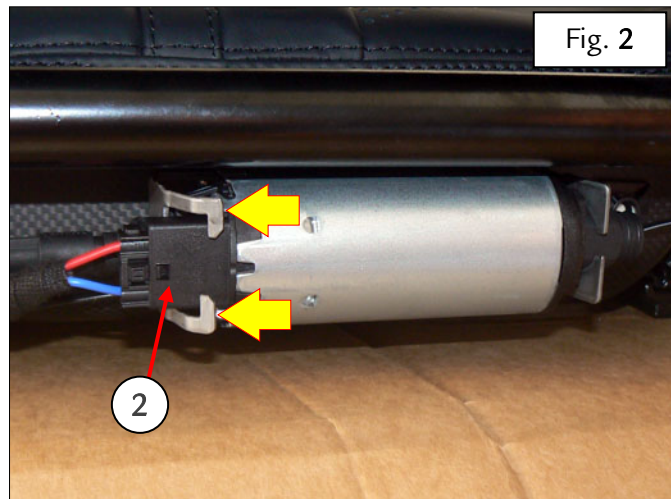



Ferrari North America

- Remove the electric motor (3), detaching the Bowden cable (4) – Fig. 3.
- Replace the electric motor (3) – Fig. 3.

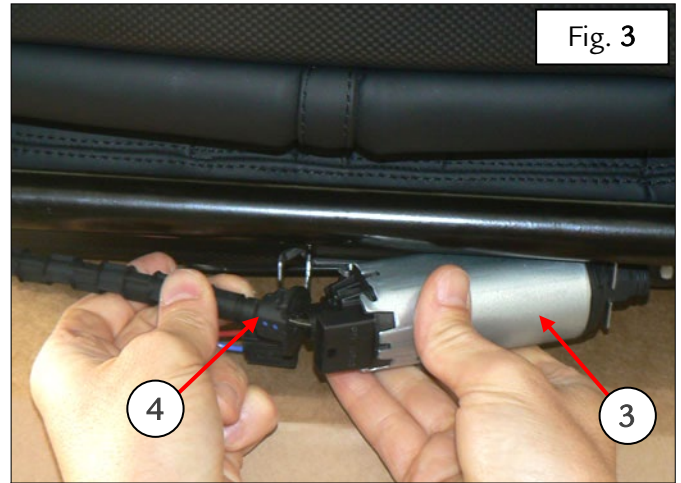

- If necessary, replace the mounting bracket (5) for the electric motor, undoing the indicated screws – Fig. 4.

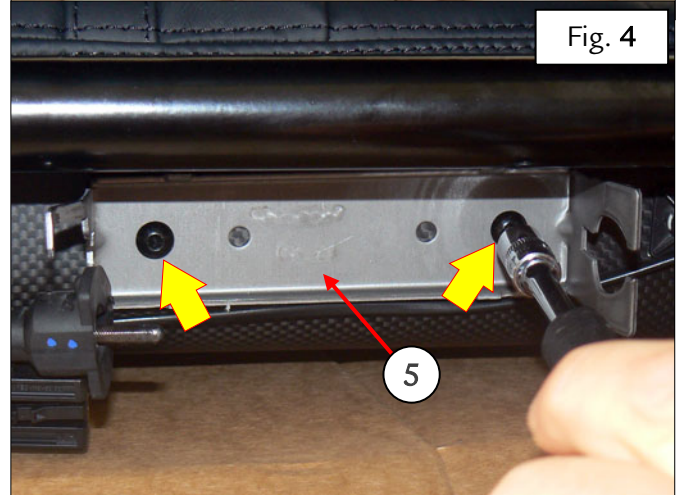

- Remove the lateral cover (6), undoing the indicated screws – Fig. 5.

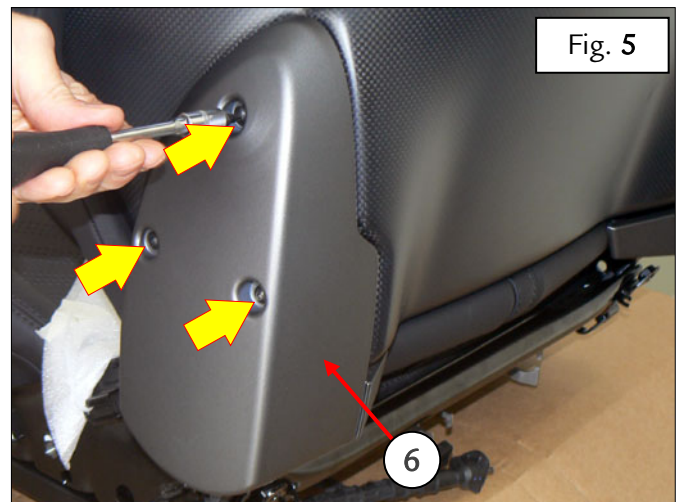



Ferrari North America

- Undo the indicated screw then detach the Bowden cable (4) from the bracket (8) – Fig. 6.

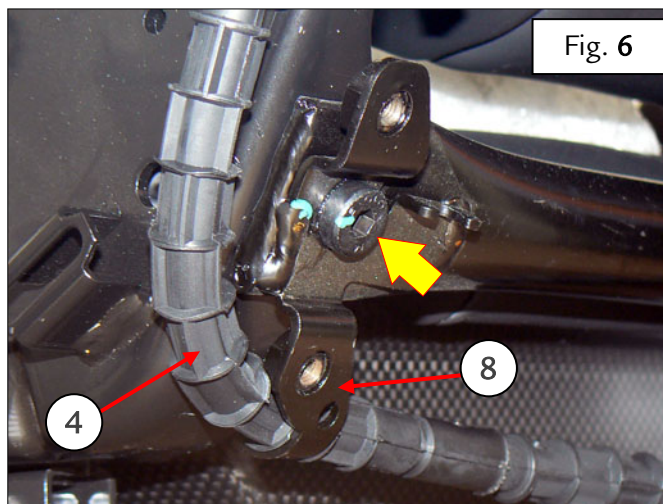

- Manually pull the Bowden cable (4) out of the reduction gear unit (9) – Fig. 7.
- Replace the Bowden cable (4) – Fig. 7.

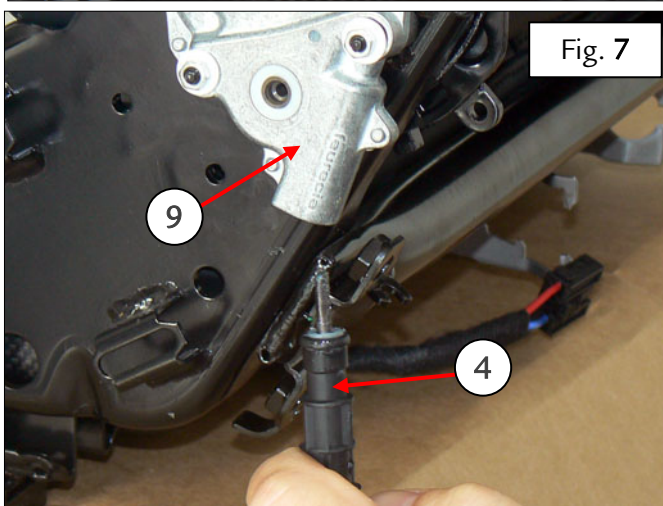

- Fasten the new Bowden cable (4) in the relative seat on the reduction gear unit (9) – Fig. 8.

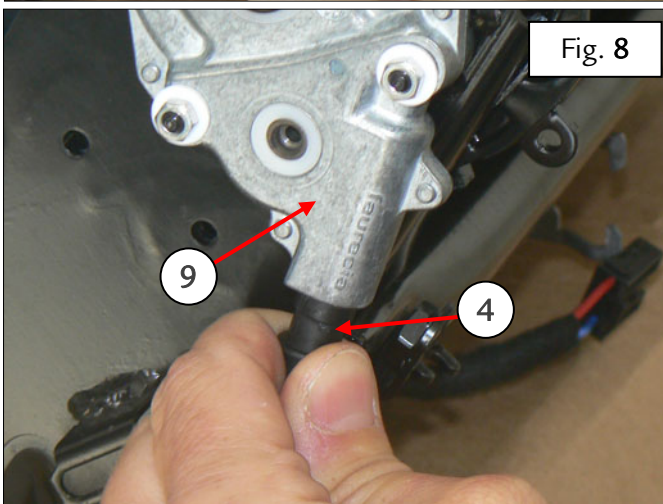



Ferrari North America

- Fasten the Bowden cable (4) to the retainer bracket (8) – Fig. 9.

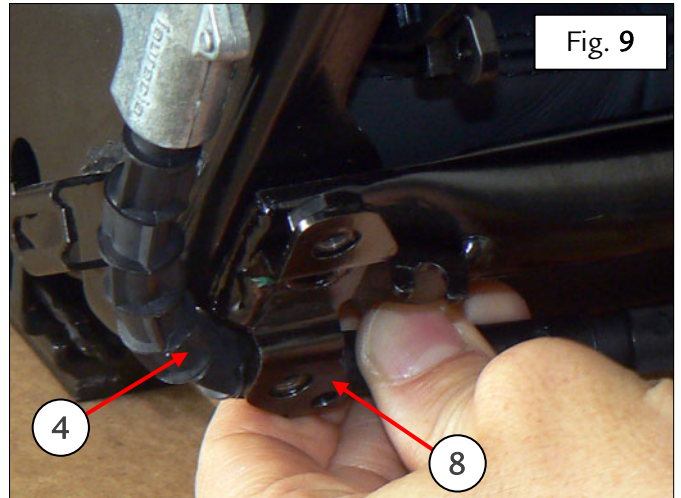

- If the bracket was removed, fasten the new bracket (5), tightening the indicated screws to a torque of 4 Nm – Fig. 10.

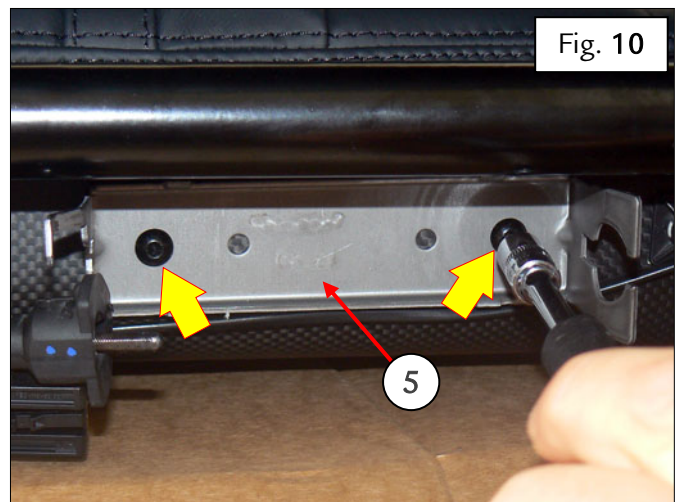

- Push the Bowden cable (4) in completely – Fig. 11.

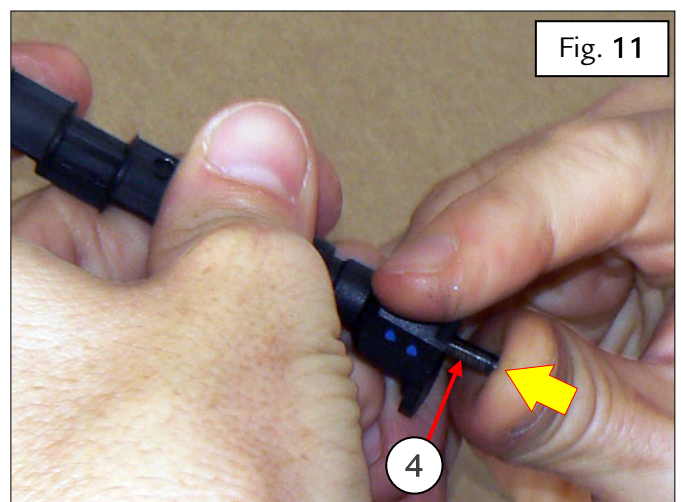



Ferrari North America

- Attach the Bowden cable (4) to the relative seat indicated on the electric motor (3) – Fig. 12.

Note: Ensure that the square section cable is fitted correctly in the respective cavity on the motor (3).

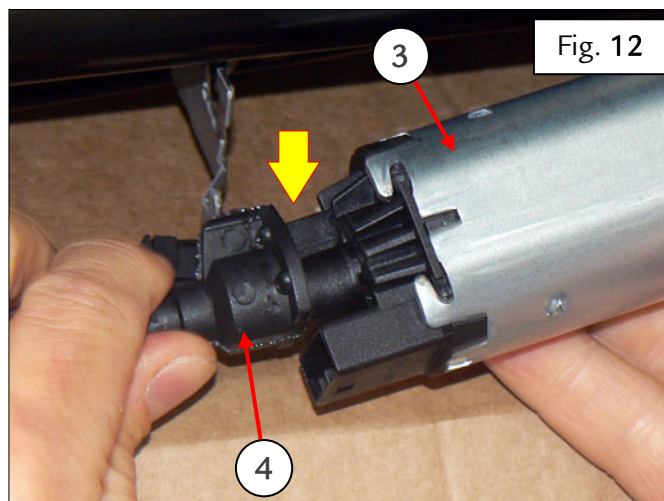

- Turn the electric motor (3) with the electrical connector facing outwards – Fig. 13.
- Fasten the rear of the electric motor in the rubber block indicated – Fig. 13.

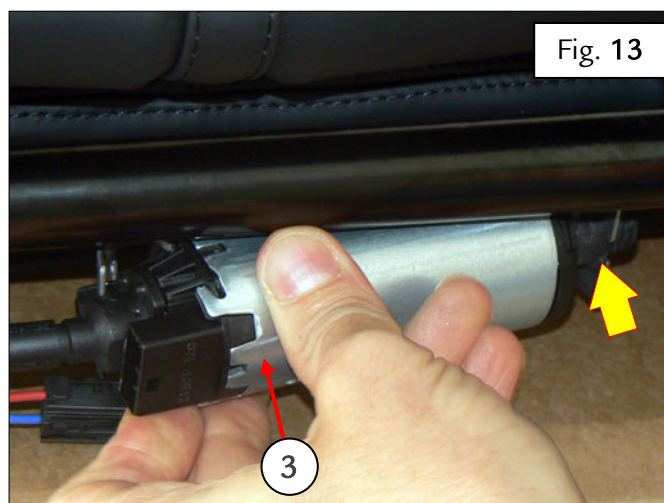



Ferrari North America

- Fasten the front of the electric motor (3) onto the relative bracket indicated, then connect the connector (2) – Fig. 14.

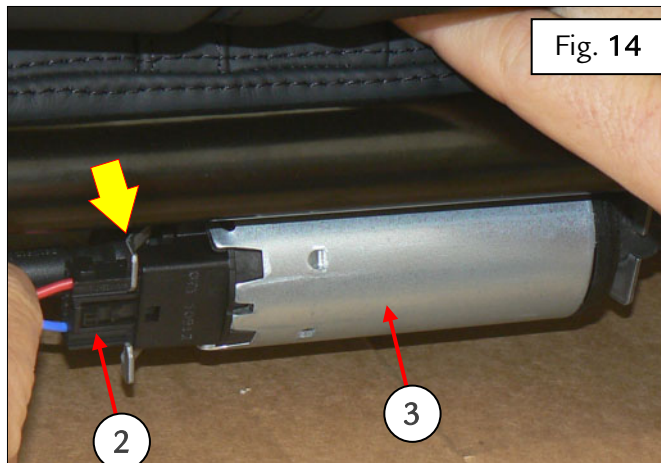

- Fasten the electric motor (3), returning the two clips indicated to their original positions – Fig. 15.

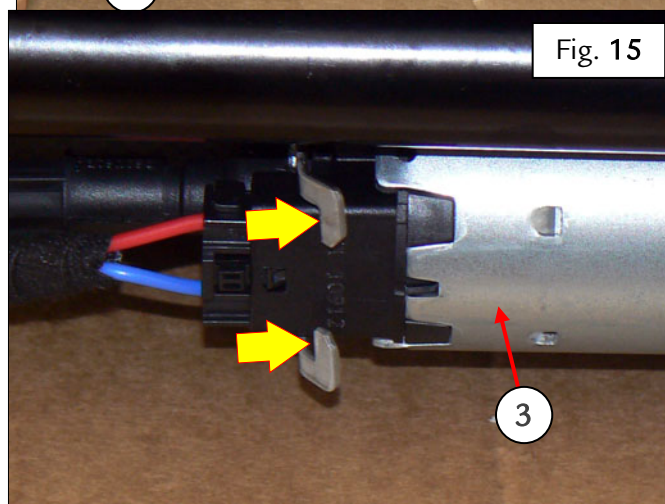

- Ensure that the Bowden cable is not bent incorrectly or strained – Fig. 16.
- Tighten the indicated screw to a torque of **24 Nm**, after applying **Arexon 52A43** or any other commercially available medium strength thread lock compound to the thread of the screw – Fig. 16.

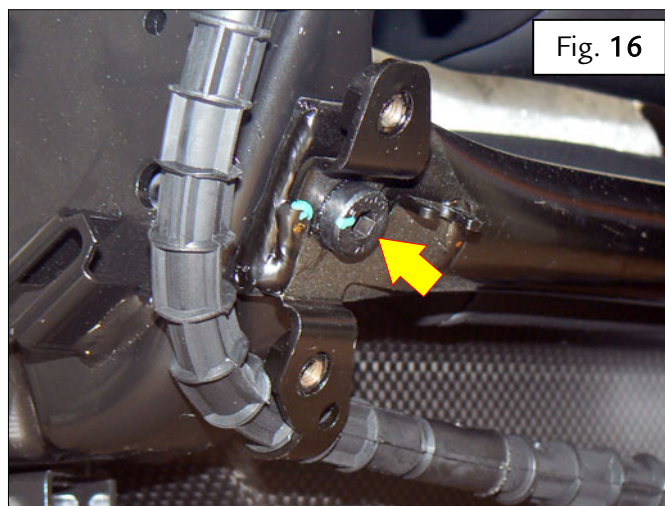



Ferrari North America

- Fit and fasten the lateral cover (6), tightening the indicated screws to a torque of 4 Nm – Fig. 17.

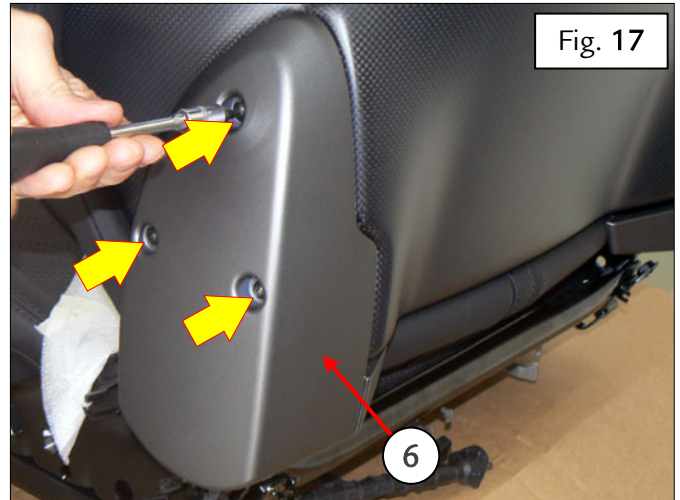

- Fit and fasten the cover (1), tightening the indicated screws to a torque of 4 Nm – Fig. 18.

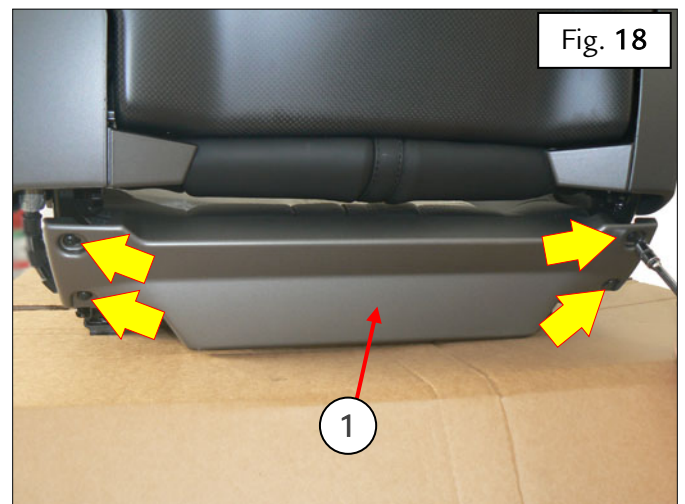

Thank you for your co-operation.